

DISPLAY THIS CARD ON PRINCIPAL FRONTAGE OF WORK



CITY OF PORTLAND BUILDING PERMIT

This is to certify that

Job ID: 2011-11-2684-HVAC

Located At 578 CONGRESS ST

CBL: 037- G-006-001

has permission to Install an electric Mitsubishi Heat pump
provided that the person or persons, firm or corporation accepting this permit shall comply with all of the provisions of the Statutes of Maine and of the Ordinances of the City of Portland regulating the construction, maintenance and use of the buildings and structures, and of the application on file in the department.

Notification of inspection and written permission procured before this building or part thereof is lathed or otherwise closed-in. 48 HOUR NOTICE IS REQUIRED.

A final inspection must be completed by owner before this building or part thereof is occupied. If a certificate of occupancy is required, it must be

Fire Prevention Officer

Code Enforcement Officer / Plan Reviewer

11/18/2011

**THIS CARD MUST BE POSTED ON THE STREET SIDE OF THE PROPERTY
PENALTY FOR REMOVING THIS CARD**

BUILDING PERMIT INSPECTION PROCEDURES

Please call 874-8703 or 874-8693 (ONLY)

or email: buildinginspections@portlandmaine.gov

With the issuance of this permit, the owner, builder or their designee is required to provide adequate notice to the city of Portland Inspections Services for the following inspections. Appointments must be requested 48 to 72 hours in advance of the required inspection. The inspection date will need to be confirmed by this office.

- **Please read the conditions of approval that is attached to this permit!! Contact this office if you have any questions.**
- **Permits expire in 6 months. If the project is not started or ceases for 6 months.**
- **If the inspection requirements are not followed as stated below additional fees may be incurred due to the issuance of a "Stop Work Order" and subsequent release to continue.**

Required Inspections:

1. Final inspection upon completion of work. NOTE: changes may have to be made if all conditions are not met.

The project cannot move to the next phase prior to the required inspection and approval to continue, REGARDLESS OF THE NOTICE OF CIRCUMSTANCES.

IF THE PERMIT REQUIRES A CERTIFICATE OF OCCUPANCY, IT MUST BE PAID FOR AND ISSUED TO THE OWNER OR DESIGNEE BEFORE THE SPACE MAY BE OCCUPIED.



PORTLAND MAINE

Strengthening a Remarkable City, Building a Community for Life • www.portlandmaine.gov

Director of Planning and Urban Development
Penny St. Louis

Job ID: 2011-11-2684-HVAC

Located At: 578 CONGRESS ST

CBL: 037- G-006-001

Conditions of Approval:

Building

1. Application approval based upon information provided by applicant. Any deviation from approved plans requires separate review and approval prior to work.
2. Ventilation of this space is required per ASRAE 62.2 or 62.1, 2007 edition.
3. Separate permits are required for any electrical, plumbing, sprinkler, fire alarm, HVAC systems, heating appliances, including pellet/wood stoves, commercial hood exhaust systems and fuel tanks. Separate plans may need to be submitted for approval as a part of this process.
4. The appliance and venting shall be installed in accordance with the UL listing, IMC 2009 and NFPA 211
5. As per conversation with Owner and Installer. This unit shall be a minimum of 7' above any walking surface and all fastening will be inspected upon completion. NOTE: changes may have to be made upon final inspection.

Fire

Installation shall comply with City Code Chapter 10.

Fuel-fired boilers shall be protected in accordance with NFPA 101, *Life Safety Code*.

NFPA 90A, *Standard for the Installation of Air-Conditioning and Ventilating Systems*;

NFPA 91, *Standard for Exhaust Systems for Air Conveying Vapors, Gases, Mists, and Noncombustible Particulate Solids*;

NFPA 70, *National Electrical Code*; and the manufacturer's published instructions.

City of Portland, Maine - Building or Use Permit Application

389 Congress Street, 04101 Tel: (207) 874-8703, FAX: (207) 8716

Job No: 2011-11-2684-HVAC	Date Applied: 11/8/2011	CBL: 037- G-006-001	
Location of Construction: 578 CONGRESS ST	Owner Name: William Stauffer	Owner Address: 468 Forest Ave, Portland, ME 04101	Phone:
Business Name:	Contractor Name: Pine State Services	Contractor Address: PO Box 6308, Scarborough, ME	Phone: 883-1200
Lessee/Buyer's Name:	Phone:	Permit Type: HVAC	Zone: B-3
Past Use: 1 st & 2 nd floor is retail 3 rd floor is one dwelling unit	Proposed Use: 1 st & 2 nd floor is retail with 3 rd floor as one residential dwelling unit – to install new heating system	Cost of Work: \$3000.00	CEO District:
		Fire Dept: <input checked="" type="checkbox"/> Approved w/conditions <input type="checkbox"/> Denied <input type="checkbox"/> N/A	Inspection: Use Group: Type: Signature: <i>HAPS</i>
		Signature: <i>Capt. P. P. 11/15/11</i>	
Proposed Project Description: Install an electric Mitsubishi Heat pump		Pedestrian Activities District (P.A.D.)	
Permit Taken By: Lannie		Zoning Approval	

<p>1. This permit application does not preclude the Applicant(s) from meeting applicable State and Federal Rules.</p> <p>2. Building Permits do not include plumbing, septic or electrical work.</p> <p>3. Building permits are void if work is not started within six (6) months of the date of issuance. False informatin may invalidate a building permit and stop all work.</p>	Special Zone or Reviews <input type="checkbox"/> Shoreland <input type="checkbox"/> Wetlands <input type="checkbox"/> Flood Zone <input type="checkbox"/> Subdivision <input type="checkbox"/> Site Plan <input type="checkbox"/> Maj <input type="checkbox"/> Min <input type="checkbox"/> MM Date: <i>11/10/11</i>	Zoning Appeal <input type="checkbox"/> Variance <input type="checkbox"/> Miscellaneous <input type="checkbox"/> Conditional Use <input type="checkbox"/> Interpretation <input type="checkbox"/> Approved <input type="checkbox"/> Denied Date:	Historic Preservation <i>W. P.</i> <input type="checkbox"/> Not in Dist or Landmark <input type="checkbox"/> Does not Require Review <input type="checkbox"/> Requires Review <input type="checkbox"/> Approved <input type="checkbox"/> Approved w/Conditions <input type="checkbox"/> Denied <i>Any exterior work requires a separate review & approval</i>
	CERTIFICATION		

I hereby certify that I am the owner of record of the named property, or that the proposed work is authorized by the owner of record and that I have been authorized by the owner to make this application as his authorized agent and I agree to conform to all applicable laws of this jurisdiction. In addition, if a permit for work described in the appication is issued, I certify that the code official's authorized representative shall have the authority to enter all areas covered by such permit at any reasonable hour to enforce the provision of the code(s) applicable to such permit.

SIGNATURE OF APPLICANT	ADDRESS	DATE	PHONE
RESPONSIBLE PERSON IN CHARGE OF WORK, TITLE		DATE	PHONE



FILL IN AND SIGN WITH INK

APPLICATION FOR PERMIT HEATING OR POWER EQUIPMENT



037 G006

B-3

To the INSPECTOR OF BUILDINGS, PORTLAND, ME.

The undersigned hereby applies for a permit to install the following heating, cooking or power equipment in accordance with the Laws of Maine, the Building Code of the City of Portland, and the following specifications:

Location / CBL 578 Congress St. Portland Use of Building Residential Date 11-8-2011
 Name and address of owner of appliance WILLIAM STAUFFER 468 Forest Ave Portland ME 04101
 Installer's name and address Pine State Services PO Box 6308 Scarborough ME 04070 Telephone 207 883-1200

Location of appliance:

- Basement
- Floor side of
- Attic
- Roof Bldg outside

Type of Fuel:

- Gas
- Oil
- Solid
- Electric

Appliance Name:

U.L. Approved Yes No

Will appliance be installed in accordance with the manufacture's installation instructions? Yes No

IF NO Explain: _____

The Type of License of Installer:

- Master Plumber # MS 8235
- Solid Fuel # _____
- Oil # _____
- Gas # _____
- Other _____

Type of Chimney:

- Masonry Lined 1st floor retail
2nd floor retail
3rd floor IDU
 - Metal
 - Direct Vent
- Factory built _____
 Factory Built U.L. Listing # _____
 Type _____ UL# _____

Type of Fuel Tank

- Oil
- Gas

Electric Heat Pump
Condenser Unit
ASAP
NO HEAT

Size of Tank _____

Number of Tanks _____

Distance from Tank to Center of Flame _____ feet.

Cost of Work: \$ 2,500.00

Permit Fee: \$ _____

Approved

Fire: _____
 Ele.: _____
 Bldg.: _____

Approved with Conditions

- See attached letter or requirement

Inspector's Signature _____

Date Approved _____

Signature of Installer [Signature]

11-10-11



Welcome, sign in or register

Toll Free: 1-866-554-HEAT (4328)

Monday-Friday: 8am - 5pm CST

Saturday: 8am - 2pm CST

Shopping Cart (0 items)

Search

Home | Shop By Category | Shop By Brand | My Account | FAQ | Contact Us | Live Chat

Home » Mini Splits & Forced Air » Ductless Mini Split Systems » Heat Pump Mini Split Systems » Heat Pump Wall Mounted Systems » Heat Pump Wall Mounted - Single Zone » Mitsubishi » Model#: MSZ/MUZGE18NA

Mitsubishi MSZGE18NA+MUZGE18NA Mr. Slim Wall Mounted Single Zone Heat Pump - 18,000BTU



5 Reviews | Review It!

LIVECHAT
TALK TO A TECH

Model: MSZ/MUZGE18NA

Brand: Mitsubishi

Availability: **In stock.** Ships within 3-5 days.

Shipping: **Free Shipping on This Product**

MSRP: \$2,715.15
Your Price: \$1,855.95

QTY: 1



enlarge

Mitsubishi Mr. Slim Ductless Mini-Split, Wall Mounted, Inverter, Heat Pump, 19.2 SEER, (1) Indoor: MSZGE18NA; (1) Outdoor: MUZGE18NA, Wireless Remote, Anti-Allergy Enzyme Filter, R410a Refrigerant, 208-230V

Description Specifications Manuals Videos Ask A Question

Product Details



Mitsubishi Mr. Slim MSZGE18NA+MUZGE18NA Wall Mounted Mini Split Single Zone Heat Pump 19.2 SEER - 17,200BTU

The high efficiency of these Mitsubishi Mr. Slim Mini Split Ductless Systems like MSZGE18NA+MUZGE18NA helps them pay for themselves by slashing electrical costs. Strong, quiet and efficient DC motors are used both indoors and outdoors. This Mitsubishi's Super High-SEER mini-split heat pump will provide you with 18,000 BTU of heating for winter and 1-1/2 ton of cooling for hot summer and it comes with 1-MSZGE18NA wall mounted 18,000 BTU unit with wireless remote control. This unit are connected to the modern MUZGE18NA - up to 18,000 BTU outdoor condensing unit. Complete system creates the perfect climate control for your space. High performance fan blades, condensers and evaporators combined with variable speed inverter-driven compressors are made for unmatched performance. Variable speed compressors automatically adjust to fluctuating room capacity requirements. Since mini splits have little-to-no ducting, they forego those energy losses typically associated central forced-air systems. Duct losses can easily account for more than 30% of energy consumption, especially if the ducts are not sealed tight or in an unconditioned space such as an attic or crawlspace. With ratings as high as 25-SEER (Seasonal Energy Efficiency Ratio), systems MSZGE15NA+MUZGE15NA and MSZGE18NA+MUZGE18NA are among the highest rated efficiency equipment available anywhere!

What is Mini-Split Heat Pump?



DOWNLOADABLE PDFS

- Owner's Manual
- Installer's Manual
- Product Submittal

ACCESSORIES

Diversitech Outdoor Unit Plastic Pad 30" x 36" x 2"

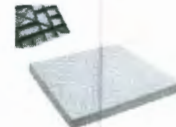

Your Price: \$41.15

Add to Cart

Honeywell 14/4 Connecting Wire (per foot)



Your Price: \$1.65

Add to Cart

Honeywell Disconnect Box + Electrical Whip Kit



Your Price: \$25.95

Add to Cart

Kamco Ductless Mini Split Line Set - 1/4"x1/2"-25'



Your Price: \$159.00

Add to Cart

Airtec CKB3 Wall Bracket for Mini Split

6336

Like your refrigerator, heat pumps use electricity to pump refrigerant and transfer heat from one space to another. When we transfer heat from within our home to the outdoors, we call it "air conditioning". Conversely, when we transfer heat from the outdoors to within the home, we call it a "heat-pump". Because refrigerant is naturally much colder than outdoor temperatures even on a very cold day, it actually absorbs heat from outdoors, and transfers the heat it absorbed outside to within your home. The refrigerant's physical properties do this naturally. What you pay for is the electricity to pump refrigerant via copper tubing from outdoors to indoors. Because we move the heat rather than create it (as electric baseboard or resistance heat does), we can deliver up to 4 times the heat for the energy we consume!

Mitsubishi Mr. Slim Mini-Split Heat Pump Systems are Flexible and Quiet

Mini splits offer flexibility because they can be suspended from a ceiling, mounted flush behind a drop ceiling, hung on a wall or floor-standing. Ductless heat pumps allow for a peaceful inside environment by enabling the contractor to install components like compressors and motors outdoors. Bedrooms, living rooms, dining rooms, basements, sunrooms, new additions and renovations are applications that can take full advantage of the single and multi-room Mitsubishi systems

Mitsubishi Mr. Slim Inverter Technology.

INVERTER-driven compressor systems in the outdoor unit detect subtle changes in temperature and, like a cars cruise control, automatically adjust compressor speed - unlike conventional units, which start and stop repetitively. Special components within the compressor increase the magnetic flux and reduce its weight, allowing the compressor to generate higher energy efficiencies with better performance than ever before - at low levels of sound during start-up and running. "Soft start" reduces the instantaneous peak demand associated with AC equipment starts. The compressor starts at minimum speed, avoiding high inrush current associated with standard compressors.

Mitsubishi Mr. Slim MSZGE18NA+MUZGE18NA Wall Mounted Mini Split Single Zone Heat Pump 19.2 SEER - 17,200BTU at a glance:

Wall Mounted MSZGE18NA Unit

- Stylish, slim and elegant, wall mounted units are designed to complement any interior decor.
- Compact size.
- I.A.Q. Blue Enzyme Anti-allergen filter.
- Wide Vane swing Mode
- Wireless remote control.
- Automatic swinging louvers.

Mitsubishi's Multiple Filters for Cleaner, Healthier Air

- Mitsubishi indoor units use a sophisticated multi-part filter system to remove contaminants such as allergens, viruses and bacteria from the air as it circulates. The hybrid catechin pre-filter absorbs odor-causing gases. A Blue-Enzyme anti-allergen filter reduces germs, bacteria and viruses and helps trap dust, pollens, mites and other particles; the filter uses an enzyme catalyst to help break down the sulfur atom bonds in allergen proteins, transforming them into non-allergen proteins. A hybrid-coating process makes the catechin filter washable and, if properly maintained with monthly cleanings, effective for more than 10 years.

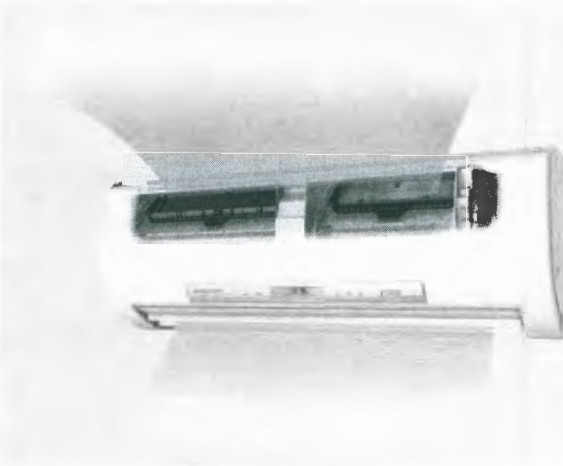

Inverter Technology

- Maximizes energy savings by making sure only the energy needed to cool or heat an area is used.

Mitsubishi Mr. Slim Integrated i-see™ Sensor - MSZ-FD/MSZ-FE models only

- The i-see sensor detects the always troublesome regions of temperature closer to the ceiling and the floor. The i-see sensor also controls the airflow up to a wide 150° lateral angle for ultimate comfort (90° angle in cooling mode) by scanning the room and making adjustments based on the ambient temperature readings. Through this process the MSZ-FD09/12NA systems achieve superior cooling/heating performance with extremely efficient operation.

Mitsubishi Mr. Slim Programmable ComfortSmart Set featured on MSZ-GE systems provides the option to program multiple settings into one "quick" press feature providing an additional level of comfort control.

Mitsubishi Mr. Slim Powerful Mode

- The POWERFUL mode (found on select systems) is available to cool or heat any desired space quickly by lowering the set temperature in cooling mode or raising the set temperature in heating mode, both by 7° F. In Powerful Mode, the fan speed increases for 15 minutes then resumes standard operation.

Mitsubishi Mr. Slim System Control in the Palm of Your Hand

- Mitsubishi Electric offers a comprehensive remote controller that controls temperature, fan speed and more. Choose from four modes: COOL, HEAT, AUTO and DRY. The controller also has a 12-hour ON/OFF timer for one-button control of your personal comfort.

Mitsubishi Mr. Slim MSZGE18NA+MUZGE18NA Wall Mounted Mini Split Single Zone Heat Pump 19.2 SEER - 17,200BTU Other Standard Features :

- All Mitsubishi Mr. Slim Systems Have ISO and ETL Approvals for U.S. and Canada.
- Environmentally Friendly and ARI performance certified.
- Sleek, Modern Design with Easy to Access Controls and Visible System.
- 19.2 SEER, 10HSPF.
- Hybrid Catechin pre-filters.
- Sleep Timer.
- 12 Hour Timer.
- Auto Louver: Up/ Down - Wall Mounted Units Only.
- Coil Dry Mode - Wall Mounted Units Only.
- Auto Restart.
- Quiet Mode - Wall Mounted Units Only.

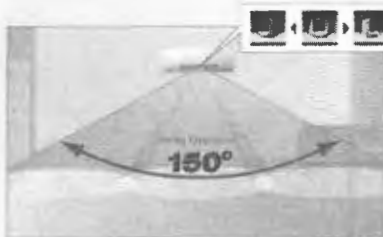

Outdoor Units, Supports Up to 200 Pounds



Your Price: \$130.00

[Add to Cart](#)

Diversitech 5/8" ID Vinyl Drain Tubing (per foot)



Your Price: \$1.00

[Add to Cart](#)

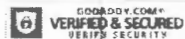

- Dry Mode.
- Cold Prevention.
- Return Air-intake - Concealed Units Only.
- Economy Mode.
- Low Ambient.
- Auto Changeover.
- Auto Restart/Reset.
- Branch Duct Capable - Concealed Units Only.
- Wired/Wireless Switching.

Mitsubishi Mr. Slim MSZGE18NA+MUZGE18NA Wall Mounted Mini Split Single Zone Heat Pump 19.2 SEER - 17,200BTU Warranty

5 year parts / 7 years compressor

Mitsubishi Mini Split Ductless Heat Pump and Air Conditioner System - more Benefits:

The high efficiency of Mitsubishi Mr. Slim systems helps them pay for themselves by slashing electrical costs. Strong, quiet and efficient DC motors are used both indoors and outdoors. High performance fan blades, condensers and evaporators combined with variable speed inverter-driven compressors are made for unmatched performance. Variable speed compressors automatically adjust to fluctuating room capacity requirements.

Mitsubishi Electric is without exception the industry leader in split-ductless air-conditioning technology. Our innovations have defined cutting-edge technology for over 28 years. Compare, and you'll see that no one surpasses the Mr. Slim brand's performance for quiet, easy-to-use and energy-efficient operation. And because our split-ductless technology carries the Mitsubishi Electric name, you know every product is built to last. The bottom line is Mr. Slim systems deliver the ultimate in comfort control for your home or office. It's true today and will be comfortably evident for years to come. Mr. Slim systems have three main components: an indoor unit, an outdoor unit and a remote controller. Installation is as simple as mounting the indoor and outdoor units, connecting the refrigerant lines and making a few electrical connections. An easy installation for your authorized contractor means you will be quickly enjoying the comfort Mr. Slim systems provide.

- [Related Products](#)
- [Related Categories](#)



COPYRIGHT © 2011 E-COMFORTUSA.COM
AN ECOMFORT HOLDINGS INC COMPANY
ALL RIGHTS RESERVED.

E-COMFORTUSA

- [Official Blog](#)
- [On Twitter](#)
- [On Scnbd](#)
- [Contact Us](#)
- [Site Map](#)

POLICIES

- [Shipping Policy](#)
- [Return Policy](#)
- [Damage and Warranty Claims](#)
- [Product Availability](#)
- [Overstock Items](#)
- [Conditions of Use](#)
- [Privacy Policy](#)

SHOPPING

- [Shop by Category](#)
- [Shop by Brand](#)
- [New Products](#)

RESOURCES

- [FAQ](#)
- [Knowledge Center](#)
- [SPACEPAK Sizing Calculator](#)
- [WarmlyYours Floor Heat Estimator](#)

Springer's Jew Bldg.

578 Congress Back of Building

mount condenser unit
minimum of 6 feet above
2nd floor egress roof.

Fire Escape



3rd Floor

2nd floor egress / roof

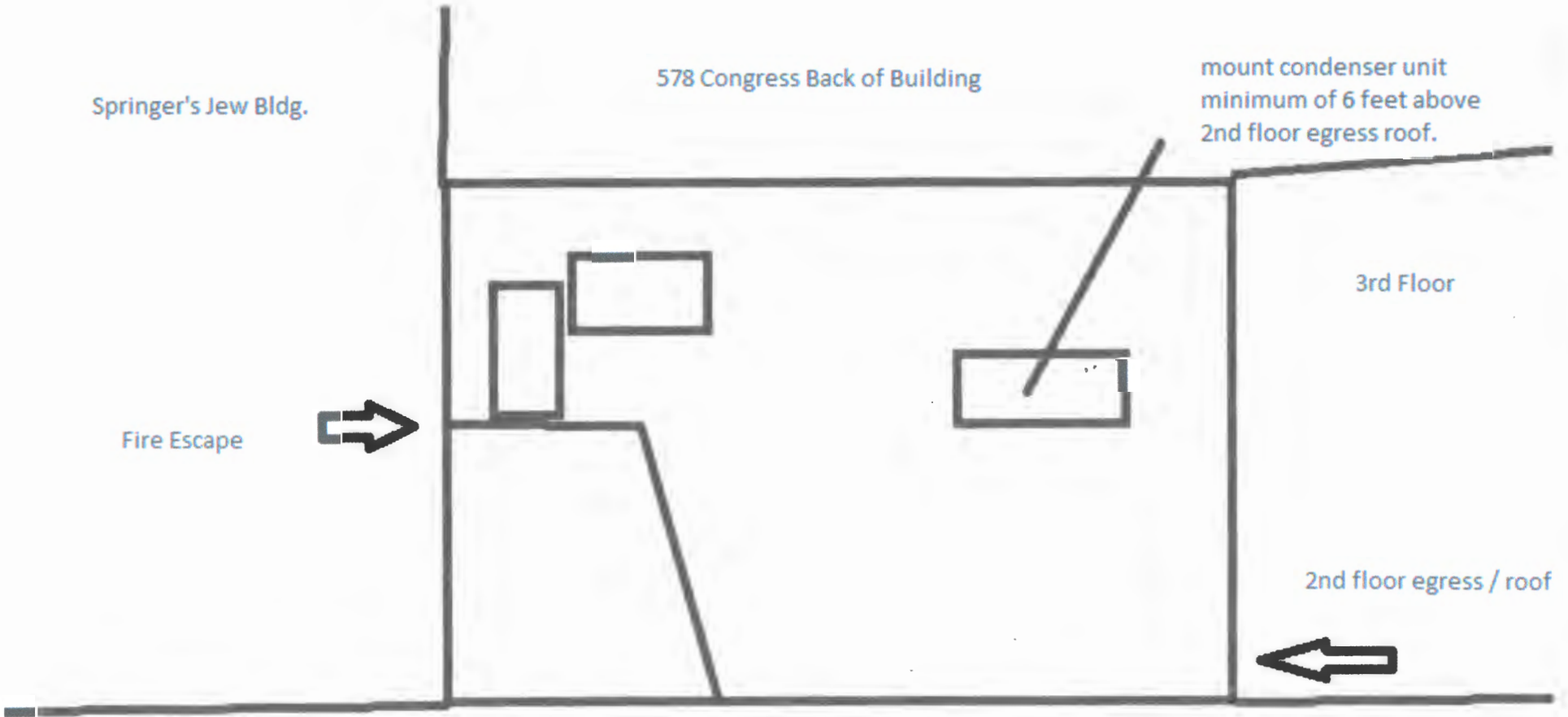



CITY OF PORTLAND, MAINE

Department of Building Inspections

Original Receipt

10-5 2011

Received from City Property Manager

Location of Work 578 Congress

Cost of Construction \$ _____ Building Fee: _____

Permit Fee \$ _____ Site Fee: _____

Certificate of Occupancy Fee: _____

Total: _____

Building (IL) ___ Plumbing (I5) ___ Electrical (I2) ___ Site Plan (U2) ___

Other _____

CBL: 037 6006

Check #: visa Total Collected \$ 50.00

**No work is to be started until permit issued.
Please keep original receipt for your records.**

Taken by: [Signature]

WHITE - Applicant's Copy
YELLOW - Office Copy
PINK - Permit Copy

John M
okay
express