

1 FIRST FLOOR REFLECTED CEILING PLAN  
Scale: 1/4" = 1'-0"

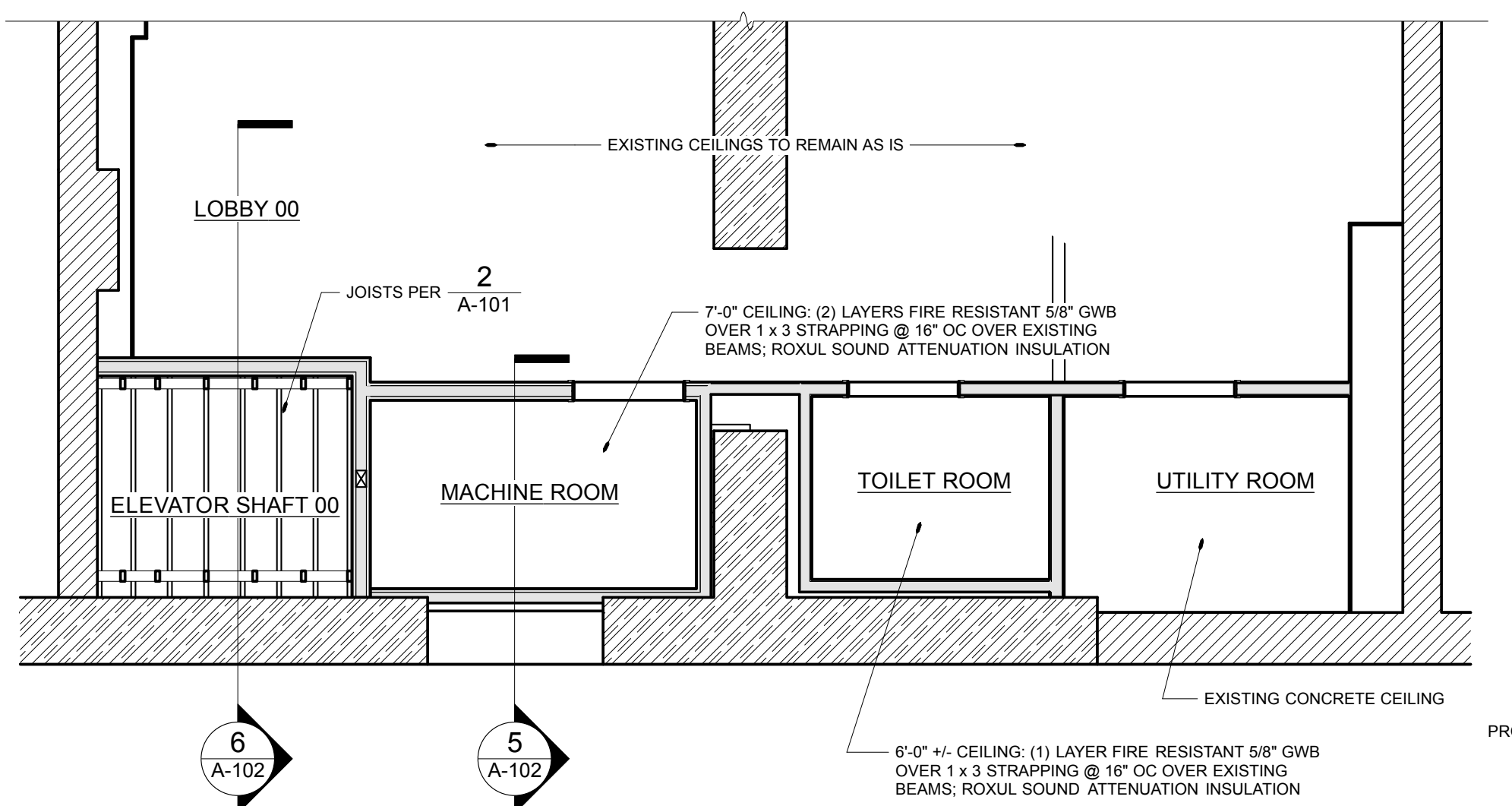

7 BASEMENT REFLECTED CEILING PLAN  
Scale: 1/4" = 1'-0"

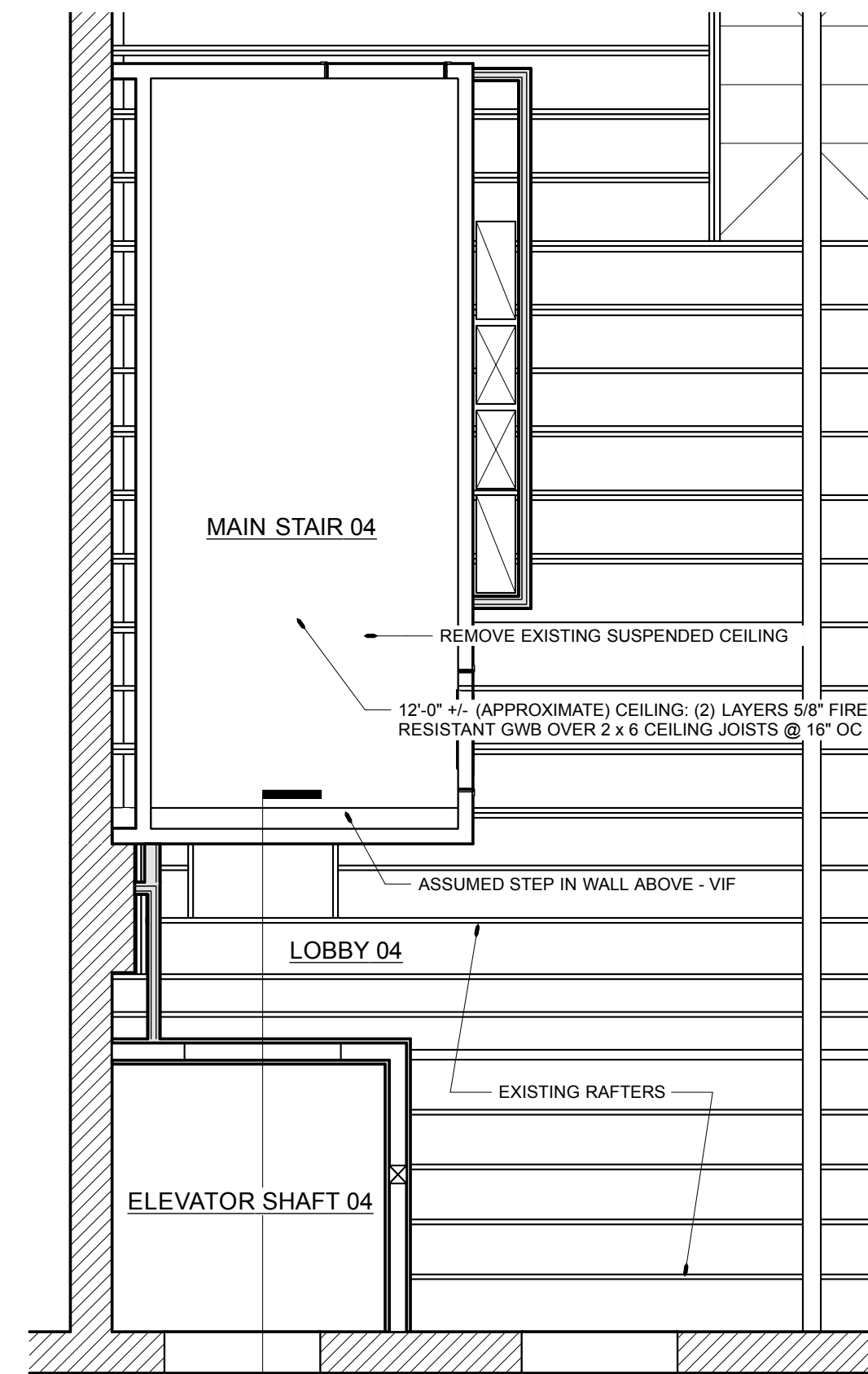

2 FOURTH FLOOR REFLECTED CEILING PLAN  
Scale: 1/4" = 1'-0"

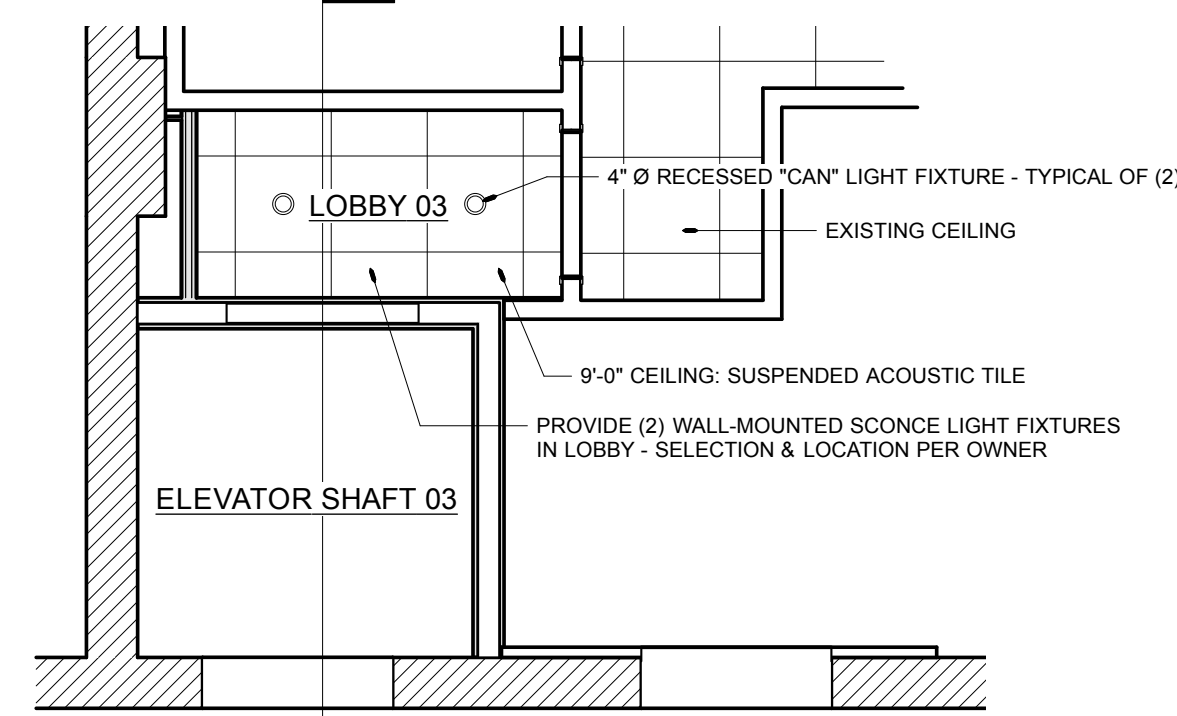

5 THIRD FLOOR REFLECTED CEILING PLAN  
Scale: 1/4" = 1'-0"

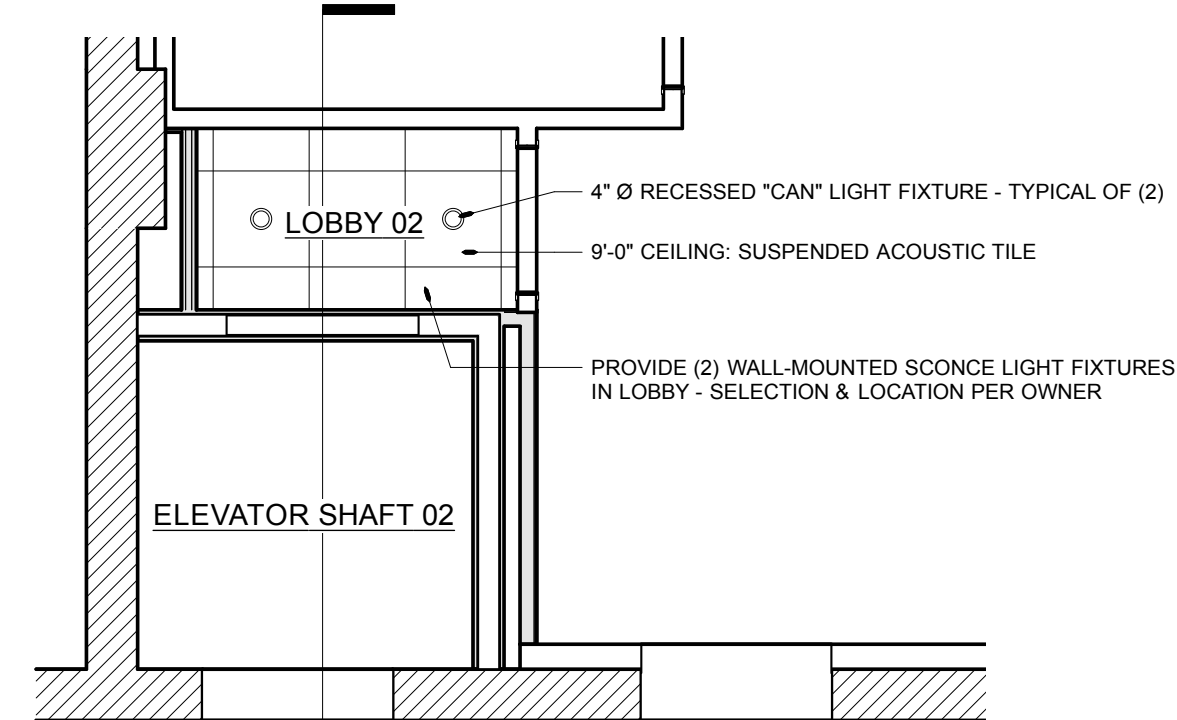

8 SECOND FLOOR REFLECTED CEILING PLAN  
Scale: 1/4" = 1'-0"

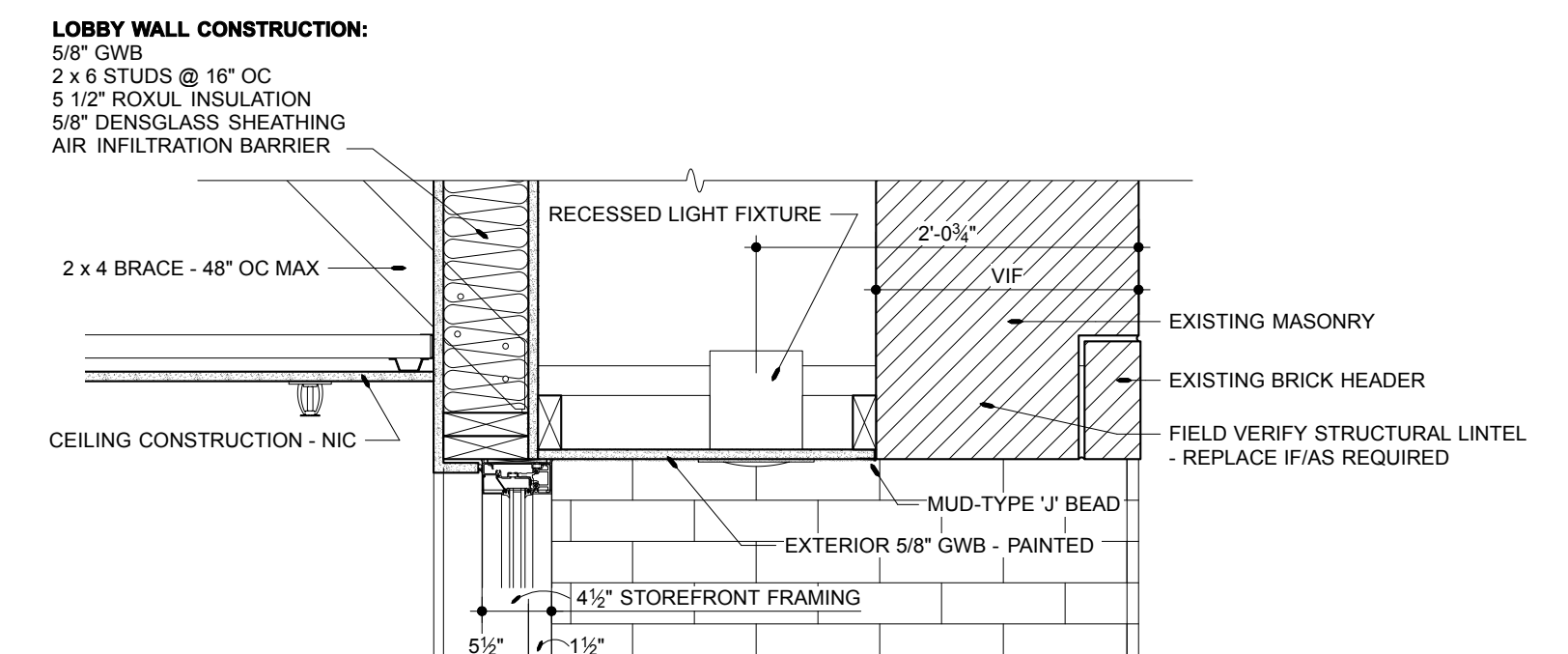

3 ENTRANCE - HEAD  
Scale: 1" = 1'-0"

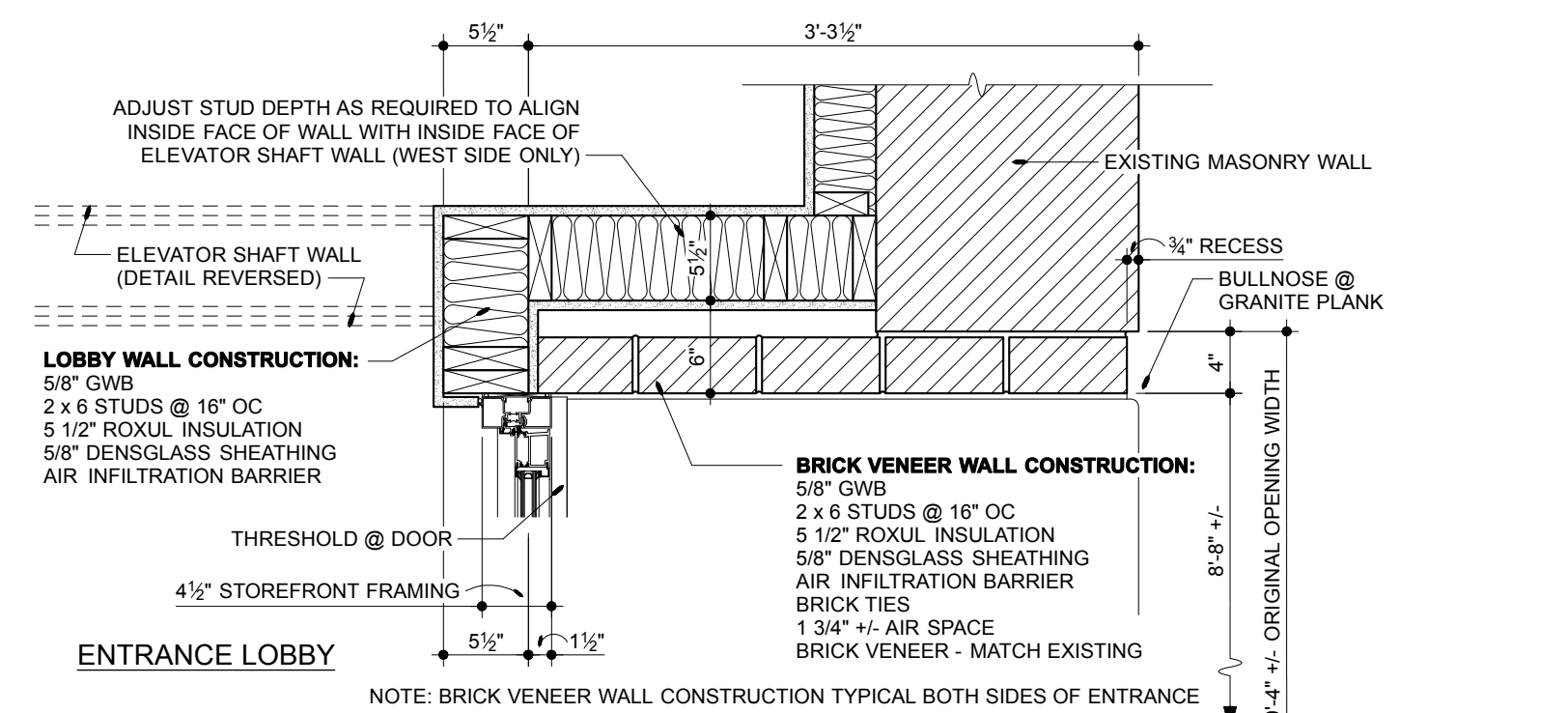

4 ENTRANCE - JAMB  
Scale: 1" = 1'-0"

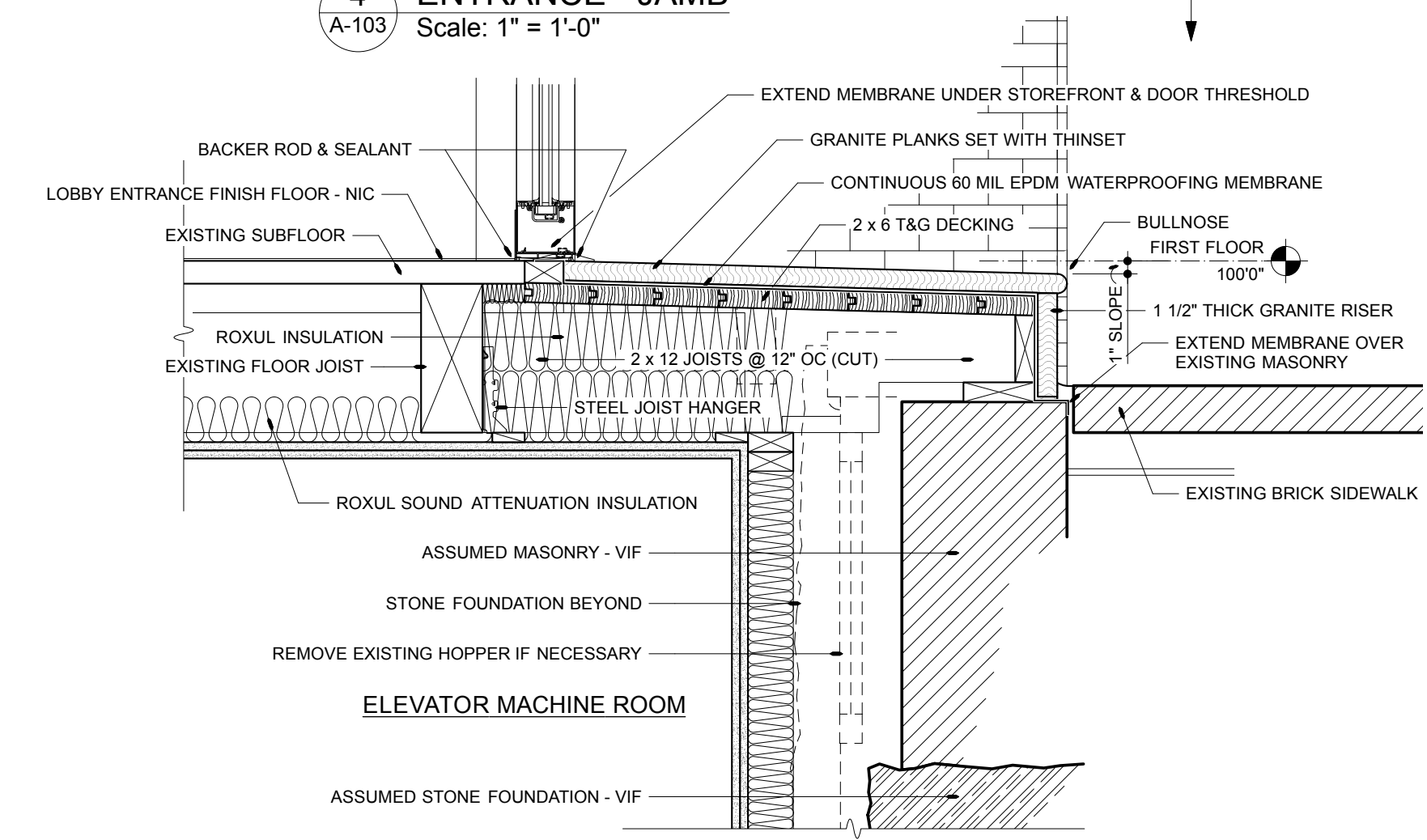

6 ENTRANCE - SILL  
Scale: 1" = 1'-0"

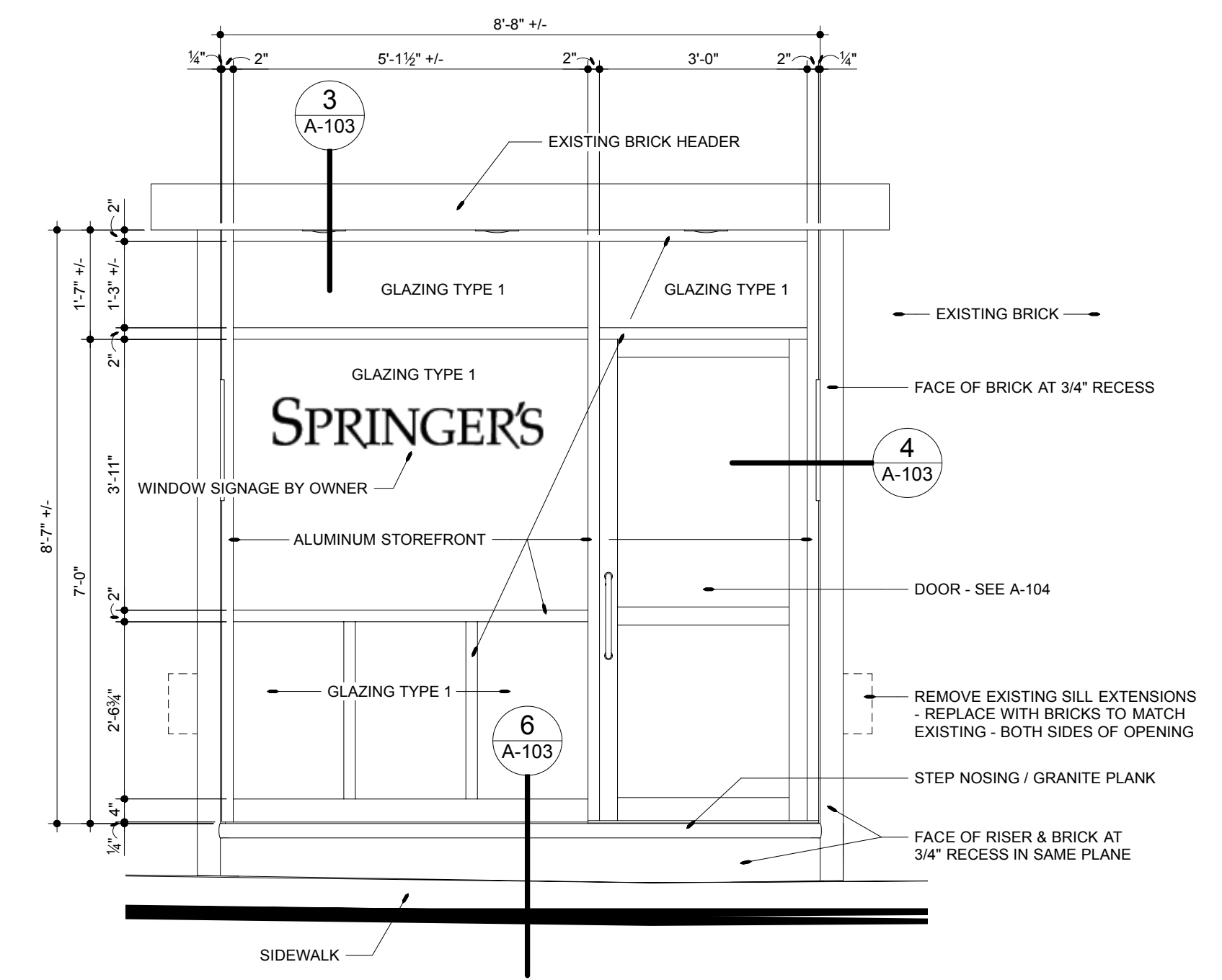

9 NEW ENTRANCE  
Scale: 1/2" = 1'-0"

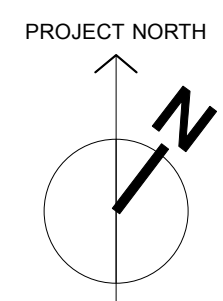

**LOBBY WALL CONSTRUCTION:**  
5/8" GWB  
2 x 6 STUDS @ 16" OC  
5 1/2" ROXUL INSULATION  
5/8" DENSGLASS SHEATHING  
AIR INFILTRATION BARRIER

2 x 4 BRACE - 48" OC MAX  
RECESSED LIGHT FIXTURE  
2'-0 1/2"  
VIF  
EXISTING MASONRY  
EXISTING BRICK HEADER  
FIELD VERIFY STRUCTURAL LINTEL  
REPLACE IF AS REQUIRED  
MUD-TYPE 'J' BEAD  
EXTERIOR 5/8" GWB - PAINTED  
4 1/2" STOREFRONT FRAMING  
5 1/2" 1 1/2"

**LOBBY WALL CONSTRUCTION:**  
5/8" GWB  
2 x 6 STUDS @ 16" OC  
5 1/2" ROXUL INSULATION  
5/8" DENSGLASS SHEATHING  
AIR INFILTRATION BARRIER

**BRICK VENEER WALL CONSTRUCTION:**  
5/8" GWB  
2 x 6 STUDS @ 16" OC  
5 1/2" ROXUL INSULATION  
5/8" DENSGLASS SHEATHING  
AIR INFILTRATION BARRIER  
BRICK TIES  
1 3/4" AIR SPACE  
BRICK VENEER - MATCH EXISTING

THRESHOLD @ DOOR  
4 1/2" STOREFRONT FRAMING  
5 1/2" 1 1/2"  
NOTE: BRICK VENEER WALL CONSTRUCTION TYPICAL BOTH SIDES OF ENTRANCE

EXTEND MEMBRANE UNDER STOREFRONT & DOOR THRESHOLD  
BACKER ROD & SEALANT  
GRANITE PLANKS SET WITH THINSET  
CONTINUOUS 60 MIL EPDM WATERPROOFING MEMBRANE  
BULLNOSE FIRST FLOOR 1000"  
2 x 6 T&G DECKING  
1 1/2" THICK GRANITE RISER  
EXTEND MEMBRANE OVER EXISTING MASONRY  
EXISTING BRICK SIDEWALK  
EXISTING SUBFLOOR  
ROXUL INSULATION  
EXISTING FLOOR JOIST  
STEEL JOIST HANGER  
2 x 12 JOISTS @ 12" OC (CUT)  
ROXUL SOUND ATTENUATION INSULATION  
ASSUMED MASONRY - VIF  
STONE FOUNDATION BEYOND  
REMOVE EXISTING HOPPER IF NECESSARY  
ELEVATOR MACHINE ROOM  
ASSUMED STONE FOUNDATION - VIF

8'-8" +/-  
1'-7" +/-  
1'-3" +/-  
2'-0"  
3'-11"  
7'-0"  
2'-0"  
1'-2" +/-  
1/2" +/-  
3  
A-103  
EXISTING BRICK HEADER  
GLAZING TYPE 1  
GLAZING TYPE 1  
EXISTING BRICK  
FACE OF BRICK AT 3/4" RECESS  
4  
A-103  
WINDOW SIGNAGE BY OWNER  
ALUMINUM STOREFRONT  
DOOR - SEE A-104  
REMOVE EXISTING SILL EXTENSIONS  
REPLACE WITH BRICKS TO MATCH EXISTING - BOTH SIDES OF OPENING  
STEP NOSING / GRANITE PLANK  
FACE OF RISER & BRICK AT 3/4" RECESS IN SAME PLANE  
SIDEWALK  
6  
A-103

brian e. duffy  
associates  
65 falmouth road  
falmouth, me. 04105  
tel: 207-773-9500

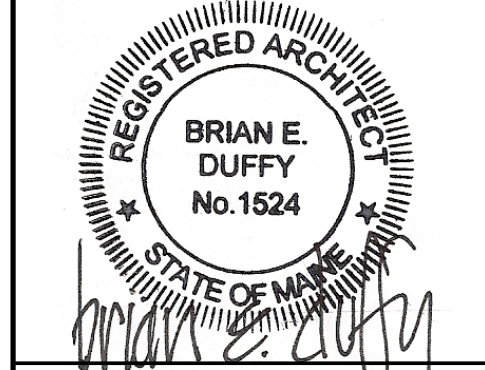

RENOVATIONS TO:  
**SPRINGER'S  
JEWELERS**  
580 CONGRESS STREET  
PORTLAND, MAINE

date: APRIL 27, 2012  
drawn by: WJT  
scale: AS NOTED  
sheet title:  
**DETAILS  
&  
RCPs**  
sheet:

**A-103**