

**1 3rd FLOOR EGRESS PLAN - 582 & 584**  
SCALE: 1/4" = 1'-0"

- 3rd FLOOR NOTES:**
1. THIS LEVEL IS RESIDENTIAL (R-2).
  2. THE BUILDING IS FULLY SPRINKLED WITH AN NFPA 13 SYSTEM.
  3. THE EXTERIOR WALLS OF UNIT A AND B ARE EXISTING MULTI-WYTHE SOLID MASONRY APPROX 8"-12" THICK. THEY ARE REQUIRED TO BE 2-HR PER IBC TABLE 601 (CONSTRUCTION TYPE 3B).
  4. THE PLAN WEST AND EAST ELEVATIONS ARE ON CONGRESS STREET AND FREE STREET AND HAVE A FIRE-SEPARATION DISTANCE GREATER THAN 30'.
  5. THE WALL BETWEEN UNIT A AND UNIT B IS A SOLID MULTI-WYTHE MASONRY WALL APPROX 8"-12" THICK AND EXCEEDS THE 1-HOUR REQUIRED TO SEPARATE RESIDENTIAL UNITS.
  6. THE ADJACENT BUILDINGS (PLAN NORTH AND PLAN SOUTH) ARE MERCANTILE USES.

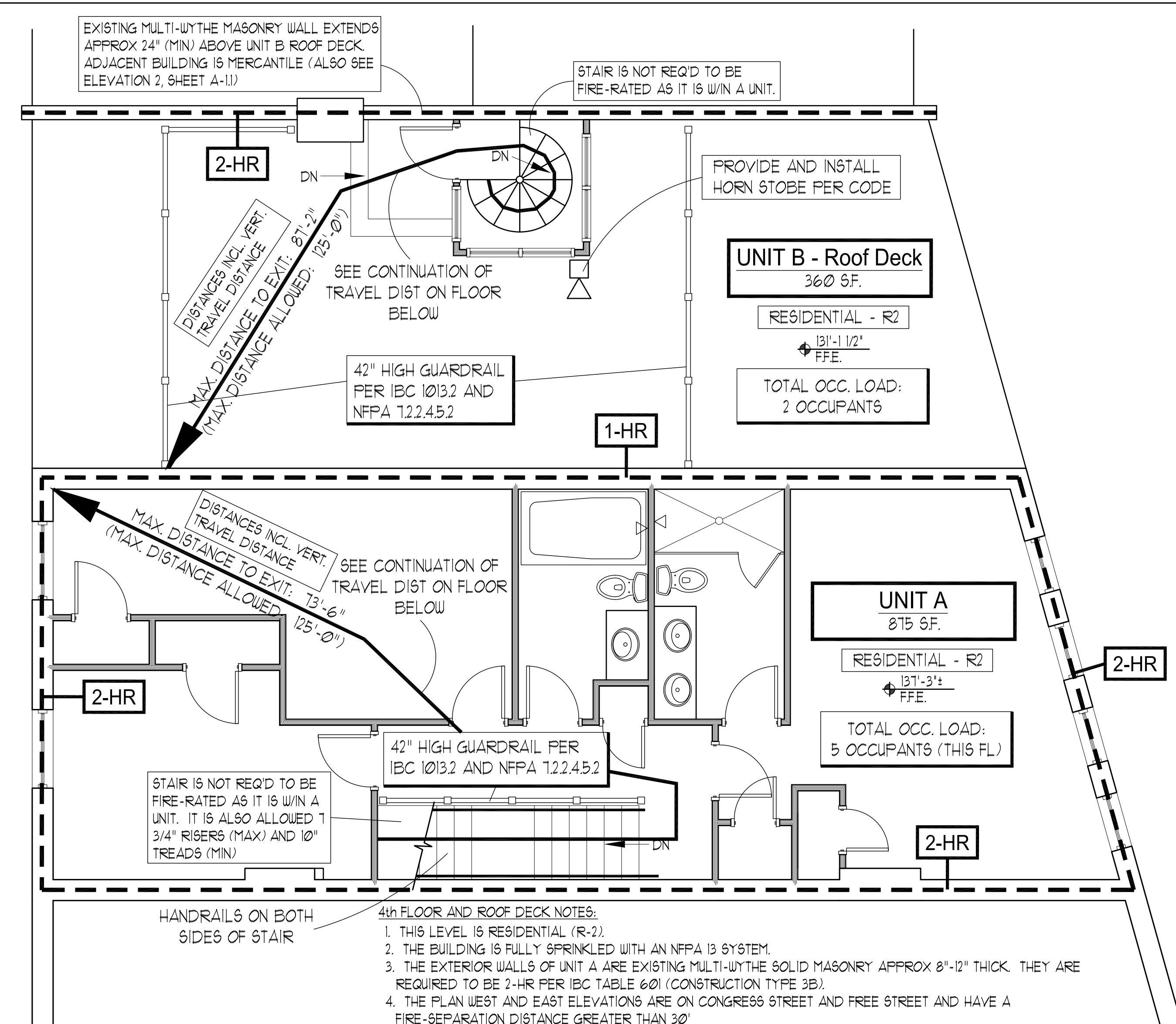

**2 4th FLOOR EGRESS PLAN - 582 & 584**  
SCALE: 1/4" = 1'-0"

- 4th FLOOR AND ROOF DECK NOTES:**
1. THIS LEVEL IS RESIDENTIAL (R-2).
  2. THE BUILDING IS FULLY SPRINKLED WITH AN NFPA 13 SYSTEM.
  3. THE EXTERIOR WALLS OF UNIT A ARE EXISTING MULTI-WYTHE SOLID MASONRY APPROX 8"-12" THICK. THEY ARE REQUIRED TO BE 2-HR PER IBC TABLE 601 (CONSTRUCTION TYPE 3B).
  4. THE PLAN WEST AND EAST ELEVATIONS ARE ON CONGRESS STREET AND FREE STREET AND HAVE A FIRE-SEPARATION DISTANCE GREATER THAN 30'.



65 NEWBURY STREET  
PORTLAND, ME 04101  
207.761.9000



**Consultants:**  
**Structural Integrity**  
Consulting Engineers, Inc.  
77 Oak Street  
Portland, ME 04101  
(207) 774-4614  
contact: Chris O'Hara  
chris@structuralinteg.com

**PERMIT SET**  
- NOT FOR CONSTRUCTION -

**CONGRESS STREET MIXED USE**

**582-584**  
Congress Street  
Portland, Maine

#	DATE	DESCRIPTION
1	10/6/11	REVIEW DWG
1	10/23/11	PERMIT SET

Date Issued: October 23, 2011  
Project Number: 15102  
Drawing Scale: As Noted

**EGRESS / LIFE SAFETY PLANS**

Drawn By: MC  
Checked By: ACH  
**LS-1.2**