

12/17/2013 5:41:06 PM N:\Starbucks\Starbucks Northeast\ME\STRN00127\_7433\_Hay Building, ME\05\_Implementation\Revit\7433 Hay Building\_ME\_OTP.rvt

### Wall Type Legend

- 1 EXISTING WALL
- 3 NEW PARTITION WALL TO 6" (152MM) ABOVE CEILING  
20 GA 3-5/8" (86 MM) METAL STUDS 16" (406MM) O.C. WITH 5/8" (16 MM) TYPE "X" GWB ON ONE OR BOTH SIDES TO MINIMUM OF 6" (152 MM) ABOVE CEILING GRID. DRYWALL SCREWS @ 12" (305 MM) O.C. 45 DEGREES. METAL STUD REINFORCEMENT @ 48" (1219 MM) O.C. ABOVE CEILING LINE TO STRUCTURE ABOVE. - MATCH EXISTING WALL THICKNESS, VERIFY IN FIELD.
- 5 NEW FURRED WALL TO 6" (152 MM) ABOVE CEILING  
20 GA 3-5/8" (86 MM) METAL STUDS 16" (406 MM) O.C. WITH 5/8" (16 MM) TYPE "X" GWB TO MINIMUM OF 6" (152MM) ABOVE CEILING GRID. DRYWALL SCREWS @ 12" (305 MM) O.C., 45 DEGREE METAL STUD REINFORCEMENT @ 48" (1219 MM) O.C. ABOVE CEILING LINE TO STRUCTURE ABOVE.

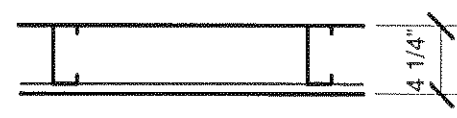

### WALL BLOCKING KEY

| SYMBOL | ITEM                                      | WEIGHT  | HEIGHT           | APPROXIMATE WIDTH                |
|--------|---|---------|------------------|----------------------------------|
| 1      | Hand Dryer                                | 350 LBS | 2'-11" to 3'-11" | 2'-10" Behind Hand Dryer         |
| 2      | Restroom Grab Bars                        | 250 LBS | 3'-0" to 5'-2"   | 12" Behind Grab Bar              |
| 3      | Upper Storage (Cubby) Cabinets at Backbar | 300 LBS | 6'-1" to 7'-10"  | Extent of Backbar Upper Casework |

Provide fire retardant 2x6 or 2x8 wood stud blocking as required to support any wall attachments

### FLOOR PLAN NOTES

- A. GENERAL CONTRACTOR TO VERIFY ALL DIMENSIONS AND NOTIFY STARBUCKS CONSTRUCTION MANAGER OF ANY DISCREPANCIES PRIOR TO CONSTRUCTION. ALL DIMENSIONS TO BE TAKEN FROM DESIGNATED DATUM POINT.
- B. IF EXISTING EXTERIOR ENTRANCE THRESHOLD EXCEEDS REQUIRED AMERICAN'S WITH DISABILITY ACT (ADA) MAXIMUM HEIGHT OF THE FOLLOWING: 1/4" STEP, 1/2" BEVEL, OR COMBINATION OF 1/4" STEP AND 1/4" BEVEL, REMOVE AND REPLACE WITH ACCESSIBLE THRESHOLD. RAISED THRESHOLDS AND FLOOR LEVEL CHANGES AT ACCESSIBLE DOORWAYS TO BE BEVELED WITH A SLOPE NO GREATER THAN 1:12.
- C. GENERAL CONTRACTOR TO PROVIDE FIRE TREATED WOOD STUD BLOCKING, OR EQUIVALENT TO SUPPORT ANY WALL ATTACHMENT AND/OR SIGNAGE.
- D. ALL DOORS TO PROVIDE 32" (800MM) MINIMUM CLEAR OPENING WHEN OPENED TO 90 DEGREE POSITION UNLESS OTHERWISE NOTED.
- E. VERIFY ALL EXISTING DOORS, HARDWARE AND FRAMES MEET STARBUCKS AND/OR CODE REQUIREMENTS.
- F. INSTALL 1/4" (6MM) GREEN BOARD ON BACKBAR WALL PER SPECIFICATION.

### SHEET NOTES

- 1. ALIGN FINISHED FACE OF WALL TO EXISTING FINISH.
- 2. GC TO FIELD VERIFY EXISTING COLUMN LOCATIONS PRIOR TO CONSTRUCTION. NOTIFY AOR IF EXISTING LOCATIONS DO NOT COORDINATE WITH DRAWINGS.
- 3. INSTALL NEW RESERVE DOOR PULL IN PLACE OF EXISTING DOOR PULL.

| DOOR SCHEDULE - "D" |       |  |          |                   |        |                |            |                |       |  |
|---------------------|-------|--|----------|-------------------|--------|----------------|------------|----------------|-------|--|
| DESIGN ID           | COUNT | DESCRIPTION  | Type     | Construction Type | Finish | Hardware Group | Frame Type | Frame Material | RESP. | COMMENTS   |
| DOOR                |       |  |          |                   |        |                |            |                |       |  |
| 13688               | 1     | DOOR - STOREFRONT RESERVE PULL NARROW FRAME SINGLE | Standard | NA                | MT0011 | NA             | NA         | NA             | VD    | BFC Architectural Metals, Inc. Contact www.bfcmetals.com. Finish: MT0011. Refer to Exterior Elevations for location and tag. |

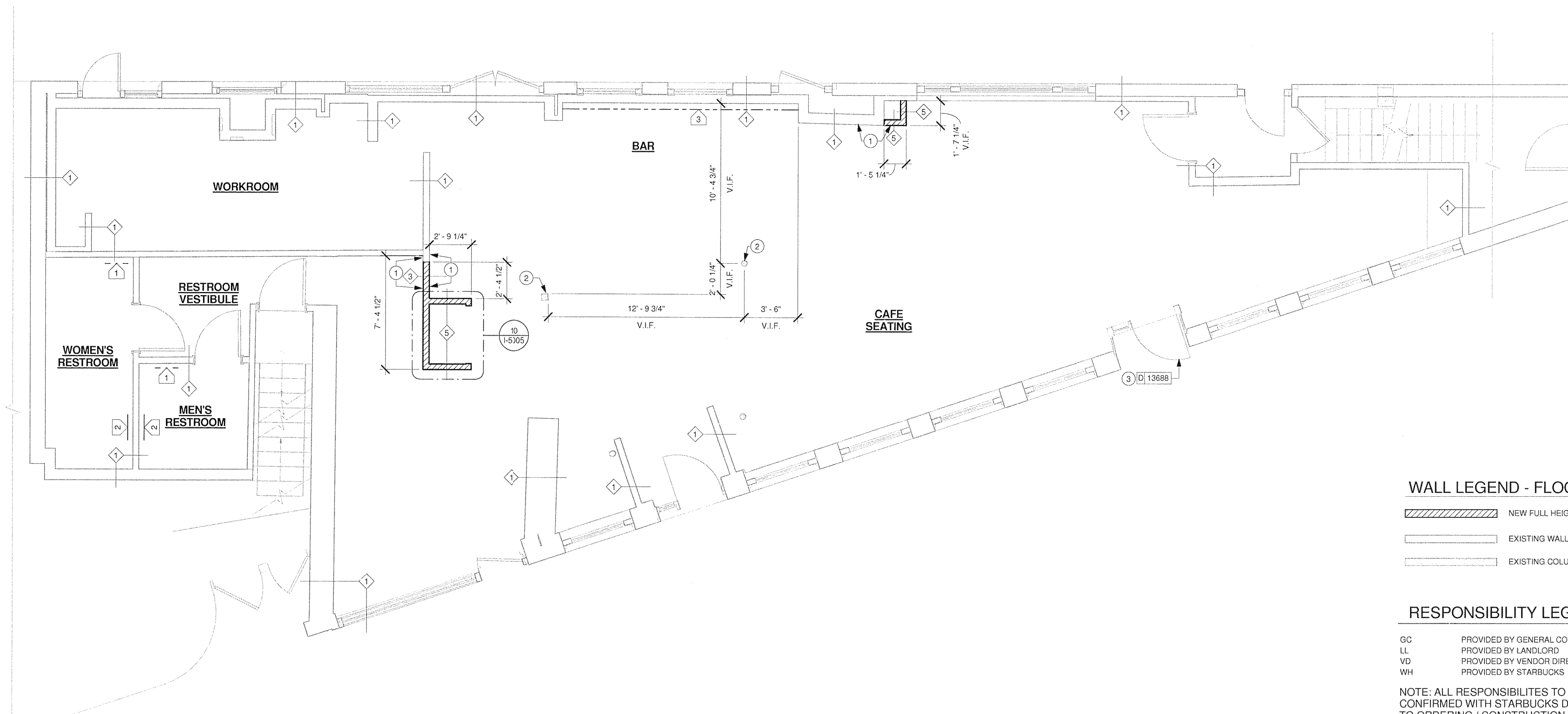

### WALL LEGEND - FLOOR PLAN

- NEW FULL HEIGHT WALL
- EXISTING WALL
- EXISTING COLUMN

### RESPONSIBILITY LEGEND

- GC PROVIDED BY GENERAL CONTRACTOR
- LL PROVIDED BY LANDLORD
- VD PROVIDED BY VENDOR DIRECT
- WH PROVIDED BY STARBUCKS

NOTE: ALL RESPONSIBILITIES TO BE CONFIRMED WITH STARBUCKS DM PRIOR TO ORDERING / CONSTRUCTION

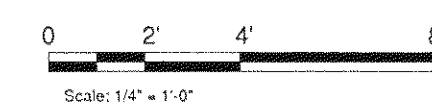

FULL REMODEL

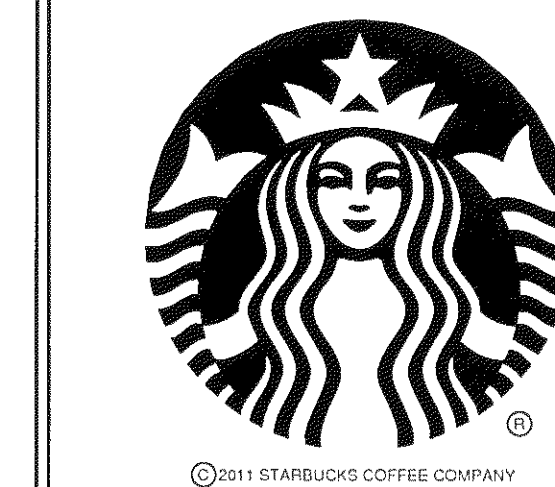

**STARBUCKS COFFEE COMPANY**  
2401 UTAH AVENUE SOUTH  
SEATTLE, WASHINGTON 98134  
(206) 318-1575

THESE DRAWINGS AND SPECIFICATIONS ARE CONFIDENTIAL AND SHALL REMAIN THE SOLE PROPERTY OF STARBUCKS CORPORATION, WHICH IS THE OWNER OF THE COPYRIGHT IN THIS WORK. THEY SHALL NOT BE REPRODUCED (IN WHOLE OR IN PART), SHARED WITH THIRD PARTIES OR USED IN ANY MANNER ON OTHER PROJECTS OR EXTENSIONS TO THIS PROJECT WITHOUT THE PRIOR WRITTEN CONSENT OF STARBUCKS CORPORATION.

| Revision Schedule |      |    |             |
|-------------------|------|----|-------------|
| Rev               | Date | By | Description |
|                   |      |    |             |
|                   |      |    |             |
|                   |      |    |             |

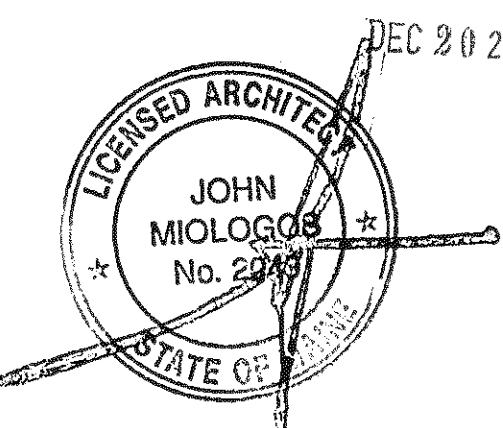

PROJECT NAME: **HAY BUILDING**  
PROJECT ADDRESS: **594 CONGRESS STREET  
PORTLAND, ME 04101**  
COUNTY: **CUMBERLAND**

STORE #: 7433  
PROJECT #: 04704-026  
CONCEPT: NCS  
PALETTE: REGIONAL MODERN  
ISSUE DATE: 12-16-2013  
DESIGN MANAGER: ETA KLIGER  
LEED® AP: N/A  
PRODUCTION DESIGNER: J.NEAL  
CHECKED BY: T. REISING

SHEET TITLE: **FLOOR PLAN**

SCALE: As indicated

SHEET NUMBER: **I-1103**

1 FLOOR PLAN  
Scale: 1/4" = 1'-0"