

LIGHTING FIXTURE SCHEDULE - "L"					
DESIGN ID	COUNT	DESCRIPTION	RESP.	BULB	COMMENTS
LAMP					
12871	4	CFL BIAx 10-19W	VD		
12903	8	LED PAR 30S 10-19W NFL	VD		
12905	2	LED PAR 20 1-9W NFL - BLACK	VD		
13257	2	LED PAR 30S 10-19W FLOOD	VD		
OTHER					
X0101	22	SURFACE MOUNTED DECORATIVE PENDANT	GC		MFG: REJUVENATION LIGHTING. LOMBARD, ITEM #A2221, FINISH: OIL RUBBED BRONZE WITH SCHOOLHOUSE SHADE. WWW.REJUVENATION.COM
PENDANT					
12392	1	PENDANT - LARGE QUONSET - BLACKENED STEEL MT0019	GC	(2) 12887 - FL T5 20-29W 34IN (850MM)	
X0102	10	PENDANT - ROPE AND CLEAR CYLINDER GLASS	GC	25W Edison Incandescent (DID#13190)	MFG: SHADES OF LIGHT, ROPE AND CLEAR CYLINDER GLASS PENDANT LIGHT. SKU: PE13079BZ WWW.SHADESOFLIGHT.COM
X0103	12	Pendant - Schoolhouse Electric - Azusa w/ shade CL-1039-09-2.25	GC	25W Edison Incandescent (DID#13190)	Azusa Pendant (sku252.0039 2GAL), round housing, 16" fixture length with Lamp shade CL-1039-09-2.25 (sku 252.1039.9CL), http://www.schoolhouseelectric.com/
RECESSED CAN					
12561	4	CAN - RECESSED HOUSING - 5IN 125MM - EXISTING CEILING	VD	(1) 12871 - CFL BIAx 1019W	
12562	2	CAN - RECESSED HOUSING ADJUSTABLE - 5IN 125MM - EXISTING CEILING	VD	(1) 13257 - LED PAR 30S 10-19W FLOOD	
12620	2	CAN - RECESSED HOUSING ADJUSTABLE - 4IN 100MM - EXISTING CEILING	VD	(1) 12905 - LED PAR 201-9W NARROW FLOOD	
13241	2	CAN - RECESSED TRIM ADJUSTABLE GIMBAL RING - 4IN 100MM - WHITE	VD		PAINT TO MATCH ADJACENT CEILING FINISH
13242	2	CAN - RECESSED TRIM ADJUSTABLE GIMBAL RING - 5IN 125MM - WHITE	VD		PAINT TO MATCH ADJACENT CEILING FINISH
13244	4	CAN - RECESSED TRIM REFLECTOR - 5IN 125MM - WHITE	VD		PAINT TO MATCH ADJACENT CEILING FINISH
SCONCE					
X0105	10	EXTERIOR SCONCE - GOOSENECK		LED PAR 16 50W MAX	MFR:MFR: SIGN BRACKET STORE. GOOSENECK LIGHT ALUMINUM - .375" W ARM WITH 7IN ANGLE SHADE. CODE: SL-AD12-ANG3607. WWW.SIGNBRACKETSTORE.COM 1-888-919-7446
STRIP					
12552	8	TASK LIGHT INTEGRATED LED - 22IN 560MM - BLACK	VD	(6) INTEGRAL LED 1W	JUMPER CORD REQUIRED WHEN CONNECTING MULTIPLE UNITS
TRACK					
11521	8	TRACK - FIXTURE ENCLOSED - 5IN 125MM - BLACK	VD	(1) 12903 - LED PAR 30S 10-19W NARROW FLOOD	
12946	1	TRACK - WITH CONNECTORS - 4FT 122CM - BLACK	VD		

SIGNAGE SCHEDULE - "S"				
DESIGN ID	COUNT	DESCRIPTION	RESP.	COMMENTS
SIGNAGE - DISK				
X0601	2	SIGN - DISK BLADE DF NON ILLUMINATED WITH BRACKET WALL MOUNTED EVOLVED - 30IN 760MM	VD	NONILLUMINATED BLADE SIGN WITH INTEGRATED GOOSENECK LIGHTING. MFR: SIGN BRACKET STORE. 30" TOP/IN ILLUMINATA SIGN BRACKET KIT. CODE: 370B-WL-30-LKIT WITH GOOSENECK 7" SHADE. WWW.SIGNBRACKETSTORE.COM 1-888-919-7446 FOR DESIGN INTENT ONLY. COORDINATE WITH STARBUCKS DESIGN MANAGER PRIOR TO ORDERING/FABRICATION.

Lighting Plan Notes

- Provide grommet at all ceiling penetrations for fixtures/supports.
- Lighting fixtures in Acoustical Ceiling Tile to be centered in tile, unless otherwise noted.
- Fixtures to be located at predetermined locations in casework.
- Adjust focus of all track and recessed directional lighting to fully illuminate all artwork, menu boards, and merchandise bays.
- Hand-off pendant to be centered over hand-off plane at barista.
- Surface-mount track directly to soffit.
- Suspend track, refer to architectural elevations.
- Undercabinet fluorescent task lighting to be circuited so that 100% of lights are "N.L." & the other 100% are on a wall switch located at the switchbank. Stagger switch lights.
- Refer to lighting fixture schedule on sheet for fixture quantities, lamp information and wattage.

Sheet Notes

- New Recessed lighting to be connected to existing circuit from removed fixture. Maintain existing controls.
- New Pendant lights shall be connected to existing local pendant lighting circuit. Maintain existing controls.
- New Exterior sconce lighting to be connected to existing circuit from removed fixture. Maintain existing controls.
- New chandelier lights shall be powered by local lighting circuit. Maintain existing controls.
- New Track lighting to be connected to existing circuit from removed fixture. Maintain existing controls.
- Weather proof junction box for sign. Mount junction box behind sign. Coordinate exact mounting requirements and location with sign supplier. Utilize existing circuit serving signage, extend as necessary.
- Circuit servicing this device shall be controlled by time clock. Time clock shall be located adjacent to manager workstation. Furnish and install all conduit, wire connections, contactors and time clock modules necessary to insure a functional time clock system.
- Sign shall have externally operable switch or circuit breaker installed at sign. Contractor shall provide disconnect per code if manufacturer sign does not include switch. Verify exact requirements with sign vendor prior to bid.
- Location of switching.
- New undercabinet LED tape lights shall be connected to the existing local lighting circuit. Maintain existing control.
- Relocated recessed lighting to be connected to existing circuit from removed fixture. Maintain existing controls.
- Relocated Track lighting to be connected to existing circuit from removed fixture. Maintain existing controls.
- New Track head on existing track lighting to be connected to existing circuit from removed fixture. Maintain existing controls.



STARBUCKS COFFEE COMPANY
2401 UTAH AVENUE SOUTH
SEATTLE, WASHINGTON 98134
(206) 318-1575

THESE DRAWINGS AND SPECIFICATIONS ARE CONFIDENTIAL AND SHALL REMAIN THE SOLE PROPERTY OF STARBUCKS CORPORATION, WHICH IS THE OWNER OF THE COPYRIGHT IN THIS WORK. THEY SHALL NOT BE REPRODUCED (IN WHOLE OR IN PART), SHARED WITH THIRD PARTIES OR USED IN ANY MANNER ON OTHER PROJECTS OR EXTENSIONS TO THIS PROJECT WITHOUT THE PRIOR WRITTEN CONSENT OF STARBUCKS CORPORATION.

ENGINEER OF RECORD

Revision Schedule			
Rev	Date	By	Description

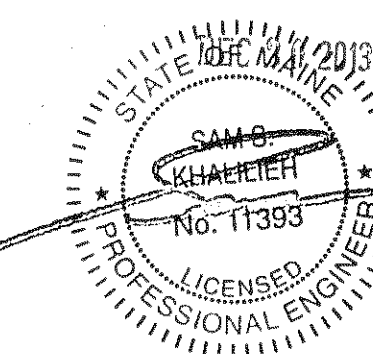

PROJECT NAME: **HAY BUILDING**
PROJECT ADDRESS: **594 CONGRESS STREET
PORTLAND, ME 04101**

STORE #: 7433
PROJECT #: 04704-026
CONCEPT: NCS
PALETTE: REGIONAL MODERN
ISSUE DATE: 12-16-2013
DESIGN MANAGER: ETA KLIGER
LEED® AP: N/A
PRODUCTION DESIGNER: SANKET J.
CHECKED BY: HUSSEIN B.

SHEET TITLE: **LIGHTING DESIGN**

SCALE: As indicated

SHEET NUMBER: **E-1103**

FULL REMODEL

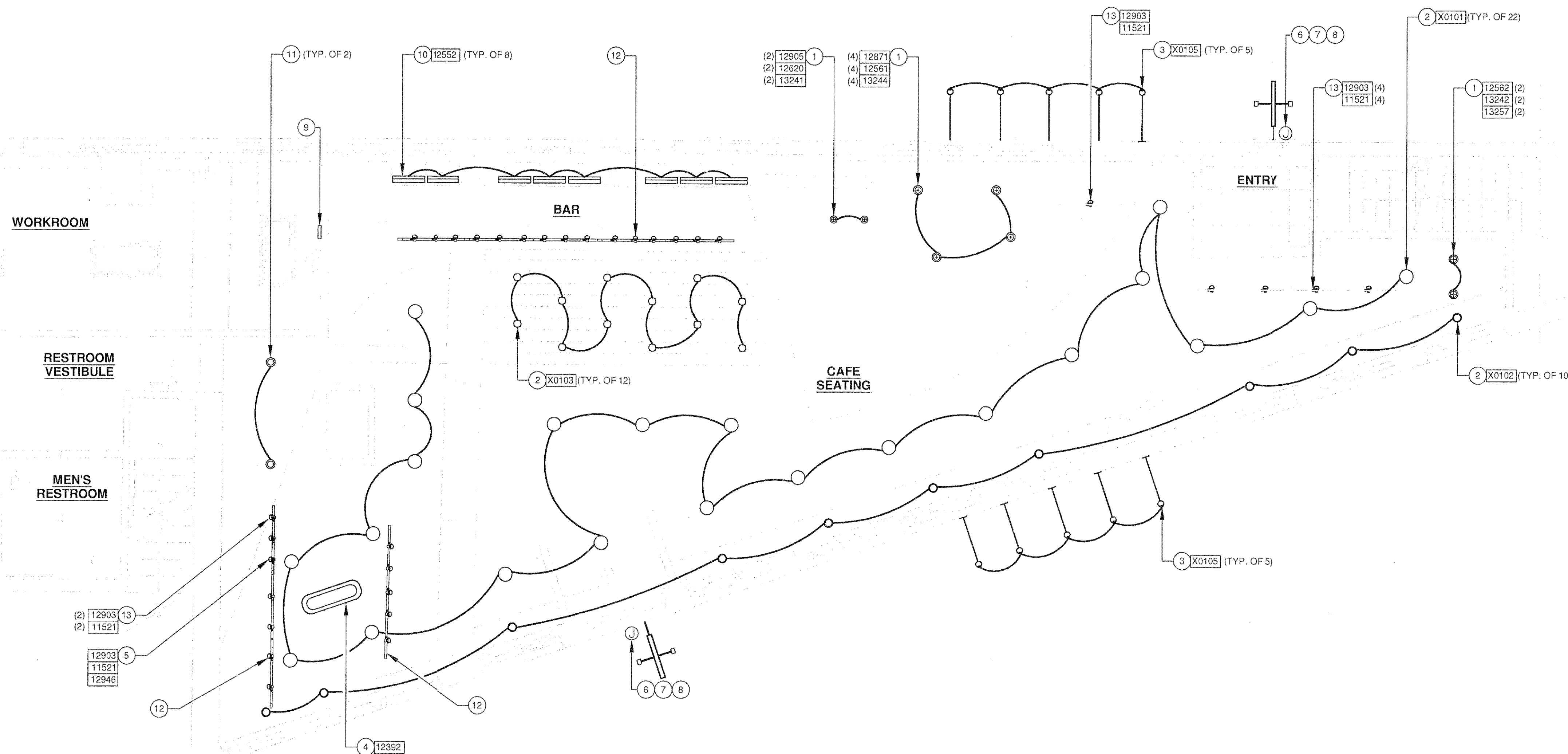

1 LIGHTING DESIGN PLAN

Scale: 1/4" = 1'-0"