

12/17/2013 5:41:28 PM N:\Starbucks\Starbucks Northeast\W\ESTRNM0127_7433_Hay Building, ME\05_implementation\Revit\7433_Hay Building ME_OTP.rvt

SHEET NOTES

1. LOCATION OF EXISTING SWITCHING.
2. RELOCATED NEWSPAPER STAND.
3. RELOCATED COFFEE BREWER.
4. RELOCATED SHUTTLES & WARMERS.
5. RELOCATED GRINDER.
6. RELOCATED SCALE.
7. RELOCATED PASTRY CASE.
8. RELOCATED ESPRESSO MACHINES (2)
9. RELOCATED 1-DOOR UC FRIDGE.
10. RELOCATED 1-DOOR UC FRIDGE WITH SHELF.
11. RELOCATED WARMING OVEN.
12. RELOCATED FIRE EXTINGUISHER.
13. RELOCATED MERCH BASKETS (4), FEATURE CUBES (3) AND SMALLWARE ITEMS.
14. RELOCATED METRO SHELF.
15. RELOCATED BLENDERS (2)
16. RELOCATED 2-DOOR UC FRIDGE.
17. RELOCATED POS & ASSOCIATED EQUIPMENT.
RELOCATED EXISTING POS EQUIPMENT. STARBUCKS CONTRACTS DIRECTLY WITH DATA CABLING VENDOR TO SUPPLY, INSTALL OR RELOCATE CAT 5 LAN CABELING FOR THEIR POS SYSTEMS. CONTRACTOR MUST SCHEDULE THROUGH THE STARBUCKS RENOVATION CONSTRUCTION MANAGER A MINIMUM OF TWO WEEKS PRIOR TO NEED.
TO CONTACT AN INFORMATION TECHNOLOGY VENDOR REGARDING DATA CABELING, VOICE & NETWORK CIRCUITS, IT RACK AND/OR TURNING EQUIPMENT OFF FOR RELOCATION OR PAINTING, CONTACT VIA EMAIL: NEWSTORE@STARBUCKS.COM
18. RELOCATE EXISTING HAND SINK AND ASSOCIATED ITEMS AS INDICATED TO PROVIDE ADEQUATE CLEAR FLOOR SPACE. VERIFY DIMENSIONS AND EXISTING CONDITIONS IN FIELD.
19. CUSTOM TASTING TABLE. REFER TO CASEWORK PLAN AND SCHEDULE.
20. CUSTOM COMMUNITY TABLE TOP. REFER TO CASEWORK PLAN AND SCHEDULE.

FF AND E PLAN NOTES

- A. GENERAL CONTRACTOR TO SCHEDULE WITH LOCAL REFRIGERATION CONTRACTOR TO CONDUCT INITIAL FOOD CASE START-UP AND TESTING. FOR APPROVED CONTRACTOR, CONTACT VENDOR.
- B. THE SPACE IS SERVED BY THE MUNICIPAL WATER AND SEWER SYSTEM UNLESS OTHERWISE NOTED.
- C. ALL EQUIPMENT AND INSTALLATION WILL MEET NATIONAL SANITATION FOUNDATION STANDARDS OR EQUIVALENT.
- D. EQUIPMENT UNITS SHALL CONTAIN NO EXPOSED THREADS, EMBELLISHMENTS OR OVERHANGING EDGES THAT SERVE AS PLACES FOR ACCUMULATION OF DUST, DIRT AND DEBRIS.
- E. WARMING OVEN(S) SHOWN FOR PERMITTING PURPOSES. INSTALLATION AT STORE OPENING TO BE VERIFIED BY STARBUCKS CONSTRUCTION REPRESENTATIVE.
- F. EACH HAND WASHING SINK WILL HAVE A SINGLE SERVICE TOWEL AND SOAP DISPENSER, AND ALL HAND SINKS TO HAVE A COMBINATION FAUCET OR PREMIXING FAUCET.
- G. FOR PLUMBING FIXTURES, REFER TO THE PLUMBING DESIGN PLAN. FOR DATA DEVICE SCHEDULE, REFER TO THE ELECTRICAL DESIGN PLAN



©2011 STARBUCKS COFFEE COMPANY

STARBUCKS COFFEE COMPANY

2401 UTAH AVENUE SOUTH
SEATTLE, WASHINGTON 98134
(206) 318-1575

THESE DRAWINGS AND SPECIFICATIONS ARE CONFIDENTIAL AND SHALL REMAIN THE SOLE PROPERTY OF STARBUCKS CORPORATION, WHICH IS THE OWNER OF THE COPYRIGHT IN THIS WORK. THEY SHALL NOT BE REPRODUCED (IN WHOLE OR IN PART), SHARED WITH THIRD PARTIES OR USED IN ANY MANNER ON OTHER PROJECTS OR EXTENSIONS TO THIS PROJECT WITHOUT THE PRIOR WRITTEN CONSENT OF STARBUCKS CORPORATION.

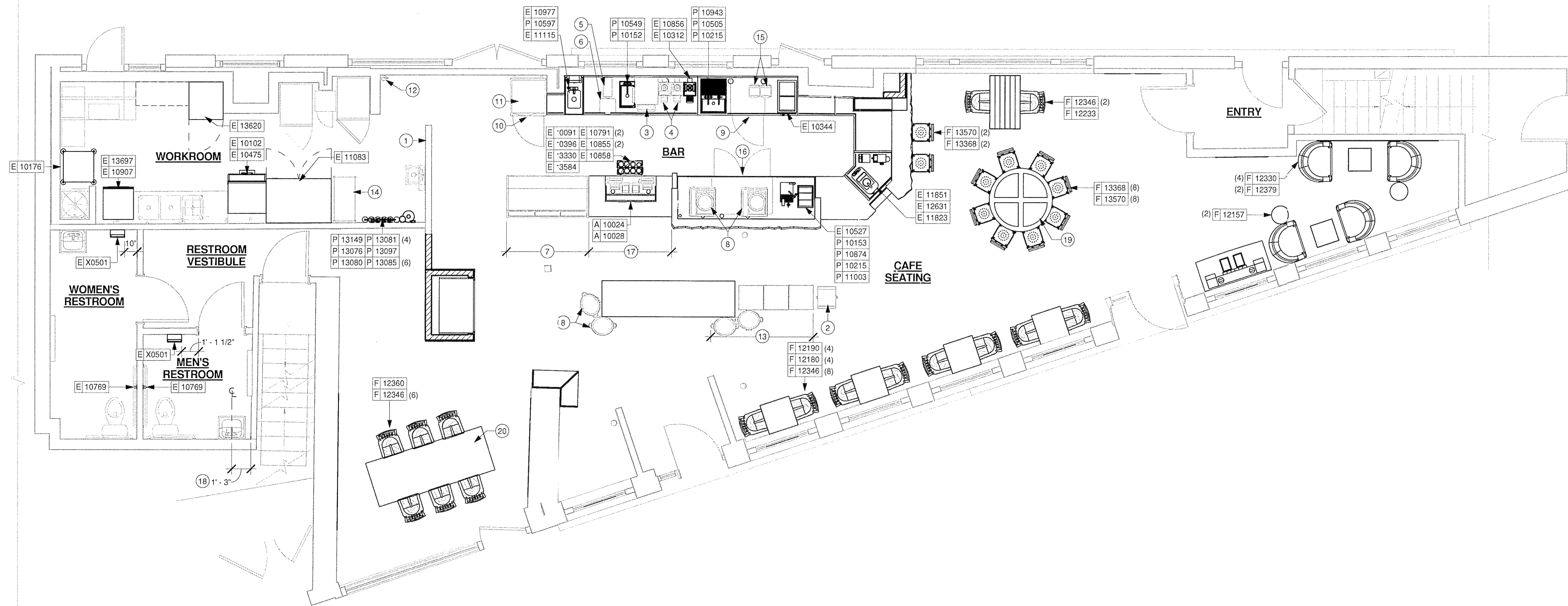

FULL REMODEL

Revision Schedule			
Rev	Date	By	Description

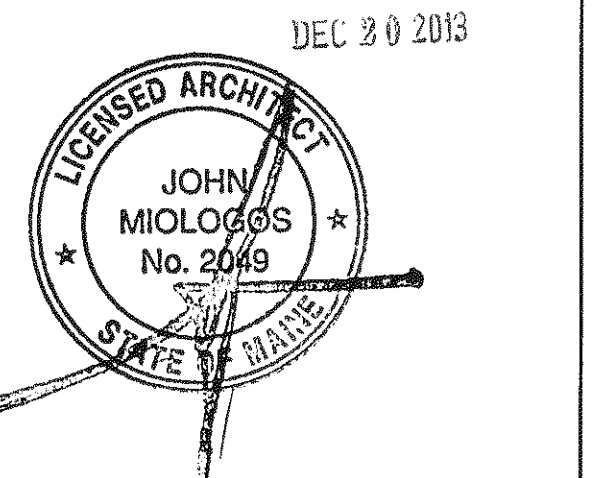

PROJECT NAME: **HAY BUILDING**
PROJECT ADDRESS: **594 CONGRESS STREET
PORTLAND, ME 04101**
COUNTY: **CUMBERLAND**

STORE #: 7433
PROJECT #: 04704-026
CONCEPT: NCS
PALETTE: REGIONAL MODERN
ISSUE DATE: 12-16-2013
DESIGN MANAGER: ETA KLIGER
LEED® AP: N/A
PRODUCTION DESIGNER: J. NEAL
CHECKED BY: T. REISING

SHEET TITLE: **FF AND E PLAN**

SCALE: 1/4" = 1'-0"

SHEET NUMBER: **I-1105**

1 FURNITURE, FIXTURES, AND EQUIPMENT PLAN

Scale: 1/4" = 1'-0"

