



© 1997 STARBUCKS CORPORATION

STARBUCKS COFFEE COMPANY
2401 UTAH AVENUE SOUTH
SEATTLE, WASHINGTON 98134
(206) 447-1575

THESE PLANS AND SPECIFICATIONS, AS WELL AS STARBUCKS NAME AND LOGO, TRADEMARKS AND DESIGN, ARE THE EXCLUSIVE PROPERTY OF STARBUCKS CORPORATION. ANY REPRODUCTION, MODIFICATION, DISCLOSURE, AND/OR USE OF THESE MATERIALS FOR ANY PORTION OF THEM WITHOUT STARBUCKS' PRIOR WRITTEN CONSENT IS STRICTLY PROHIBITED.

CONSULTANTS

DATE: 10/14/03
F.M. *[Signature]*
R.C.M. *[Signature]*
DESIGN *Wendy Sorensen*
OPS *Wendy Sorensen*

REV DATE

7433

STARBUCKS COFFEE

HAY BUILDING

594 CONGRESS STREET
PORTLAND, MAINE 04101

COUNTY: CUMBERLAND COUNTY

PROJECT NO. 470401
CONCEPT: AB GROW
ISSUE DATE: 11/4/99
PM: DRU SHARPBACK
JC: MARCUS LINTAULT
CHECKED: C. M. CHKD: STEPHEN DELROSE

SCALE: 1/4" = 1'-0"
(DO NOT SCALE DRAWINGS)

SHEET TITLE

COMPOSITE PLAN

PROJECT CODE: 470401

ANY COLUMNS TO REMAIN

ANY COLUMNS TO REMAIN
Approx 10' long

Typical Throughout: (1) (2) (8) (13) (28) (35)

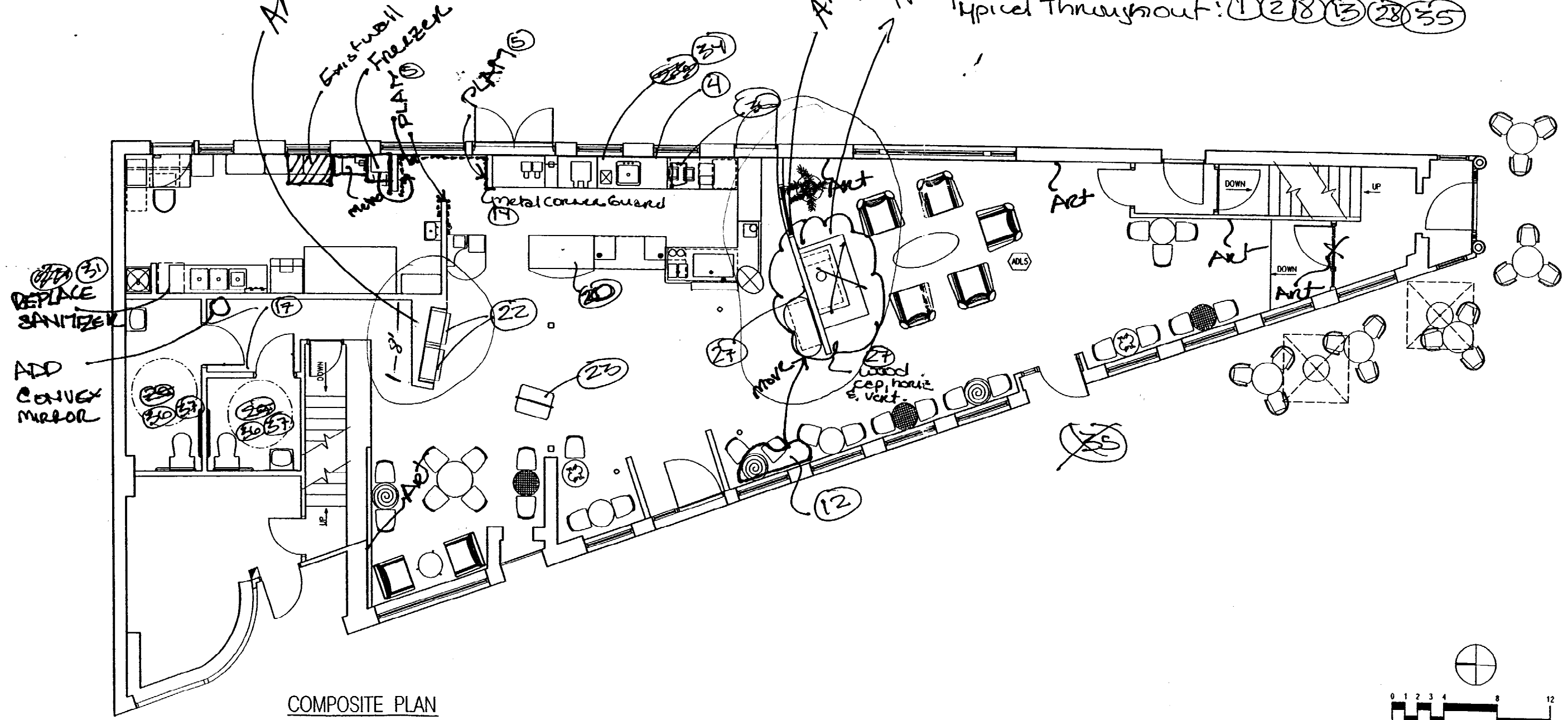

COMPOSITE PLAN

