

PRELIMINARY NOT
FOR CONSTRUCTION

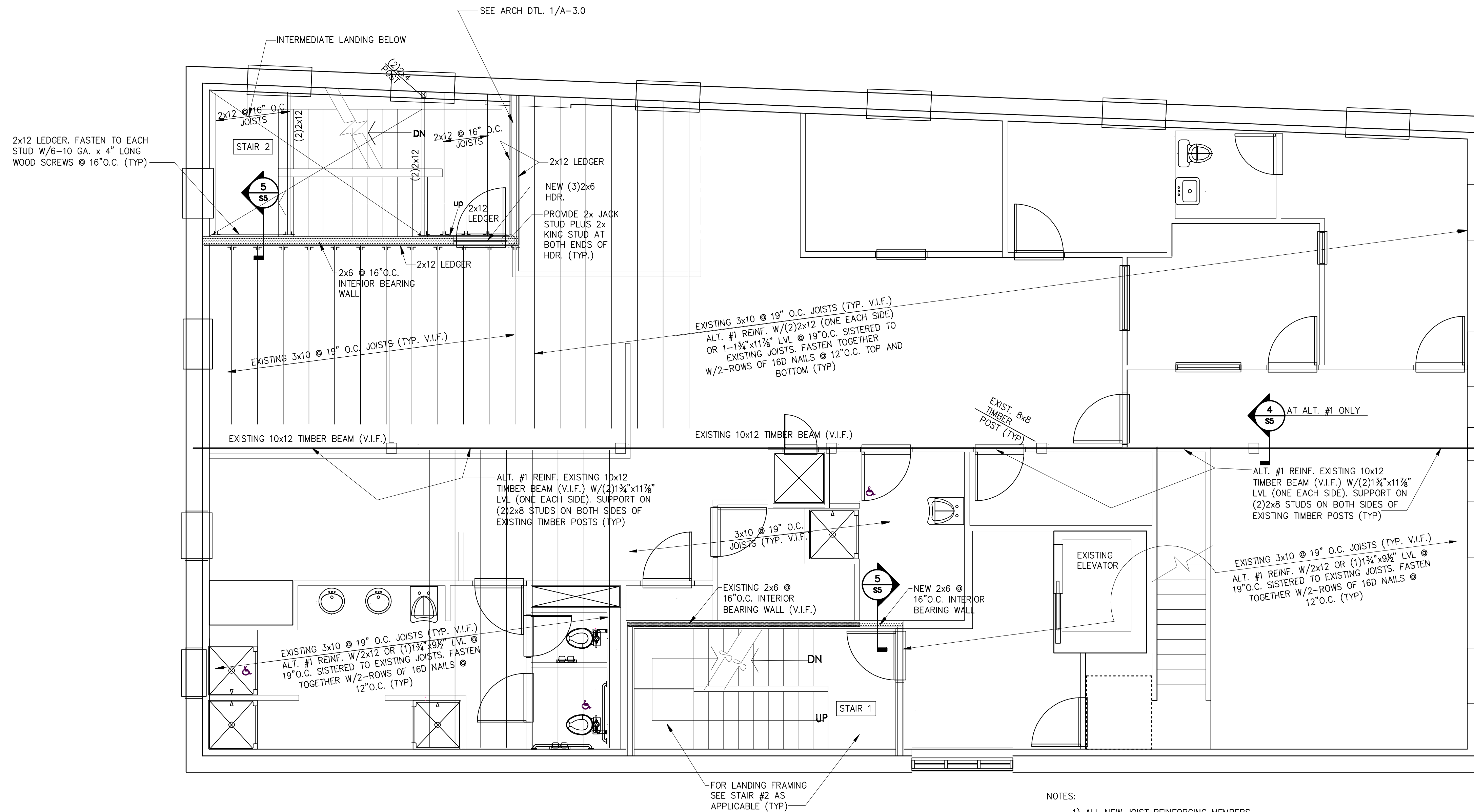

PARTIAL THIRD FLOOR FRAMING PLAN
1/4" = 1'-0"

- NOTES:
- 1) ALL NEW JOIST REINFORCING MEMBERS SHALL BEAR 2" MIN. ON THE EXISTING SUPPORT WALLS/BEAMS AT BOTH ENDS (TYP)
 - 2) ALTERNATE #1 TO REINFORCE EXISTING FLOOR TO SUPPORT FUTURE OFFICE LOADING.

**L & L STRUCTURAL
ENGINEERING SERVICES, INC.**
SIX O. STREET
SOUTH PORTLAND, MAINE 04106
PHONE: (207) 767-4830
FAX: (207) 799-5432

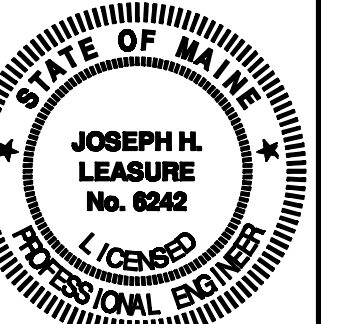

rev.	date	description	designed by	checked by	scale	date	plot date	project #
A	3-20-12	FOR REVIEW & PRICING	JHL	JHL				
B	4-4-12	FOR REVIEW & PRICING	JHL	JHL				

38 PREBLE STREET TEEN SHELTER
PORTLAND, MAINE

PARTIAL THIRD FLOOR FRAMING PLAN

S3

THESE DRAWINGS HAVE BEEN DEVELOPED BY L&L STRUCTURAL ENGINEERING SERVICES, INC. FOR THE TITLED SET ONLY. THE DRAWINGS ARE THE SOLE PROPERTY OF L&L ENGINEERING SERVICES, INC. AND THEY SHALL NOT BE USED, LENT, COPIED OR ALTERED WITHOUT THE WRITTEN CONSENT OF L&L STRUCTURAL ENGINEERING SERVICES, INC.