

# DISPLAY THIS CARD ON PRINCIPAL FRONTAGE OF WORK CITY OF PORTLAND

Please Read Application And Notes, If Any, Attached

BUILDING DEPARTMENT

Permit Number: 071502

PERMIT ISSUED  
MAR - 7 2008  
CITY OF PORTLAND

This is to certify that MHS INC /Portland Color

has permission to (2) two 8' x 18' signs

AT 489 CONGRESS ST

037 F01700

provided that the person or persons, firm or corporation accepting this permit shall comply with all of the provisions of the Statutes of Maine and of the ordinances of the City of Portland regulating the construction, maintenance and use of buildings and structures, and of the application on file in this department.

Apply to Public Works for street line and grade if nature of work requires such information.

Notification of inspection must be given and work on permit on procedure before this building or part thereof is altered or closed-in. 24 HOUR NOTICE IS REQUIRED.

A certificate of occupancy must be procured by owner before this building or part thereof is occupied.

**OTHER REQUIRED APPROVALS**

Fire Dept. \_\_\_\_\_  
Health Dept. \_\_\_\_\_  
Appeal Board \_\_\_\_\_  
Other \_\_\_\_\_  
Department Name \_\_\_\_\_

*Thomas M. Mearns* 3/7/08  
Director - Building & Inspection Services

**PENALTY FOR REMOVING THIS CARD**

Scanned

**City of Portland, Maine - Building or Use Permit Application**

389 Congress Street, 04101 Tel: (207) 874-8703, Fax: (207) 874-8716

Permit No: 07-1502	Issue Date:	CBL: 037 F017001
-----------------------	-------------	---------------------

Location of Construction: 489 CONGRESS ST	Owner Name: MHS INC	Owner Address: 485 CONGRESS ST	Phone:
Business Name:	Contractor Name: Portland Color	Contractor Address: 14 Industrial Way Portland	Phone 2077741822
Lessee/Buyer's Name	Phone:	Permit Type: Signs - Permanent	Zone: B-3

Past Use: Commercial - Maine Historical Society	Proposed Use: Commercial - Maine Historical Society - (2) two <del>8'x18'</del> signs 64"x144" banners & 7 pin letter signs - 4" high	Permit Fee: \$606.00	Cost of Work: \$606.00	CEO District: 1
Proposed Project Description: (2) two <del>8'x18'</del> signs 64"x144" banners & 7 pin letter signs 4" high		FIRE DEPT: <input type="checkbox"/> Approved <input type="checkbox"/> Denied		INSPECTION: Use Group: <i>A3</i> Type: <i>SB</i> <i>IBC 2003</i>
		Signature: _____		Signature: <i>zm 3/7/08</i>
PEDESTRIAN ACTIVITIES DISTRICT (P.A.D.) Action: <input type="checkbox"/> Approved <input type="checkbox"/> Approved w/Conditions <input type="checkbox"/> Denied Signature: _____ Date: _____				

Permit Taken By: ldobson	Date Applied For: 12/12/2007	<b>Zoning Approval</b>		
-----------------------------	---------------------------------	------------------------	--	--

- This permit application does not preclude the Applicant(s) from meeting applicable State and Federal Rules.
- Building permits do not include plumbing, septic or electrical work.
- Building permits are void if work is not started within six (6) months of the date of issuance. False information may invalidate a building permit and stop all work..

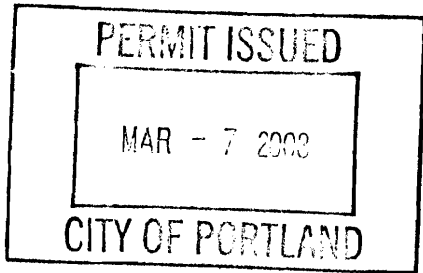

Special Zone or Reviews	Zoning Appeal	Historic Preservation
<input type="checkbox"/> Shoreland <input type="checkbox"/> Wetland <input type="checkbox"/> Flood Zone <input type="checkbox"/> Subdivision <input checked="" type="checkbox"/> Site Plan Maj <input type="checkbox"/> Minor <input type="checkbox"/> MM <input type="checkbox"/> Date: <i>1/15/08</i>	<input type="checkbox"/> Variance <input type="checkbox"/> Miscellaneous <input type="checkbox"/> Conditional Use <input type="checkbox"/> Interpretation <input type="checkbox"/> Approved <input type="checkbox"/> Denied Date: _____	<input checked="" type="checkbox"/> Not in District or Landmark <input type="checkbox"/> Does Not Require Review <input type="checkbox"/> Requires Review <input type="checkbox"/> Approved <input type="checkbox"/> Approved w/Conditions <input type="checkbox"/> Denied Date: _____

*PAD special exception 14-526(25)*  
*D. Andrews approved*

**CERTIFICATION**

I hereby certify that I am the owner of record of the named property, or that the proposed work is authorized by the owner of record and that I have been authorized by the owner to make this application as his authorized agent and I agree to conform to all applicable laws of this jurisdiction. In addition, if a permit for work described in the application is issued, I certify that the code official's authorized representative shall have the authority to enter all areas covered by such permit at any reasonable hour to enforce the provision of the code(s) applicable to such permit.

SIGNATURE OF APPLICANT	ADDRESS	DATE	PHONE
RESPONSIBLE PERSON IN CHARGE OF WORK, TITLE		DATE	PHONE

**City of Portland, Maine - Building or Use Permit Application**

389 Congress Street, 04101 Tel: (207) 874-8703, Fax: (207) 874-8716

Permit No: 07-1502	Issue Date:	CBL: 037 F017001
-----------------------	-------------	---------------------

Location of Construction: 489 CONGRESS ST	Owner Name: MHS INC	Owner Address: 485 CONGRESS ST	Phone:
Business Name:	Contractor Name: Portland Color	Contractor Address: 14 Industrial Way Portland	Phone 2077741822
Lessee/Buyer's Name	Phone:	Permit Type: Signs - Permanent	Zone: B-3

Past Use: Commercial - Maine Historical Society	Proposed Use: Commercial - Maine Historical Society - (2) two <del>8'x18' signs</del> 64"x144" banners & 7 pin letter signs - 4" high	Permit Fee: \$606.00	Cost of Work: \$606.00	CEO District: 1
Proposed Project Description: (2) two <del>8'x18' signs</del> 64"x144" banners & 7 pin letter signs 4" high		FIRE DEPT: <input type="checkbox"/> Approved <input type="checkbox"/> Denied	INSPECTION: Use Group: <i>A3</i> Type: <i>SB</i> <i>IBC 2003</i> Signature: <i>DM 3/7/08</i>	
		PEDESTRIAN ACTIVITIES DISTRICT (P.A.D.) Action: <input type="checkbox"/> Approved <input type="checkbox"/> Approved w/Conditions <input type="checkbox"/> Denied Signature: _____ Date: _____		

Permit Taken By: ldobson	Date Applied For: 12/12/2007
-----------------------------	---------------------------------

**Zoning Approval**

- This permit application does not preclude the Applicant(s) from meeting applicable State and Federal Rules.
- Building permits do not include plumbing, septic or electrical work.
- Building permits are void if work is not started within six (6) months of the date of issuance. False information may invalidate a building permit and stop all work..

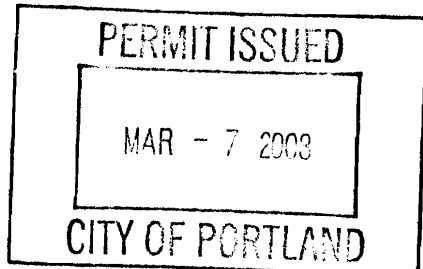

<b>Special Zone or Reviews</b> <input type="checkbox"/> Shoreland <input type="checkbox"/> Wetland <input type="checkbox"/> Flood Zone <input type="checkbox"/> Subdivision <input checked="" type="checkbox"/> Site Plan Maj <input type="checkbox"/> Minor <input type="checkbox"/> MM <input type="checkbox"/> Date: <i>1/15/08</i>	<b>Zoning Appeal</b> <input type="checkbox"/> Variance <input type="checkbox"/> Miscellaneous <input type="checkbox"/> Conditional Use <input type="checkbox"/> Interpretation <input type="checkbox"/> Approved <input type="checkbox"/> Denied Date: _____	<b>Historic Preservation</b> <input checked="" type="checkbox"/> Not in District or Landmark <input type="checkbox"/> Does Not Require Review <input type="checkbox"/> Requires Review <input type="checkbox"/> Approved <input type="checkbox"/> Approved w/Conditions <input type="checkbox"/> Denied Date: _____
---	---	--

*Special exception 14-524(25)*  
*D. Andrews approved*

**CERTIFICATION**

I hereby certify that I am the owner of record of the named property, or that the proposed work is authorized by the owner of record and that I have been authorized by the owner to make this application as his authorized agent and I agree to conform to all applicable laws of this jurisdiction. In addition, if a permit for work described in the application is issued, I certify that the code official's authorized representative shall have the authority to enter all areas covered by such permit at any reasonable hour to enforce the provision of the code(s) applicable to such permit.

SIGNATURE OF APPLICANT	ADDRESS	DATE	PHONE
RESPONSIBLE PERSON IN CHARGE OF WORK, TITLE		DATE	PHONE



# Signage/Awning Permit Application

If you or the property owner owes real estate or personal property taxes or user charges on any property within the City, payment arrangements must be made before permits of any kind are accepted.

Location/Address of Construction: <u>Maine Historical Society, 489 Congress Street</u>		
Tax Assessor's Chart, Block & Lot Chart# <u>39</u> Block# <u>F</u> Lot# <u>17</u>	Owner: <u>Maine Historical Society</u>	Telephone: <u>774-1822</u>
Lessee/Buyer's Name (If Applicable): <u>n/a</u>	Contractor name, address & telephone: <u>Portland Color</u> <u>14 Industrial Way</u> <u>Portland, 04103</u> <u>774-2689</u>	Total s.f. of signage x \$2.00 <u>144 x 2 =</u> Per s.f. plus <del>\$30.00</del> \$65.00 <u>288 x 2 =</u> For H.D. signage= Total <u>0576 x 30</u> Fee: \$ _____ Awning Fee= cost of work _____ Total Fee: \$ <u>606</u>
Who should we contact when the permit is ready: <u>Jane Foden</u> phone: <u>774-1822 x 230</u>		
Tenant/allocated building space frontage (feet): Length: <u>80'</u> Height: <u>40'</u> Lot Frontage (feet) <u>200' X 100'</u> Single Tenant or <u>Multi Tenant</u> Lot _____		
Current Specific use: <u>Historical Society</u> <u>144 x 2</u> If vacant, what was prior use: <u>n/a</u> <u>288 x 2 x 3</u> Proposed Use: <u>unchanged</u> <u>606</u>		
Information on proposed sign(s): Freestanding (e.g., pole) sign? Yes ___ No <u>X</u> Dimensions proposed: <u>8' x 18'</u> Height from grade: _____ Bldg. wall sign? (attached to bldg) Yes <u>X</u> No ___ Dimensions proposed: _____ <u>flat against bldg.</u> <u>Metal brackets permanently attached</u>		
Proposed awning? Yes ___ No <u>X</u> Is awning backlit? Yes ___ No ___ Height of awning: _____ Length of awning: _____ Depth: _____ <u>to building facade.</u> Is there any communication, message, trademark or symbol on it? Yes ___ No ___ <u>has Bolts</u> If yes, total s.f. of panels w/communications, message, trademark or symbol: _____ s.f.		
Information on existing and previously permitted sign(s): Freestanding (e.g., pole) sign? Yes ___ No <u>X</u> Dimensions: _____ Bldg. wall sign? (attached to bldg) Yes ___ No <u>X</u> Dimensions: _____ Awning? Yes ___ No <u>X</u> Sq. ft. area of awning w/communication: _____		
A site sketch and building sketch showing exactly where existing and new signage is located must be provided. Sketches and/or pictures of proposed signage and existing building are also required.		

Please submit all of the information outlined in the Sign/Awning Application Checklist. Failure to do so may result in the automatic denial of your permit.

In order to be sure the City fully understands the full scope of the project, the Planning and Development Department may request additional information prior to the issuance of a permit. For further information visit us on-line at [www.portlandmaine.gov](http://www.portlandmaine.gov), stop by the Building Inspections office, room 315 City Hall or call 874-8703.

I hereby certify that I am the Owner of record of the named property, or that the owner of record authorizes the proposed work and that I, have been authorized by the owner to make this application as his/her authorized agent. I agree to conform to all applicable laws of this jurisdiction. In addition, if a permit for work described in this application is issued, I certify that the Code Official's authorized representative shall have the authority to enter all areas covered by this permit at any reasonable hour to enforce the provisions of the codes applicable to this permit.

Signature of applicant: Jane Foden

Date: 12/11/07

B-3 multi  
80 x 2 = 160 φ

8' x 18' = 144 φ

This is not a permit; you may not commence ANY work until the permit is issued.

need certificate of handicraftability / what is banner made out of?  
size of smaller graphic  
only one sign per street.

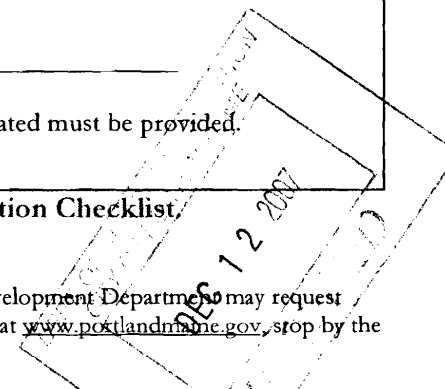

**City of Portland, Maine - Building or Use Permit**

389 Congress Street, 04101 Tel: (207) 874-8703, Fax: (207) 874-8716

<b>Permit No:</b> 07-1502	<b>Date Applied For:</b> 12/12/2007	<b>CBL:</b> 037 F017001
------------------------------	--	----------------------------

<b>Location of Construction:</b> 489 CONGRESS ST	<b>Owner Name:</b> MHS INC	<b>Owner Address:</b> 485 CONGRESS ST	<b>Phone:</b>
<b>Business Name:</b>	<b>Contractor Name:</b> Portland Color	<b>Contractor Address:</b> 14 Industrial Way Portland	<b>Phone</b> (207) 774-1822
<b>Lessee/Buyer's Name</b>	<b>Phone:</b>	<b>Permit Type:</b> Signs - Permanent	

<b>Proposed Use:</b> Commercial - Maine Historical Society - two 64" x 144" banners & 7 pin letter signs 4" high	<b>Proposed Project Description:</b> two 64" x 144" banners & 7 pin letter signs 4" high
---	---

**Dept:** PAD      **Status:** Approved with Conditions      **Reviewer:** Deborah Andrews      **Approval Date:** 01/18/2008

**Note:** **Ok to Issue:**

- 1) \* Approved as special exception under Sec. 14-526 (23) of Site Plan Ordinance. Approval is based on revised drawings reviewed by the Historic Preservation Board on 1/16/08. (With the consent of the applicant, Staff referred application to the HP Board for review and comment.) HP Board found that the proposed number, scale and character of signs was appropriate in this instance, given the unique character and scale of the subject structure. Large scale window graphics were also acceptable in this instance, as the existing windows are tinted and blinds are currently drawn to obscure visibility. In HP Board's opinion, proposed window graphics would provide more pedestrian interest than is currently the case.

\* Condition of approval: That the applicant submit to staff a final specification for banner material, together with proposed method of attachment.

**Dept:** Zoning      **Status:** Approved      **Reviewer:** Ann Machado      **Approval Date:** 01/23/2008

**Note:** Not meet ordinance. See comment. **Ok to Issue:**

1/18/08 Approved by Deb Andrews.  
Was on hold until received more information on the banners.

**Dept:** Building      **Status:** Approved      **Reviewer:** Tom Markley      **Approval Date:** 03/07/2008

**Note:** **Ok to Issue:**

- 1) Signage Installation to comply with Chapter 31 of the IBC 2003 building code.  
2) Application approval based upon information provided by applicant. Any deviation from approved plans requires separate review and approval prior to work.

**Comments:**

12/17/2007-amachado: Did not meet sign ordinance requirements. Does not permit more than one sign per street. Gave permit to Deb Andrews to review.

1/23/2008-amachado: Left message for Jane Foden. Need to know the material that the banner is made out of, how they are going to be attached and the certificate of flammability.

3/4/2008-amachado: Received information from Deb Andrews. She is fine with the banner material.

**City of Portland, Maine - Building or Use Permit**

389 Congress Street, 04101 Tel: (207) 874-8703, Fax: (207) 874-8716

<b>Permit No:</b> 07-1502	<b>Date Applied For:</b> 12/12/2007	<b>CBL:</b> 037 F017001
------------------------------	--	----------------------------

<b>Location of Construction:</b> 489 CONGRESS ST	<b>Owner Name:</b> MHS INC	<b>Owner Address:</b> 485 CONGRESS ST	<b>Phone:</b>
<b>Business Name:</b>	<b>Contractor Name:</b> Portland Color	<b>Contractor Address:</b> 14 Industrial Way Portland	<b>Phone</b> (207) 774-1822
<b>Lessee/Buyer's Name</b>	<b>Phone:</b>	<b>Permit Type:</b> Signs - Permanent	

<b>Proposed Use:</b> Commercial - Maine Historical Society - two 64" x 144" banners & 7 pin letter signs 4" high	<b>Proposed Project Description:</b> two 64" x 144" banners & 7 pin letter signs 4" high
---	---

**Dept:** PAD      **Status:** Approved with Conditions      **Reviewer:** Deborah Andrews      **Approval Date:** 01/18/2008

**Note:****Ok to Issue:** 

- 1) \* Approved as special exception under Sec. 14-526 (23) of Site Plan Ordinance. Approval is based on revised drawings reviewed by the Historic Preservation Board on 1/16/08. (With the consent of the applicant, Staff referred application to the HP Board for review and comment.) HP Board found that the proposed number, scale and character of signs was appropriate in this instance, given the unique character and scale of the subject structure. Large scale window graphics were also acceptable in this instance, as the existing windows are tinted and blinds are currently drawn to obscure visibility. In HP Board's opinion, proposed window graphics would provide more pedestrian interest than is currently the case.

\* Condition of approval: That the applicant submit to staff a final specification for banner material, together with proposed method of attachment.

**Dept:** Historic      **Status:**      **Reviewer:** Deborah Andrews      **Approval Date:** 01/22/2008

**Note:****Ok to Issue:** 

**Dept:** Zoning      **Status:** Approved      **Reviewer:** Ann Machado      **Approval Date:** 01/23/2008

**Note:** Not meet ordinance. See comment.  
1/18/08 Approved by Deb Andrews

**Ok to Issue:** 

**Dept:** Building      **Status:** Pending      **Reviewer:**      **Approval Date:**

**Note:****Ok to Issue:** **Comments:**

12/17/2007-amachado: Did not meet sign ordinance requirements. Does not permit more than one sign per street. Gave permit to Deb Andrews to review.

FRISKEY DESIGN 35 PLEASANT STREET  
PORTLAND ME 04101 TEL 207.773.9699  
EMAIL FRISKEYDESIGN@COMCAST.NET -  
*graphic design marketing communications*

*Approved based on  
these revised  
Drawings & Specs.  
D. Andrews  
1/15/08*

January 2008

**MAINE HISTORICAL SOCIETY  
BUILDING SIGNAGE**

*Content, Fabrication, Installation and Vendors*

**MAINE HISTORICAL SOCIETY  
EXTERIOR LARGE BANNERS**

*Content:* MHS logo

*Quantity:* 2

*Fabrication:*

Size: 64"x144" each

Single Sided 13oz Scrim Vinyl

(material selection to be reviewed based on revised size)

pole pocket finishing top and bottom

Red and Gold logo colors

*Installation:*

Metal Brackets permanently attached to building facade.

HD Lift/ electricity required/two men, eight hours

*Locations:*

1. Front door niche for view from Longfellow Square/Congress Street
2. Brown Street at Congress Street corner

*Vendor:*

Portland Color

14 Industrial Way

Portland ME 04103

207-774-2689

Contact: Paul Maddrell, Monica Bell

FRISKEY DESIGN 35 PLEASANT STREET  
PORTLAND ME 04101 TEL 207.773.9699  
EMAIL FRISKEYDESIGN@COMCAST.NET  
*graphic design marketing communications*

**MAINE HISTORICAL SOCIETY  
WINDOW SIGNAGE**

*Content:* cartouche graphic, changeable exhibit graphic, logo and tick mark graphic  
*Quantity:* 5 window bays—3 on Congress Street, 2 on Brown Street

*Fabrication:*

MHS Logos:

6 quantity

1.626"x5" Avery calendar Vinyl

Red and Gold logo colors

Ovals (changeable colored inserts):

6 quantity 43.5 x 21.5 Avery calendar Vinyl

Full color inserts change per exhibition

Permanent Cartouches:

2 quantity 156"x48" and

3 quantity 125"x48"

2mil Arlon Vinyl

Black

Tick Mark ribbon:

Gerber Window Vinyl

Medium grey

*Installation:*

Install: Two men, eight hours.

\*Note: All Window Graphics require min. 50 Degree temp. to install

*Vendor:*

Portland Color

14 Industrial Way

Portland ME 04103



FRISKEY DESIGN 35 PLEASANT STREET  
PORTLAND ME 04101 TEL 207.773.9699  
EMAIL FRISKEYDESIGN@COMCAST.NET-  
*graphic design marketing communications*

207-774-2689

Contact: Paul Maddrell, Monica Bell

**MAINE HISTORICAL SOCIETY  
PIN LETTER SIGNAGE**

*Content:*

*Placed above window bays:*

MUSEUM

LONGFELLOW HOUSE

LIBRARY

MUSEUM SHOP

*Placed below banners:*

MAINE HISTORICAL SOCIETY (x 2, one at entry, one on Brown Street under banner)

*Placed above entry door:*

MHS ENTRANCE

*Quantity:* Total of 93 letters.

*Fabrication:*

4" \* set of 93 letters with stud patterns

Dimensional Cast Aluminum Letters With Natural Satin Finish.

\* Size to be reviewed on site for optimum spacing, readability

*Installation:*

Letters are positioned using a pen plot. Pen plot is taped to Dryvit finished face. Holes are drilled into the face of the building to accommodate the studs. Each letter has 2 -3 1/8" x 3" aluminum studs inserted into threaded stub bosses cast into the back of the letter. 4" high letters have an average width of 3 1/8" and depth of 3/4" with a stroke of between 3/4" and 7/8"  
Cast Metal Letters

*Vendor:*

The Signery

7 Lincoln Avenue

Scarborough, ME 04074

Contact: Dave Berrang

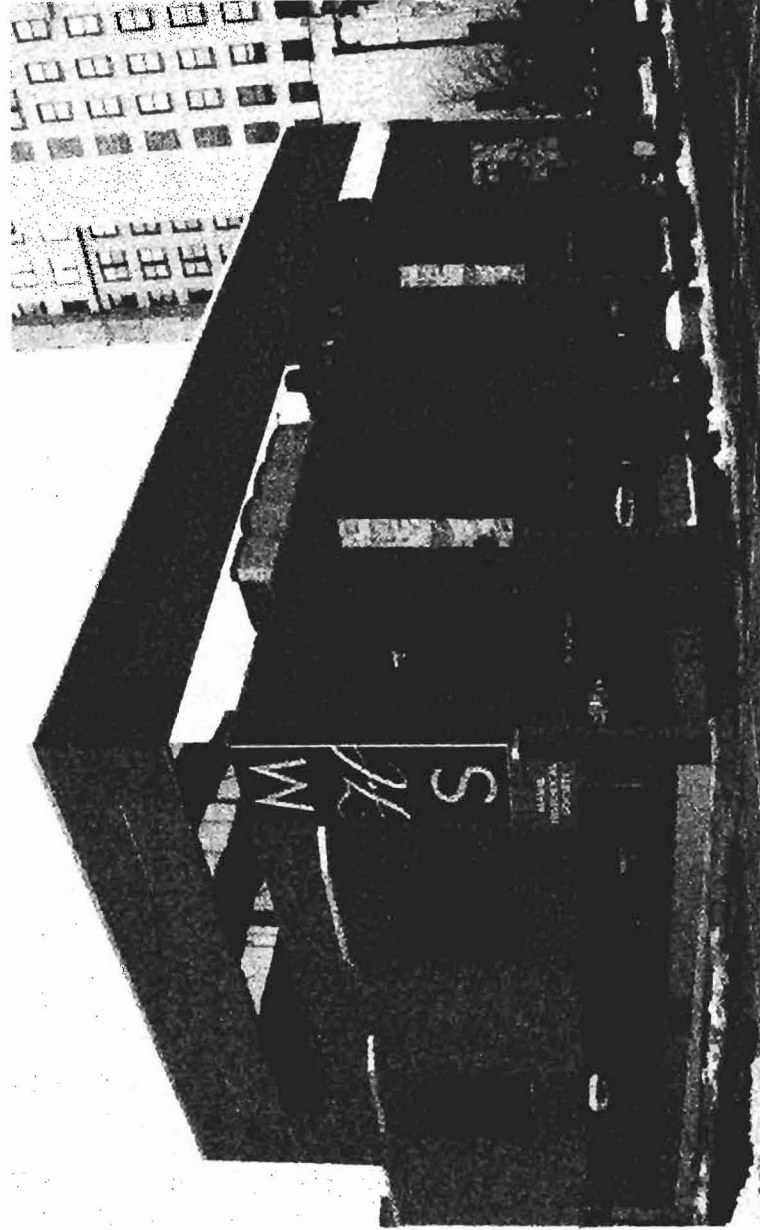

CARTOUCHE, TUCK MARKS, HUBBARD, LOGO AND DISASSEMBLE EXHIBITION GRAPHIC  
2 WINDOW BAYS ON BROWN STREET AND 3 WINDOW BAYS ON CONGRESS STREET  
2 EXISTING POLE BANNERS REMAIN FOR EXHIBITIONS ON CONGRESS STREET

BANNERS AT BROWN/CONGRESS CORNER AND MAIN ENTRY BANNER  
PIL LETTERS (63 LETTERS) ON BUILDING INCLUDING  
MAINE HISTORICAL SOCIETY TO BE ADDED IN ENTRYWAY  
AND ON BROWN/CONGRESS CORNER

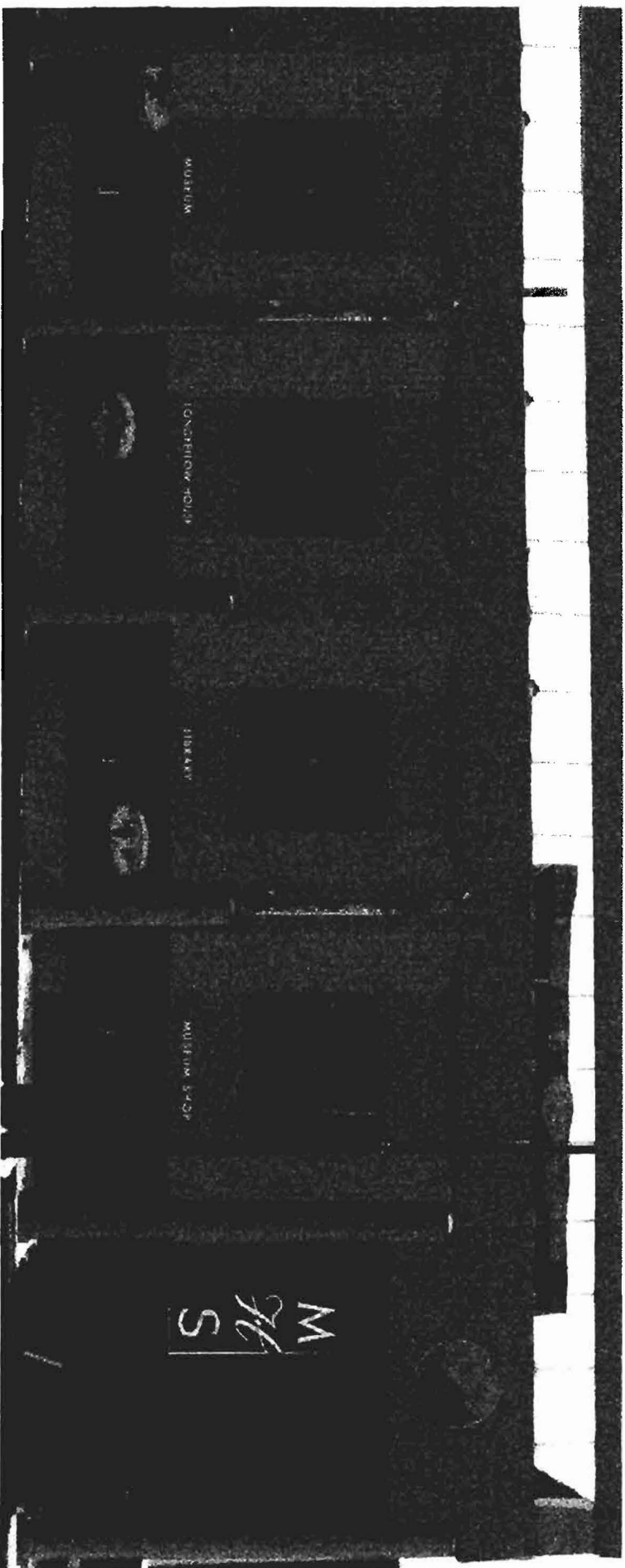

1. CARTRIDGE, TUCK MARKS, MASON, LOGO AND CORNERSTONE EXHIBITION SPACING.  
3 WINDOW BAYS ON CONGRESS STREET AND 2 WINDOW BAYS ON BRIDWAY STREET  
2 EXISTING POLE SIGNMETS REMAIN FOR EXHIBITIONS ON CONGRESS STREET

2. SIGNMETS IN ENTRY AND  
BRONWOOD/CORNER CORNER SIGNMET  
P/N LETTERS (S/L LETTERS) ON BUILDING INCLUDING  
NAME HISTORICAL SOCIETY TO BE ADDED IN ENTRYWAY  
AND ON BRONWOOD/CORNER CORNER

<b>ACORD. CERTIFICATE OF LIABILITY INSURANCE</b>		OP ID 9S MEHIS-1	DATE (MM/DD/YYYY) 11/16/07
<b>PRODUCER</b>  TD Banknorth Ins Agcy Inc (SP) P.O. Box 406 Portland ME 04112-0406 Phone: 207-239-3500 Fax: 207-775-0339		THIS CERTIFICATE IS ISSUED AS A MATTER OF INFORMATION ONLY AND CONFERS NO RIGHTS UPON THE CERTIFICATE HOLDER. THIS CERTIFICATE DOES NOT AMEND, EXTEND OR ALTER THE COVERAGE AFFORDED BY THE POLICIES BELOW.	
<b>INSURED</b>  Maine Historical Society 489 Congress St Portland ME 04101		<b>INSURERS AFFORDING COVERAGE</b>	<b>NAIC #</b>
		INSURER A York Insurance Co. of Maine	31267
		INSURER B	
		INSURER C	
		INSURER D	
		INSURER E	

**COVERAGES**

THE POLICIES OF INSURANCE LISTED BELOW HAVE BEEN ISSUED TO THE INSURED NAMED ABOVE FOR THE POLICY PERIOD INDICATED. NOTWITHSTANDING ANY REQUIREMENT, TERM OR CONDITION OF ANY CONTRACT OR OTHER DOCUMENT WITH RESPECT TO WHICH THIS CERTIFICATE MAY BE ISSUED OR MAY PERTAIN, THE INSURANCE AFFORDED BY THE POLICIES DESCRIBED HEREIN IS SUBJECT TO ALL THE TERMS, EXCLUSIONS AND CONDITIONS OF SUCH POLICIES. AGGREGATE LIMITS SHOWN MAY HAVE BEEN REDUCED BY PAID CLAIMS.

INSR LTR	POLICY LTR	TYPE OF INSURANCE	POLICY NUMBER	POLICY EFFECTIVE DATE (MM/DD/YY)	POLICY EXPIRATION DATE (MM/DD/YY)	LIMITS
A		GENERAL LIABILITY <input checked="" type="checkbox"/> COMMERCIAL GENERAL LIABILITY <input type="checkbox"/> CLAIMS MADE <input checked="" type="checkbox"/> OCCUR  GEN'L AGGREGATE LIMIT APPLIES PER: <input checked="" type="checkbox"/> POLICY <input type="checkbox"/> PROJECT <input type="checkbox"/> LOC	710013630	07/15/07	07/15/08	EACH OCCURRENCE \$ 1,000,000. DAMAGE TO RENTED PREMISES (Ea occurrence) \$ 100,000. MED EXP (Any one person) \$ 5,000. PERSONAL & ADV INJURY \$ 1,000,000. GENERAL AGGREGATE \$ 2,000,000. PRODUCTS - COMP/OP AGG \$ 2,000,000.
		AUTOMOBILE LIABILITY <input type="checkbox"/> ANY AUTO <input type="checkbox"/> ALL OWNED AUTOS <input type="checkbox"/> SCHEDULED AUTOS <input type="checkbox"/> HIRED AUTOS <input type="checkbox"/> NON-OWNED AUTOS				COMBINED SINGLE LIMIT (Ea accident) \$ BODILY INJURY (Per person) \$ BODILY INJURY (Per accident) \$ PROPERTY DAMAGE (Per accident) \$
		GARAGE LIABILITY <input type="checkbox"/> ANY AUTO				AUTO ONLY - EA ACCIDENT \$ OTHER THAN AUTO ONLY EA ACC \$ AGG \$
		EXCESS/UMBRELLA LIABILITY <input type="checkbox"/> OCCUR <input type="checkbox"/> CLAIMS MADE  DEDUCTIBLE RETENTION \$				EACH OCCURRENCE \$ AGGREGATE \$ \$ \$
		WORKERS COMPENSATION AND EMPLOYERS' LIABILITY ANY PROPRIETOR/PARTNER/EXECUTIVE OFFICER/MEMBER EXCLUDED? If yes, describe under SPECIAL PROVISIONS below				WC STATUTORY LIMITS OTHER E.L. EACH ACCIDENT \$ E.L. DISEASE - EA EMPLOYEE \$ E.L. DISEASE - POLICY LIMIT \$
		OTHER				
DESCRIPTION OF OPERATIONS / LOCATIONS / VEHICLES / EXCLUSIONS ADDED BY ENDORSEMENT / SPECIAL PROVISIONS <b>Evidence of general liability to the below named certificate holder.</b>						

**CERTIFICATE HOLDER****CANCELLATION**

CITYP01  City of Portland 389 Congress St Portland ME 04101	SHOULD ANY OF THE ABOVE DESCRIBED POLICIES BE CANCELLED BEFORE THE EXPIRATION DATE THEREOF, THE ISSUING INSURER WILL ENDEAVOR TO MAIL <u>10</u> DAYS WRITTEN NOTICE TO THE CERTIFICATE HOLDER NAMED TO THE LEFT, BUT FAILURE TO DO SO SHALL IMPOSE NO OBLIGATION OR LIABILITY OF ANY KIND UPON THE INSURER, ITS AGENTS OR REPRESENTATIVES. AUTHORIZED REPRESENTATIVE <b>Small Business</b>
---	--

**Consort Display Group**  
 2129 Portage St. Kalamazoo, MI 49001  
 269.388.4532 fax 269.342.1928

PART NAME: Outdoor Bracket  
 PART NO.  
 DESCRIPTION-  
 MATERIAL- STEEL

D	
C	
B	
A	
REVISIONS	DATE

UNLESS OTHERWISE SPECIFIED DIMENSIONS ARE IN INCHES, TOLERANCES ARE:  
 FRACTIONS DECIMALS ANGLES  
 $\pm 1/64"$   $\pm 0.01"$   $\pm 0.5^\circ$   
 CAD GENERATED DRAWING, DO NOT MANUALLY UPDATE  
 Copyright © Consort Display Group, 2003

SCALE 1:5	DRAWN BY EB ON 7-10-03
SHEET 1 of 1	FILE NAME: Towel Bar

**KBW** Kalamazoo  
 Banner Works  
 by CONSORT

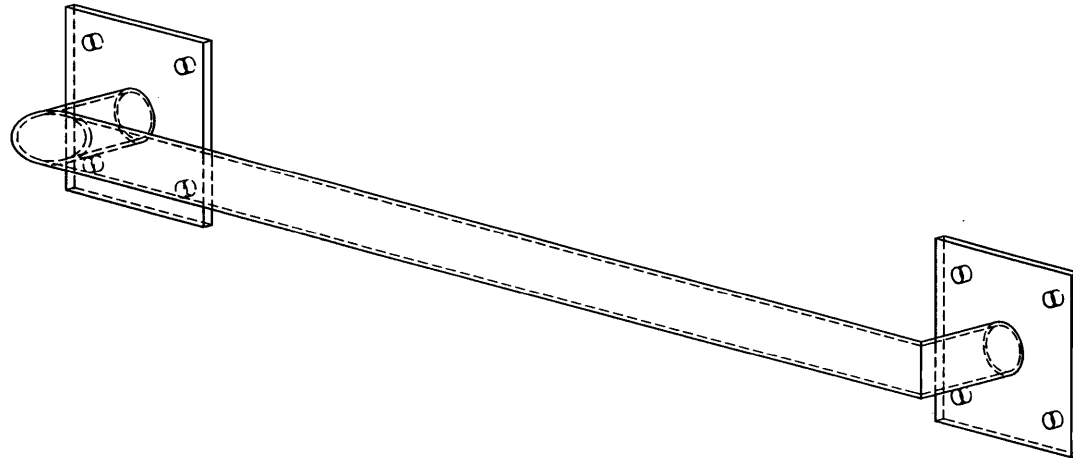
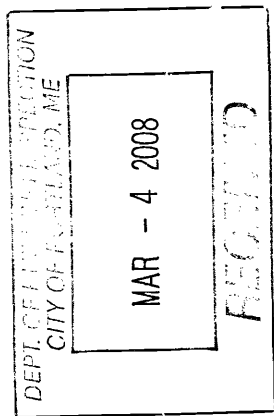
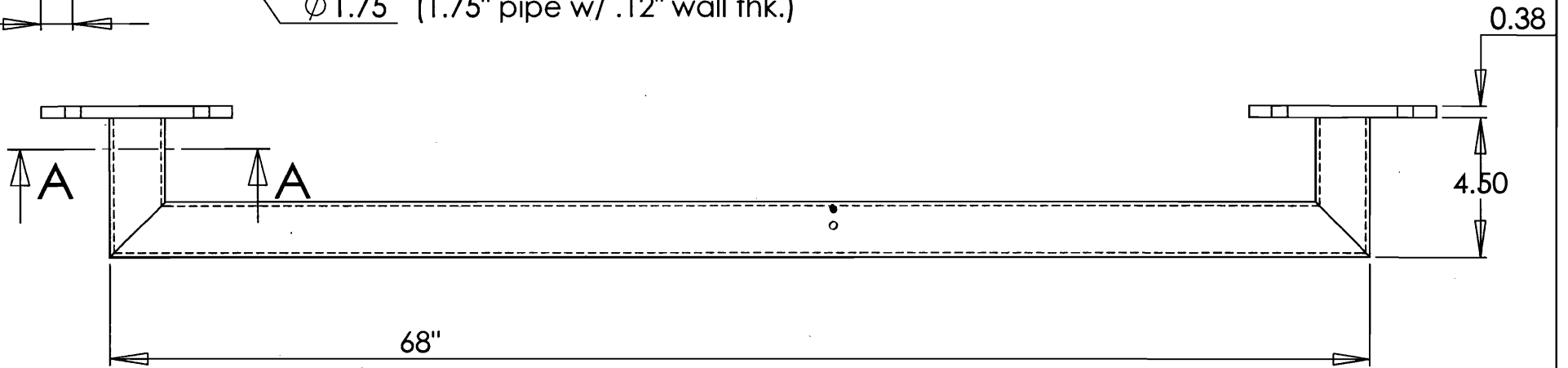
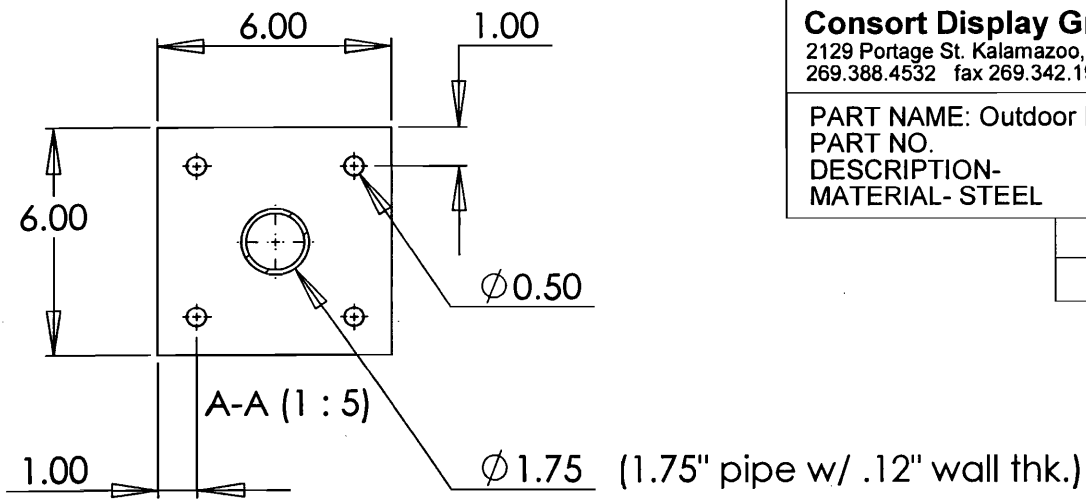

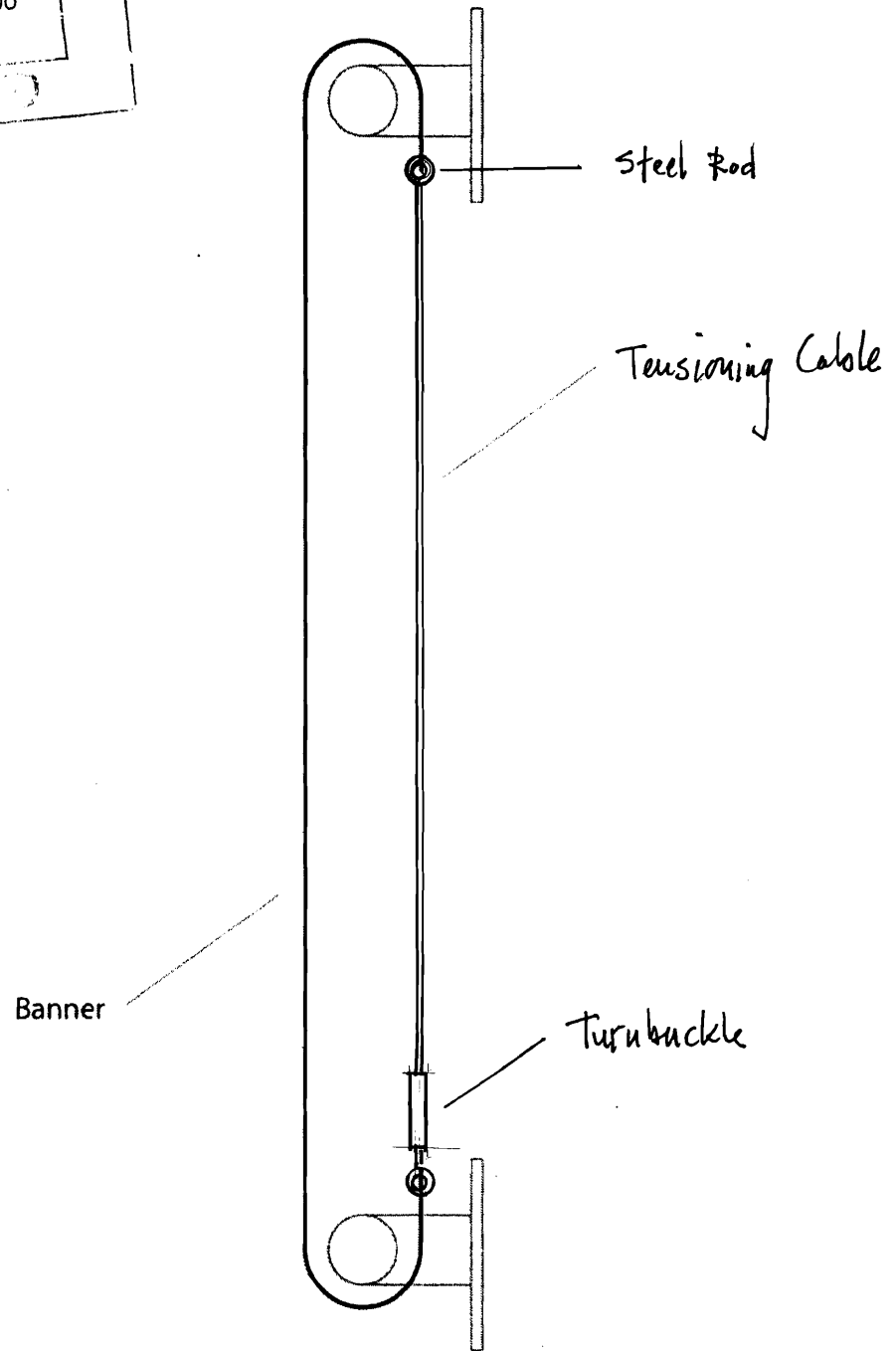
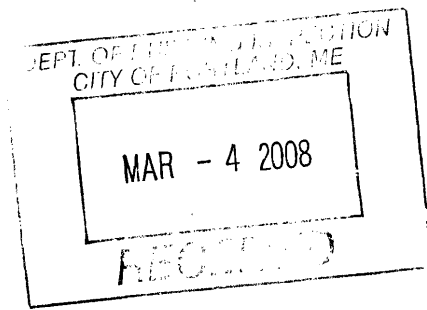

SIDE VIEW

• Not To Scale •

REVISION  
DATE: 03/04/08  
MAR - 4 2008  
REVISION

Mounting Plates

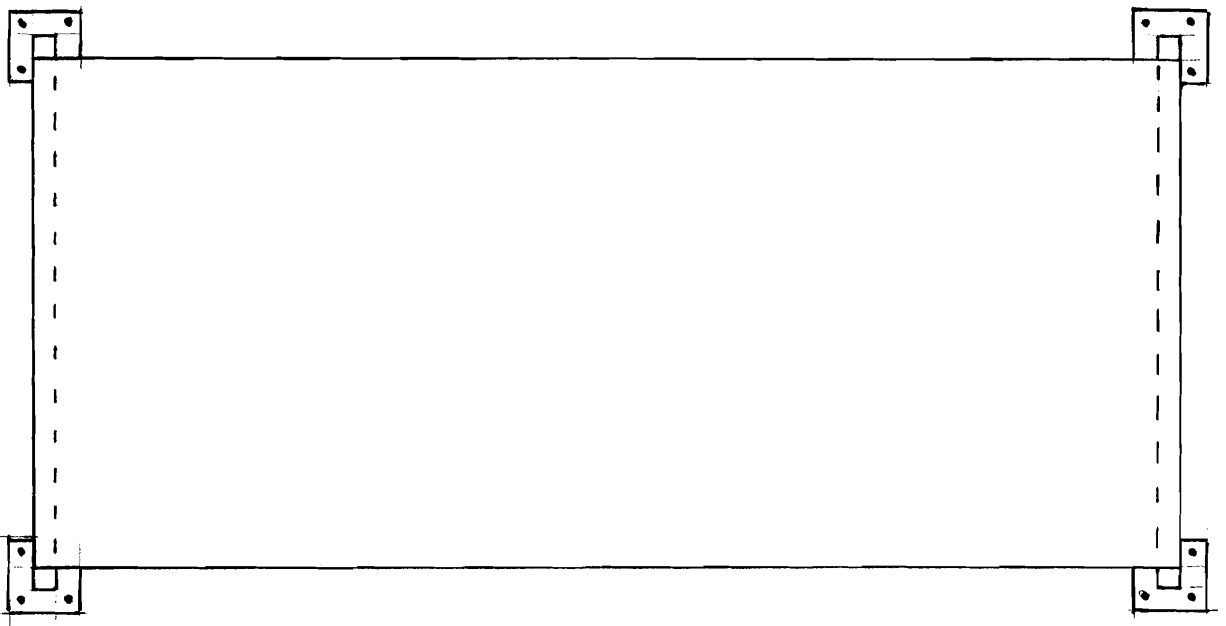

F R O N T

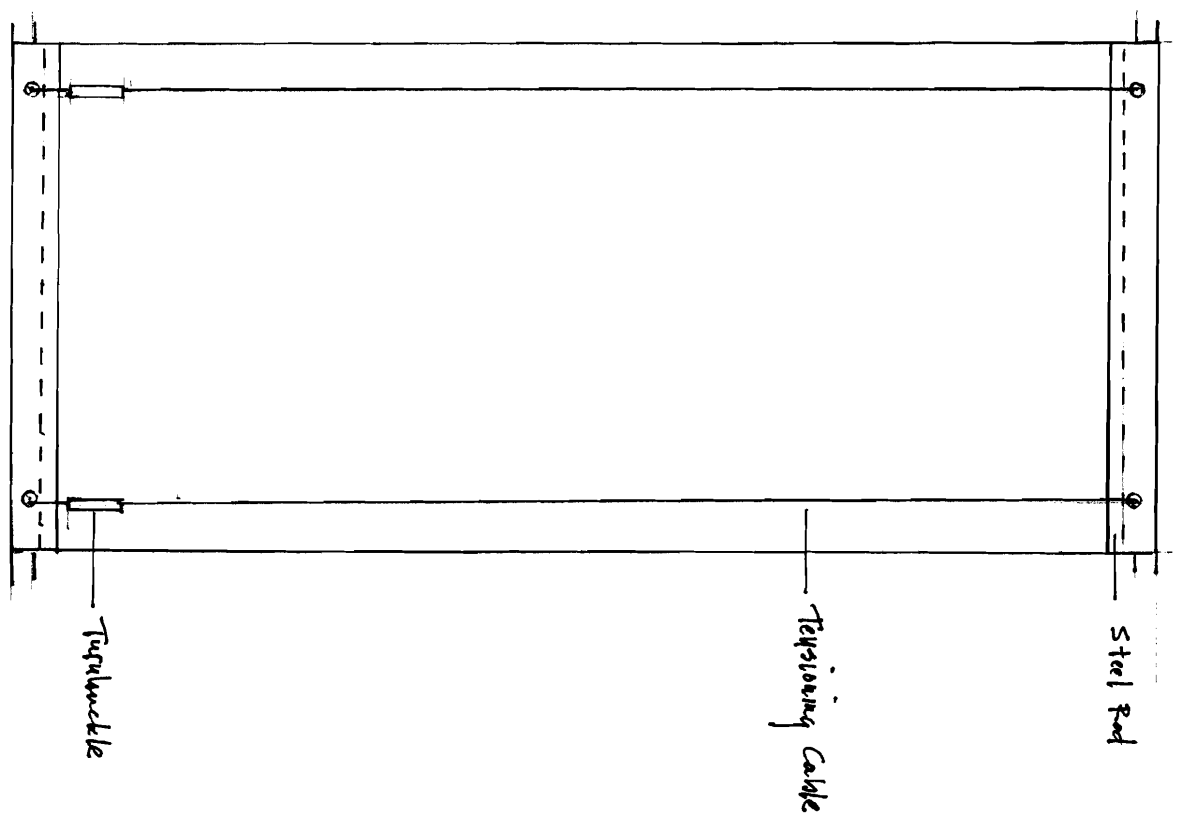

R E A R

Scale: 1/2" = 1.0'

Tensioning Cable

Steel Rod

Turnbuckle

MAR - 4 2008

TECHNICAL DATA SHEET

®  
**Jetflex FL**

**Description:**

Jetflex FL white front-lit banner or billboard substrate produces true, vibrant, eye-catching colors without problems concerning fish-eyes, streaking, or color drift. Ink will not scratch off, and drying time is minimal. Jetflex FL is available in both matte and gloss finish in a wide selection of widths (from 30" or .76m)(Print Side Out 54", and Print Side Out on 6" core 39", 54", and 64") and lengths, also on Arizona cores. THE WIDER VERSION OF THE SAME PRODUCT IS CALLED **NORMANDY PRO** IN WIDTHS FROM 98" up to 16'4"(2.5m up to 5m). It is perfect for solvent or UV inks and screenprinting (in custom 902' or 275m. rolls).

**Physical Properties**

The following information on physical and chemical characteristics is based upon tests believed to be reliable. The values are intended only as a source of information. They are given without guaranty and do not constitute a warranty. The purchaser should independently determine, prior to use, the suitability of this material for his/her specific purpose. (Data represents averages and is not intended for use as a specification.)

CHARACTERISTICS	TEST METHOD	METRIC	ENGLISH
Support Cloth	DIN 6001	Polyester	Polyester
Yarn dtex	DIN 53830	1100 x 1100	1000 x 1000
Type of Coating	N/A	PVC	PVC
Total Weight	DIN EN ISO 2286-2	450 g/m <sup>2</sup>	13 oz/yd <sup>2</sup>
Width	DIN EN ISO 2286-1	.76m, .965m, 1.37m 1.52m, 1.6m, 1.83m, 2.03m also .965, 1.37 and 1.6m on Arizona Cores	30", 38", 54", 60", 63", 72", 80" also 38", 54" and 63" on Arizona Cores
Tensile Strength	ISO 13934-1999	139 x 116 kgF/5cm	153 x 128 lbs/in
Tear Strength (warp/weft)	ISO 13937-2-2000	11.4 x 15.5 kgF/5cm	53 x 45 lbs
Flame Resistance	DIN 4102	NEPA 701, CA Fire Marshall, NYC (MEA)	
Low Temperature (No Crack at:)	ASTM D 2137	-40°C	-40°F
Fungus Resistance	ASTM G21	Treated	
Puncture Resistance	N/A	Yes	Yes
RF Weldable (Heat Sealable)	DIN 53354	Yes	Yes

1578 Sussex Turnpike, Bldg 4; Randolph, NJ, 07869

USA TEL: (973) 627-8608 FAX: (973) 627-8506

EMAIL: SALES@ULTRAFLEXX.COM

www.ultraflexx.com

Rev. 2/06



