



Issue Dates:
JULY 9, 2012
ISSUE FOR PERMIT
MAY 7, 2013
FIRE MARSHALL COMMENTS

WESTIN
HOTELS & RESORTS

ROCKBRIDGE CAPITAL

NEW CASTLE HOTELS
& RESORTS

CONTRACTOR
IDC
IDC CONSTRUCTION, LLC

NOTE:
THE DOCUMENTS CONTAINED HEREIN HAVE BEEN PRODUCED
IN ACCORDANCE WITH THE PROFESSIONAL STANDARDS OF THE
ARCHITECT ASSOCIATION OF AMERICA. THE ARCHITECT
ASSUMES NO LIABILITY RESULTING FROM THE OMISSIONS
OR DEVIATIONS OF THE ATTACHED DOCUMENTS AND ACTUAL
CONSTRUCTION FROM THE INTENT OF THE ARCHITECT'S
DESIGN. THE ARCHITECT SHALL BE RESPONSIBLE FOR VERIFYING THE ACTUAL
EXISTING CONDITIONS.

Project:
**WESTIN
EASTLAND PARK
HOTEL RENOVATION**
FOR
ROCKBRIDGE CAPITAL, LLC.
157 HIGH STREET
PORTLAND, ME

This Document is the property of Raintree
Architecture, Inc. (PFVS) and is to be used only in
connection with the project named herein.
Reproduction, in whole or in part, shall be allowed
only with the express written or verbal permission
from the architect. Drawing scales as shown are
valid on the original sized document which is 30
by 42 inches. © 2013 Raintree Architecture, Inc.
d/b/a PFVS Architecture.

Sheet Title:

**B-1 BASEMENT
FLOOR PLAN**

Job Number:
11009
Scale: 1/8" = 1'-0"
Drawn: IP
Checked: AR
Date: Nov. 21, 2011
PERMIT SET - RELEASED
FOR CONSTRUCTION

A-100S

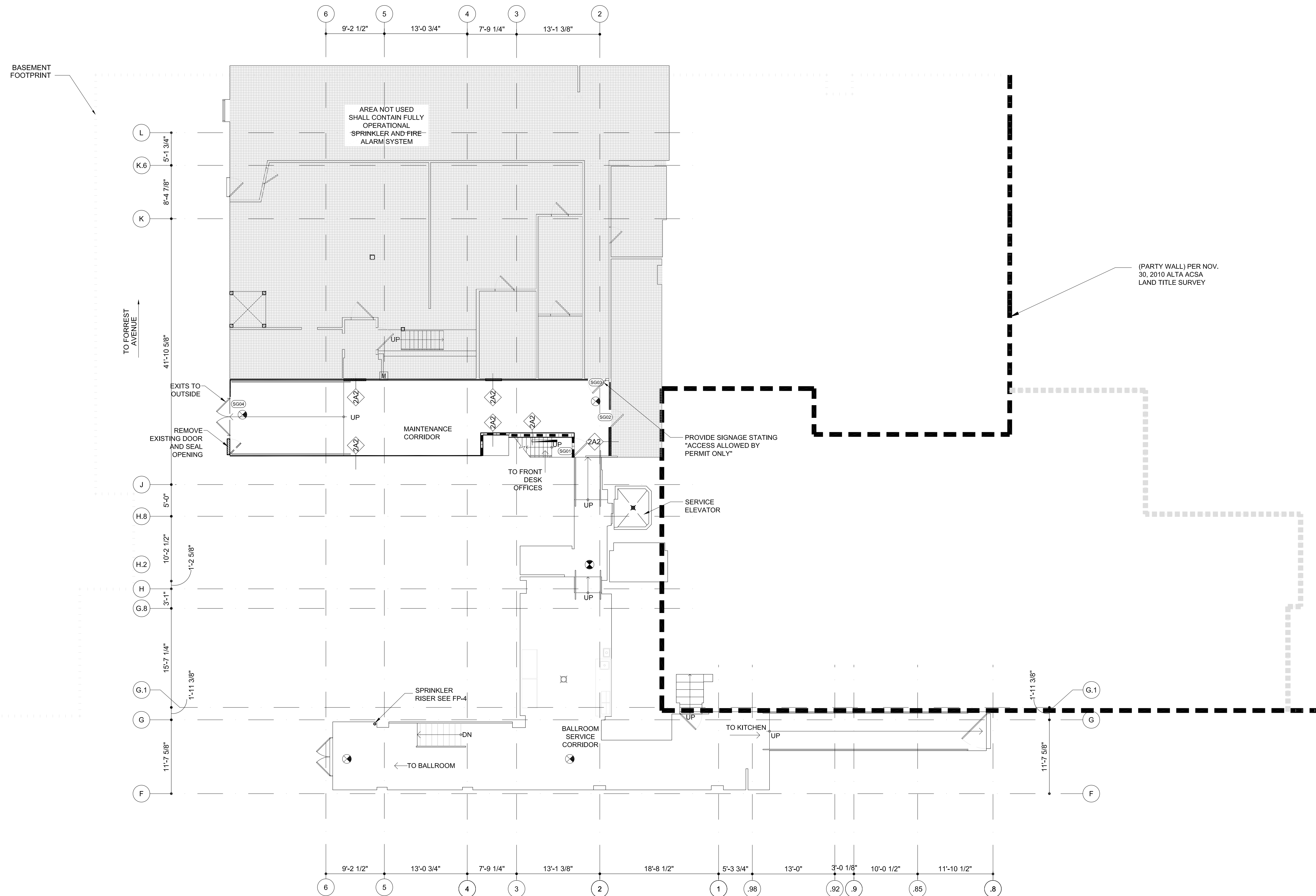

B-1 BASEMENT FLOOR PLAN
SCALE: 1/8" = 1'-0"

WALL LEGEND

—	EXISTING
—	NEW
- - -	SMOKE
- · - · -	1 HOUR
- - - - -	2 HOUR
— · — · —	EXISTING DEMISING

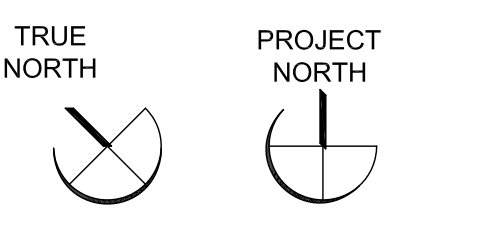

HANDRAILS PROVIDED ON BOTH SIDES OF ALL RAMPS