



Issue Dates:
1 JULY 9, 2012
2 APRIL 18, 2013
3 ISSUE FOR PERMIT
4 FIELD UPDATES & REVISIONS
MAY 7, 2013
5 FIRE MARSHALL COMMENTS

WESTIN
HOTELS & RESORTS
ROCKBRIDGE CAPITAL

NEWCASTLE HOTELS & RESORTS

CONTRACTOR
IDC
IDC CONSTRUCTION, LLC

NOTE: ALL DIMENSIONS CONTAINED HEREIN HAVE BEEN PROVIDED BY THE ARCHITECT. THE CONTRACTOR SHALL VERIFY ALL DIMENSIONS AND CONDITIONS OF THE ATTACHED DOCUMENTS AND ASSOCIATED FIELD CONDITIONS. THE CONTRACTOR AND ALL ASSOCIATED SUBCONTRACTORS SHALL BE RESPONSIBLE FOR VERIFYING THE ACTUAL EXISTING CONDITIONS.

Project:
WESTIN EASTLAND PARK HOTEL RENOVATION FOR ROCKBRIDGE CAPITAL, LLC.
157 HIGH STREET
PORTLAND, ME

This Document is the property of Raintree Architecture, Inc. (R/A) and is to be used only in connection with the project named herein. Reproduction in whole or in part, shall be allowed only with the express written or verbal permission from the architect. Drawing scales as shown are valid on the original sized document which is 30 by 42 inches. © 2013 Raintree Architecture, Inc. All rights reserved.

Sheet Title:
GROUND LEVEL FLOOR PLAN

Job Number: 11009
Scale: 1/8" = 1'-0"
Drawn: IP
Checked: AR
Date: Nov. 21, 2011
PROJECT NORTH
A-100
PERMIT SET - RELEASED FOR CONSTRUCTION

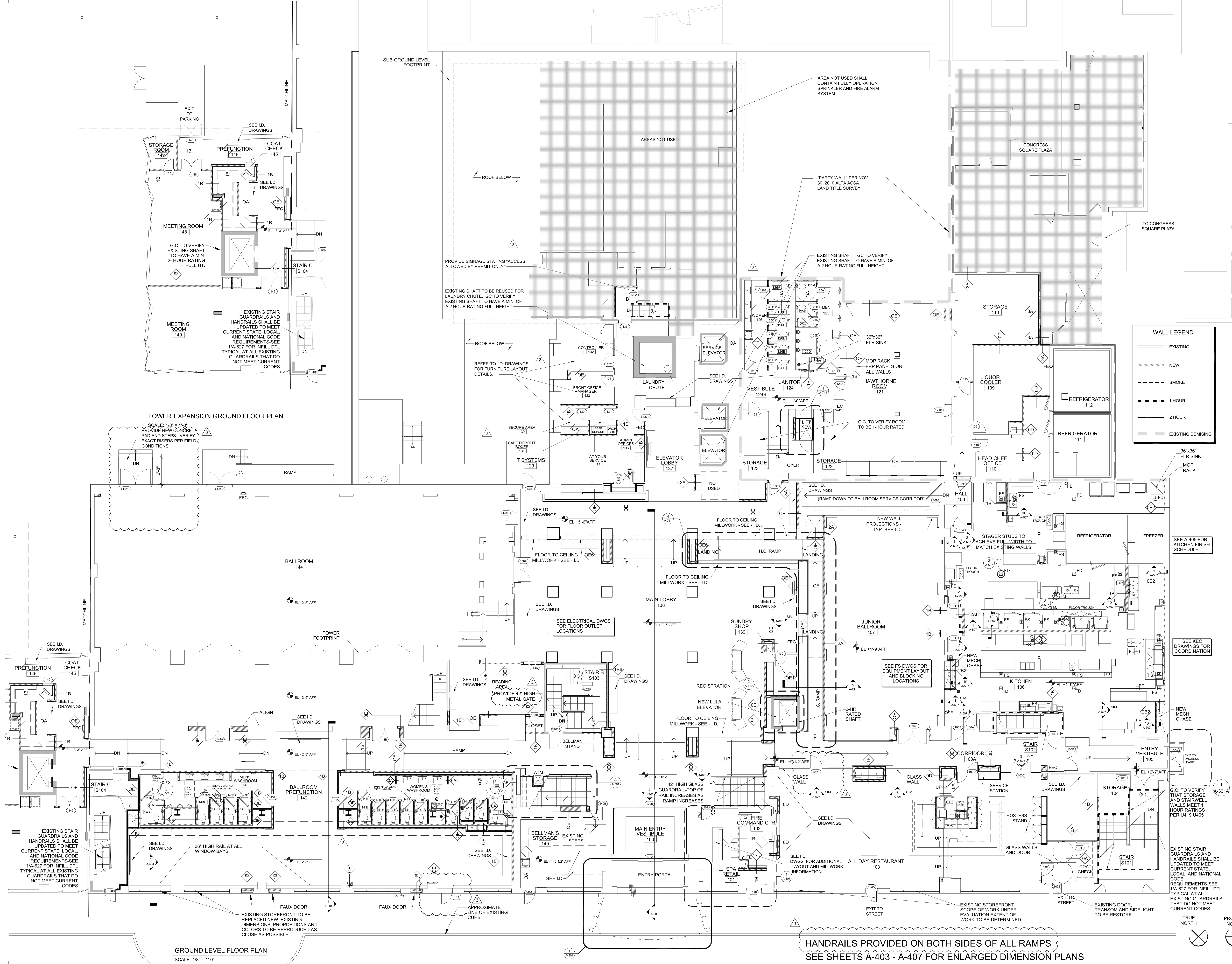

TOWER EXPANSION GROUND FLOOR PLAN

SCALE: 1/8" = 1'-0"
PROVIDE NEW CONCRETE PAD AND STEPS - VERIFY EXACT RISERS PER FIELD CONDITIONS

GROUND LEVEL FLOOR PLAN
SCALE: 1/8" = 1'-0"

HANDRAILS PROVIDED ON BOTH SIDES OF ALL RAMPS
SEE SHEETS A-403 - A-407 FOR ENLARGED DIMENSION PLANS