



Issue Dates:

JULY 9, 2012	ISSUE FOR PERMIT
MAY 7, 2013	FIRE MARSHALL COMMENTS

**WESTIN**  
HOTELS & RESORTS

ROCKBRIDGE CAPITAL

NEW CASTLE HOTELS  
& RESORTS

CONTRACTOR  
**IDC**  
IDC CONSTRUCTION, LLC

NOTE: THE DOCUMENTS CONTAINED HEREIN HAVE BEEN PRODUCED BY THE ARCHITECT AND HIS OR HER OFFICE. THE ARCHITECT ASSUMES NO LIABILITY FOR ANY DEVIATIONS OF THE ATTACHED DOCUMENTS AND ACTUAL TRADES SHALL BE RESPONSIBLE FOR VERIFYING THE ACTUAL EXISTING CONDITIONS.

Project:  
**WESTIN  
EASTLAND PARK  
HOTEL RENOVATION**  
FOR  
**ROCKBRIDGE CAPITAL, LLC.**  
157 HIGH STREET  
PORTLAND, ME

This Document is the property of Raintree Architecture, Inc. (PFVS) and is to be used only in connection with the project named herein. Reproduction, in whole or in part, shall be allowed only with the express written or verbal permission from the architect. Drawing scales as shown are valid on the original sized document which is 36 by 42 inches. © 2013 Raintree Architecture, Inc. d/b/a PFVS Architecture.

Sheet Title:

**B-1 BASEMENT  
FLOOR PLAN**

Job Number:	11009
Scale:	1/8" = 1'-0"
Drawn:	JP
Checked:	AR
Date:	Nov. 21, 2011

PERMIT SET - RELEASED  
FOR CONSTRUCTION

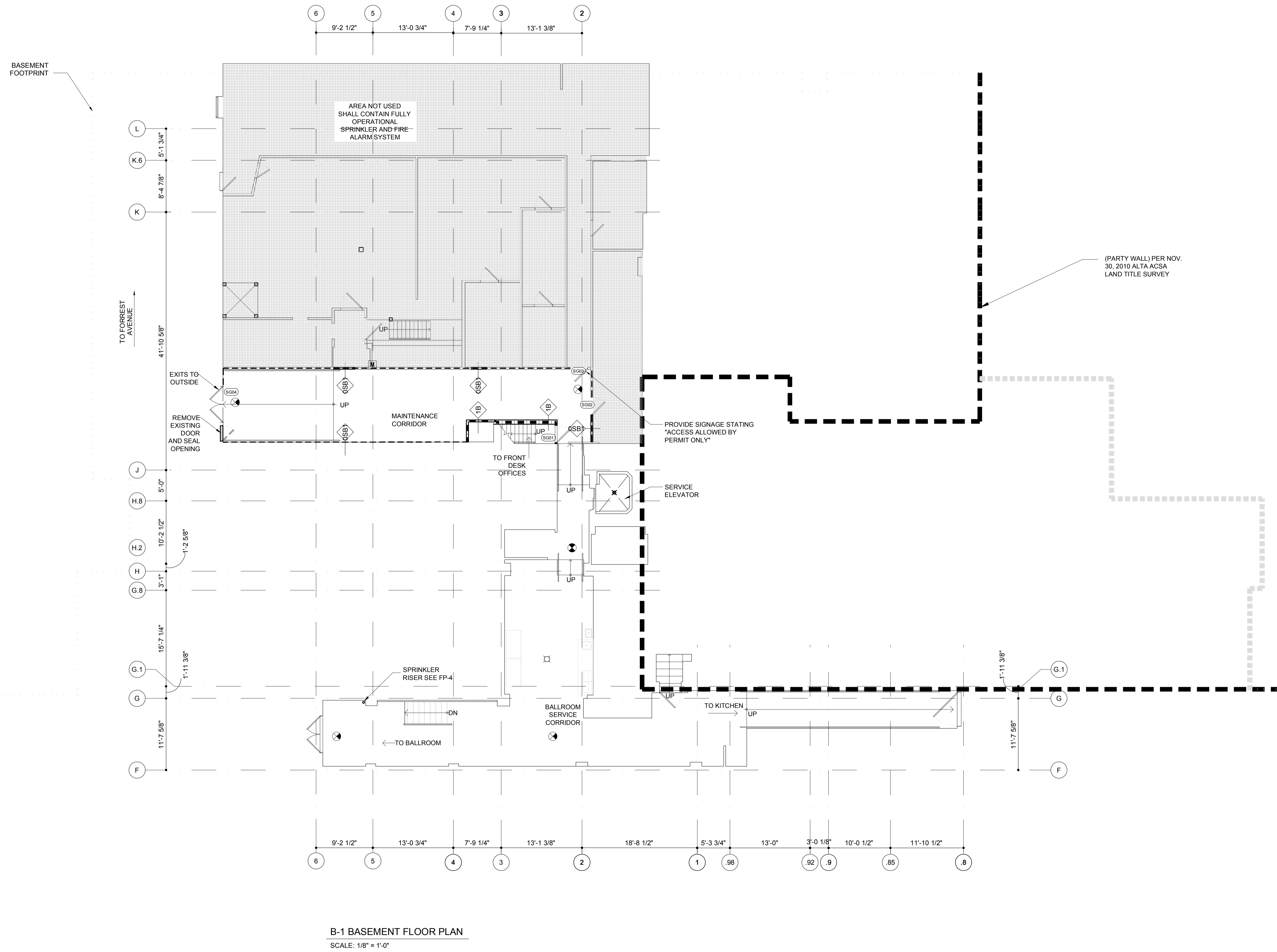

**B-1 BASEMENT FLOOR PLAN**  
SCALE: 1/8" = 1'-0"

**WALL LEGEND**

—	EXISTING
—	NEW
- - -	SMOKE BARRIER
- - -	1 HOUR
- - -	2 HOUR
---	EXISTING DEMISING

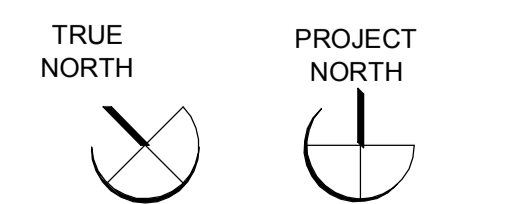

**HANDRAILS PROVIDED ON BOTH SIDES OF ALL RAMPS**