

CABLES AND FENCING NOT SHOWN FOR CLARITY

BARRIER CABLE DETAILS
1"=1'-0"

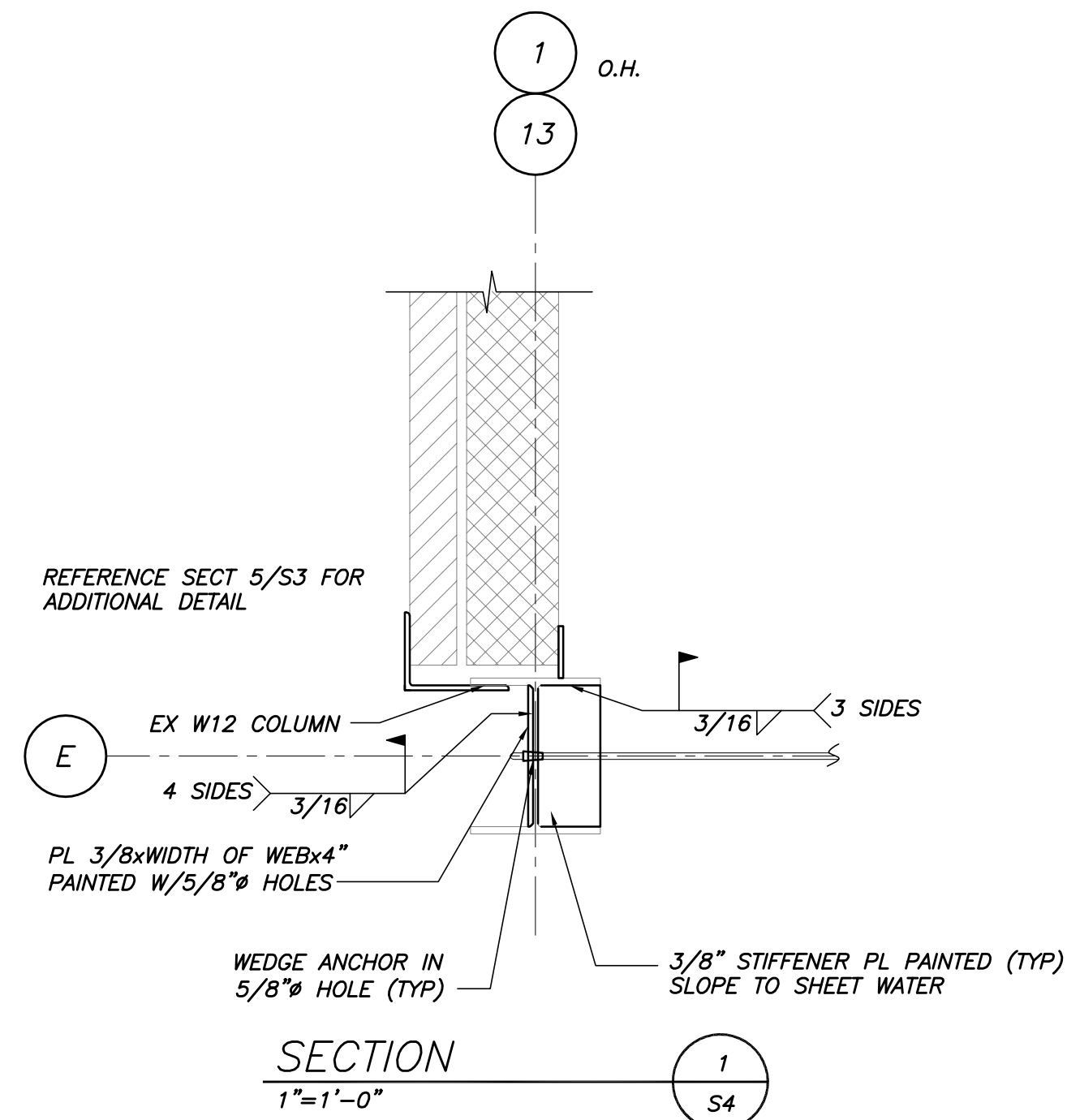

GUARDRAIL CABLE NOTES

1. ALL WORK SHALL CONFORM TO THE POST TENSIONING INSTITUTES (PTI) GUIDE SPECIFICATION "SPECIFICATION FOR SEVEN-WIRE PRESTRESSING STEEL STRAND FOR BARRIER CABLE APPLICATIONS."
2. ALL STRAND SHALL BE 1/2"Ø GRADE 250 (MINIMUM) AND GALVANIZED PER ASTM A 475 CLASS A.
3. ALL WEDGE TYPE ANCHORS SHALL BE CAPABLE OF DEVELOPING 95% OF THE MINIMUM ULTIMATE BREAKING STRENGTH OF THE BARRIER CABLE.
4. BARRIER CABLE INSTALLATION SHALL BE PERFORMED BY PTI CERTIFIED INSTALLERS.
5. INSTALLATION:
 - A. THE SYSTEM SHALL BE A MINIMUM OF 42 INCHES IN HEIGHT AND BE CONSTRUCTED SUCH THAT A 4"Ø SPHERE SHALL NOT PASS THROUGH ANY OPENING.
 - B. PROPERLY CALIBRATED STRESSING EQUIPMENT SHALL BE SUPPLIED FOR THE PARTICULAR APPLICATION AND BARRIER CABLE SYSTEM THAT IS NECESSARY TO PERFORM THE WORK.
 - C. AT INTERMEDIATE COLUMNS, PROVIDE A HOLE WHICH IS A MINIMUM OF 1/8"Ø LARGER THAN THE BARRIER STRAND DIAMETER USED (INCLUDING COATING).
 - D. ALL ANCHORAGES SHALL BE BACKSTRESSED. THE CABLE SHALL BE STRESSED TO 80% OF MINIMUM ULTIMATE TENSILE STRENGTH (MUTS). ANY DAMAGE TO CABLE COATINGS DUE TO THIS PROCESS SHALL BE REPAIRED WITH 2 COATS OF ZRC COLD GALVANIZING.
 - E. BARRIER CABLE TAILS SHALL BE REMOVED TO WITHIN 1" OF END OF ANCHORS USING A METAL CUT-OFF SAW OR A HYDRAULIC SHEAR. ALL ENDS SHALL BE COATED WITH 2 COATS OF ZRC COLD GALVANIZING.
 - F. JACK CABLES AS REQUIRED TO BACKSTRESS AND SEAT ANCHORS.
 - G. PRETENSION CABLES TO A MINIMUM OF 3,000 LBS.

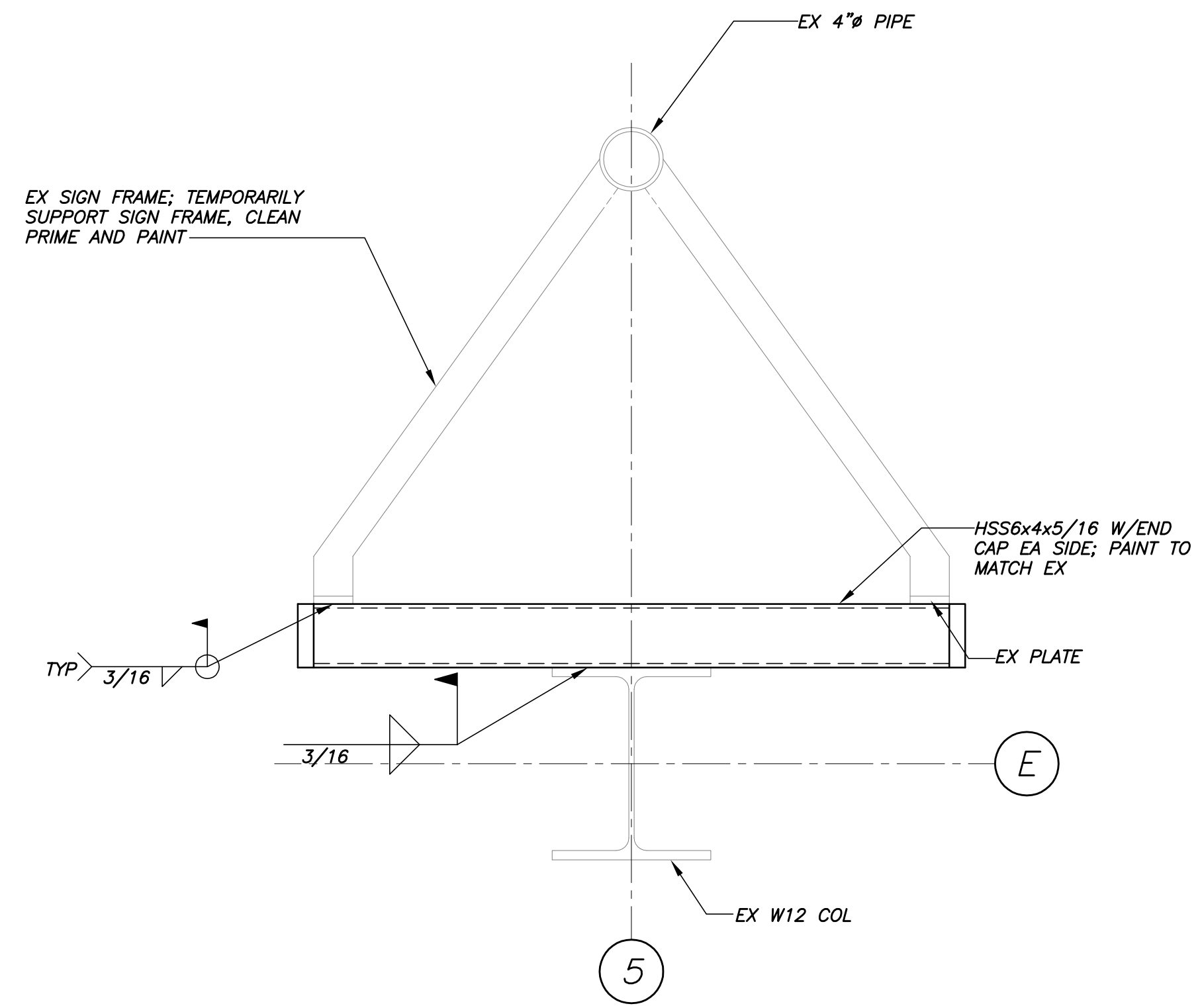

SECTION
1 1/2"=1'-0"

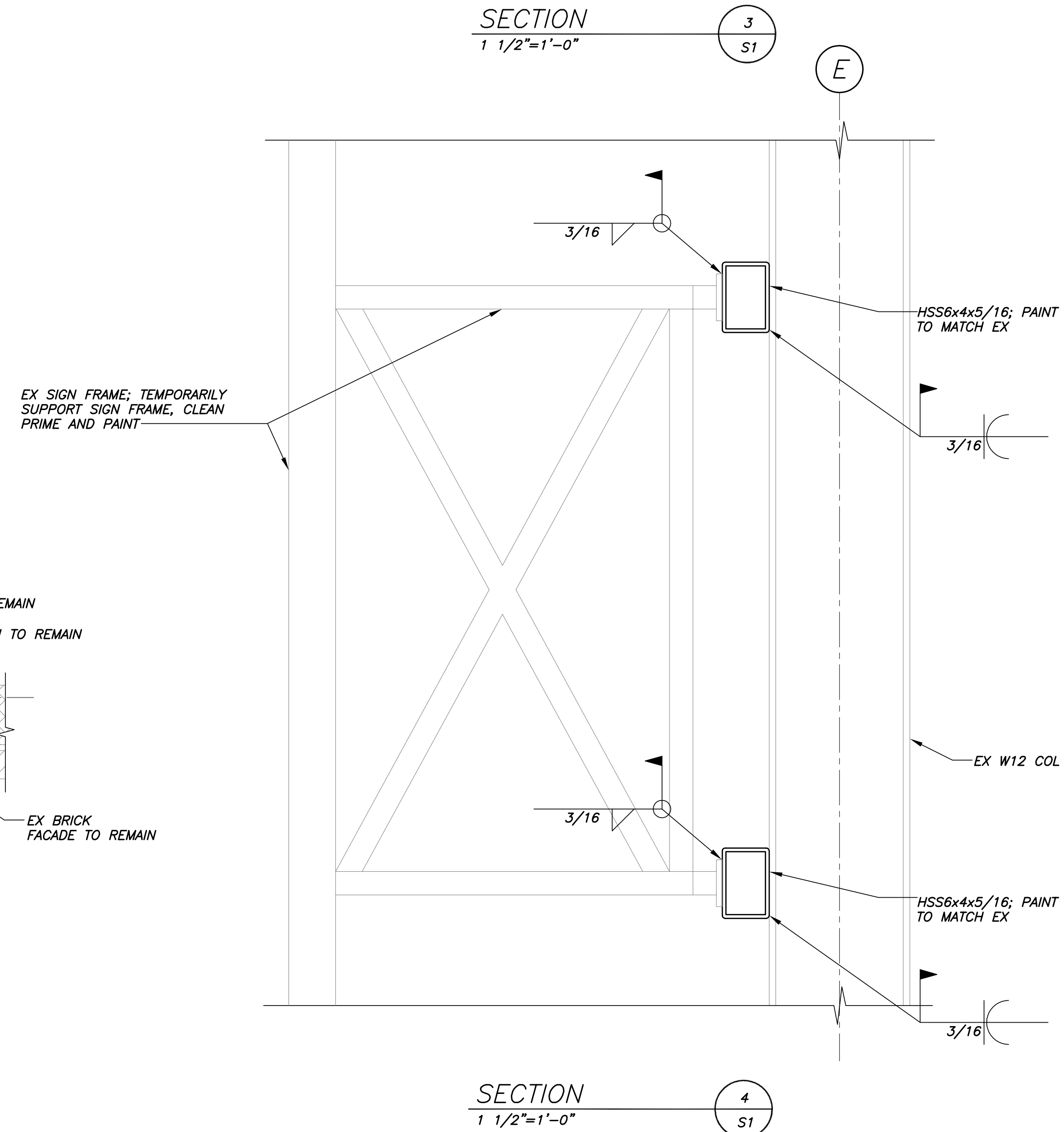

SECTION
1 1/2"=1'-0"

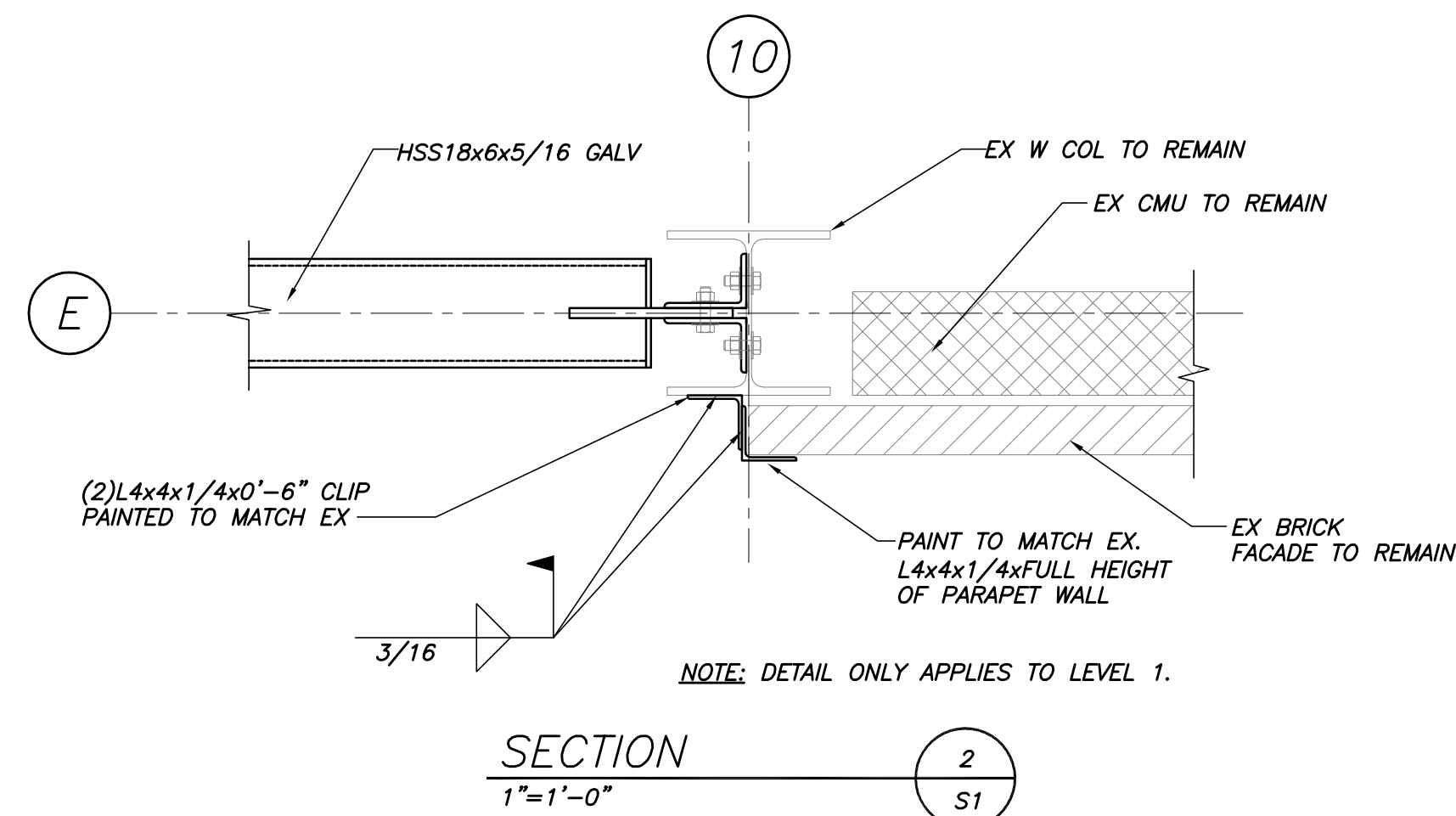

SECTION
1"=1'-0"

NOTE: DETAIL ONLY APPLIES TO LEVEL 1.

THIS DRAWING IS AN INSTRUMENT OF SERVICE AND SHALL REMAIN THE PROPERTY OF BECKER STRUCTURAL ENGINEERS INC. IT SHALL NOT BE REPRODUCED, COPIED, LENT OR DISPOSED OF DIRECTLY OR INDIRECTLY, NOR USED FOR ANY PURPOSE OTHER THAN FOR WHICH IT IS SPECIFICALLY FURNISHED AND MUST BE RETURNED TO BECKER STRUCTURAL ENGINEERS INC. ON COMPLETION OF WORK, IF REQUESTED.

Approved	
Issued For	FOR BID FOR PERMIT
Date	5/27/15
Rev. No	6/30/15

GATEWAY PARKING GARAGE
PORTLAND, MAINE
FACADE REPAIRS PHASE 1
SECTIONS

Designed	JMM	Scale	AS NOTED
Drawn	ATS	Date	5/27/15
Checked	TMN	Becker Job Number	3521