

Main Level
SCALE: 1/4"=1'-0"

Total sq. ft. this floor: 1158

Room	Floor	Walls	Ceiling	Notes
100 - Dining	Existing Wood - refinish	Existing Plaster - paint	Existing tin - paint	Decorative wood wall treatment TBD
101 - Kitchen	New vinyl or linoleum non-slip sheetgood	Apply stainless sheet over existing plaster up to 6'-0"	Existing tin - paint	
102 - Bar	New vinyl or linoleum non-slip sheetgood	Apply stainless sheet over GWB to underside of bartop	Existing tin - paint	
103 - Hall	Existing Wood - refinish	Existing GWB - paint	Existing GWB - paint	patch and paint as needed
104 - WC 1	Existing to remain	Existing GWB - paint	Existing GWB - paint	
105 - WC 2	Existing to remain	Existing GWB - paint	Existing GWB - paint	patch and paint as needed
106 - DISH	New vinyl or linoleum non-slip sheetgood	Apply stainless sheet over existing GWB up to 48"	Existing GWB - paint	
107 - PREP	New vinyl or linoleum non-slip sheetgood	Apply stainless sheet over existing GWB up to 48"	Existing GWB - paint	
108 - Stair	Existing Wood - paint	Existing GWB - paint	Existing GWB - paint	
200 - Private Function	Existing Wood - refinish	Existing Plaster - paint	Existing GWB - paint	Fire-rated sound attenuation panels TBD

Door	Room	Door Type	Size	Manufacturer	Type	Material	Finish	Hardware
100.1	Dining	Entry (existing)	3'-0" x 6'-8"			metal & glass		Existing - Entry
104.1	WC 1	1-panel	3'-0" x 6'-8"			Wood	Paint	Existing - Privacy
105.1	WC 2	1-panel	2'-8" x 6'-8"			Wood	Paint	Existing - Privacy
106.1	DISH	1-panel	3'-0" x 6'-8"	TBD	A	wood		swinging door
106.2	exit	fire exit (existing)	3'-0" x 6'-8"			metal & glass		Existing - Exit - reverse swing add exit hardware if needed

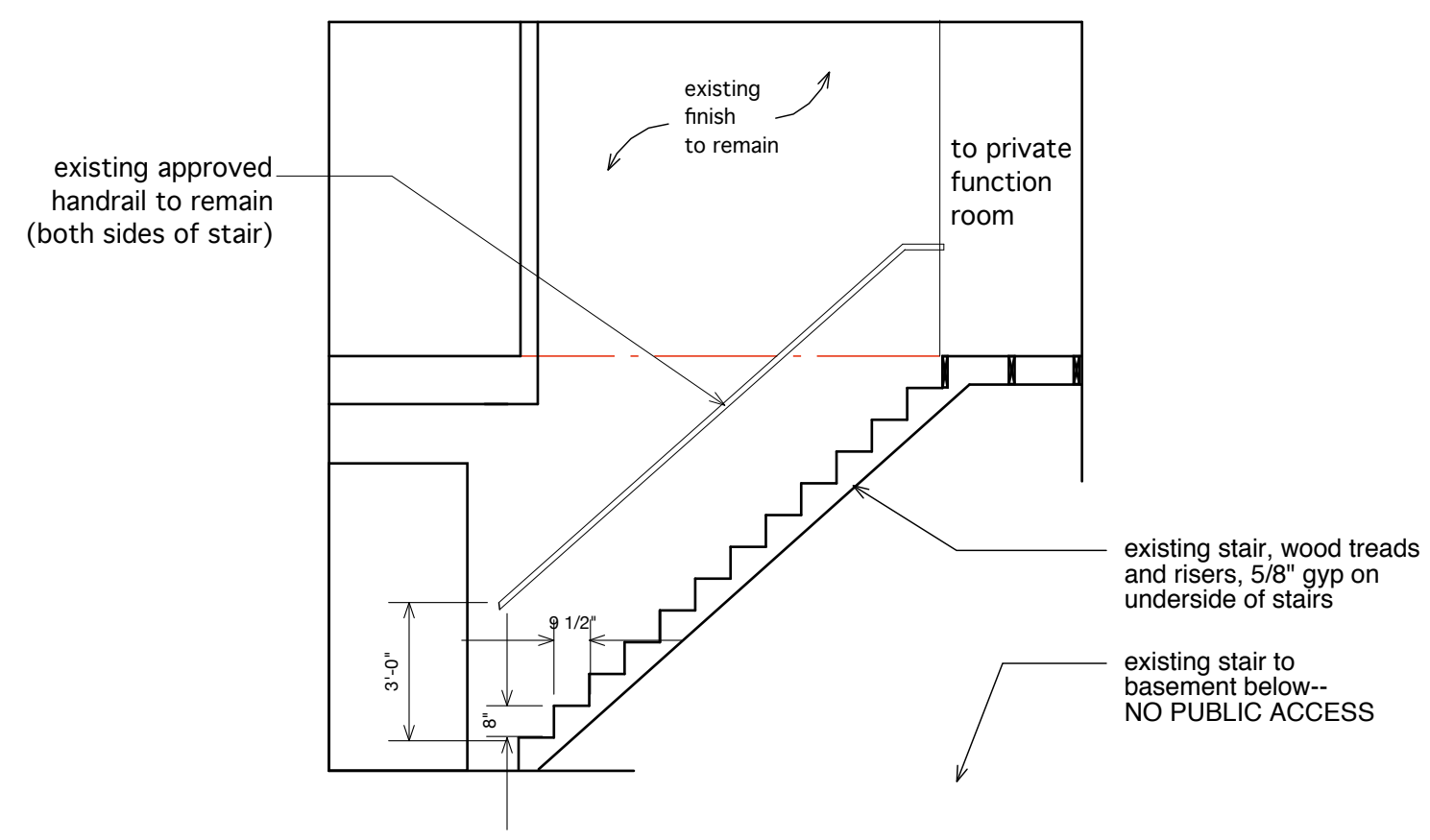

Section A-A
SCALE: 1/4"=1'-0"

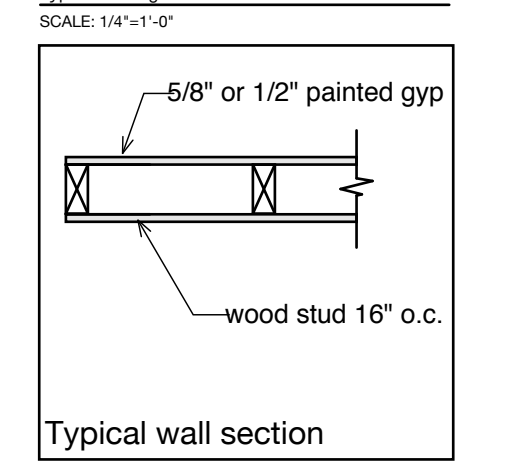
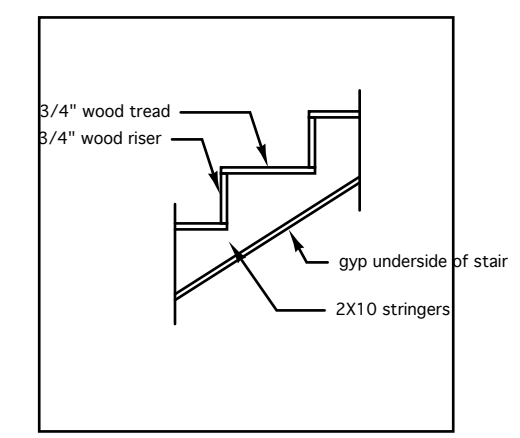

1 New Wall Type (unless otherwise noted)

NOTE:

Electrical:
To be revised as needed, all work to comply with code. Separate electrical permitting application to be submitted by contractor.

Lighting:
Existing lighting to remain.

Plumbing:
Existing piping and fixtures to be reused when possible, all work to comply with current codes. Separate permitting application to be submitted by contractor.

Sprinklers:
Existing sprinkler system to remain, heads to be relocated as shown

PERMIT SET - NOT FOR CONSTRUCTION

A-1.1

Plans
Plot Plan
Schedules
Wall Types

Vinland Restaurant
593 Congress St.

DATE: 3.20.11 SCALE: As noted