

City of Portland, Maine - Building or Use Permit Application

389 Congress Street, 04101 Tel: (207) 874-8703, Fax: (207) 874-8716

Permit No: 01-1159	ISSUED PERMIT ISSUED OCT 1 2001	CEB: 037 D003001
Owner Name: Pride Properties Inc	Owner Address: 5 Maccabe Rd	Phone:
Business Name: Same	Contractor Name: no contractor/self	Contractor Address: n/a n/a
Lessee/Buyer's Name: Polly Smith	Phone: 408-1411	Permit Type: Signs - Permanent
Past Use: Comm. / Pet Grooming	Proposed Use: Same : Erect a 16 SqFt Sign	Permit Fee: Cost of Work: \$0.00 CEO District: 2
Proposed Project Description: Erect a 16 SqFt Sign		FIRE DEPT: <input type="checkbox"/> Approved <input type="checkbox"/> Denied INSPECTION: <input checked="" type="checkbox"/> Approved <input type="checkbox"/> Denied Use Group: Signage PERMIT ISSUED WITH REQUIREMENTS Signature: <i>[Signature]</i>
Permit Taken By: cjh		Date Applied For: 09/19/2001
Zoning Approval		
Action: <input type="checkbox"/> Approved <input type="checkbox"/> Approved w/Conditions <input checked="" type="checkbox"/> Denied		Signature: <i>[Signature]</i> Date: N/A

Location of Construction: 364 Cumberland Ave	Owner Name: Pride Properties Inc	Owner Address: 5 Maccabe Rd	Phone:
Business Name: Same	Contractor Name: no contractor/self	Contractor Address: n/a n/a	Phone:
Lessee/Buyer's Name: Polly Smith	Phone: 408-1411	Permit Type: Signs - Permanent	Zone: B-3
Past Use: Comm. / Pet Grooming	Proposed Use: Same : Erect a 16 SqFt Sign	Permit Fee: Cost of Work: \$0.00 CEO District: 2	
Proposed Project Description: Erect a 16 SqFt Sign		FIRE DEPT: <input type="checkbox"/> Approved <input type="checkbox"/> Denied INSPECTION: <input checked="" type="checkbox"/> Approved <input type="checkbox"/> Denied Use Group: Signage PERMIT ISSUED WITH REQUIREMENTS Signature: <i>[Signature]</i>	
Permit Taken By: cjh		Date Applied For: 09/19/2001	
Zoning Approval			
Action: <input type="checkbox"/> Approved <input type="checkbox"/> Approved w/Conditions <input checked="" type="checkbox"/> Denied		Signature: <i>[Signature]</i> Date: N/A	

<p>1. This permit application does not preclude the Applicant(s) from meeting applicable State and Federal Rules.</p> <p>2. Building permits do not include plumbing, septic or electrical work.</p> <p>3. Building permits are void if work is not started within six (6) months of the date of issuance. False information may invalidate a building permit and stop all work..</p>	<p>Special Zone or Reviews</p> <input type="checkbox"/> Shoreland <input type="checkbox"/> Wetland <input type="checkbox"/> Flood Zone <input type="checkbox"/> Subdivision <input type="checkbox"/> Site Plan Maj <input type="checkbox"/> Minor <input type="checkbox"/> MM <input type="checkbox"/> Date: <i>OKS</i> 9/27/01	<p>Zoning Appeal</p> <input type="checkbox"/> Variance <input type="checkbox"/> Miscellaneous <input type="checkbox"/> Conditional Use <input type="checkbox"/> Interpretation <input type="checkbox"/> Approved <input type="checkbox"/> Denied Date:	<p>Historic Preservation</p> <input checked="" type="checkbox"/> Not in District or Landmark <input type="checkbox"/> Does Not Require Review <input type="checkbox"/> Requires Review <input type="checkbox"/> Approved <input type="checkbox"/> Approved w/Conditions <input type="checkbox"/> Denied Date: <i>[Signature]</i>
	<p>PERMIT ISSUED WITH REQUIREMENTS</p>		

CERTIFICATION

I hereby certify that I am the owner of record of the named property, or that the proposed work is authorized by the owner of record and that I have been authorized by the owner to make this application as his authorized agent and I agree to conform to all applicable laws of this jurisdiction. In addition, if a permit for work described in the application is issued, I certify that the code official's authorized representative shall have the authority to enter all areas covered by such permit at any reasonable hour to enforce the provision of the code(s) applicable to such permit.

SIGNATURE OF APPLICANT	ADDRESS	DATE	PHONE
RESPONSIBLE PERSON IN CHARGE OF WORK, TITLE		DATE	PHONE

THIS IS NOT A PERMIT/CONSTRUCTION MAY NOT COMMENCE UNTIL THE PERMIT IS ISSUED

SIGNAGE APPLICATION

01-11-59

THIS IS NOT A PERMIT
CONSTRUCTION CANNOT NOT COMMENCE UNTIL THE PERMIT IS ISSUED

In the interest of processing your application in the quickest possible manner, please complete the Information below for a Building or Use Permit.

If you or the property owner owes real estate or personal property taxes or user charges on any property within the City, payment arrangements must be made before permits of any kind are accepted.

Location/Address of Construction: 364 Cumberland Ave., Portland, Me. 04101		
Total Square Footage of Proposed Structure 16	Square Footage of Lot	
Tax Assessor's Chart, Block & Lot Number Chart# 37 Block# D Lot# 3	Owner: JIM MARKS K10C2K0	Telephone #: 207.541.3647
Lessee/Buyer's Name (If Applicable) Polly Smith	Owner's/Purchaser/Lessee Address: 538 Cumberland Ave. Portland, Me. 04101	Total s.f of signs 16 x .20 \$ 320, plus \$30.00 TOTAL \$ 35.20
Current use: empty Proposed use: Pet Grooming		
Project description: erect an 8' x 2' sign		
Applicants Name, Address & Telephone: Polly Smith, 538 Cumberland Ave. Portland, Me. 04101		
Contractor's Name, Address & Telephone:		
Who shall we contact when the permit is ready: Polly Smith		
Telephone: 207.408.1411		
If you would like it mailed, what mailing address should we use:		
		Rec'd By: 9/17 CH PN

**THIS IS NOT A PERMIT/CONSTRUCTION MAY NOT COMMENCE UNTIL THE
PERMIT IS ISSUED**

If the property is located in a HISTORIC DISTRICT, a separate sketch is required indicating the design, dimensions, construction materials and source of illumination if any. A photograph of the building façade should be submitted, showing where each sign is to be installed.

Certification

I hereby certify that I am the Owner of record of the named property, or that the owner of record authorizes the proposed work and that I have been authorized by the owner to make this application as his/her authorized agent. I agree to conform to all applicable laws of this jurisdiction. In addition, if a permit for work described in this application is issued, I certify that the Code Official's authorized representative shall have the authority to enter all areas covered by this permit at any reasonable hour to enforce the provisions of the codes applicable to this permit.

Signature of applicant: 	Date: 9.18.01
---	---------------

Sign Permit Fee: \$30.00 plus \$0.20 per square foot.

A building permit is also required for any awning based on cost of work-\$30.00 for the first \$1,000.00 and \$6.00 for each additional \$1,000.00

**BY FILLING OUT THIS APPLICATION IS DOES NOT MEET THAT
YOU WILL BE APPROVED FOR THE AMOUNT OF SIGNAGE YOU
ARE APPLYING FOR**

**IT IS SUGGESTED THAT YOU DO NOT ORDER ANY SIGNAGE UNTIL
YOU HAVE RECEIVED YOUR SIGN PERMIT THAT HAS BEEN
SIGNED BY THE BUILDING, ZONING AND POSSIBLE HISTORICAL
OFFICIALS OF THIS OFFICE**

BUILDING PERMIT REPORT

DATE: 21 September 2008 ADDRESS: 364 Cumberland Ave. CBL: 037-D-003

REASON FOR PERMIT: Signage

BUILDING OWNER: Pride Properties Inc.

PERMIT APPLICANT: _____ /CONTRACTOR _____

USE GROUP: _____ CONSTRUCTION TYPE: _____ CONSTRUCTION COST: _____ PERMIT FEES: \$320

The City's Adopted Building Code (The BOCA National Building Code/1999 with City Amendments)
The City's Adopted Mechanical Code (The BOCA National Mechanical Code/1993)

CONDITION(S) OF APPROVAL

This permit is being issued with the understanding that the following conditions shall be met: *1, *37

- *1. This permit does not excuse the applicant from meeting applicable State and Federal rules and laws.
- 2. Before concrete for foundation is placed, approvals from the Development Review Coordinator and Inspection Services must be obtained. (A 24 hour notice is required prior to inspection) **"ALL LOT LINES SHALL BE CLEARLY MARKED BEFORE CALLING."**
- 3. Foundation drain shall be placed around the perimeter of a foundation that consists of gravel or crushed stone containing not more than 10 percent material that passes through a No. 4 sieve. The drain shall extend a minimum of 12 inches beyond the outside edge of the footing. The thickness shall be such that the bottom of the drain is not higher than the bottom of the base under the floor, and that the top of the drain is not less than 6 inches above the top of the footing. The top of the drain shall be covered with an approved filter membrane material. Where a drain tile or perforated pipe is used, the invert of the pipe or tile shall not be higher than the floor elevation. The top of joints or top of perforations shall be protected with an approved filter membrane material. The pipe or tile shall be placed on not less than 2" of gravel or crushed stone, and shall be covered with not less than 6" of the same material. Section 1813.5.2
- 4. Foundations anchors shall be a minimum of 1/2" in diameter, 7" into the foundation wall, minimum of 12" from corners of foundation and a maximum 6' O.C. between bolts. Section 2305.17
- 5. Waterproofing and dampproofing shall be done in accordance with Section 1813.0 of the building code.
- 6. Precaution must be taken to protect concrete and masonry. Concrete Sections 1908.9-19.8.10/ Masonry Sections 2111.3-2111.4.
- 7. It is strongly recommended that a registered land surveyor check all foundation forms before concrete is placed. This is done to verify that the proper setbacks are maintained.
- 8. Private garages located beneath habitable rooms in occupancies in Use Group R-1, R-2, R-3 or I-1 shall be separated from adjacent interior spaces by fire partitions and floor/ceiling assembly which are constructed with not less than 1-hour fire resisting rating. Private garages attached side-by-side to rooms in the above occupancies shall be completely separated from the interior spaces and the attic area by means of 1/2 inch gypsum board or the equivalent applied to the garage side. (Chapter 4, Section 407.0 of the BOCA/1999)
- 9. All chimneys and vents shall be installed and maintained as per Chapter 12 of the City's Mechanical Code. (The BOCA National Mechanical Code/1993). Chapter 12 & NFPA 211
- 10. Sound transmission control in residential building shall be done in accordance with Chapter 12, Section 1214.0 of the City's Building Code.
- 11. Guardrails & Handrails: A guardrail system is a system of building components located near the open sides of elevated walking surfaces for the purpose of minimizing the possibility of an accidental fall from the walking surface to the lower level. Minimum height all Use Groups 42". In occupancies in Use Group A, B,H-4, I-1, I-2, M, R, public garages and open parking structures, open guards shall have balusters or be of solid material such that a sphere with a diameter of 4" cannot pass through any opening. Guards shall not have an ornamental pattern that would provide a ladder effect. Handrails shall be a minimum of 34" but not more than 38". Exception: Handrails that form part of a guard shall have a height not less than 36 inches (914 mm) and not more than 42 inches (1067 mm). Handrail grip size shall have a circular cross section with an outside diameter of at least 1 1/4" and not greater than 2". (Sections 1021 & 1022.0). Handrails shall be on both sides of stairway. (Section 1014.7) **R-3 (ONE & TWO FAMILY DWELLINGS) GUARD HEIGHT IS 36" MINIMUM.**
- 12. Headroom in habitable space is a minimum of 7'6". (Section 1204.0)
- 13. Stair construction in Use Group R-3 & R-4 is a minimum of 10" tread and 7 3/4" maximum rise. All other Use Group minimum 11" tread, 7" maximum rise. (Section 1014.0)
- 14. The minimum headroom in all parts of a stairway shall not be less than 80 inches. (6'8") 1014.4
- 15. The Minimum required width of a corridor shall be determined by the most restrictive of the criteria under section 1011.3 but not less than 36".
- 16. Every sleeping room below the fourth story in buildings of Use Groups R and I-1 shall have at least one operable window or exterior door approved for emergency egress or rescue. The units must be operable from the inside without the use of special knowledge or separate tools. Where windows are provided as means of egress or rescue they shall have a sill height not more than 44 inches (1118mm) above the floor. All egress or rescue windows from sleeping rooms shall have a minimum net clear opening height dimension of 24 inches (610mm). The minimum net clear opening width dimension shall be 20 inches (508)mm, and a minimum net clear opening of 5.7 sq. ft. (Section 1010.4)
- 17. Each apartment shall have access to two (2) separate, remote and approved means of egress. A single exit is acceptable when it exits directly from the apartment to the building exterior with no communications to other apartment units. (Section 1010.1)
- 18. All vertical openings shall be enclosed with construction having a fire rating of at least one (1) hour, including fire doors with self closure's. (Over 3 stories in height requirements for fire rating is two (2) hours. (Section 710.0)
- 19. The boiler shall be protected by enclosing with (1) hour fire rated construction including fire doors and ceiling, or by providing automatic extinguishment. (Table 302.1.1)

20. All single and multiple station smoke detectors shall be of an approved type and shall be installed in accordance with the provisions of the City's Building Code Chapter 9, Section 920.3.2 (BOCA National Building Code/1999), and NFPA 101 Chapter 18 & 19. (Smoke detectors shall be installed and maintained at the following locations):
 - In the immediate vicinity of bedrooms
 - In all bedrooms
 - In each story within a dwelling unit, including basements
21. A portable fire extinguisher shall be located as per NFPA #10. They shall bear the label of an approved agency and be of an approved type. (Section 921.0)
22. The Fire Alarm System shall be installed and maintained to NFPA #72 Standard.
23. The Sprinkler System shall be installed and maintained to NFPA #13 Standard.
24. All exit signs, lights and means of egress lighting shall be done in accordance with Chapter 10 Section & Subsections 1023.0 & 1024.0 of the City's Building Code. (The BOCA National Building Code/1999)
25. Section 25 - 135 of the Municipal Code for the City of Portland states, "No person or utility shall be granted a permit to excavate or open any street or sidewalk from the time of November 15 of each year to April 15 of the following year".
26. The builder of a facility to which Section 4594-C of the Maine State Human Rights Act Title 5 MRSA refers, shall obtain a certification from a design professional that the plans commencing construction of the facility, the builder shall submit the certification the Division of Inspection Services.
27. Ventilation and access shall meet the requirements of Chapter 12 Sections 1210.0 and 1211.0 of the City's Building Code. (Crawl spaces & attics).
28. All electrical, plumbing and HVAC permits must be obtained by Master Licensed holders of their trade. No closing in of walls until all electrical (min. 72 hours notice) and plumbing inspections have been done.
29. All requirements must be met before a final Certificate of Occupancy is issued.
30. All building elements shall meet the fastening schedule as per Table 2305.2 of the City's Building Code (The BOCA National Building Code/1996).
31. Ventilation of spaces within a building shall be done in accordance with the City's Mechanical code (The BOCA National Mechanical Code/1993). (Chapter M-16)
32. Please read and implement the attached Land Use Zoning report requirements.
33. Boring, cutting and notching shall be done in accordance with Sections 2305.3, 2305.3.1, 2305.4.4 and 2305.5.1 of the City's Building Code.
34. Bridging shall comply with Section 2305.16.
35. Glass and glazing shall meet the requirements of Chapter 24 of the building code. (Safety Glazing Section 2406.0)
36. All flashing shall comply with Section 1406.3.10.
- X-37. All signage shall be done in accordance with Section 3102.0 signs of the City's Building Code, (The BOCA National Building Code/1999).
(See attached)

 P. Samuel Hibbs, Building Inspector
 Cc: Lt. McDougall, PFD
 Marge Schmuckal, Zoning Administrator
 Michael Nugent, Inspection Service Manager

PSH 10/1/00

****This permit is herewith issued, on the basis of plans submitted and conditions placed on these plans, any deviations shall require a separate approval.**

*****THIS PERMIT HAS BEEN ISSUED WITH THE UNDERSTANDING THAT ALL THE CONDITIONS OF THE APPROVAL SHALL BE COMPLETED. THEREFORE, BEFORE THE WORK IS COMPLETED A REVISED PLAN OR STATEMENT FROM THE PERMIT HOLDER SHALL BE SUBMITTED TO THIS OFFICE SHOWING OR EXPLAINING THAT THE CONDITIONS HAVE BEEN MET. IF THIS REQUIREMENT IS NOT RECEIVED YOUR CERTIFICATE OF OCCUPANCY SHALL BE WITHHELD. (You Shall Call for Inspections)**

******ALL PLANS THAT REQUIRE A PROFESSIONAL DESIGNER'S SEAL, (AS PER SECTION 114.0 OF THE BUILDING CODE) SHALL ALSO BE PRESENTED TO THIS DIVISION ON AUTO CAD LT. 2000, DXF FORMAT OR EQUIVALENT.**

*******CERTIFICATE OF OCCUPANCY FEE \$50.00**

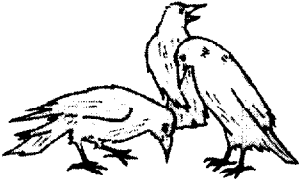

Three Crows, Inc.

31 Forest Road • Cape Elizabeth, ME 04107 • Ph/Fx(207) 767-1079

September 18, 2001

Polly Smith
c/o PetTacular
364 Cumberland Ave.
Portland, ME 04101

Dear Polly:

You have our permission to place signage on and in front of the building on 362-364 Cumberland Avenue related to the advertising of PetTacular. These signs should be consistent with the style already in use by other businesses in the building.

Sincerely,

A handwritten signature in cursive script that reads "Jim Kloczko". The signature is fluid and somewhat stylized, with a long tail on the final letter.

Jim Kloczko

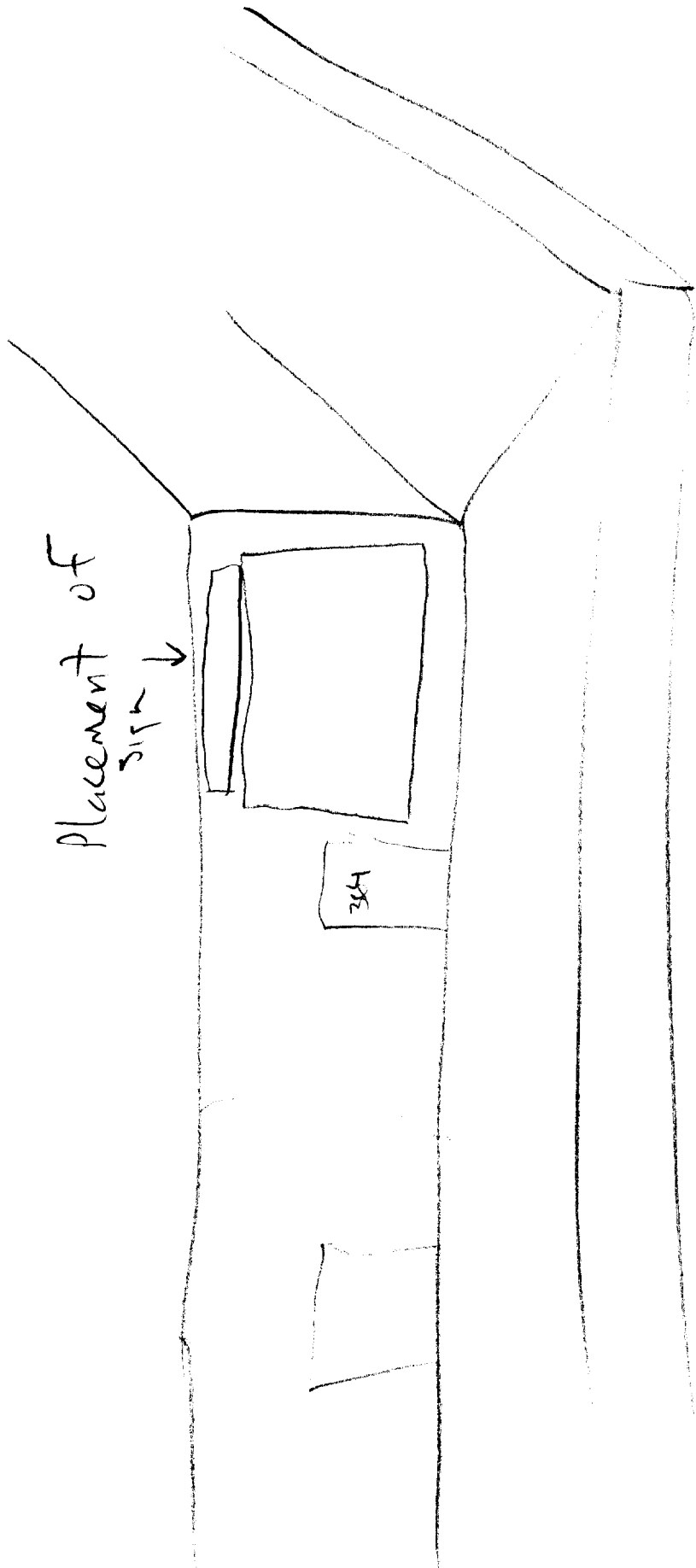

Placement of
sign ↓

384

- attached securely to outside building with sign brackets.

8

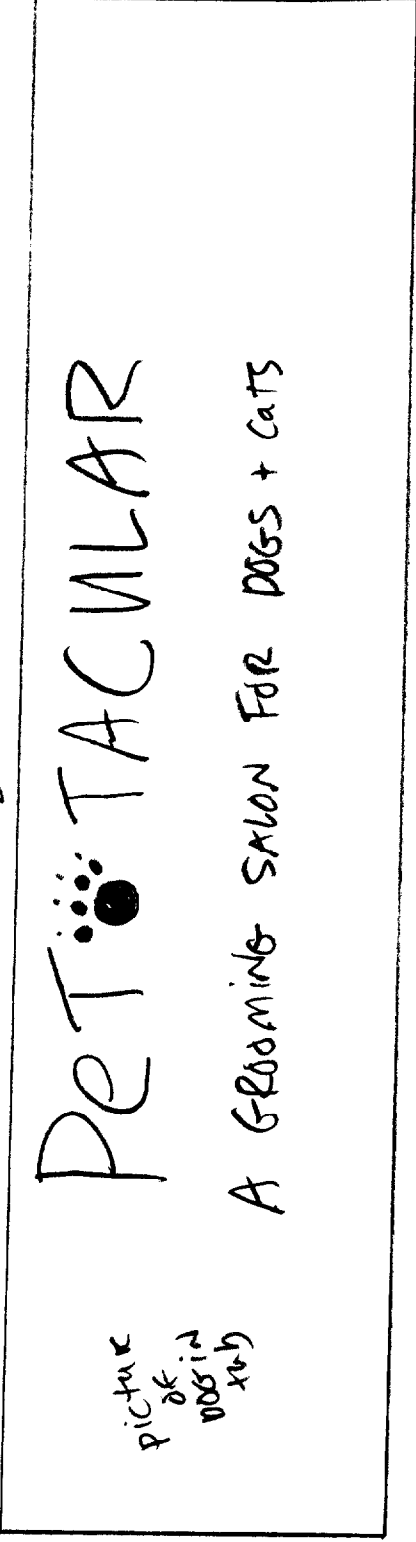

picture
of
dog in
shop

2

ACORD INSURANCE BINDER

DATE
09/17/2001

THIS BINDER IS A TEMPORARY INSURANCE CONTRACT, SUBJECT TO THE CONDITIONS SHOWN ON THE REVERSE SIDE OF THIS FORM.

PRODUCER Rousseau Insurance Agency 334 Elm Street PO Box 303 Biddeford, ME 04005-0303	PHONE (A/C, No, Ext): (207) 282-7568 FAX (207) 282-7560	COMPANY Allstate Insurance	BINDER # B01091704796
CODE: 266422	SUB CODE:	THIS BINDER IS ISSUED TO EXTEND COVERAGE IN THE ABOVE NAMED COMPANY PER EXPIRING POLICY #:	
AGENCY CUSTOMER ID: 00002649	DESCRIPTION OF OPERATIONS/VEHICLES/PROPERTY (Including Location) A pet grooming business located at 364 Cumberland Ave Portland Me 04101		
INSURED Polly Smith DBA Pet-Tacular 364 Cumberland Ave Portland, Me 04101			

COVERAGES

LIMITS

TYPE OF INSURANCE	COVERAGE/FORMS	DEDUCTIBLE	COINS %	AMOUNT
PROPERTY CAUSES OF LOSS <input type="checkbox"/> BASIC <input type="checkbox"/> BROAD <input checked="" type="checkbox"/> SPEC	Special Form	500	100	10,000
GENERAL LIABILITY <input checked="" type="checkbox"/> COMMERCIAL GENERAL LIABILITY <input type="checkbox"/> CLAIMS MADE <input type="checkbox"/> OCCUR	RETRO DATE FOR CLAIMS MADE:	EACH OCCURRENCE		\$ 500,000
		FIRE DAMAGE (Any one fire)		\$ 100,000
		MED EXP (Any one person)		\$ 5,000
		PERSONAL & ADV INJURY		\$
		GENERAL AGGREGATE		\$
		PRODUCTS - COMP/OP AGG		\$
AUTOMOBILE LIABILITY <input type="checkbox"/> ANY AUTO <input type="checkbox"/> ALL OWNED AUTOS <input type="checkbox"/> SCHEDULED AUTOS <input type="checkbox"/> HIRED AUTOS <input type="checkbox"/> NON-OWNED AUTOS	RETRO DATE FOR CLAIMS MADE:	COMBINED SINGLE LIMIT		\$
		BODILY INJURY (Per person)		\$
		BODILY INJURY (Per accident)		\$
		PROPERTY DAMAGE		\$
		MEDICAL PAYMENTS		\$
		PERSONAL INJURY PROT		\$
		UNINSURED MOTORIST		\$
				\$
AUTO PHYSICAL DAMAGE DEDUCTIBLE <input type="checkbox"/> COLLISION: _____ <input type="checkbox"/> OTHER THAN COL: _____	<input type="checkbox"/> ALL VEHICLES <input type="checkbox"/> SCHEDULED VEHICLES	ACTUAL CASH VALUE		
		STATED AMOUNT		\$
		OTHER		
GARAGE LIABILITY <input type="checkbox"/> ANY AUTO	RETRO DATE FOR CLAIMS MADE:	AUTO ONLY - EA ACCIDENT		\$
		OTHER THAN AUTO ONLY:		
		EACH ACCIDENT		\$
		AGGREGATE		\$
EXCESS LIABILITY <input type="checkbox"/> UMBRELLA FORM <input type="checkbox"/> OTHER THAN UMBRELLA FORM	RETRO DATE FOR CLAIMS MADE:	EACH OCCURRENCE		\$
		AGGREGATE		\$
		SELF-INSURED RETENTION		\$
WORKER'S COMPENSATION AND EMPLOYER'S LIABILITY		WC STATUTORY LIMITS		
		E.L. EACH ACCIDENT		\$
		E.L. DISEASE - EA EMPLOYEE		\$
		E.L. DISEASE - POLICY LIMIT		\$
SPECIAL CONDITIONS/ OTHER COVERAGES		FEES		\$
		TAXES		\$
		ESTIMATED TOTAL PREMIUM		\$

NAME & ADDRESS

	MORTGAGEE	ADDITIONAL INSURED
	LOSS PAYEE	
	LOAN #	
	AUTHORIZED REPRESENTATIVE	
	Raymond Lambert JR/RPL	