

ELECTRICAL PERMIT

City of Portland, Maine

To the Electrical Inspector, Portland Maine :

The undersigned hereby applies for a permit to make electrical installations in accordance with the laws of Maine, the City of Portland's Electrical Ordinances, National Electrical Code and the following specifications:



Date: _____

Permit #: _____

CBL#: _____

ADDRESS: _____ METER MAKE/MODEL #: _____

CMP Work Order #: _____ OWNER: _____

TENANT: _____ PHONE #: _____

PLEASE HAVE YOUR PERMIT # (OR JOB ID) READY & CALL 874-8703 TO SCHEDULE AN INSPECTION!

TOTAL EACH FEE

OUTLETS:	Receptacles	Switches	Smoke Detector	0.20
FIXTURES:	Incandescent	Flourescent	Strips	0.20
SERVICES:	Overhead	Underground	TTL Amps <800	15.00
			TTL Amps >800	25.00
TEMPORARY SERVICE:	Overhead	Underground	TTL Amps	25.00
METERS:	(Number of)			1.00
MOTORS:	(Number of)			2.00
RESID/COMMER:	Electric Units			1.00
HEATING:	Oil/Gas Units	Interior	Exterior	5.00
APPLIANCES:	Ranges	Cook Tops	Wall Ovens	2.00
	Insta-hot	Water Heaters	Fans	2.00
	Dryers	Disposals	Dishwasher	2.00
	Compactors	Spa	Washing Machine	2.00
	Others (denote)			2.00
MISC. (# of):	Air Cond (Window)			3.00
	Air Cond (Central)		Pools	10.00
	HVAC	EMS	Thermostat	5.00
	Signs			10.00
	Alarms/Resident			5.00
	Alarms/Commer			15.00
	Heavy Duty (CRKT)			2.00
	Alterations			5.00
	Fire Repairs			15.00
	Emergency Lights			1.00
	Emer Generators			20.00
	Circus/Carnival			25.00
PANELS:	Service	Remote	Main	4.00
TRANSFORMER:	0-25 Kva			5.00
	25-200 Kva			8.00
	Over 200 Kva			10.00

MINIMUM COMMERCIAL FEE: \$55.00

MINIMUM RESIDENTIAL FEE: \$45.00

Brief Description of work:

TOTAL DUE:

PLEASE HAVE YOUR PERMIT # (OR JOB ID) READY & CALL 874-8703 TO SCHEDULE AN INSPECTION!

CONTRACTOR INFORMATION:

Contractor Name: _____ Master License #: _____

Address: _____ Limited License #: _____

Telephone & E Mail: _____

Contractor Signature:

PLEASE HAVE YOUR PERMIT # (OR JOB ID) READY & CALL 874-8703 TO SCHEDULE AN INSPECTION!

CBL :



PORTLAND MAINE

Strengthening a Remarkable City, Building a Community for Life • www.portlandmaine.gov

Jeff Levine, AICP, Director
Director of Planning and Urban Development

Tammy Munson
Director, Inspections Division

Electronic Signature and Fee Payment Confirmation

Notice: Your electronic signature is considered a legal signature per state law.

By digitally signing the attached document(s), you are signifying your understanding this is a legal document and your electronic signature is considered a **legal signature** per Maine state law. You are also signifying your intent on paying your fees by the opportunities below.

I, the undersigned, intend and acknowledge that no permit application can be reviewed until payment of appropriate permit fees are **paid in full** to the Inspections Office, City of Portland Maine by method noted below:

Within 24-48 hours, once my complete permit application and corresponding paperwork has been electronically delivered, I intend to **call the Inspections Office** at 207-874-8703 and speak to an administrative representative and provide a credit/debit card over the phone.

Within 24-48 hours, once my permit application and corresponding paperwork has been electronically delivered, I intend to **hand deliver** a payment method to the Inspections Office, Room 315, Portland City Hall.

I intend to deliver a payment method through the U.S. Postal Service mail once my permit paperwork has been electronically delivered.

Applicant Signature:

Date:

I have provided digital copies and sent them on:

Date:

NOTE: All electronic paperwork must be delivered to buildinginspections@portlandmaine.gov or by physical means ie; a thumb drive or CD to the office.

Room 315 - 389 Congress Street- Portland, Maine 04101 (207) 874-8703 - Fax: 874-8716 - TTY: 874-8936

CUSTOMER:
RxANTE
511 Congress Street
Suite 803
Portland, ME. 04101



October 17, 2013

PROPOSED DSX ACCESS CONTROL SYSTEM FOR RXANTE, INC.

This project has been approved by the building leasing manager: Boulos Realty.

The Below described DSX access control system will be installed to provide access control the three office doors for RXANTE at their above referenced office location.

The doors effected are:

The two office entry doors in the interior of the main building offices access hallway.

The One office interior LAN Room door.

This low voltage system will interface with the customer's LAN system; providing both the software suite for RxANTE office door management as well as providing the ability to manage the employee badge/card access control system.

Install the following for RXANTE office:

1- DSX-1022 Package:

- Three door controllers in a small metal controls box; located in the interior office LAN Room
- Three proximity Card readers; One each on the two exterior door frames near the access doors, and one on the interior LAN Room door frame.

1- DSX LAN Module; Located in the LAN Cabinet

3- DSX SWS 150/28 Electronic Power Supply located in the Door control box in the LAN Room

3- HES 1006 Electric Door Strike Assemblies; One for each door, installed in the door frames, and controlled by the DSX System.

These will only provide access into the office and LAN room, from the exterior, when presenting the employee badge.

Egress from the interior to the outside hallways is accomplished conventionally, by turning the existing door handle and walking out as normal.

This is a 24VDC low-voltage system, powered by existing 110vac service within the office. All wiring will be run above the office hung ceiling, and fished within the drywall where required.

Respectfully Submitted,



Mark Dobson
NORTHEAST SECURITY SYSTEMS, INC.
Systems Design and Sales

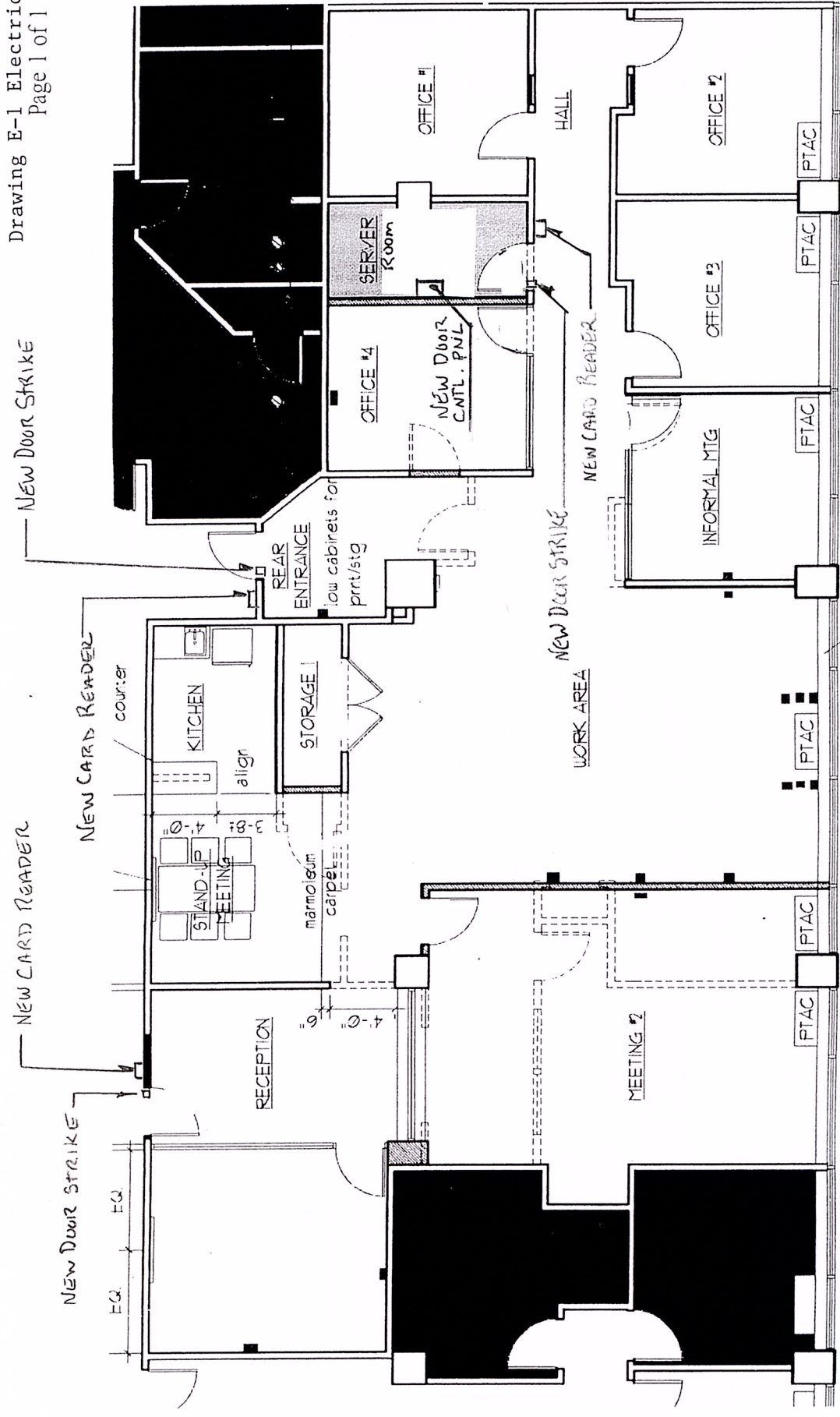

Northeast Security Systems, INC.
PO Box 1566
Wiscasset, ME. 04578

PROJECT:
Low-Voltage Access Control System For:

RXANTE, INC.
511 Congress Street, Suite 803
Portland, ME. 04101

SCALE: 1/8" = 1'-0"