

2 EVENT SPACE REFLECTED CEILING PLAN  
A101 3/16" = 1'-0"

PLUMBING COUNT: LOUNGES  
240 OCCUPANTS (149 M/149 F)  
WATER CLOSETS: 2 MALE  
URINALS: 1 MALE  
LAVATORIES: 1 MALE  
3 FEMALE  
1 FEMALE

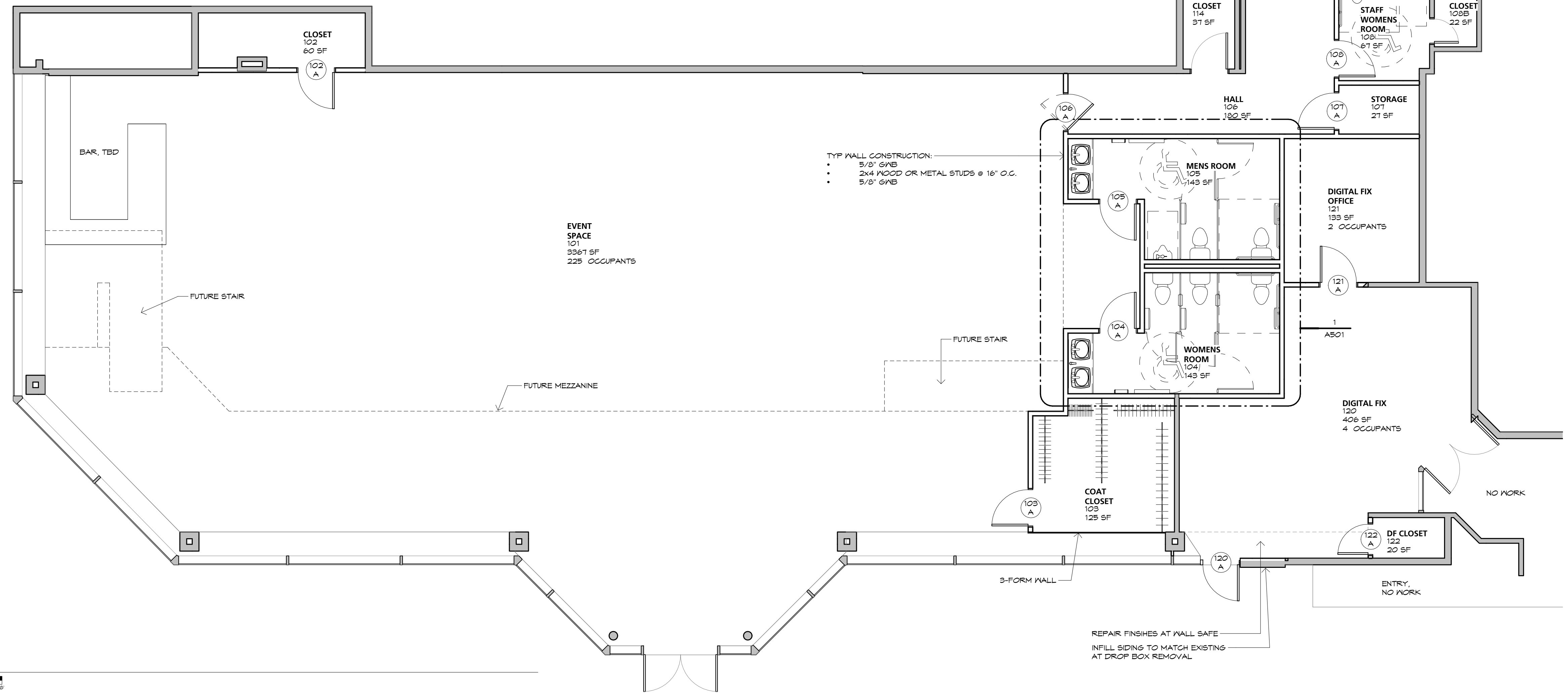

1 PROPOSED FIRST FLOOR  
A101 3/16" = 1'-0"

TYP WALL CONSTRUCTION:  
• 5/8" GNB  
• 2x4 WOOD OR METAL STUDS @ 16" O.C.  
• 5/8" GNB

REPAIR FINISHES AT WALL SAFE  
INFILL SIDING TO MATCH EXISTING  
AT DROP BOX REMOVAL

**BARBA+WHEELOCK**  
ARCHITECTURE SUSTAINABILITY PRESERVATION  
500 CONGRESS STREET  
PORTLAND, MAINE 04101  
207.772.2722  
WWW.BARBAWHEELOCK.COM

FOR PERMIT ONLY  
NOT FOR CONSTRUCTION

511 CONGRESS STREET EVENT SPACE  
OCEAN GARE REALTY  
511 CONGRESS STREET  
PORTLAND, ME 04101

PROPOSED FIRST FLOOR PLAN  
ISSUED FOR: PERMIT  
DRAWN BY: B+W  
DATE: 01/02/2017  
Copyright 2018 Barba + Wheelock

511 EVENT SPACE  
A101