

DISPLAY THIS CARD ON PRINCIPAL FRONTAGE OF WORK CITY OF PORTLAND

BUILDING INSPECTION

PERMIT

Permit Number: 040519

Please Read Application And Notes, If Any, Attached

This is to certify that Spring Street Limited /Doug in Design
has permission to 20" x 48" freestanding sign
AT 511 Congress St 037 D002001

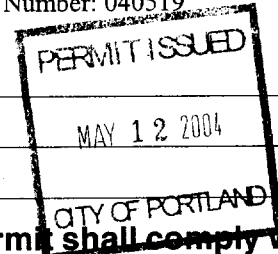

provided that the person or persons, firm or corporation accepting this permit shall comply with all of the provisions of the Statutes of Maine and of the ordinances of the City of Portland regulating the construction, maintenance and use of buildings and structures, and of the application on file in this department.

Apply to Public Works for street line and grade if nature of work requires such information.

Notification of inspection must be given and when permission is procured before this building or part thereof is opened or closed-in. HOUR NOTICE IS REQUIRED.

A certificate of occupancy must be procured by owner before this building or part thereof is occupied.

OTHER REQUIRED APPROVALS

Fire Dept. _____
Health Dept. _____
Appeal Board _____
Other _____
Department Name

[Signature]
Director - Building & Inspection Services

PENALTY FOR REMOVING THIS CARD

City of Portland, Maine - Building or Use Permit Application

339 Congress Street, 04101 Tel: (207) 874-8703, Fax: (207) 874-8716

Permit No: 04-0519	Issue Date: MAY 12 2004	CBL: 037 D002001
-----------------------	----------------------------	---------------------

Location of Construction: 511 Congress St	Owner Name: Spring Street Limited	Owner Address: 317 Glen Rd	Phone: CITY OF PORTLAND
Business Name:	Contractor Name: Doug Sign Design	Contractor Address: PO Box 207 Westbrook	Phone: 2078562600
Lessee/Buyer's Name	Phone:	Permit Type: Signs - Permanent	Zone: B3

Past Use: Sandwich Shop	Proposed Use: Sandwich Shop w/20" x 48" freestanding sign	Permit Fee: \$44.00	Cost of Work: \$0.00	CEO District: 1
----------------------------	--	------------------------	-------------------------	--------------------

Proposed Project Description: 20" x 26" freestanding sign	FIRE DEPT: <input checked="" type="checkbox"/> Approved <input type="checkbox"/> Denied	INSPECTION: Use Group: U Type: Sign BOCA 1999
--	---	---

<p style="text-align: center;">PERMIT ISSUED WITH REQUIREMENTS</p>	Signature:	Signature:
	PEDESTRIAN ACTIVITIES DISTRICT (P.A.D.) Action: <input checked="" type="checkbox"/> Approved <input type="checkbox"/> Approved w/Conditions <input type="checkbox"/> Denied Signature: D. Andrews Date: 5/06/04	

Permit Taken By: kwd	Date Applied For: 04/29/2004	Zoning Approval
-------------------------	---------------------------------	------------------------

1. This permit application does not preclude the Applicant(s) from meeting applicable State and Federal Rules. 2. Building permits do not include plumbing, septic or electrical work. 3. Building permits are void if work is not started within six (6) months of the date of issuance. False information may invalidate a building permit and stop all work..	Special Zone or Reviews <input type="checkbox"/> Shoreland <input type="checkbox"/> Wetland <input type="checkbox"/> Flood Zone <input type="checkbox"/> Subdivision <input type="checkbox"/> Site Plan Maj <input type="checkbox"/> Minor <input type="checkbox"/> MM <input type="checkbox"/> Date: 5/5/04	Zoning Appeal <input type="checkbox"/> Variance <input type="checkbox"/> Miscellaneous <input type="checkbox"/> Conditional Use <input type="checkbox"/> Interpretation <input type="checkbox"/> Approved <input type="checkbox"/> Denied Date:	Historic Preservation <input type="checkbox"/> Not in District or Landmark <input checked="" type="checkbox"/> Does Not Require Review <input type="checkbox"/> Requires Review <input type="checkbox"/> Approved <input type="checkbox"/> Approved w/Conditions <input type="checkbox"/> Denied Date:
	Special Note: Sent for review under A 368.5.9 - Special Signage Circumstances Deb A.		

CERTIFICATION

I hereby certify that I am the owner of record of the named property, or that the proposed work is authorized by the owner of record and that I have been authorized by the owner to make this application as his authorized agent and I agree to conform to all applicable laws of this jurisdiction. In addition, if a permit for work described in the application is issued, I certify that the code official's authorized representative shall have the authority to enter all areas covered by such permit at any reasonable hour to enforce the provision of the code(s) applicable to such permit.

SIGNATURE OF APPLICANT	ADDRESS	DATE	PHONE
RESPONSIBLE PERSON IN CHARGE OF WORK, TITLE		DATE	PHONE

City of Portland, Maine - Building or Use Permit

389 Congress Street, 04101 Tel: (207) 874-8703, Fax: (207) 874-8716

Permit No: 04-0519	Date Applied For: 04/29/2004	CBL: 037 D002001
------------------------------	--	----------------------------

Location of Construction: 511 Congress St	Owner Name: Spring Street Limited	Owner Address: 317 Glen Rd	Phone:
Business Name:	Contractor Name: Doug Sign Design	Contractor Address: PO Box 207 Westbrook	Phone (207) 856-2600
Lessee/Buyer's Name	Phone:	Permit Type: Signs - Permanent	

Proposed Use: Sandwich Shop w/20" x 26" freestanding sign	Proposed Project Description: 20" x 26" freestanding sign
---	---

Dept: Historical **Status:** Approved **Reviewer:** Deborah Andrews **Approval Date:** 05/06/2004
Note: **Ok to Issue:**
 1) P.A.D. Approved under site plan exemption.

Dept: Zoning **Status:** Approved **Reviewer:** Marge Schmuckal **Approval Date:**
Note: 5/5/04 Free standing signs are not permitted in the B-3 zone - this permit does not meet that requirement - **Ok to Issue:**
 Apparently the sign company has spoken with Deb A. in planning about this sign. The permit is being transferred to Deb Andrews for review as permitted under 14-368.5.g - site plan special and unique circumstances.

Dept: Building **Status:** Approved with Conditions **Reviewer:** Tammy Munson **Approval Date:** 05/07/2004
Note: **Ok to Issue:**
 1) Signage Installation to comply with Chapter 31 BOCA 1999

04-0519

Signage/Awning Permit Application

If you or the property owner owes real estate or personal property taxes or user charges on any property within the City, payment arrangements must be made before permits of any kind are accepted.

Location/Address of Construction: <u>511 Congress</u>		
Total Square Footage of Proposed Structure <u>10 Sg. Ft.</u>	Square Footage of Lot <u>2500 +/- ?</u>	
Tax Assessor's Chart, Block & Lot Chart# <u>037</u> Block# <u>D</u> Lot# <u>002</u>	Owner: <u>871-1290 sort</u> <u>Boulos Prop Manage</u>	Telephone: <u>871-1290</u>
Lessee/Buyer's Name (If Applicable) <u>D'ANGELOS Sandwich</u> <u>CumbeerlandME</u>	Applicant name, address & telephone: <u>Sign Design Inc.</u> <u>P.O. Box 207</u> <u>WestbrookME</u>	Total s.f. of signage x \$2.00 per s.f. plus \$30.00/\$65.00 for H.D. signage = Total Fee: \$ _____ Awning Fee = Cost Of Work: \$ _____ Total Fee: \$ <u>4400</u>
Current use: <u>Sandwich Shop</u>		
If the location is currently vacant, what was prior use: <u>N/A</u>		
Approximately how long has it been vacant: <u>N/A</u>		
Proposed use: <u>Same</u>		
Project description: <u>Additional Free Standing Sign.</u>		
Contractor's name, address & telephone: <u>Doug Sign Design.</u>		
Whom should we contact when the permit is ready: <u>Doug 8562600</u>		
Mailing address: <u>P.O. Box 207 Westbrook ME 04099</u>		
We will contact you by phone when the permit is ready. You must come in and pick up the permit and review the requirements before starting any work, with a Plan Reviewer. A STOP WORK ORDER will be issued and a \$100.00 fee if any work starts before the permit is picked up. PHONE: <u>856.2600</u>		

IF THE REQUIRED INFORMATION IS NOT INCLUDED IN THE SUBMISSIONS THE PERMIT WILL BE AUTOMATICALLY DENIED AT THE DISCRETION OF THE BUILDING/PLANNING DEPARTMENT. WE MAY REQUIRE ADDITIONAL INFORMATION IN ORDER TO APPROVE THIS PERMIT.

I hereby certify that I am the Owner of record of the named property, or that the owner of record has authorized me to make this application as his/her authorized agent. I agree to conform to all applicable laws of this jurisdiction. In addition, if a permit for work described in this application is issued, I certify that the Code Official's authorized representative shall have the authority to enter all areas covered by this permit at any reasonable hour to enforce the provisions of the codes applicable to this permit.

Signature of applicant: 	Date: <u>APR 29 2004</u>
---	--------------------------

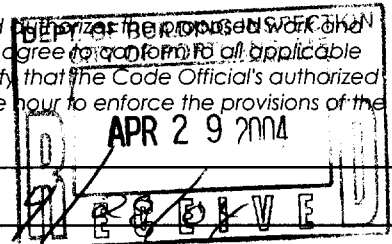

This is NOT a permit, you may not commence ANY work until the permit is issued.

SIGNAGE/AWNING PRE-APPLICATION QUESTIONNAIRE

PLEASE COMPLETE ALL INFORMATION

ADDRESS: 511 Congress ZONE: B-3

CBL: _____

SINGLE TENANT LOT? YES _____ NO MULTI TENANT LOT? YES NO _____

MORE THAN ONE SIGN TOTAL WITH PROPOSED SIGN? YES NO _____

see attached

TENANT/ALLOCATED BUILDING SPACE FRONTAGE (FEET):

Length: 58'+/- Height: 12'+/-

INFORMATION ON PROPOSED SIGN(S):

FREESTANDING (e.g., pole) SIGN? YES NO DIMENSIONS PROPOSED: 20" x 48"

BLDG. WALL SIGN? (attached to bldg) YES NO DIMENSIONS PROPOSED: _____

INFORMATION ON ALREADY EXISTING AND PERMITTED SIGN(S):

FREESTANDING (e.g., pole) SIGN? YES _____ NO DIMENSIONS: _____

BLDG. WALL SIGN(attached to bldg)? YES NO _____ DIMENSIONS 21' x 10', 8' x 26'

AWNING? YES NO _____ DIMENSIONS: 3' x 6'

LOT FRONTAGE (FEET): 500'+/-

AWNING YES _____ NO IS AWNING BACKLIT? YES N/A NO _____

HEIGHT OF AWNING: N/A LENGTH OF AWNING: N/A DEPTH: N/A

IS THERE ANY COMMUNICATION, MESSAGE, TRADEMARK OR SYMBOL ON IT? YES N/A NO _____

IF YES, TOTAL S.F. OF PANELS WITH COMMUNICATIONS/MESSAGE/TRADEMARK/SYMBOL? _____ s.f.

A SITE SKETCH AND BUILDING SKETCH SHOWING EXACTLY WHERE EXISTING AND NEW SIGNAGE IS LOCATED MUST BE PROVIDED. SKETCHES AND/OR PICTURES OF PROPOSED SIGNAGE ARE ALSO REQUIRED.

SIGNATURE OF APPLICANT: [Signature] DATE: 4/29/04

***** FOR OFFICE USE ONLY *****

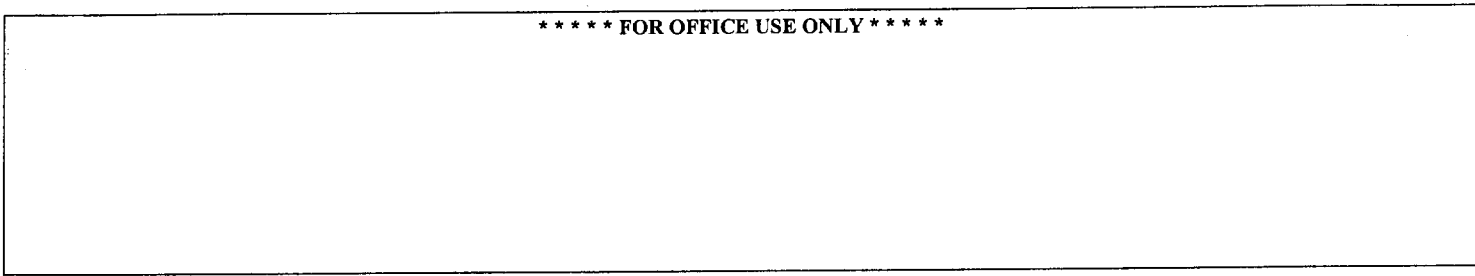

Existing signage



$A = 1' \times 10' = 10.58 \text{ ft.}$
 $B = 1' \times 10' = 10.58 \text{ ft.}$
 $C = 3' \times 6' = 18.58 \text{ ft.}$
 ↓
 30' TOTAL

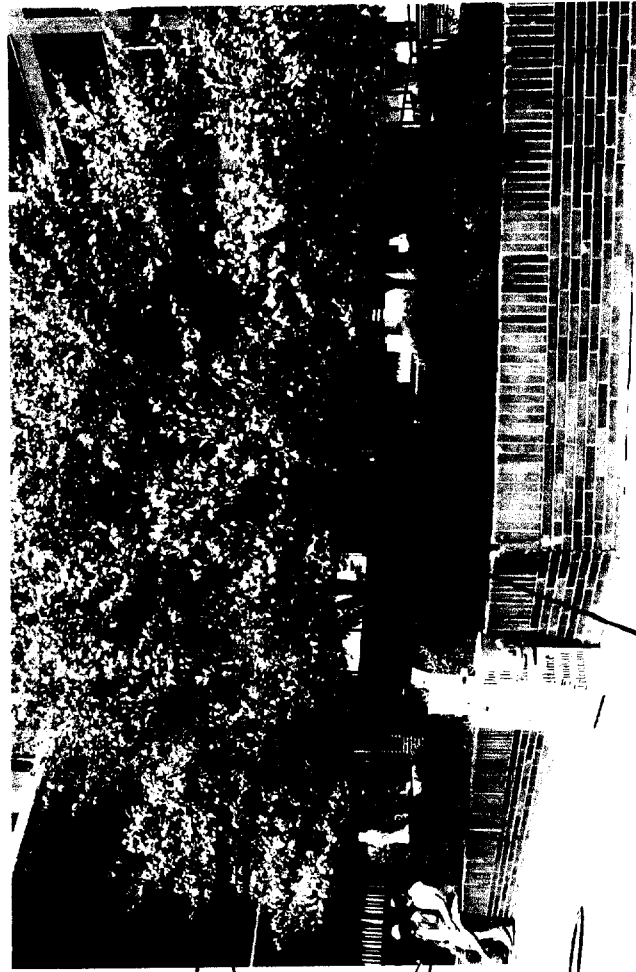
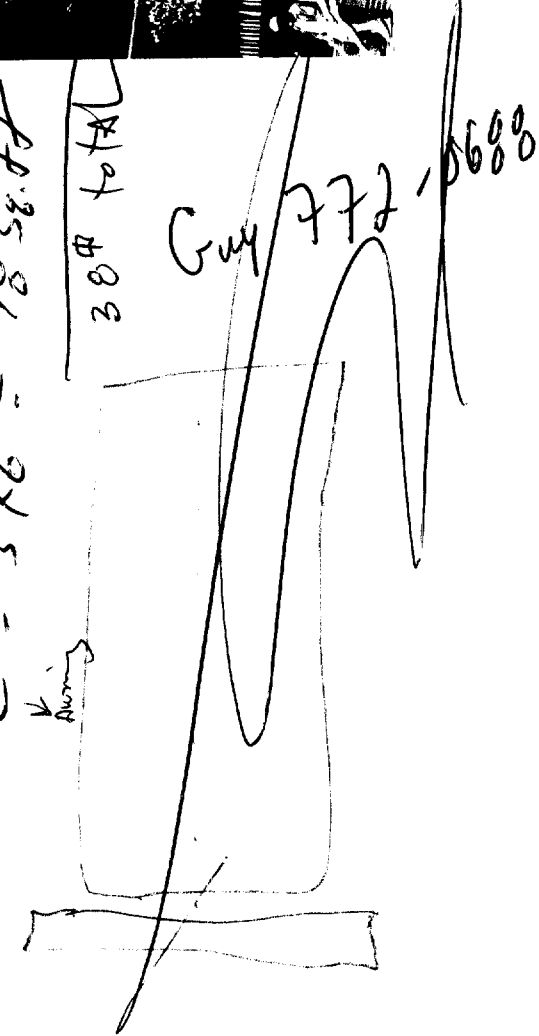

Proposed sign 4/28

This Design Is The Property Of:

Sign Design Inc.

306 Warren Ave. Portland, ME
207-856-2600

This sign has been
reviewed w/ Deb Andrew
4/29/04

D/F INT. ILLUM. POLE MOUNT CABINET
LEXAN FACES W/ VINYL GRAPHICS
(BUILDING MTD.)

48"

20"



26"

26" above ground

Customer: Deangelo
Job Name: dange comp. 1
Date: 4-28-04

Approval:

511 Congress

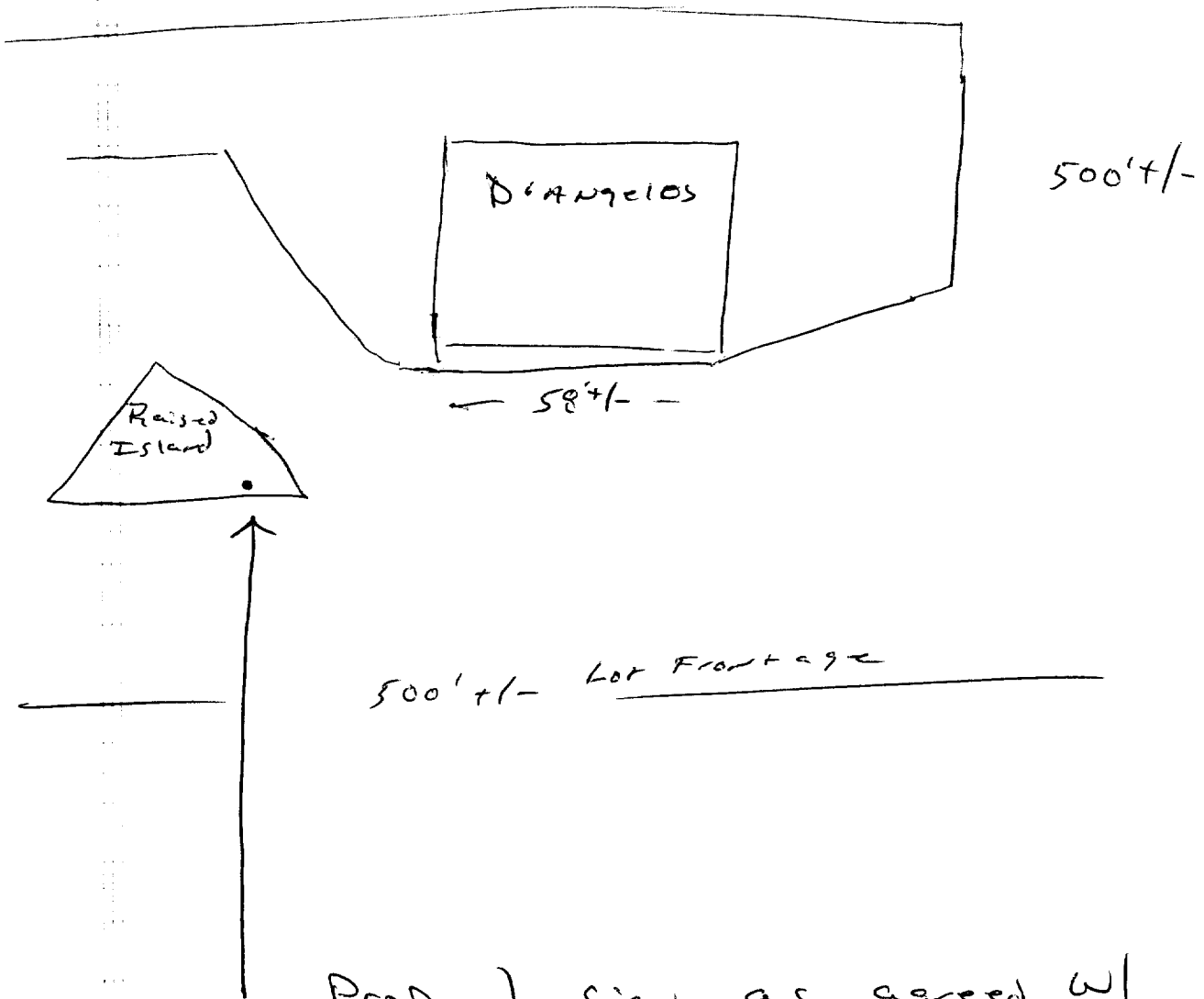

Proposed sign as agreed w/
Deb Andrews same set back
as Peoples, 26" to base of
sign, sign is 20" x 48" D/F Lit,
46" overall height.

CB  **Richard Ellis**
Boulos Property Management

One Canal Plaza
Portland, ME 04101
207.871.1290 Fax
207.772.2647
www.boulos.com

September 25, 2003

Mr. Jerry Howland
Substantial Investments, Inc.
42 Gray Road
Cumberland, ME 04021

RE: Signage Consent - 511 Congress Street, Portland, Maine

Dear Jerry:

This letter serves as the Landlord's approval to install signage on the façade of 511 Congress Street pursuant to our discussions. All connections to the building must be weather tight and water resistant.

Jerry, we very much appreciate your continued tenancy at 511 Congress Street. As always, please do not hesitate to contact me with any questions related to this or any other matter.

Sincerely,



Amy R. Booth
Senior Vice President

THE RIGHT WAY TO DO REAL ESTATE

10/01/03 WED 13:06 FAX 120778033882
CHROME 92266

CROSS INSURANCE LEWISTON
12DANGELO

001

AGORD CERTIFICATE OF LIABILITY INSURANCE

DATE (MM/DD/YYYY)
10/01/03

PRODUCER
CROSS INSURANCE - LEWISTON
217 Main Street
P.O. BOX 3028
Lewiston, ME 04243

THIS CERTIFICATE IS ISSUED AS A MATTER OF INFORMATION ONLY AND CONFERS NO RIGHTS UPON THE CERTIFICATE HOLDER. THIS CERTIFICATE DOES NOT AMEND, EXTEND OR ALTER THE COVERAGE AFFORDED BY THE POLICIES BELOW.

INSURED
Substantial Investments, Inc. dba
D'Angelo Sandwich Shops; 43 Gray Road
Cumberland Center, ME 04021

INSURERS AFFORDING COVERAGE	NAIC #
INSURER A: Peerless Ins. Co.	24188
INSURER B:	
INSURER C:	
INSURER D:	
INSURER E:	

COVERAGES

THE POLICIES OF INSURANCE LISTED BELOW HAVE BEEN ISSUED TO THE INSURED NAMED ABOVE FOR THE POLICY PERIOD INDICATED. NOTWITHSTANDING ANY REQUIREMENT, TERM OR CONDITION OF ANY CONTRACT OR OTHER DOCUMENT WITH RESPECT TO WHICH THIS CERTIFICATE MAY BE ISSUED OR MAY PERTAIN, THE INSURANCE AFFORDED BY THE POLICIES DESCRIBED HEREIN IS SUBJECT TO ALL THE TERMS, EXCLUSIONS AND CONDITIONS OF SUCH POLICIES. AGGREGATE LIMITS SHOWN MAY HAVE BEEN REDUCED BY PAID CLAIMS.

POLICY TYPE / CODE	TYPE OF INSURANCE	POLICY NUMBER	POLICY PERIOD DATE	POLICY EXPIRATION DATE	LIMITS	
					DESCRIPTION	AMOUNT
A	GENERAL LIABILITY	BOP6708288	04/01/03	04/01/04	EACH OCCURRENCE	\$1,000,000
	<input checked="" type="checkbox"/> COMMERCIAL GENERAL LIABILITY				DAMAGE TO RENTED	\$200,000
	<input type="checkbox"/> CLAIMS MADE <input checked="" type="checkbox"/> OCCUR				MED EXP (ANY ONE PERSON)	\$10,000
					PERSONAL & ADV INJURY	\$1,000,000
	GEN'L AGGREGATE LIMIT APPLIES PER:				GENERAL AGGREGATE	\$2,000,000
	POLICY <input type="checkbox"/> TRUCK <input type="checkbox"/> LOC				PRODUCTS - COMP/OP ASS	\$2,000,000
	AUTOMOBILE LIABILITY				COMBINED SINGLE LIMIT (Per Occurrence)	\$
	ANY AUTO				BODILY INJURY (Per Person)	\$
	ALL OWNED AUTOS				BODILY INJURY (Per Occurrence)	\$
	SCHEDULED AUTOS				PROPERTY DAMAGE (Per Occurrence)	\$
	HIRED AUTOS				AUTO ONLY - EA ACCIDENT	\$
	NON-OWNED AUTOS				OTHER THAN AUTO ONLY	EA ACC \$ AGG \$
A	RECREATIONAL LIABILITY	CU0708870	04/01/03	04/01/04	EACH OCCURRENCE	\$5,000,000
	<input checked="" type="checkbox"/> OCCUR <input type="checkbox"/> CLAIMS MADE				AGGREGATE	\$5,000,000
	<input type="checkbox"/> DEDUCTIBLE					\$
	<input checked="" type="checkbox"/> RETENTION \$10000					\$
	WORKERS COMPENSATION AND EMPLOYERS' LIABILITY				E.L. EACH ACCIDENT	\$
	ANY PROPRIETOR/PARTNER/EXECUTIVE OFFICER/OWNER EXCLUDED				E.L. DISEASE - EA EMPLOYEE	\$
	If yes, describe using SPECIAL PROVISIONS below				E.L. DISEASE - POLICY LIMIT	\$
	OTHER					

DESCRIPTION OF OPERATIONS / LOCATIONS / VEHICLES / EXCLUSIONS ADDED BY ENDORSEMENT / SPECIAL PROVISIONS

Location: 511 Congress Street, Portland, Maine.
Certificate Holder is also an Additional Insured as respects to the General Liability Policy only.

CERTIFICATE HOLDER

City of Portland
Portland, ME 04101

CANCELLATION

SHOULD ANY OF THE ABOVE DESCRIBED POLICIES BE CANCELLED BEFORE THE EXPIRATION DATE THEREOF, THE ISSUING INSURER WILL ENDEAVOR TO MAIL 10 DAYS WRITTEN NOTICE TO THE CERTIFICATE HOLDER NAMED TO THE LEFT, BUT FAILURE TO DO SO SHALL IMPOSE NO OBLIGATION OR LIABILITY OF ANY KIND UPON THE INSURER, ITS AGENTS OR REPRESENTATIVES.

AUTHORIZED REPRESENTATIVE

Wick & Currier

Permit No: **341099**

PERMIT ISSUED
OCT 14 1994

CITY OF PORTLAND
Zoning Code: 037-D-002

Special Zone or Reviews:
 Shoreland
 Wetland
 Flood Zone
 Subdivision
 Site Plan major minor mm

Zoning Approval: _____

Zoning Appeal:
 Variance
 Miscellaneous
 Conditional Use
 Interpretation
 Approved
 Denied

Historic Preservation:
 Not in District or Landmark
 Does Not Require Review
 Requires Review

Action:
 Approved
 Approved with Conditions
 Denied

Date: _____

CEO DISTRICT

Location of Construction: _____
 511 Congress St

Owner: State Mutual Life Ins. Co.
 Phone: _____

Lease/Buyer's Name: _____
 D'angelo's Sandwich Shops 121 Orchard Rd
 Phone: _____

Business Name: Cumberland, ME 04021

Contractor Name: _____
 Address: _____
 Phone: 797-9602

Past Use: _____

Proposed Use: Retail Food w/signs

PERMIT FEE: \$ 32.60

FIRE DEPT. Approved Denied

INSPECTION: _____
 Use Group: _____ Type: _____

Signature: _____
 PEDESTRIAN ACTIVITIES DISTRICT (P.U.D.)

Action: Approved Approved with Conditions Denied

Signature: _____ Date: _____

Proposed Project Description:
 Erect Illuminated Signs (Band which is existing is illuminated)

1. This permit application doesn't preclude the Applicant(s) from meeting applicable State and Federal rules.

2. Building permits do not include plumbing, septic or electrical work.

3. Building permits are void if work is not started within six (6) months of the date of issuance. False information may invalidate a building permit and stop all work.

Sign 1: 1 x 10.5
 Sign 2: 1 x 9.5
 Sign 3: 6 x 3
 32.6 sq ft total

copy sent 4-98-0071 #322

CERTIFICATION

I hereby certify that I am the owner of record of the named property, or that the proposed work is authorized by the owner of record and that I have been authorized by the owner to make this application as his authorized agent and I agree to conform to all applicable laws of this jurisdiction. In addition, if a permit for work described in the application issued, I certify that the code official's authorized representative shall have the authority to enter all areas covered by such permit at any reasonable hour to enforce the provisions of the code(s) applicable to such permit

SIGNATURE OF APPLICANT: *Jerry Howland*
 Jerry Howland
 ADDRESS: 121 ORCHARD RD CUMBERLAND ME
 DATE: 21 Sept '94
 PHONE: 797-9602

RESPONSIBLE PERSON IN CHARGE OF WORK, TITLE: _____
 PHONE: _____

White-Permit Desk Green-Assessor's Canary-D.P.W. Pink-Public File Ivory Card-Inspector

DISPLAY THIS CARD ON PRINCIPAL FRONTAGE OF WORK

CITY OF PORTLAND

BUILDING INSPECTION

PERMIT

No.

PERMIT ISSUED

OCT 14 1994

CITY OF PORTLAND

941099

Please Read

Application And
Notes, if Any,
Attached

This is to certify that D'Angelo's Sandwich Shop
has permission to Erect sign
AT 511 Congress St

provided that the person or persons, firm or corporation accepting this permit shall comply with all of the provisions of the Statutes of Maine and of the Ordinances of the City of Portland regulating the construction, maintenance and use of buildings and structures, and of the application on file in this department.

Apply to Public Works for street line and grade if nature of work requires such information.

Notification for inspection must be given and written permission procured before this building or part thereof is leased or otherwise closed-in.

A certificate of occupancy must be procured by owner before this building or part thereof is occupied.

OTHER REQUIRED APPROVALS

Fire Dept. _____
Health Dept. _____
Appeal Board _____
Other _____

Department Name

[Signature]
Director - Building & Inspection Services

PENALTY FOR REMOVING THIS CARD

15 [Signature]

SUBSTANTIAL INVESTMENTS, INC.

DBA D'angelo Sandwich Shops

42 Gray Rd.

Cumberland, ME 04021

Phone: 207-829-3668 Fax: 207-829-4092

Date 12/17/03 Pages (incl cover) 3
To Marge Schmuckal From Jerry Howland
Message Original Sign Permit

SIGNAGE/AWNING PRE-APPLICATION QUESTIONNAIRE

PLEASE ANSWER ALL QUESTIONS

ADDRESS: 511 Congress ZONE: B-3

CBL: _____

SINGLE TENANT LOT? YES _____ NO MULTI TENANT LOT? YES NO _____
MORE THAN ONE SIGN TOTAL WITH PROPOSED SIGN? YES NO _____
See Attached

INFORMATION ON PROPOSED SIGN(S):

FREESTANDING (e.g., pole) SIGN? YES _____ NO DIMENSIONS PROPOSED: _____
BLDG. WALL SIGN? (attached to bldg) YES NO _____ DIMENSIONS PROPOSED: 2' x 5' = 10'

INFORMATION ON ALREADY EXISTING AND PERMITTED SIGN(S):

FREESTANDING (e.g., pole) SIGN? YES _____ NO DIMENSIONS: _____
BLDG. WALL SIGN(attached to bldg) ? YES NO _____ DIMENSIONS: (2) 1' x 10' = 20'
AWNING? YES NO _____ DIMENSIONS: (1) 3' x 6'

LOT FRONTAGE (FEET): 500' +/-
TENANT/ALLOCATED BUILDING SPACE FRONTAGE (FEET): 58' +/- $58' \times 2' = 116'$ [#] max

AWNING YES NO Existing IS AWNING BACKLIT? YES NO _____

HEIGHT OF AWNING: 12' LENGTH OF AWNING: 6' DEPTH: 2'

IS THERE ANY COMMUNICATION, MESSAGE, TRADEMARK OR SYMBOL ON IT? YES NO See picture

IF YES, TOTAL S.F. OF PANELS WITH COMMUNICATIONS/MESSAGE/TRADEMARK/SYMBOL? 18 s.f.

A SITE SKETCH AND BUILDING SKETCH SHOWING EXACTLY WHERE EXISTING AND NEW SIGNAGE IS LOCATED MUST BE PROVIDED. SKETCHES AND/OR PICTURES OF PROPOSED SIGNAGE ARE ALSO REQUIRED.

SIGNATURE OF APPLICANT: [Signature] DATE: 10/14/03

***** FOR OFFICE USE ONLY *****

BUILDING PERMIT INSPECTION PROCEDURES

Please call 874-8703 or 874-8693 to schedule your inspections as agreed upon

Permits expire in 6 months, if the project is not started or ceases for 6 months.

The Owner or their designee is required to notify the inspections office for the following inspections and provide adequate notice. Notice must be called in 48-72 hours in advance in order to schedule an inspection:

By initializing at each inspection time, you are agreeing that you understand the inspection procedure and additional fees from a "Stop Work Order" and "Stop Work Order Release" will be incurred if the procedure is not followed as stated below.

JA **Pre-construction Meeting:** Must be scheduled with your inspection team upon receipt of this permit. Jay Reynolds, Development Review Coordinator at 874-8632 must also be contacted at this time, before any site work begins on any project other than single family additions or alterations.

DTG **Footing/Building Location Inspection:** Prior to pouring concrete

NA **Re-Bar Schedule Inspection:** Prior to pouring concrete

NA **Foundation Inspection:** Prior to placing ANY backfill

 Framing/Rough Plumbing/Electrical: Prior to any insulating or drywalling

DTG **Final/Certificate of Occupancy:** Prior to any occupancy of the structure or use. NOTE: There is a \$75.00 fee per inspection at this point.

*15awne
electrical
will have to
be approved
and inspected*

Certificate of Occupancy is not required for certain projects. Your inspector can advise you if your project requires a Certificate of Occupancy. All projects DO require a final inspection

DTG **If any of the inspections do not occur, the project cannot go on to the next phase, REGARDLESS OF THE NOTICE OR CIRCUMSTANCES.**

CERTIFICATE OF OCCUPANCIES MUST BE ISSUED AND PAID FOR, BEFORE THE SPACE MAY BE OCCUPIED

[Signature] 5/18/07
Signature of Applicant/Designee Date
[Signature] 5/18/07
Signature of Inspections Official Date

CBL. 037-0002 Building Permit #: 04-0579