

01 DEMOLITION PLAN

SCALE: 1/4" = 1'-0"

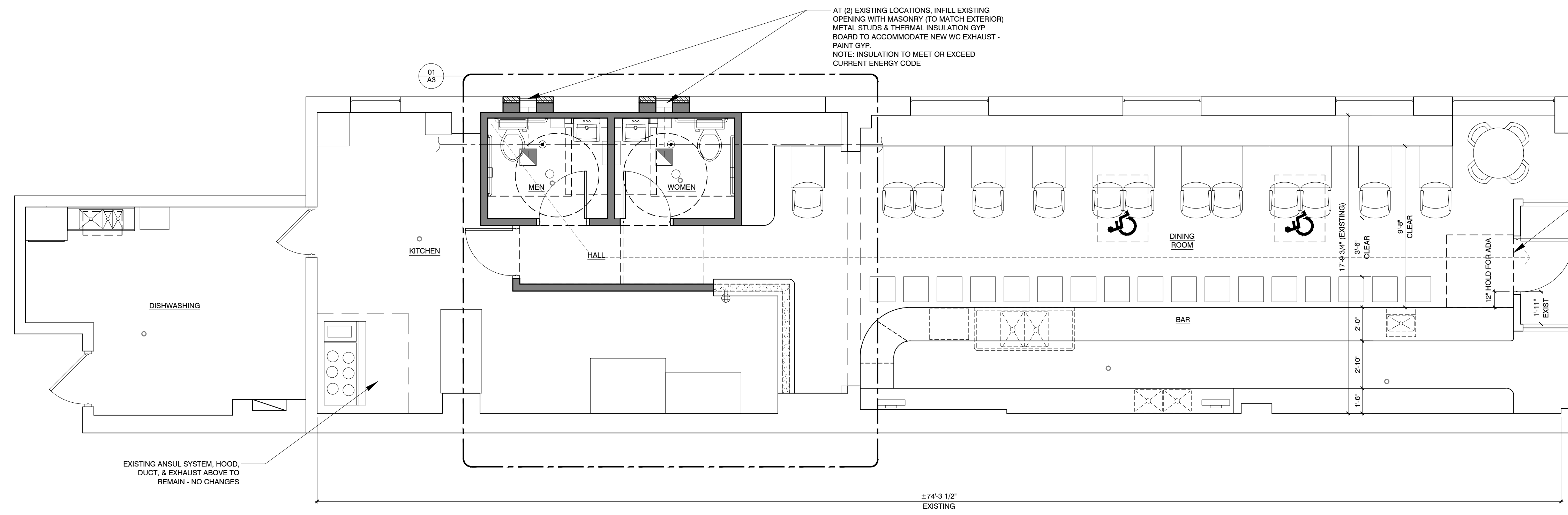

02 REMODEL FLOOR PLAN

SCALE: 1/4" = 1'-0"

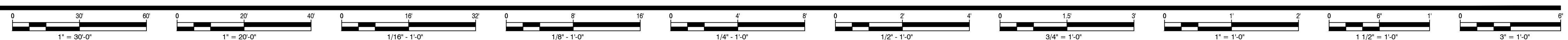

DEPARTMENT OF BUILDINGS APPROVAL

545 CONGRESS STREET
 PORTLAND, ME 04101
 WGA NUMBER: 16195

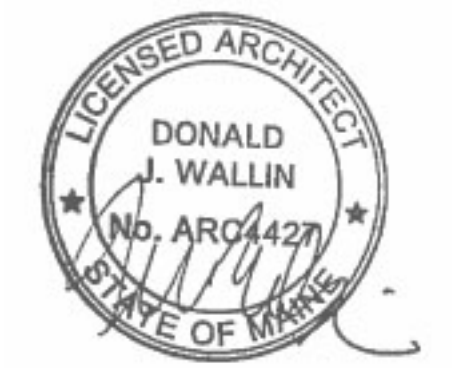

© COPYRIGHT 2016 WALLINGOMEZ ARCHITECTS, LTD. PROFESSIONAL DESIGN FIRM LICENSE NO. 184-002948

MAINE
 DONALD J. WALLIN
 REGISTERED ARCHITECT
 ARC4427
 EXPIRATION DATE: JUNE, 30, 2017
 THESE DRAWINGS HAVE BEEN PREPARED AT / OR UNDER MY SUPERVISION AND TO THE BEST OF MY KNOWLEDGE AND BELIEF CONFORM AND COMPLY WITH THE REQUIREMENTS OF THE DEPARTMENT OF BUILDING AND CODES HAVING JURISDICTION.

Wallin ■ Gomez
 ARCHITECTS LTD
 711 South Dearborn Street, Suite 606
 Chicago, Illinois 60605-1827
 P: 312-427-4702 ■ F: 312-427-6611

 PLOT DATE: 1.13.2017

NO.	DATE	DESCRIPTION
1	01/10/17	ISSUE FOR PERMIT
2		
3		
4		
5		
6		
7		
8		

SHEET TITLE:
DEMOLITION & REMODEL PLANS

SHEET NUMBER:

A1