

City of Portland, Maine - Building or Use Permit Application
 389 Congress Street, 04101 Tel: (207) 874-8703, Fax: (207) 874-8716

Permit No: 09-0769	Issue Date:	CBL: 037 C017001
-----------------------	-------------	---------------------

Location of Construction: 545 CONGRESS ST	Owner Name: CONGRESS JOINT DEVELOPME	Owner Address: PO BOX 6799	Phone:
Business Name:	Contractor Name: Emilitsa	Contractor Address: Portland	Phone: 2077569724
Lessee/Buyer's Name	Phone:	Permit Type: Outdoor Seating	Zone: B-3

Past Use: Resturant - Emilitsa's	Proposed Use: <i>Emilitsa's</i> Resturant- with outside dining 5' by 18' = 90 Sq. Ft: two 2 tables four (4) chairs	Permit Fee:	Cost of Work:	CEO District: 1
Proposed Project Description: Resturant- with outside dining 5' by 18' = 90 Sq. Ft: two 2 tables four (4) chairs		FIRE DEPT: <input type="checkbox"/> Approved <input checked="" type="checkbox"/> Denied <i>[Signature]</i>	INSPECTION: Use Group: <i>U</i> Type: <i>outdoor seating</i> <i>[Signature]</i>	
		PEDESTRIAN ACTIVITIES DISTRICT (P.A.D.) Action: <input type="checkbox"/> Approved <input type="checkbox"/> Approved w/Conditions <input type="checkbox"/> Denied Signature: _____ Date: _____		

Permit Taken By: jrioux	Date Applied For: 07/23/2009	Zoning Approval		
1. This permit application does not preclude the Applicant(s) from meeting applicable State and Federal Rules. 2. Building permits do not include plumbing, septic or electrical work. 3. Building permits are void if work is not started within six (6) months of the date of issuance. False information may invalidate a building permit and stop all work..		Special Zone or Reviews <input type="checkbox"/> Shoreland <input type="checkbox"/> Wetland <input type="checkbox"/> Flood Zone <input type="checkbox"/> Subdivision <input type="checkbox"/> Site Plan Maj <input type="checkbox"/> Minor <input type="checkbox"/> MM <input type="checkbox"/> Date: <i>7/23/09 TR</i>	Zoning Appeal <input type="checkbox"/> Variance <input type="checkbox"/> Miscellaneous <input type="checkbox"/> Conditional Use <input type="checkbox"/> Interpretation <input type="checkbox"/> Approved <input type="checkbox"/> Denied Date: _____	Historic Preservation yes <input type="checkbox"/> Not in District or Landmark <input type="checkbox"/> Does Not Require Review <input type="checkbox"/> Requires Review <input type="checkbox"/> Approved <input type="checkbox"/> Approved w/Conditions <input type="checkbox"/> Denied any extra work requires a separate review approval thru historic. Date: _____

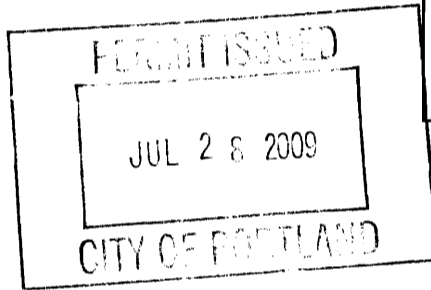

CERTIFICATION

I hereby certify that I am the owner of record of the named property, or that the proposed work is authorized by the owner of record and that I have been authorized by the owner to make this application as his authorized agent and I agree to conform to all applicable laws of this jurisdiction. In addition, if a permit for work described in the application is issued, I certify that the code official's authorized representative shall have the authority to enter all areas covered by such permit at any reasonable hour to enforce the provision of the code(s) applicable to such permit.

SIGNATURE OF APPLICANT	ADDRESS	DATE	PHONE
RESPONSIBLE PERSON IN CHARGE OF WORK, TITLE		DATE	PHONE

Form # P 04

DISPLAY THIS CARD ON PRINCIPAL FRONTAGE OF WORK

CITY OF PORTLAND

BUILDING DEPARTMENT

PERMIT

Please Read Application And Notes. If Any, Attached

Permit Number: 090769

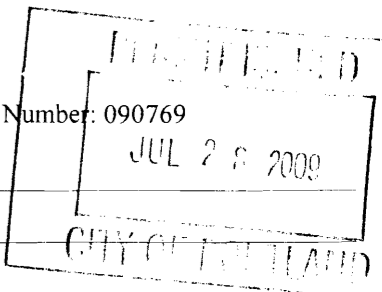

This is to certify that CONGRESS JOINT DEVELOPMENT LLC
has permission to Resturant with outside dining area 18' x 9' sq. Ft. 2 tables for (4) chairs
AT 545 CONGRESS ST CD 037 C017001

provided that the person or persons, firm or corporation accepting this permit shall comply with all of the provisions of the Statutes of Maine and of the Ordinances of the City of Portland regulating the construction, maintenance and use of buildings and structures, and of the application on file in this department.

Apply to Public Works for street line and grade if nature of work requires such information.

Notification of inspection must be given and written permission procured before this building or part thereof is lath or other work closed-in. 2 HOUR NOTICE IS REQUIRED.

A certificate of occupancy must be procured by owner before this building or part thereof is occupied.

OTHER REQUIRED APPROVALS

Fire Dept. _____
Health Dept. _____
Appeal Board _____
Other _____
Department Name

Director - Building & Inspection Services

PENALTY FOR REMOVING THIS CARD

City of Portland, Maine - Building or Use Permit

389 Congress Street, 04101 Tel: (207) 874-8703, Fax: (207) 874-8716

Permit No: 09-0769	Date Applied For: 07/23/2009	CBL: 037 C017001
------------------------------	--	----------------------------

Location of Construction: 545 CONGRESS ST	Owner Name: CONGRESS JOINT DEVELOPME	Owner Address: PO BOX 6799	Phone:
Business Name:	Contractor Name: Emilitsa	Contractor Address: Portland	Phone (207) 756-9724
Lessee/Buyer's Name	Phone:	Permit Type: Outdoor Seating	

Proposed Use: Resturant- Emilista - with outside dining 5' by 18' = 90 Sq. Ft: two 2 tables four (4) chairs	Proposed Project Description: Resturant- with outside dining 5' by 18' = 90 Sq. Ft: two 2 tables four (4) chairs
---	--

Dept: Zoning	Status: Approved with Conditions	Reviewer: Ann Machado	Approval Date: 07/23/2009
Note:			Ok to Issue: <input checked="" type="checkbox"/>
1) All outdoor seating is subject to adjustment at any time from the City's traffic engineer who ensures that the City sidewalk is open and cleared for pedestrian use. 2) ANY exterior work requires a separate review and approval thru Historic Preservation. This property is located within an Historic District.			
Dept: Building	Status: Approved with Conditions	Reviewer: Tammy Munson	Approval Date: 07/28/2009
Note:			Ok to Issue: <input checked="" type="checkbox"/>
1) The outside dining permit is approved for the area delineated at the inspection and stated on the permit, and must be kept on site. THIS PERMIT MUST BE RENEWED ANNUALY 2) The tables and chairs must not block any means of egress of any building, even during storage.			



Outdoor Dining Permit Application

If you or the property owner owes real estate or personal property taxes or user charges on any property within the City, payment arrangements must be made before permits of any kind are accepted.

<input type="checkbox"/> New Application for Outside Dining <input checked="" type="checkbox"/> Renewal Application for Outside Dining ^{OK.} City Clerk signature for liquor license approval: <u>7.23.09 <i>DM</i></u> or Pending Council Date _____ Location/Address of Outdoor Seating: _____		
Total Square Footage of Proposed Seating Area ¹ <u>60'</u>		Square Footage of Lot <u>1460</u>
Tax Assessor's Chart, Block & Lot Chart# Block# Lot# <u>037 C-017 01B</u>	Phone#: <u>756-9724</u> <u>221-0245</u>	Owner: <u>Ring Island LLC</u>
Applicant * <u>must be owner or Lessee</u> Name: <u>John Regas</u> Address: <u>547 Congress</u> City, State & Zip: <u>Portland ME</u>	Lessee/Buyer's Name: (If Applicable)	Annual Fee: \$80 Total Sq. Ft. <u>60' 90'</u> Sq. Ft. Fee: \$ <u>90 @ 2.00</u> Total Fee: \$ <u>180.00</u>
Current use: <u>RESTAURANT</u> Business name: <u>EMILITSA</u> Seating area dimensions: <u>5'x6' & 5'x6'</u> How many chairs? <u>4</u> How many tables? <u>2</u> <input checked="" type="checkbox"/> Yes Alcohol is served. <input type="checkbox"/> No Alcohol being served.		
Who should we contact for the pre-inspection: <u>John Regas</u> Mailing address: <u>POB 852 PORTLAND ME</u> Phone: <u>756-9724</u>		

Please submit all of the information outlined in the Outdoor Dining Application Checklist. Failure to do so will result in the automatic denial of your permit.

In order to be sure the City fully understands the full scope of the project, the Planning and Development Department may request additional information prior to the issuance of a permit. For further information visit us on-line at www.portlandmaine.gov, stop by the Building Inspections office, room 315 City Hall or call 874-8703.

I hereby certify that I am the Owner of record of the named property, or that the owner of record authorizes the proposed work and that I have been authorized by the owner to make this application as his/her authorized agent. I agree to conform to all applicable laws of this jurisdiction. In addition, if a permit for work described in this application is issued, I certify that the Code Official's authorized representative shall have the authority to enter all areas covered by this permit at any reasonable hour to enforce the provisions of the codes applicable to this permit.

Signature of Applicant: *John Regas*

Date: 7/15 09

¹ In no instance shall the total square footage of dining area equal more than 10% of park space, unless the applicant receives a waiver from the Director of Parks and Recreation or his or her designee. **This is not a permit; you may not commence ANY work until the permit is issued.**



OUTDOOR DINING PERMIT CHECKLIST

Permits are required for expanding food service establishments to the outside on City Property. The annual fee is \$80.00 plus \$2.00 per square foot of dining area on streets, sidewalks or other public ways and \$80.00 plus \$6.00 per square foot of dining area in city parks. For purposes of fee calculation, the area abutting the buildings which border Monument Square and extending ten (10) feet from the facade of said buildings shall be considered a sidewalk. The ten (10) foot area shall be measured from that portion of the facade that protrudes furthest into the sidewalk. The area beyond the ten (10) foot sidewalk shall be considered park space.

Outdoor dining is permitted year round under the permit; however, furniture must be removed in inclement weather to allow for sidewalk snow removal. **The permit must be renewed each year.**

All of the following information is required and must be submitted. You will also be required to fill out an Outdoor Dining Permit Application.

A plot plan is required and must include:

- A drawing of the lot, where the building sits on the lot along with the lot and building dimensions
- The dimensional setback from the sidewalk to the building
- The location of the street, and if it's a corner lot, the intersecting streets
- The sidewalk along with its width and curbing location
- The location of the table and chair placement, including dimensions

(NOTE: there must be a minimum of four feet of open sidewalk from the outer boundary of the seating area to the curb, and a minimum of five feet on corners, and egress from the building must be maintained free of obstruction per the building code and NFPA Life Safety Code).

Additional Requirements:

- The permit holder is required to produce, at the time of submission, and maintain public liability insurance coverage in an amount of not less than four hundred thousand dollars (\$400,000) combined single limit for bodily injury, death and property damage, naming the City as an additional insured thereon.

All permits for outdoor dining are issued subject to the following conditions:

- The tables and chairs must be placed within the permitted area on the sidewalk in such a manner as to allow the free and safe passage of pedestrian traffic. If the tables and chairs are moved and located outside of the permitted outdoor seating area, they must be relocated to within the permitted area. Failure to contain the tables and chairs to the permitted area may result in a reduced permitted area or a revocation of the permit.

- The permit holder is responsible for keeping the outdoor seating area clean. The sidewalk area where the tables and chairs are located must be kept neat and free from litter and debris.
- No food shall be prepared outside.
- If alcohol is to be served, the permit holder must notify the City's Business Licensing Office in room 203 of City Hall or by telephone at 874-8557 and obtain approval for the service of alcohol outdoors. Additionally, State law requires that any outdoor area serving alcohol be segregated from the rest of the public.
- All tables and chairs shall be removed prior to a predicted snowfall and while any snow or ice exists within the designated outdoor seating area or within four feet from the boundaries thereof. The City will not be responsible for damage to any tables, chairs or other property that is not properly removed when the City is engaged in sidewalk maintenance activities.
- The permit holder shall comply with all applicable rules and regulations implemented by the city regarding outdoor dining.

Failure to comply with any of the above conditions will result in revocation or non-renewal of the permit.

I/We fully understand that the City of Portland, its agents, officers and employees accept no responsibility and will not be liable for any injury, harm or damage to my/our person or property arising out of the establishment's occupancy of the sidewalk or park space. To the fullest extent permitted by law, I/We do hereby agree to assume all risk of injury, harm or damage to my/our person or property (including but not limited to all risk of injury, harm or damage to my/our property cause by the negligence of the City of Portland, its agents, officers or employees) arising out of the establishment's occupancy of the sidewalk or park space. I/We hereby agree, to the fullest extent permitted by law, to defend, indemnify and hold harmless the City of Portland, its agents, officers and employees, from and against all claims, damages, losses and expenses, just or unjust, including, but not limited to costs of defense and attorney's fees, arising out of the establishment's occupancy of the sidewalk or park space, provided that any such claims, damage, loss or expense (1) is attributable to bodily injury, sickness, disease, or death, or to injury to or destruction of tangible property including the loss of use there from, and (2) is caused in whole or in part by any negligent act or omission of the establishment, anyone directly or indirectly employed by it, or anyone for whose act it may be liable.

Signed and acknowledged:

Printed name

Establishment

Location

John Regas

Emilitsa

547 Congress

Date: 7/15/09

CONGRESS STREET

curb

2 light y chairs

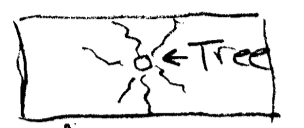
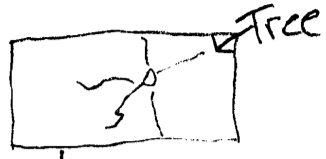

5' x 18' →

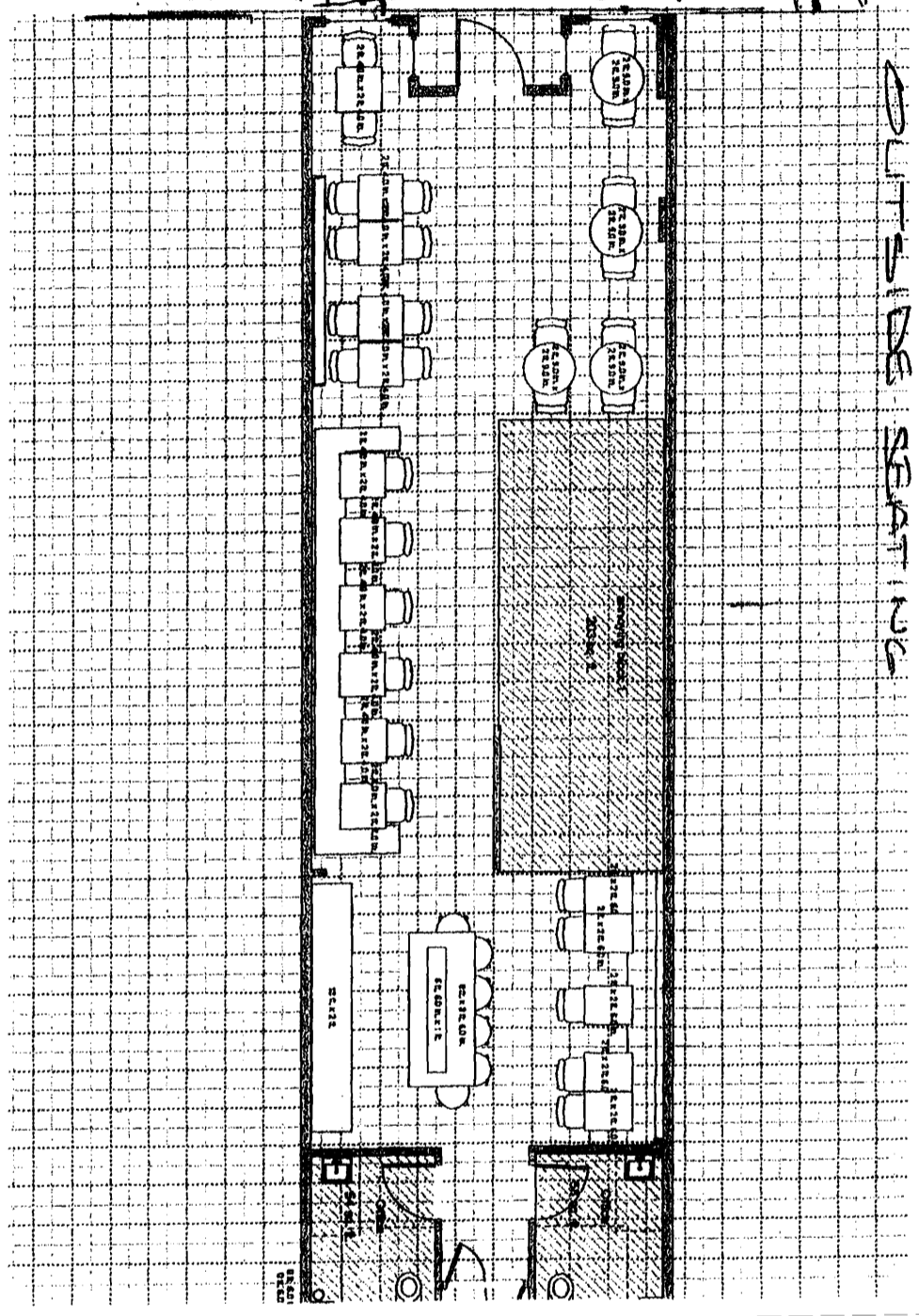
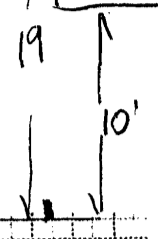
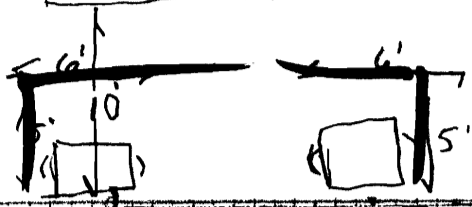

OUTSIDE SEATING

ACORD CERTIFICATE OF LIABILITY INSURANCE		CSR RC FOXVI-1	DATE (MM/DD/YYYY) 04/14/09
PRODUCER Bragdon Insurance, Inc. 286 York St PO Box 468 York ME 03909-0468 Phone: 207-363-3200 Fax: 207-363-1023	THIS CERTIFICATE IS ISSUED AS A MATTER OF INFORMATION ONLY AND CONFERS NO RIGHTS UPON THE CERTIFICATE HOLDER. THIS CERTIFICATE DOES NOT AMEND, EXTEND OR ALTER THE COVERAGE AFFORDED BY THE POLICIES BELOW.		
INSURED Foxville Group, LLC PO Box 852 Portland ME 04104	INSURERS AFFORDING COVERAGE INSURER A: MiddleOak INSURER B: INSURER C: INSURER D: INSURER E:	NAIC #	

COVERAGES

THE POLICIES OF INSURANCE LISTED BELOW HAVE BEEN ISSUED TO THE INSURED NAMED ABOVE FOR THE POLICY PERIOD INDICATED. NOTWITHSTANDING ANY REQUIREMENT, TERM OR CONDITION OF ANY CONTRACT OR OTHER DOCUMENT WITH RESPECT TO WHICH THIS CERTIFICATE MAY BE ISSUED OR MAY PERTAIN, THE INSURANCE AFFORDED BY THE POLICIES DESCRIBED HEREIN IS SUBJECT TO ALL THE TERMS, EXCLUSIONS AND CONDITIONS OF SUCH POLICIES. AGGREGATE LIMITS SHOWN MAY HAVE BEEN REDUCED BY PAID CLAIMS.

INSR LTR	TYPE OF INSURANCE	POLICY NUMBER	POLICY EFFECTIVE DATE (MM/DD/YY)	POLICY EXPIRATION DATE (MM/DD/YY)	LIMITS
A	GENERAL LIABILITY <input checked="" type="checkbox"/> COMMERCIAL GENERAL LIABILITY <input type="checkbox"/> CLAIMS MADE <input checked="" type="checkbox"/> OCCUR GENL AGGREGATE LIMIT APPLIES PER <input type="checkbox"/> POLICY <input type="checkbox"/> PRO-JECT <input type="checkbox"/> LOC	CP0100037075	02/23/09	02/23/10	EACH OCCURRENCE \$ 1000000 DAMAGE TO RENTED PREMISES (Ea occurrence) \$ 300000 MED EXP (Any one person) \$ 10000 PERSONAL & ADV INJURY \$ 1000000 GENERAL AGGREGATE \$ 2000000 PRODUCTS - COMP/OP AGG \$ 2000000
	AUTOMOBILE LIABILITY <input type="checkbox"/> ANY AUTO <input type="checkbox"/> ALL OWNED AUTOS <input type="checkbox"/> SCHEDULED AUTOS <input type="checkbox"/> HIRED AUTOS <input type="checkbox"/> NON-OWNED AUTOS				COMBINED SINGLE LIMIT (Ea accident) \$ BODILY INJURY (Per person) \$ BODILY INJURY (Per accident) \$ PROPERTY DAMAGE (Per accident) \$
	GARAGE LIABILITY <input type="checkbox"/> ANY AUTO				AUTO ONLY - EA ACCIDENT \$ OTHER THAN AUTO ONLY: EA ACC \$ AGG \$
	EXCESS/UMBRELLA LIABILITY <input type="checkbox"/> OCCUR <input type="checkbox"/> CLAIMS MADE DEDUCTIBLE RETENTION \$				EACH OCCURRENCE \$ AGGREGATE \$ \$ \$
	WORKERS COMPENSATION AND EMPLOYERS' LIABILITY ANY PROPRIETOR/PARTNER/EXECUTIVE OFFICER/MEMBER EXCLUDED? If yes, describe under SPECIAL PROVISIONS below				WC STATUTORY LIMITS OTH-ER E. L. EACH ACCIDENT \$ E. L. DISEASE - EA EMPLOYEE \$ E. L. DISEASE - POLICY LIMIT \$
	OTHER				

DESCRIPTION OF OPERATIONS / LOCATIONS / VEHICLES / EXCLUSIONS ADDED BY ENDORSEMENT / SPECIAL PROVISIONS
Restaurant including outside seating- City of Portland is named as Additional Insured

CERTIFICATE HOLDER City of Portland 389 Congress Street Portland ME 04101	CANCELLATION SHOULD ANY OF THE ABOVE DESCRIBED POLICIES BE CANCELLED BEFORE THE EXPIRATION DATE THEREOF, THE ISSUING INSURER WILL ENDEAVOR TO MAIL <u>10</u> DAYS WRITTEN NOTICE TO THE CERTIFICATE HOLDER NAMED TO THE LEFT, BUT FAILURE TO DO SO SHALL IMPOSE NO OBLIGATION OR LIABILITY OF ANY KIND UPON THE INSURER, ITS AGENTS OR REPRESENTATIVES. AUTHORIZED REPRESENTATIVE Roswitha Coughlin
---	--