

DISPLAY THIS CARD ON PRINCIPAL FRONTAGE OF WORK



CITY OF PORTLAND BUILDING PERMIT

This is to certify that **NOSH KITCHEN BAR**

Located At **551 CONGRESS ST**

Job ID: **2012-05-4024-OSD**

CBL: **037-C-016-001**

has permission to **4 Tables; 8 Chairs; Nosh Kitchen Bar 100 sq ft** provided that the person or persons, firm or corporation accepting this permit shall comply with all of the provisions of the Statues of Maine and of the Ordinances of the City of Portland regulating the construction, maintenance and use of the buildings and structures, and of the application on file in the department.

Notification of inspection and written permission procured before this building or part thereof is lathed or otherwise closed-in. **48 HOUR NOTICE IS REQUIRED.**

A final inspection must be completed by owner before this building or part thereof is occupied. If a certificate of occupancy is required, it must be

Fire Prevention Officer

Code Enforcement Officer / Plan Reviewer

8-21-12

**THIS CARD MUST BE POSTED ON THE STREET SIDE OF THE PROPERTY
PENALTY FOR REMOVING THIS CARD**

BUILDING PERMIT INSPECTION PROCEDURES

Please call 874-8703 or 874-8693 (ONLY)

or email: buildinginspections@portlandmaine.gov

With the issuance of this permit, the owner, builder or their designee is required to provide adequate notice to the city of Portland Inspections Services for the following inspections.

Appointments must be requested 48 to 72 hours in advance of the required inspection. The inspection date will need to be confirmed by this office.

- **Please read the conditions of approval that is attached to this permit!! Contact this office if you have any questions.**
- **Permits expire in 6 months. If the project is not started or ceases for 6 months.**
- **If the inspection requirements are not followed as stated below additional fees may be incurred due to the issuance of a "Stop Work Order" and subsequent release to continue.**

The project cannot move to the next phase prior to the required inspection and approval to continue, **REGARDLESS OF THE NOTICE OF CIRCUMSTANCES.**

IF THE PERMIT REQUIRES A CERTIFICATE OF OCCUPANCY, IT MUST BE PAID FOR AND ISSUED TO THE OWNER OR DESIGNEE BEFORE THE SPACE MAY BE OCCUPIED.

City of Portland, Maine - Building or Use Permit Application

389 Congress Street, 04101 Tel: (207) 874-8703, FAX: (207) 8716

Job No: 2012-05-4024-OSD	Date Applied: 5/18/2012	CBL: 037- C-016-001	
Location of Construction: 551 CONGRESS ST	Owner Name: 551 CONGRESS STREET LLC	Owner Address: PO BOX 6799 SCARBOROUGH, ME 04070	Phone:
Business Name: Nosh Kitchen Bar	Contractor Name: Lessee	Contractor Address: 551 Congress Street	Phone: 749-0340
Lessee/Buyer's Name:	Phone:	Permit Type: OUTDOOR	Zone: B-3
Past Use: 1 st floor Restaurant	Proposed Use: Same: 1 st floor Restaurant –to have outdoor seating for 2012	Cost of Work:	CEO District:
		Fire Dept: <input type="checkbox"/> Approved <input type="checkbox"/> Denied <input type="checkbox"/> N/A Signature:	Inspection: Use Group: Type: Signature:
Proposed Project Description: 4 Tables; 8 Chairs		Pedestrian Activities District (P.A.D.)	

Permit Taken By: Brad

Zoning Approval

1. This permit application does not preclude the Applicant(s) from meeting applicable State and Federal Rules. 2. Building Permits do not include plumbing, septic or electrical work. 3. Building permits are void if work is not started within six (6) months of the date of issuance. False informatin may invalidate a building permit and stop all work.	Special Zone or Reviews <input type="checkbox"/> Shoreland <input type="checkbox"/> Wetlands <input type="checkbox"/> Flood Zone <input type="checkbox"/> Subdivision <input type="checkbox"/> Site Plan <input type="checkbox"/> Maj <input type="checkbox"/> Min <input type="checkbox"/> MM Date: <u>5/24/12</u>	Zoning Appeal <input type="checkbox"/> Variance <input type="checkbox"/> Miscellaneous <input type="checkbox"/> Conditional Use <input type="checkbox"/> Interpretation <input type="checkbox"/> Approved <input type="checkbox"/> Denied Date:	Historic Preservation <input type="checkbox"/> Not in Dist or Landmark <input type="checkbox"/> Does not Require Review <input type="checkbox"/> Requires Review <input type="checkbox"/> Approved <input type="checkbox"/> Approved w/Conditions <input type="checkbox"/> Denied Date:
	CERTIFICATION		

I hereby certify that I am the owner of record of the named property, or that the proposed work is authorized by the owner of record and that I have been authorized by the owner to make this application as his authorized agent and I agree to conform to all applicable laws of this jurisdiction. In addition, if a permit for work described in the application is issued, I certify that the code official's authorized representative shall have the authority to enter all areas covered by such permit at any reasonable hour to enforce the provision of the code(s) applicable to such permit.

SIGNATURE OF APPLICANT	ADDRESS	DATE	PHONE
RESPONSIBLE PERSON IN CHARGE OF WORK, TITLE		DATE	PHONE



Outdoor Dining Permit Application

If you or the property owner owes real estate or personal property taxes or user charges on any property within the City, payment arrangements must be made before permits of any kind are accepted.

<input type="checkbox"/> New Application for Outside Dining <input checked="" type="checkbox"/> Renewal Application for Outside Dining City Clerk signature for liquor license approval: _____ Pending Council Date: _____			
Location Name & Address: Nosh Kitchen BAR 551 Congress St.	Chart 037	Block C	Lot 016
Owner & Phone #: MATT MOYAN/JASON LORING/Tobey Moulton (207) 553-2227	Total Square Footage of Proposed Seating Area:¹ 100		
Applicant *must* be owner or lessee Name: Nosh Kitchen BAR Address: 551 Congress St City, State & Zip: Portland, ME 04101. E-Mail: matt@noshkitchenbar.com	Annual Fee: \$80 Total Sq. Ft.: 100 - Sq. Ft. Fee: (sq ft x \$2) \$ _____ (Due when issued) Total Fees: \$ _____ (Permit not issued until <u>all</u> fees are paid)		
Current use: <u>Nosh Kitchen BAR</u> Business name: <u>Nosh LLC.</u> Seating area dimensions: <u>10'x10' 100 sq ft.</u> How many chairs? <u>10</u> How many tables? <u>BARTOP SEATING.</u> <input checked="" type="checkbox"/> Yes Alcohol is served. <input type="checkbox"/> No Alcohol being served.			
Who should we contact for the pre-inspection: <u>Matt Moya</u> Mailing address: <u>58 Wilson St. Portland, ME 04101</u> Phone: <u>(207) 749-0340</u>			

Please submit all of the information outlined in the Outdoor Dining Application Checklist. Failure to do so will result in the automatic denial of your permit.

In order to be sure the City fully understands the full scope of the project, the Planning and Development Department may request additional information prior to the issuance of a permit. For further information visit us on-line at www.portlandmaine.gov, stop by the Building Inspections office, room 315 City Hall or call 874-8703.

I hereby certify that I am the Owner of record of the named property, or that the owner of record authorizes the proposed work and that I have been authorized by the owner to make this application as his/her authorized agent. I agree to conform to all applicable laws of this jurisdiction. In addition, if a permit for work described in this application is issued, I certify that the Code Official's authorized representative shall have the authority to enter all areas covered by this permit at any reasonable hour to enforce the provisions of the codes applicable to this permit.

Signature of Applicant: _____ Date: 8/26/13.

¹ In no instance shall the total square footage of dining area equal more than 10% of park space, unless the applicant receives a waiver from the Director of Parks and Recreation or his or her designee.

This is not a permit; you may not commence ANY work until the permit is issued.



OUTDOOR DINING PERMIT CHECKLIST

Permits are required for expanding food service establishments to the outside on City Property. The annual fee is \$80.00 plus \$2.00 per square foot of dining area on streets, sidewalks or other public ways and \$80.00 plus \$6.00 per square foot of dining area in city parks. The annual fee is due when you drop off your permit application. The square footage fee is paid when you pick up your permit. ***For purposes of fee calculation, the area abutting the buildings which border Monument Square and extending ten (10) feet from the facade of said buildings shall be considered a sidewalk. The ten (10) foot area shall be measured from that portion of the facade that protrudes furthest into the sidewalk. The area beyond the ten (10) foot sidewalk shall be considered park space.***

Outdoor dining is permitted year round under the permit; however, furniture must be removed in inclement weather to allow for sidewalk snow removal.

The permit must be renewed each year.

All of the following information is required and must be submitted. You will also be required to fill out an Outdoor Dining Permit Application.

A plot plan is required and must include:

- A drawing of the lot, where the building sits on the lot along with the lot and building dimensions
- The dimensional setback from the sidewalk to the building
- The location of the street, and if it's a corner lot, the intersecting streets
- The sidewalk along with its width and curbing location
- The location of the table and chair placement, including dimensions

(NOTE: there must be a minimum of four feet of open sidewalk from the outer boundary of the seating area to the curb, and a minimum of five feet on corners, and egress from the building must be maintained free of obstruction per the building code and NFPA Life Safety Code).

Additional Requirements:

- The permit holder is required to produce at the time of submission and maintain public liability insurance coverage in an amount of not less than four hundred thousand dollars (\$400,000) combined single limit for bodily injury, death and property damage, naming the City as an additional insured thereon.

All permits for outdoor dining are issued subject to the following conditions:

- The tables and chairs must be placed within the permitted area on the sidewalk in such a manner as to allow the free and safe passage of pedestrian traffic. If the tables and chairs are moved and located outside of the permitted outdoor seating area, they must be relocated to within the permitted area. Failure to contain the tables and chairs to the permitted area may result in a reduced permitted area or a revocation of the permit.

- The permit holder is responsible for keeping the outdoor seating area clean. The sidewalk area where the tables and chairs are located must be kept neat and free from litter and debris.
- No food shall be prepared outside.
- If alcohol is to be served, the permit holder must notify the City's Business Licensing Office in room 203 of City Hall or by telephone at 874-8557 and obtain approval for the service of alcohol outdoors. Additionally, State law requires that any outdoor area serving alcohol be segregated from the rest of the public.
- All tables and chairs shall be removed prior to a predicted snowfall and while any snow or ice exists within the designated outdoor seating area or within four feet from the boundaries thereof. The City will not be responsible for damage to any tables, chairs or other property that is not properly removed when the City is engaged in sidewalk maintenance activities.
- The permit holder shall comply with all applicable rules and regulations implemented by the city regarding outdoor dining.

Failure to comply with any of the above conditions will result in revocation or non-renewal of the permit.

I/We fully understand that the City of Portland, its agents, officers and employees accept no responsibility and will not be liable for any injury, harm or damage to my/our person or property arising out of the establishment's occupancy of the sidewalk or park space. To the fullest extent permitted by law, I/We do hereby agree to assume all risk of injury, harm or damage to my/our person or property (including but not limited to all risk of injury, harm or damage to my/our property cause by the negligence of the City of Portland, its agents, officers or employees) arising out of the establishment's occupancy of the sidewalk or park space. I/We hereby agree, to the fullest extent permitted by law, to defend, indemnify and hold harmless the City of Portland, its agents, officers and employees, from and against all claims, damages, losses and expenses, just or unjust, including, but not limited to costs of defense and attorney's fees, arising out of the establishment's occupancy of the sidewalk or park space, provided that any such claims, damage, loss or expense (1) is attributable to bodily injury, sickness, disease, or death, or to injury to or destruction of tangible property including the loss of use there from, and (2) is caused in whole or in part by any negligent act or omission of the establishment, anyone directly or indirectly employed by it, or anyone for whose act it may be liable.

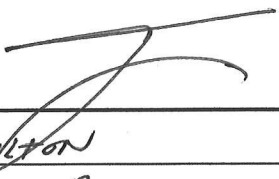
Signed and acknowledged:  Date: 8/26/13
 Printed name Tobey Moulton
 Establishment North Kitchen Bar
 Location 551 Congress St. Portland, ME 04101.

Outdoor Seating:
9'10" x 10'
EST. 100 SQ. FT.
10 SEATS.
NOTABLES / BAR TOP,

NOSH KITCHEN BAR -

(FRNT. ENTER -)

Dark Street,

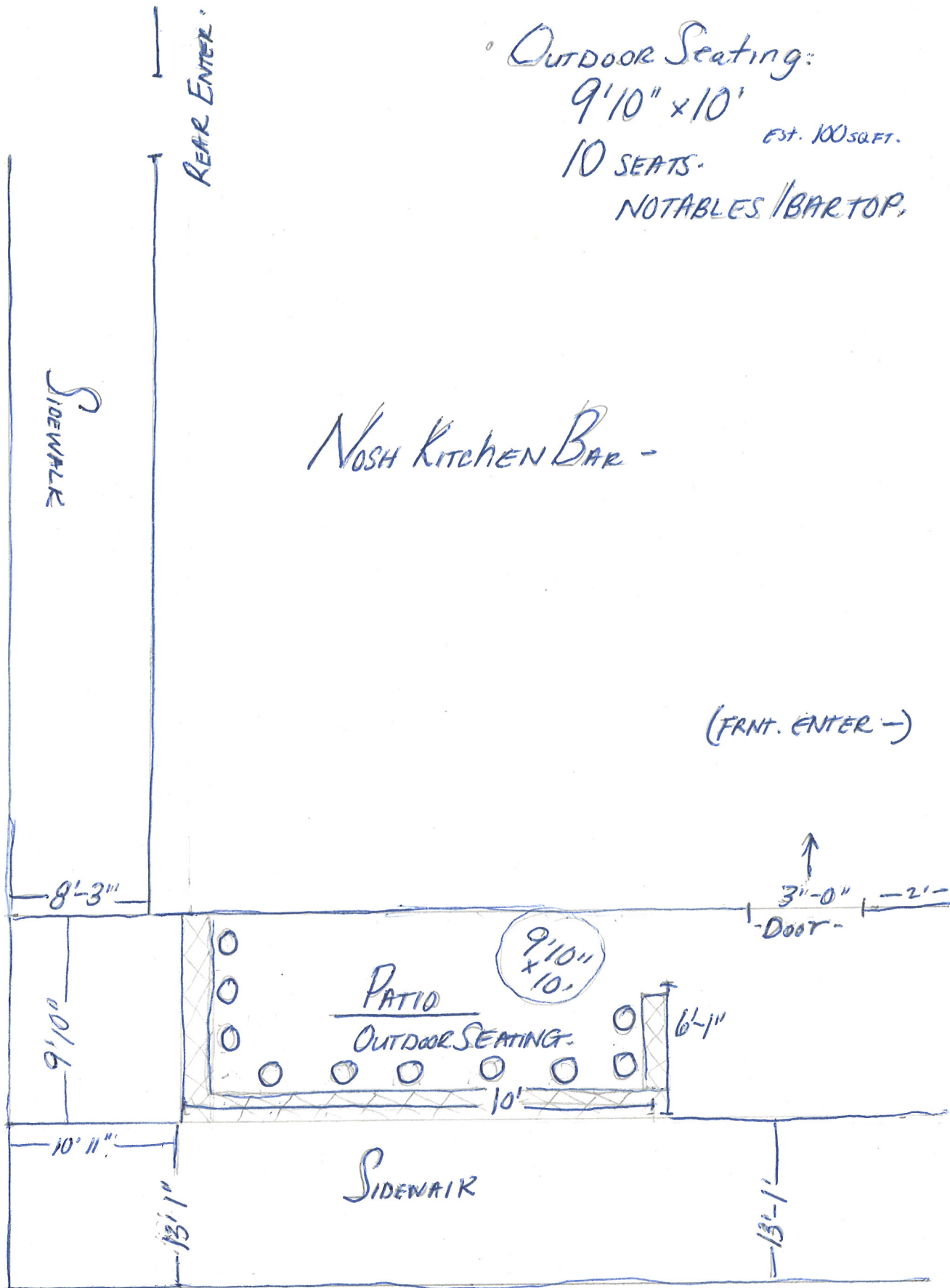

Congress Street.



NOSHLLC-01

AZIDOW

CERTIFICATE OF LIABILITY INSURANCE

DATE (MM/DD/YYYY)
8/26/2013

THIS CERTIFICATE IS ISSUED AS A MATTER OF INFORMATION ONLY AND CONFERS NO RIGHTS UPON THE CERTIFICATE HOLDER. THIS CERTIFICATE DOES NOT AFFIRMATIVELY OR NEGATIVELY AMEND, EXTEND OR ALTER THE COVERAGE AFFORDED BY THE POLICIES BELOW. THIS CERTIFICATE OF INSURANCE DOES NOT CONSTITUTE A CONTRACT BETWEEN THE ISSUING INSURER(S), AUTHORIZED REPRESENTATIVE OR PRODUCER, AND THE CERTIFICATE HOLDER.

IMPORTANT: If the certificate holder is an ADDITIONAL INSURED, the policy(ies) must be endorsed. If SUBROGATION IS WAIVED, subject to the terms and conditions of the policy, certain policies may require an endorsement. A statement on this certificate does not confer rights to the certificate holder in lieu of such endorsement(s).

PRODUCER Norton Insurance Agency 275 US Route 1 Cumberland Foreside, ME 04110	CONTACT NAME: PHONE (A/C, No, Ext): (207) 829-3450	FAX (A/C, No): (207) 829-6350	
	E-MAIL ADDRESS:		
INSURED Nosh LLC, Taco Escobarr 551 Congress Street Portland, ME 04101	INSURER(S) AFFORDING COVERAGE		NAIC #
	INSURER A : United States Liab Ins. Co.		
	INSURER B : Torus Specialty Insurance Company		
	INSURER C :		
	INSURER D :		
	INSURER E :		
INSURER F :			

COVERAGES**CERTIFICATE NUMBER:****REVISION NUMBER:**

THIS IS TO CERTIFY THAT THE POLICIES OF INSURANCE LISTED BELOW HAVE BEEN ISSUED TO THE INSURED NAMED ABOVE FOR THE POLICY PERIOD INDICATED. NOTWITHSTANDING ANY REQUIREMENT, TERM OR CONDITION OF ANY CONTRACT OR OTHER DOCUMENT WITH RESPECT TO WHICH THIS CERTIFICATE MAY BE ISSUED OR MAY PERTAIN, THE INSURANCE AFFORDED BY THE POLICIES DESCRIBED HEREIN IS SUBJECT TO ALL THE TERMS, EXCLUSIONS AND CONDITIONS OF SUCH POLICIES. LIMITS SHOWN MAY HAVE BEEN REDUCED BY PAID CLAIMS.

INSR LTR	TYPE OF INSURANCE	ADDL INSR	SUBR WVD	POLICY NUMBER	POLICY EFF (MM/DD/YYYY)	POLICY EXP (MM/DD/YYYY)	LIMITS
A	GENERAL LIABILITY	X		CL1566088A	11/11/2012	11/11/2013	EACH OCCURRENCE \$ 1,000,000
	COMMERCIAL GENERAL LIABILITY						DAMAGE TO RENTED PREMISES (Ea occurrence) \$
	CLAIMS-MADE <input checked="" type="checkbox"/> OCCUR						MED EXP (Any one person) \$
	X Liquor Liability						PERSONAL & ADV INJURY \$
	GEN'L AGGREGATE LIMIT APPLIES PER: POLICY <input type="checkbox"/> PRO-JECT <input type="checkbox"/> LOC <input type="checkbox"/>						GENERAL AGGREGATE \$ 1,000,000
							PRODUCTS - COMP/OP AGG \$
							\$
	AUTOMOBILE LIABILITY						COMBINED SINGLE LIMIT (Ea accident) \$
	ANY AUTO						BODILY INJURY (Per person) \$
	ALL OWNED AUTOS						BODILY INJURY (Per accident) \$
	HIRED AUTOS						PROPERTY DAMAGE (Per accident) \$
							\$
B	UMBRELLA LIAB <input checked="" type="checkbox"/> OCCUR			76969C121ALI	11/11/2012	11/11/2013	EACH OCCURRENCE \$ 1,000,000
	X EXCESS LIAB						AGGREGATE \$
	DED <input checked="" type="checkbox"/> RETENTION \$ 10,000						Aggregate \$ 1,000,000
	WORKERS COMPENSATION AND EMPLOYERS' LIABILITY						WC STATUTORY LIMITS
	ANY PROPRIETOR/PARTNER/EXECUTIVE OFFICER/MEMBER EXCLUDED? (Mandatory in NH)						OTHER
	If yes, describe under DESCRIPTION OF OPERATIONS below		N/A				E.L. EACH ACCIDENT \$
							E.L. DISEASE - EA EMPLOYEE \$
							E.L. DISEASE - POLICY LIMIT \$
A	Liquor Liability			CL1566088A	11/11/2012	11/11/2013	1,000,000

DESCRIPTION OF OPERATIONS / LOCATIONS / VEHICLES (Attach ACORD 101, Additional Remarks Schedule, if more space is required)

Certificate holder has Additional Insured status as provided on the policies in the column above as required by written contract.

CERTIFICATE HOLDER**CANCELLATION**

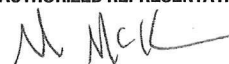
City of Portland 389 Congress St. Rm 312 Portland, ME 04101	SHOULD ANY OF THE ABOVE DESCRIBED POLICIES BE CANCELLED BEFORE THE EXPIRATION DATE THEREOF, NOTICE WILL BE DELIVERED IN ACCORDANCE WITH THE POLICY PROVISIONS.
	AUTHORIZED REPRESENTATIVE 

© 1988-2010 ACORD CORPORATION. All rights reserved.