

DISPLAY THIS CARD ON PRINCIPAL FRONTAGE OF WORK CITY OF PORTLAND

BUILDING CONSTRUCTION

PERMIT

Please Read Application And Notes, If Any, Attached

Permit Number: 071466

PERMIT ISSUED

DEC 19 2007

This is to certify that HEGA REALTY TRUST / D C Paint Modeling
has permission to Mandated security update - re-late wall w balli resistant floor & window 20 line 1 foot 1 w
AT 531 CONGRESS ST 3rd floor 037 C014001
provided that the person or persons, firm or corporation accepting this permit shall comply with all of the provisions of the Statutes of Maine and of the ordinances of the City of Portland regulating the construction, maintenance and use of buildings and structures, and of the application on file in this department.

Apply to Public Works for street line and grade if nature of work requires such information.

Notification inspection must given and written permission procured before this building or part thereof lashed or closed-in. HOURS NOTICE IS REQUIRED.

A certificate of occupancy must be procured by owner before this building or part thereof is occupied.

OTHER REQUIRED APPROVALS

Fire Dept. Greg Cross
Health Dept. _____
Appeal Board _____
Other _____
Department Name

12/19/07 Cheryl R
Director - Building & Inspection Services

PENALTY FOR REMOVING THIS CARD

City of Portland, Maine - Building or Use Permit Application

389 Congress Street, 04101 Tel: (207) 874-8703, Fax: (207) 874-8716

Permit No: 07-1466	Issue Date: 12/13/07	CBL: 037 C014001
-----------------------	-------------------------	---------------------

Location of Construction: 531 CONGRESS ST 3rd floor	Owner Name: HEGA REALTY TRUST	Owner Address: 218 EAST RD	Phone:
Business Name:	Contractor Name: DMC Painting & Remodeling	Contractor Address: One City Ctr Portland	Phone 2078711080
Lessee/Buyer's Name	Phone:	Permit Type: Alterations - Commercial	Zone: B-3

Past Use: Commercial Office 3rd floor Lobby of the Probation & Parole Office	Proposed Use: Commercial Office 3rd floor Lobby of the Probation & Parole Office - Mandated security update- relocate wall new ballistic resistand door & window 20 linear foot wall	Permit Fee: \$120.00	Cost of Work: \$10,000.00	CEO District: 1
Proposed Project Description: Mandated security update- relocate wall new ballistic resistand door & window 20 linear foot wall		FIRE DEPT: <input checked="" type="checkbox"/> Approved <input type="checkbox"/> Denied	INSPECTION: Use Group: B Type: <i>IBC 2003</i>	
		Signature: <i>Greg Cass</i> Signature: <i>12/16/07 [Signature]</i>		
		PEDESTRIAN ACTIVITIES DISTRICT (P.A.D.)		
		Action: <input type="checkbox"/> Approved <input type="checkbox"/> Approved w/Conditions <input type="checkbox"/> Denied		
		Signature: _____ Date: _____		

Permit Taken By: Iobson	Date Applied For: 12/03/2007	Zoning Approval		
----------------------------	---------------------------------	------------------------	--	--

- This permit application does not preclude the Applicant(s) from meeting applicable State and Federal Rules.
- Building permits do not include plumbing, septic or electrical work.
- Building permits are void if work is not started within six (6) months of the date of issuance. False information may invalidate a building permit and stop all work..

Special Zone or Reviews <input type="checkbox"/> Shoreland <input type="checkbox"/> Wetland <input type="checkbox"/> Flood Zone <input type="checkbox"/> Subdivision <input type="checkbox"/> Site Plan Maj <input type="checkbox"/> Minor <input type="checkbox"/> MM <input type="checkbox"/> Date: <i>12/14/07 ABN</i>	Zoning Appeal <input type="checkbox"/> Variance <input type="checkbox"/> Miscellaneous <input type="checkbox"/> Conditional Use <input type="checkbox"/> Interpretation <input type="checkbox"/> Approved <input type="checkbox"/> Denied Date: _____	Historic Preservation Yes <input type="checkbox"/> Not in District or Landmark <input type="checkbox"/> Does Not Require Review <input type="checkbox"/> Requires Review <input type="checkbox"/> Approved <input type="checkbox"/> Approved w/Conditions <input type="checkbox"/> Denied Date: <i>work requires</i>
---	---	---

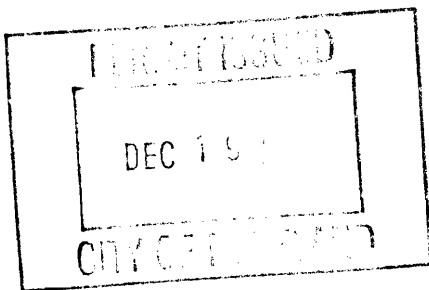

Any exterior work requires separate review & approval thru Historic Preservation.

CERTIFICATION

I hereby certify that I am the owner of record of the named property, or that the proposed work is authorized by the owner of record and that I have been authorized by the owner to make this application as his authorized agent and I agree to conform to all applicable laws of this jurisdiction. In addition, if a permit for work described in the application is issued, I certify that the code official's authorized representative shall have the authority to enter all areas covered by such permit at any reasonable hour to enforce the provision of the code(s) applicable to such permit.

SIGNATURE OF APPLICANT	ADDRESS	DATE	PHONE
RESPONSIBLE PERSON IN CHARGE OF WORK, TITLE		DATE	PHONE

City of Portland, Maine - Building or Use Permit

389 Congress Street, 04101 Tel: (207) 874-8703, Fax: (207) 874-8716

Permit No: 07-1466	Date Applied For: 12/03/2007	CBL: 037 C014001
------------------------------	--	----------------------------

Location of Construction: 531 CONGRESS ST 3rd floor	Owner Name: HEGA REALTY TRUST	Owner Address: 218 EAST RD	Phone:
Business Name:	Contractor Name: DMC Painting & Remodeling	Contractor Address: One City Ctr Portland	Phone (207) 871-1080
Lessee/Buyer's Name	Phone:	Permit Type: Alterations - Commercial	

Proposed Use: Commercial Office 3rd floor Lobby of the Probation & Parole Office - Mandated security update- relocate wall new ballistic resistand door & window 20 linear foot wall	Proposed Project Description: Mandated security update- relocate wall new ballistic resistand door & window 20 linear foot wall
--	---

Dept: Zoning **Status:** Approved with Conditions **Reviewer:** Ann Machado **Approval Date:** 12/04/2007

Note: **Ok to Issue:**

- 1) ANY exterior work requires a separate review and approval thru Historic Preservation. This property is located within an Historic District.
- 2) This permit is being approved on the basis of plans submitted. Any deviations shall require a separate approval before starting that work.

Dept: Building **Status:** Approved with Conditions **Reviewer:** Chris Hanson **Approval Date:** 12/19/2007

Note: **Ok to Issue:**

- 1) Application approval based upon information provided by applicant. Any deviation from approved plans requires separate review and approval prior to work.
- 2) Separate permits are required for any electrical, plumbing, or HVAC systems. Separate plans may need to be submitted for approval as a part of this process.

Dept: Fire **Status:** Approved **Reviewer:** Capt Greg Cass **Approval Date:** 12/04/2007

Note: **Ok to Issue:**



General Building Permit Application

If you or the property owner owes real estate or personal property taxes or user charges on any property within the City, payment arrangements must be made before permits of any kind are accepted.

301

Location/Address of Construction: <u>537 CONGRESS ST. - 3RD FLOOR</u>		
Total Square Footage of Proposed Structure/Area <u>NO EXPANSION</u>	Square Footage of Lot <u>16,957</u>	<u>LOBBY</u>
Tax Assessor's Chart, Block & Lot Chart# <u>37</u> Block# <u>C</u> Lot# <u>14</u>	Applicant *must be owner, Lessee or Buyer* Name <u>DIRIGO MANAGEMENT</u> Address <u>1 CITY CENTER</u> City, State & Zip <u>FORTLAND, ME</u>	Telephone: <u>8711080</u>
Lessee/DBA (If Applicable) <u>UNITED STATES PROBATION + PAROLE OFFICE</u>	Owner (if different from Applicant) Name <u>MICA READY TRUST</u> Address <u>218 EAST RD.</u> City, State & Zip <u>03841 NH</u>	Cost Of Work: \$ <u>9,000.</u> C of O Fee: \$ _____ Total Fee: \$ _____
Current legal use (i.e. single family) <u>OFFICE</u> If vacant, what was the previous use? <u>N/A</u> Proposed Specific use: <u>NO CHANGE.</u> Is property part of a subdivision? <u>NO</u> If yes, please name _____ Project description: <u>MANDATED SECURITY UPDATE - RELOCATE WALL NEW BALLISTIC RESISTANT DOOR & WINDOW 20 LINEAR FOOT WALL</u>		
Contractor's name: <u>DMC REMODELING</u> Address: <u>59 SANFORD DR. SUITE 3</u> City, State & Zip <u>GORHAM, ME 04038</u> Telephone: <u>8561838</u> Who should we contact when the permit is ready: <u>MIKE NUGENT</u> Telephone: <u>3292354</u> Mailing address: <u>SAME</u>		

Please submit all of the information outlined on the applicable Checklist. Failure to do so will result in the automatic denial of your permit.

In order to be sure the City fully understands the full scope of the project, the Planning and Development Department may request additional information prior to the issuance of a permit. For further information or to download copies of this form and other applications visit the Inspections Division on-line at www.portlandmaine.gov, or stop by the Inspections Division office, room 315 City Hall or call 874-8703.

I hereby certify that I am the Owner of record of the named property, or that the owner of record authorizes the proposed work and that I have been authorized by the owner to make this application as his/her authorized agent. I agree to conform to all applicable laws of this jurisdiction. In addition, if a permit for work described in this application is issued, I certify that the Code Official's authorized representative shall have the authority to enter all areas covered by this permit at any reasonable hour to enforce the provisions of the codes applicable to this permit.

Signature: [Signature] Date: 11/29/07

This is not a permit; you may not commence ANY work until the permit is issue

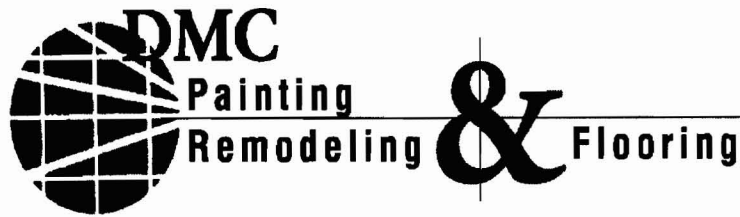

A division of Dirigo Management Company
59 Sanford Drive, Suite 3
Gorham, Maine 04038
(207) 856-1838 Fax (207) 856-9719

Date: November 29, 2007

To: The City of Portland Inspections Office

Project Name: Demo wall/ Build new wall install door and window/install carpet

Location: Probation & Parole Space, 3rd floor, J.B. Brown Building, 537 Congress St., Portland, Maine

Job Description and Specifications

We hereby submit specifications for:

- Demo existing wall between offices and waiting area
- Construct an new wall, relocated to expand waiting area. Framing of partition wall with 3 5/8 inch metal studs, spaced 16 inches on center, R-13 insulation in the cavities, 5/8 inch gypsum wall board. Wall will extend to the underside of the floor above. Wall will have one layer of 5/8 " Fibre Tex Level 3 Bullet Resistant Opaque wall armor on the waiting area side between the studs and drywall.
- The Cost of the wall demo and construction w/paint, not including the Bullet Resistant element
- One layer of 5/8 " Fibre Tex Level 3 Bullet Resistant Opaque wall armor on the waiting area side between the studs and drywall
- Install 1 3068 (UL752) Bullet Resistant Door and frames w/ continuous hinge, mortise lockset and self closer:
- Install 1 Bullet resistant transaction window, natural voice transmission and Deal tray/Level 3 UL 752
- Repair existing wall where adjoining wall was demolished, paint to match existing
- Swap the door slab from office 105 with the door in the waiting area that leads to the galley area without disturbing the existing frames

- Prep and paint new door frame and window frame to match existing.
- Remove carpet in the reception area Install 66.7 s.y. of Ayers Hall or equivalent Carpet & resulting cove base.
- Patch/ tie together suspended ceiling
- Obtain required permits
- Dispose of Demo Debris
- Clean jobsite daily.

Please review the attached submissions. We would like to commence construction on December 17th, 2007.

Thanks,



Mike Nugent

DMC Manager of Construction Services

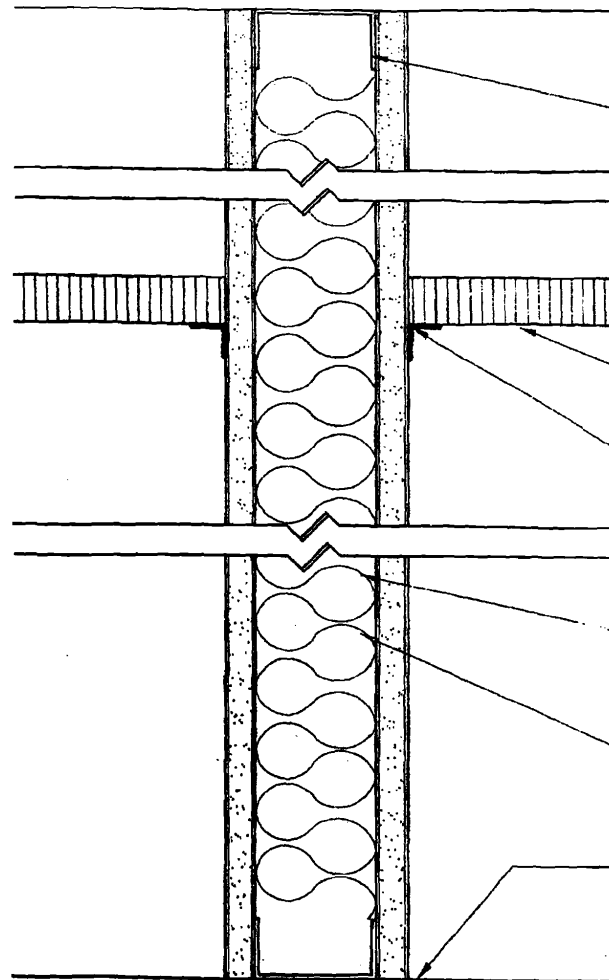

Attach and seal tight, metal studs, to underside of deck above.

Suspended acoustical ceiling tile.

USG Model #200-A metal trim. Finish with joint compound.

Sound insulation throughout entire wall cavity.

3 5/8" 25 ga. metal studs at 16" o.c. with 5/8" gyp. board full height each side.

Floor line

NOTE: At walls "3A" use 5/8" type "X" gyp. board. "3A" wall to be constructed to achieve 1 hour fire rating.

WALL TYPE #3

3" = 1'-0"

3
IN101

WAL

3" = 1'-0"

2'-0"

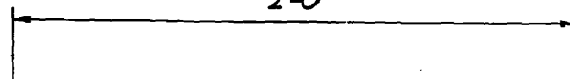

C:\MASTERS\ARMORTEX\FBERNS\F1010500A.DWG, DWG 05/03/04 @ 12:11 User: cperez

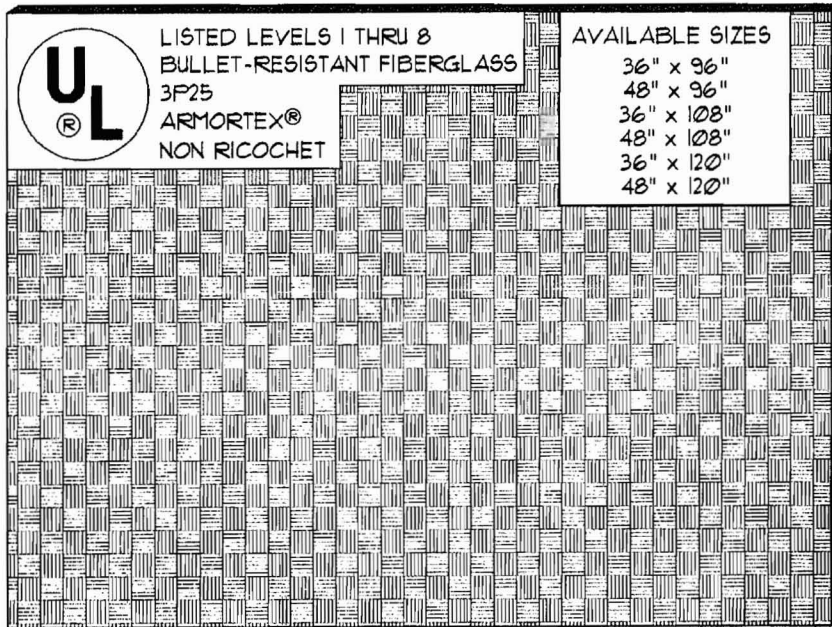

**ARMORTEX® UL LISTED BULLET RESISTANT FIBERGLASS
 (PANEL SIZES)**

REVISIONS			SAFEGUARD SECURITY SERVICES, Ltd.			DRN.BY:		DATE:		
No.	DESCRIPTION	DATE	4728 GOLDFIELD, BLDG. 8 SAN ANTONIO, TX. 78218 TEL: 210-661-8306 800-880-8306 FAX: 210-661-8308			A. Perez		03-14-03		
			TITLE: ARMORTEX® UL LISTED BULLET RESISTANT FIBERGLASS			PROJECT NAME:		CHKD.BY:		
			UNLESS OTHERWISE SPECIFIED ALL DIMENSIONS ARE IN INCHES			SCALE NONE	PROJECT No.	DRAWING No. F1010500A		SHEET 1 OF 1

NOTES:

- ① ARMORTEX® BULLET RESISTANT FIBERGLASS PANEL
- ② BATTEN STRIP (CUT FROM FIBERGLASS FULL SHEET)
- ③ DRY WALL PANEL (BY OTHERS)
- ④ STEEL OR WOOD STUDS (BY OTHERS)

NOTE:

JOINTS BETWEEN FIBERGLASS PANELS
MUST BE KEPT AS TIGHT AS POSSIBLE

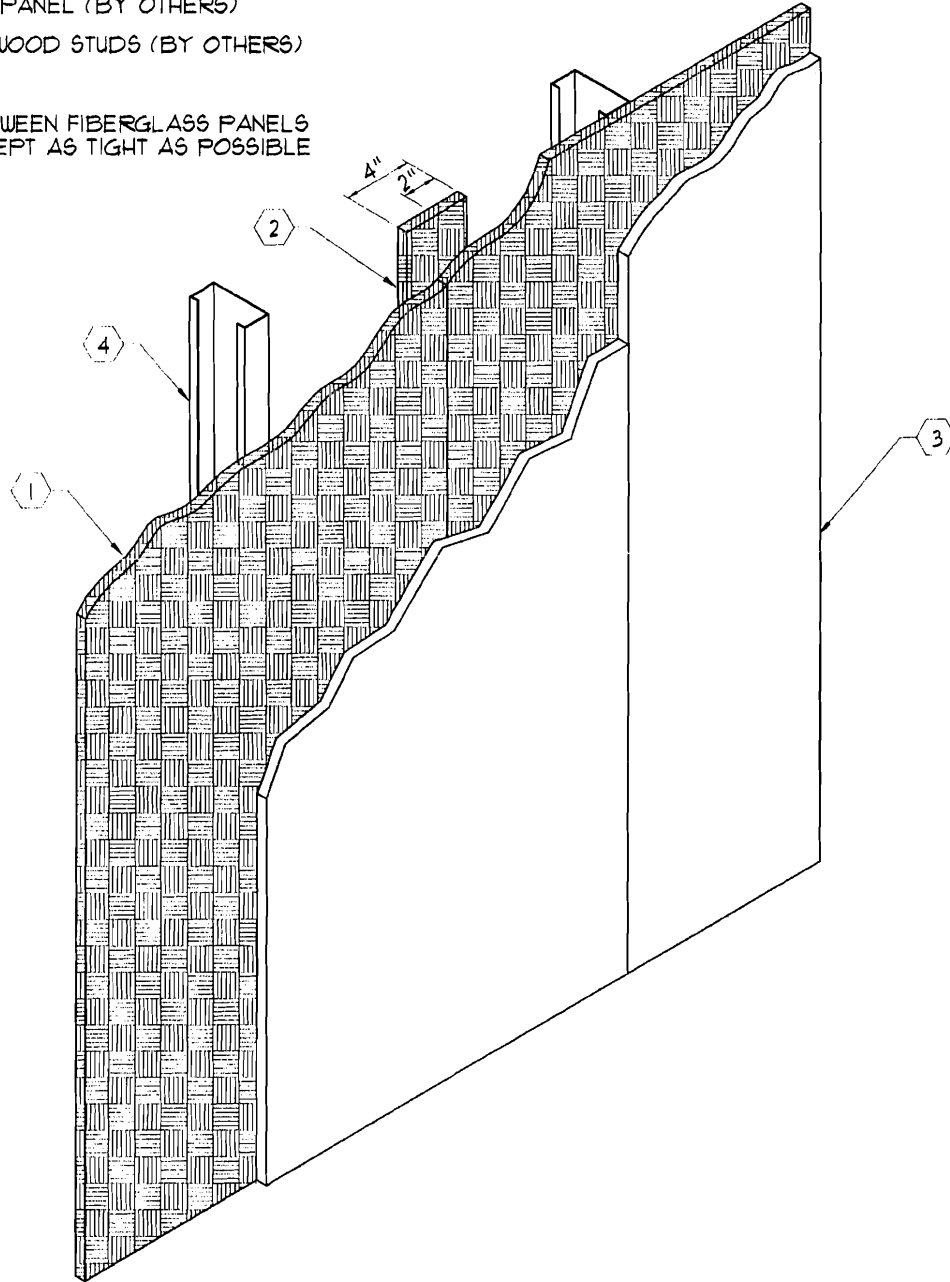

C:\MASTERS\ARMORTEX\F.BERNS\F1010501.DWG.DWG 08/25/03 @ 4:19 User: ocy perez

REVISIONS			SAFEGUARD SECURITY SERVICES, Ltd. 4728 GOLDFIELD, BLDG. 8 SAN ANTONIO, TX. 78218 TEL: 210-661-8306 800-880-8306 FAX: 210-661-8308		BALLISTIC LEVEL	
No.	DESCRIPTION	DATE			DRN.BY:	DATE:
			A. Perez	03-14-03		
			CHKD.BY:	DATE:		
			DRAWING No.	SHEET		
			F1010501	1 OF 1		

TITLE: ARMORTEX® BULLET RESISTANT FIBERGLASS INSTALLATION

UNLESS OTHERWISE SPECIFIED ALL DIMENSIONS ARE IN INCHES

PROJECT NAME:

SCALE: NONE

PROJECT No.:

NOTES:

- ① UL LISTED ARMORTEX® BULLET RESISTANT FIBERGLASS PANEL
- ② BATTEN STIP (CUT FROM FIBERGLASS FULL SHEET)
- ③ STEEL OR WOOD STUDS (BY OTHERS)
- ④ JOINTS BETWEEN FIBERGLASS PANELS MUST BE KEPT AS TIGHT AS POSSIBLE

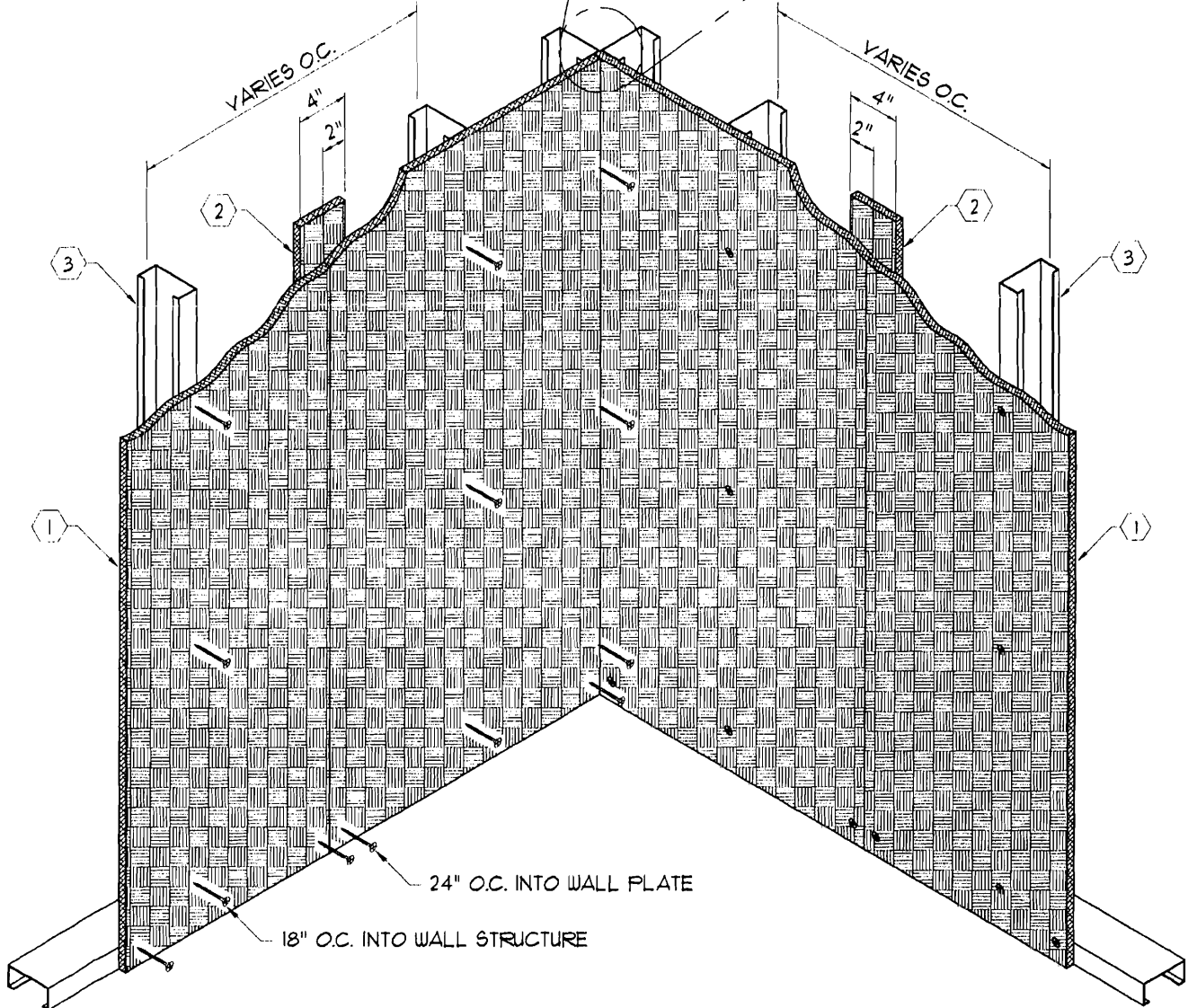
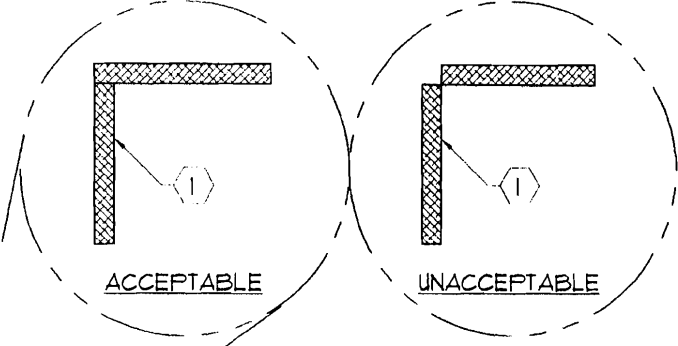

(BULLET RESISTANT PANEL SHOULD BE INSTALLED WITH FULL LOAD RESTING SECURELY AGAINST SLAB. ANCHOR TO WALL PLATE AND WALL STRUCTURE AS SHOWN.)

C:\MASTERS\ARMORTEX\FIBERINS\F1010504.DWG DWG 02/27/03 @ 14:24 User: andy perez

REVISIONS		
No.	DESCRIPTION	DATE

SAFEGUARD SECURITY SERVICES, Ltd.
 4728 GOLDFIELD, BLDG. 8 SAN ANTONIO, TX. 78218
 TEL: 210-661-8306 800-880-8306 FAX: 210-661-8308









TITLE: ARMORTEX® BULLET RESISTANT FIBERGLASS INSTALLATION
 UNLESS OTHERWISE SPECIFIED ALL DIMENSIONS ARE IN INCHES

PROJECT NAME: _____
 SCALE: NONE PROJECT No. _____

BALLISTIC LEVEL	
DRN. BY: A. Perez	DATE: 03-14-03
CHKD. BY:	DATE:
DRAWING No. F1010504	SHEET 1 OF 1

ARMORTEX® FIBERGLASS BALLISTIC CHART

U. L. - UNDERWRITERS LABORATORY

ARMORTEX® PRODUCT	NOMINAL WEIGHT LBS/SQ. FT. (KGS./SQ. MTR.)	NOMINAL THICKNESS INCHES (mm)	LEVEL (NOTES 1 & 2)	WEAPON	AMMUNITION	VELOCITY FT./SEC.
 O.F. 100	2.0 (101)	3/16 (5)	UL1 (MPSA)	9 mm	124 GR FMJ	1175-1295
 O.F. 200	3.0 (151)	5/16 (8)	UL 2 (HPSA)	.357 MAGNUM	158 GR SP	1250-1375
 O.F. 300	4.0 (201)	7/16 (12)	UL 3 (SPSA)	.44 MAGNUM	240 GR LEAD	1350-1485
 O.F. 400	12.0 (59)	1 3/16 (30)	UL 4 (HPR)	.30 cal RIFLE	180 GR SP	2540-2794
 O.F. 500	14.5 (71)	1 3/8 (35)	UL 5	7.62 mm RIFLE	150 GR FMJ	2750-3025
 O.F. 600	3.0 (151)	5/16 (8)	UL 6	9 mm UZI	124 GR FMJ MS	1400-1540
 O.F. 700	11.5 (57)	1 1/8 (29)	UL 7	5.56 mm M-16	55 GR FMJ MS	3080-3388
 O.F. 800	14.5 (71)	1 3/8 (35)	UL 8	7.62 mm M-14	150 GR FMJ MS	2750-3025

NOTES:

-  UL LISTED PRODUCTS
- UL 152 REVISED 9th EDITION DATED JANUARY 21, 1995
AS TESTED BY H.P. WHITE LABORATORIES. (LEVELS 2 AND 3)

ABBREVIATIONS USED IN THIS CHART

UL - UNDERWRITERS LABORATORY
 SP - SOFT POINT
 GR - GRAINS
 MS - MULTIPLE SHOTS

MPSA - MEDIUM POWER SMALL ARMS
 HPSA - HIGH POWER SMALL ARMS
 SPSA - SUPER POWER SMALL ARMS

HPR - HIGH POWER RIFLE
 FMJ - FULL METAL JACKET

SAFEGUARD SECURITY SERVICES, Ltd.
TEL.(210) 661-8306 (800) 880-8306 FAX (210) 661-8308

ARMORTEX® FIBERGLASS BALLISTIC CHART

N. I. J. - NATIONAL INSTITUTE OF JUSTICE

ARMORTEX® PRODUCT	NOMINAL WEIGHT LBS/SQ. FT. (KGS/SQ. MTR.)	NOMINAL THICKNESS INCHES (mm)	LEVEL (NOTE 1)	WEAPON	AMMUNITION	VELOCITY FT./SEC.
A - 1	1.2 (6)	1/8 (3)	N.I.J. I	.22 LRHV .38 SPECIAL	40 GR LEAD 158 GR LEAD	1050 ± 40 850 ± 50
A - 2	2.4 (12)	1/4 (6)	N.I.J. II - A	.357 MAGNUM 9 mm	158 GR JSP 124 GR FMJ	1250 ± 50 1090 ± 40
OF. 200	3.0 (15)	5/16 (8)	N.I.J. II	.357 MAGNUM 9 mm	158 GR JSP 124 GR FMJ	1395 ± 50 1175 ± 40
A - 3	3.8 (19)	3/8 (10)	UN LISTED UL LEVEL 3 HP WHITE	.44 MAGNUM	240 GR LEAD	1350-1485
OF. 300	4.0 (20)	7/16 (12)	N.I.J. III - A	.44 MAGNUM 9 mm	240 GR LEAD 124 GR FMJ	1400 ± 50 1400 ± 50
A - 4	5.5 (27)	9/16 (14)	MIL-STD 662E V50	.30 cal CARBINE 12 ga SHOT GUN	110 GR FMJ 1 OZ. SLUG	2109 1864
OF. 400	12.0 (59)	1 3/16 (30)	N.I.J. III	7.62 mm RIFLE	150 GR FMJ	2750 ± 50

NOTE:

1. NIJ - NATIONAL INSTITUTE OF JUSTICE PRODUCTS 010301

ABBREVIATIONS USED IN THIS CHART

NIJ - NATIONAL INSTITUTE OF JUSTICE
GR - GRAINS

JSP - JACKETED SOFT POINT
FMJ - FULL METAL JACKET

LRHV - LONG RIFLE HIGH VELOCITY

SAFEGUARD SECURITY SERVICES, Ltd.

TEL. (210) 661-8306 (800) 880-8306 FAX (210) 661-8308

Material Safety Data Sheet

U.S. Department of Labor

May be used to comply with
OSHA's Hazard Communication Standard,
29 CFR 1910.1200. Standard must be
consulted for specific requirements.

Occupational Safety and Health Administration
(Non-Mandatory Form)

Form Approved

OMB No. 1218-0072

Manufacturer's Name **Safeguard Security Services,
Ltd.**

Emergency Telephone Number **210-661-8306**

Address (*Number, Street, City, State, and ZIP Code*)

Telephone Number for Information **210-661-8306**

4728 Goldfield, Bldg. 8

Date Prepared **2/16/99**

San Antonio, Texas 78218

Signature of Preparer (*optional*)

Section II - Hazard Ingredients/Identity Information

Boiling Point	N/A	Specific Gravity (H ₂ O = 1)	1.6 - 2.0
Vapor Pressure (mm Hg.)	N/A	Melting Point	N/A
Vapor Density (AIR = 1)	N/A	Evaporation Rate (Butyl Acetate = 1)	0

Solubility in Water **None**

Appearance and Odor **Light Beige - No Odor**

Section IV - Fire and Explosion Hazard Data

(Reproduce locally)

OSHA 174, Sept. 1985

Section V - Reactivity Data

Route(s) of Entry: **N/A** Inhalation? Skin? Ingestion?

Health Hazards (*Acute and Chronic*)

N/A

Carcinogenicity: **N/A** NTP? IARC Monographs? OSHA Regulated?

Signs and Symptoms of Exposure

Effects of overexposure: **Dust from grinding or finishing can cause mild irritation to the eyes and skin.
Nuisance dust.**

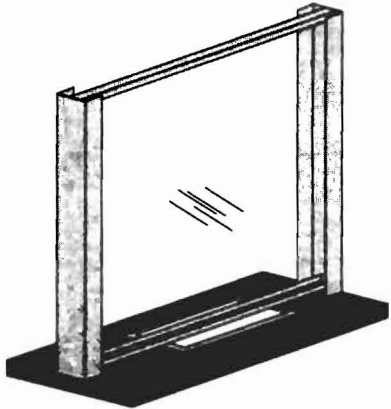

Standard SV Transaction Window

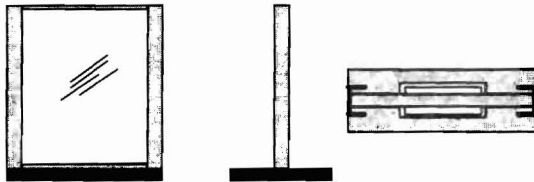

Typical Window Views



Units can be easily ganged together for multiple work stations

Typical SV Transaction window Dimensions

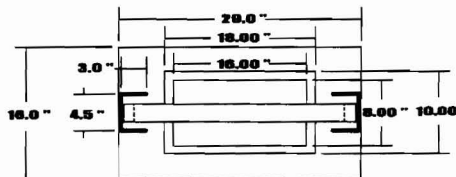

FEATURES

- Natural voice transmission system
- Stainless steel voice rails and cash tray
- Black Formica counter standard
- Use of GE Plastics Lexgard® laminates
- Delivered assembled & ready for installation
- Forced entry option available
- U.L. Listed

RECOMMENDED USES

- Cash Payment windows
- Ticket windows
- Reception / Interview windows

BALLISTIC OPTIONS

- U.L. 752 Levels 1 Thru 8 (only Level's 1-3 are UL Listed)
- NIJ STD-0108.00 Levels I Thru III

AVAILABLE SIZES

Standard Sizes	Approx. Shipping Wgt
29" x 40"	200 lbs.
48" x 42"	290 lbs.
60" x 42"	350 lbs.
72" x 42"	420 lbs.

Custom sizes available upon request

- For Exterior Applications see SVE Transaction Window Product Data Sheet
- For applications requiring a Pass-Thru Box or Package Exchanger to be in see SVPT Transaction Window Product Data Sheet.
- For applications requiring the forced entry option. Contact factory for forced entry capabilities.

BULLET RESISTING GLAZING MATERIAL OPTIONS

Level 1	1 1/4" Acrylic 1 1/4" SAR Coated Acrylic 3/4" Lexgard MP750 IC-1 Glazing System 1 3/16" BR glass
Level 2	IC-221.5 1 1/2" BR Glass 1 3/8" Acrylic
Level 3	1 1/4" Lexgard SP1250 IC-322 Glazing System IC-315 Glazing System BALULN25 GCP

*Above Insulgard glazing systems can be triple glazed with 1/4" tempered glass for additional abrasion resistance.

VOICE RAIL FINISH OPTIONS

- Stainless Steel (Standard)

COUNTER FINISH

- Black laminate (Standard)

SV TRANSACTION WINDOW



**GE Polymershapes
Insulgard**

HANDLING INFORMATION

Handling: Care should be exercised during shipping and handling to maintain transaction window appearance.

Storage: Store upright in a dry, well ventilated building or shelter at a constant temperature. Do not store in damp areas or freshly plastered buildings. Place unit on wood blocks at least 2" high to prevent moisture damage.

Application: Remove from protective container just prior to installation. Care should be exercised when installing window to insure that installation is level, plumb, square and secure.

Contact factory at 1-800-624-6315

Insulgard is a registered trademark of Insulgard Corporation
Lexgard is a registered trademark of the GE

1994 Copyright Insulgard Corporation

SPECIFICATIONS

A. Window Construction

1. Constructed of stainless steel side-around voice tubes, which surround vertical edges of bullet resisting glazing. Glazing affixed to voice tubes at top and bottom with side separation for natural voice transmission.
 - a. Voice tubes armored with bullet resisting material consistent with threat level.
 - b. Glazing is wrapped with anodized aluminum channels
2. Standard base construction is layered particle board with plastic laminate covering.
 - a. Base armored with bullet resisting material consistent with threat level.
 - b. Deal tray to be stainless steel with bullet-trap below. Bullet-trap bullet resistance to be consistent with threat level.

B. Window Glazing

1. Glazing materials shall be of a type listed by Underwriter's Laboratories, Standard 752 for bullet resistance and/or tested by H.P. White Laboratory for specified bullet resistance.
2. Bullet resisting protection level shall be as specified by end user and consistent with threat level.

INSTALLATION DETAILS

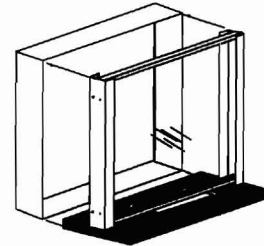

Rough opening should be 1/2" wider and 1/4" higher than size of unit ordered

1	Cut a finished opening in the wall sized to accept the standard SV Window.
2	Place preframed SV Window in opening, shim as necessary and attach sides to existing wall with screws, using anchors if the wall is masonry.
3	Apply finish trim molding obtained locally, and installation is complete.

WARRANTY

LIMITED WARRANTY

Insulgard warrants the SV Transaction Window against defects in quality and workmanship for a period of one year from the date of shipment. The warranties stated here replace and exclude all other warranties.

Insulgard's liability is limited to:

- 1.) replacing products that fail to meet specification, or are defective in quality or workmanship at the time of delivery; or
- 2.) providing credit for such products.

Insulgard will not be responsible for reinstallation expenses or any other direct or indirect losses, which may result from a defective product.

Insulgard reserves the right to choose between replacement or credit, and the right to field inspect any product alleged to be defective.

The buyer is responsible for any consequences resulting from product use. Since Insulgard Corporation has no control over how others use its products, it does not guarantee the same results as those discussed. All users should conduct test and evaluations for their own applications.

TECHNICAL SUPPORT

GE Polymershapes Insulgard maintains a full staff of professional and experienced sales representatives, project estimators, engineers, draftsmen, craftsmen and installers ready to assist in all phases of the bullet resistant project from initial design through installation. Consult our sales department or your local representative for assistance with all your bullet-resistant needs.

Contact factory at 1-800-624-6315

Phone: 1.800.624.6315

Website: www.insulgard.com

LC BULLET RESISTING DOOR SYSTEM



GE Polymershapes
Insulgard

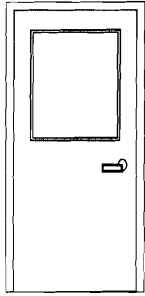

20 x 30 VIEW WINDOW

Door Styles

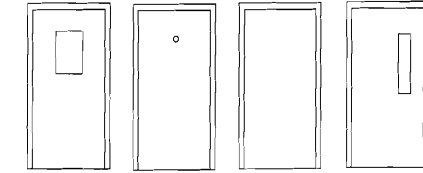

12 X 18 VIEW WINDOW

PEEPHOLE VIEWER

FULL OPAQUE

VERTICAL LITE VIEW

FEATURES

- U.L. LISTED LEVELS 1, 2 AND 3 ACRYLIC AND FIBERGLASS COMPONENTS
- HEAVY DUTY CONTINUOUS HINGE
- COMPLETE HARDWARE PROVIDED
- WIDE RANGE OF SIZES AVAILABLE
- ADA APPROVED CLOSER AND LOCKSET
- ANTI-JIMMY DEVICE (FOR OUTSWINGING DOORS)
- WIDE RANGE OF LAMINATE FINISHES
- FRAME SHIPPED WITH DOOR
- OTHER BALLISTIC OPTIONS AVAILABLE

PRODUCT DESCRIPTION

The INSULGARD LC Bullet Resisting door is designed to defeat ballistic assaults from a 9mm medium power through .44 magnum superpower small arms handgun as tested in accordance with U.L. Standard 752 at Underwriter's Laboratories. This door and frame system is designed to provide protection in those areas where a threat from ballistic attacks exist.

BASIC USE

- Applications include:
- Gas stations
 - Convenience stores
 - Banks
 - Law enforcement facilities
 - Pharmacies
 - Other retail applications.

LIMITATIONS

This door has been designed to meet the U.L. Listed 1, 2 and 3 specifications. It is recommended that each end user determine their ballistic threat and determine the correct product to resist that threat. Higher ballistic ratings are available as requested. Consult factory representative for details. It is recommended that this door and frame system be used in conjunction with protected wall areas.

SYSTEM CONSTRUCTION

The LC Door System is constructed with lumber core lined with a fiberglass liner. Exterior finish (standard) is plastic laminate.

Glazing material consists of U.L. Listed Levels 1, 2 and 3 acrylic or super abrasion-resistant acrylic. Window framing has no exposed fasteners and is finished to match exterior.

Door hardware (standard) will be:

- Continuous Hinge
 - Overhead Surface Closer
 - Schlage Lever Lockset
 - Anti-Jimmy Plate
 - Two Piece Door Stops
 - Electric Strike Release System
- keypad to protection's key cards*

Please consult factory for further information.

→ core existing

SIZES

Door thickness: varies
Frame thickness: 1 3/4" x 4"
Standard sizes: 36" x 80", 36" x 84"

FACTORY FINISH

A wide variety of plastic laminates, metal laminates, wood veneers, and prime paint finishes are available. Consult factory for details.

ALUMINUM FINISH OPTIONS

Standard hardware and frame finishes are dark bronze or clear anodized. Custom anodizing or baked enamel paint finishes are available but will delay delivery.

HARDWARE OPTIONS

Heavy-duty hardware is provided and meets American Disabilities Act (ADA) requirements. Custom hardware may be specified within design limitations.

SPECIFICATION

DOOR CONSTRUCTION

Door is to be constructed using a lumber core lined with a sheet of fiberglass. Exterior to be laminated or painted according to customer requirements.

DOOR FRAME CONSTRUCTION

Frame to be 1 3/4" x 4" aluminum slick tube. Frames to be completely fabricated and shipped for field installation. All joint connections to have concealed shear block to provide a rigid assembly when installed.

DOOR HANDING CHART

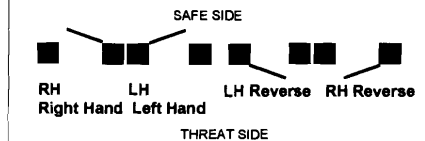

Phone: 1.800.624.6315

Website: www.insulgard.com