

ALL EXISTING CONDITIONS ARE TO BE VERIFIED IN THE FIELD BEFORE CONSTRUCTION AND ANY DISCREPANCIES ARE TO BE REPORTED TO THE ARCHITECT

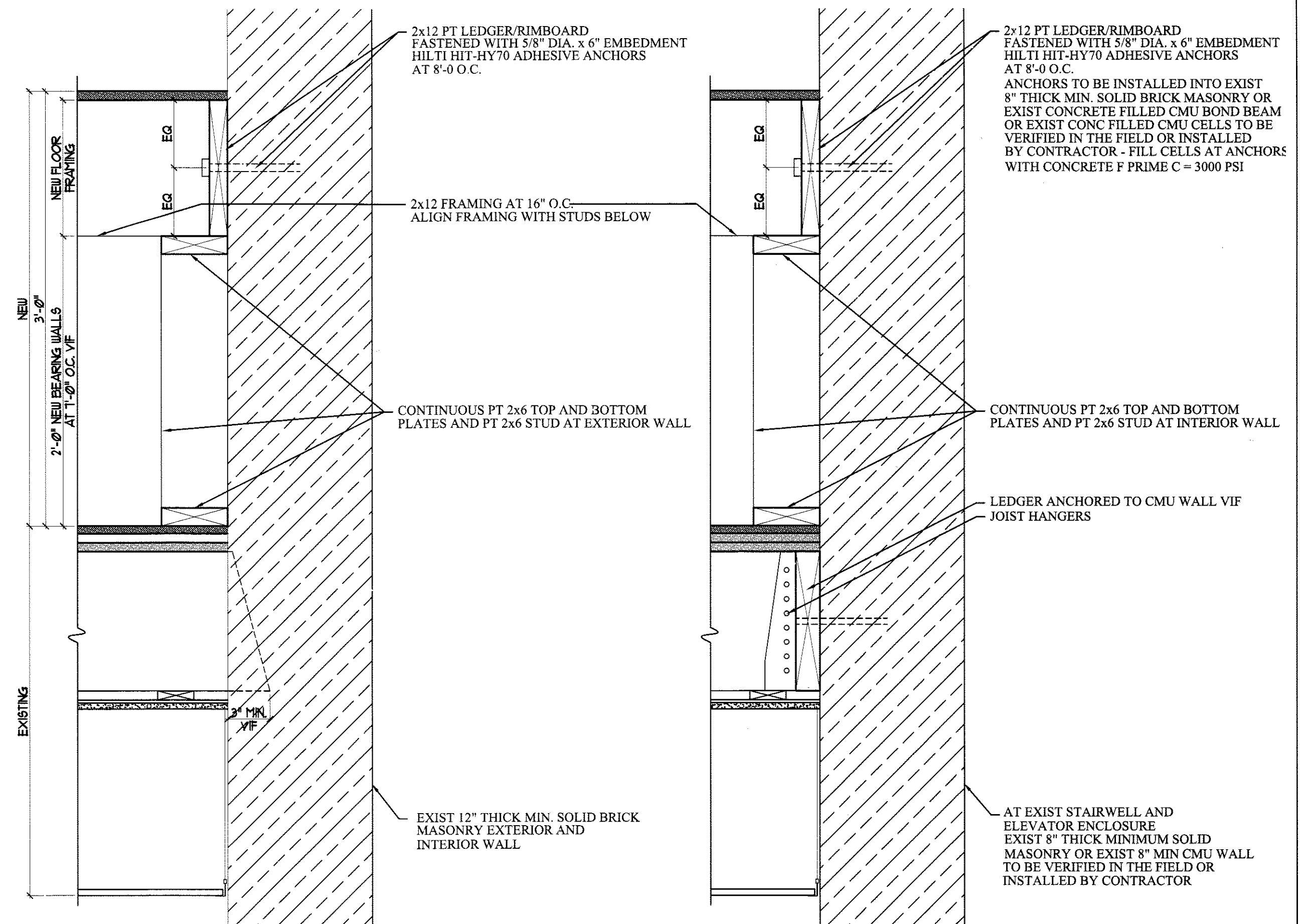

5 SECTION AT EXT MASONRY WALL

6 SECTION AT INT CMU WALL

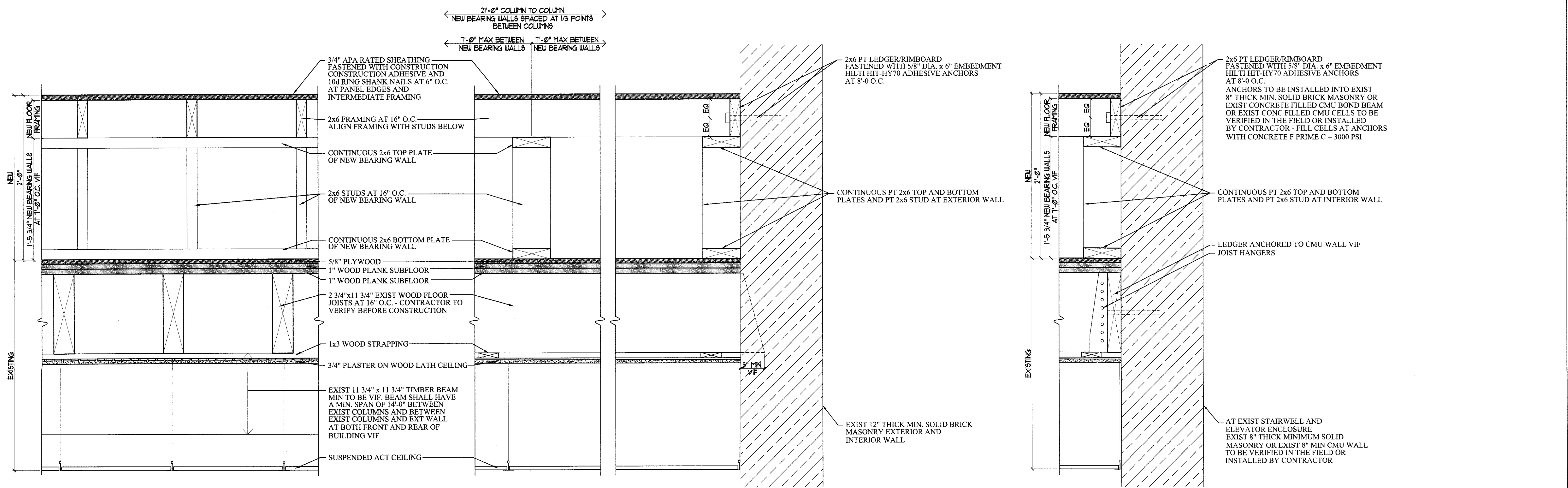

1 SECTION THROUGH TYPICAL FLOOR CONDITION

2 SECTION AT BEARING WALL

3 SECTION AT EXT MASONRY WALL

4 SECTION AT INT CMU WALL

Owner:

Consulting Engineer:

STATE OF MAINE
 JOSEPH H. LEASURE
 No. 6242
 LICENSED PROFESSIONAL ENGINEER

Architect:

ARCHETYPE
 architects
 48 Union Wharf Portland, Maine 04101
 (207) 772-6022 Fax (207) 772-4056

Project:

J.B. BROWN BUILDING
 537 CONGRESS STREET
 PORTLAND, ME

Revisions:

Date: 16 April 2013

Scale: 1 1/2" = 1'-0"

FRAMING TO RAISED THIRD FLOOR AREA
 DETAIL SECTIONS

S2