

**CODE ANALYSIS IBC 2003**

- TABLE 303 - USE GROUP S2
- AREA PROPOSED 1600 SQ FT
- AREA ALLOWED W/ SB TYPE CONSTRUCTION 13,500 SQ FT
- OVERHEAD DOOR AS EXIT 100.8.1.2
- SEPERATION FROM ADJACENT BUILDING W/ FIRE WALL
- ROOF OF ADJACENT BUILDING GREATER THAN 15' ABOVE PROPOSED GARAGE

1 | GARAGE SITE PLAN  
SCALE: 1/8" = 1'-0"

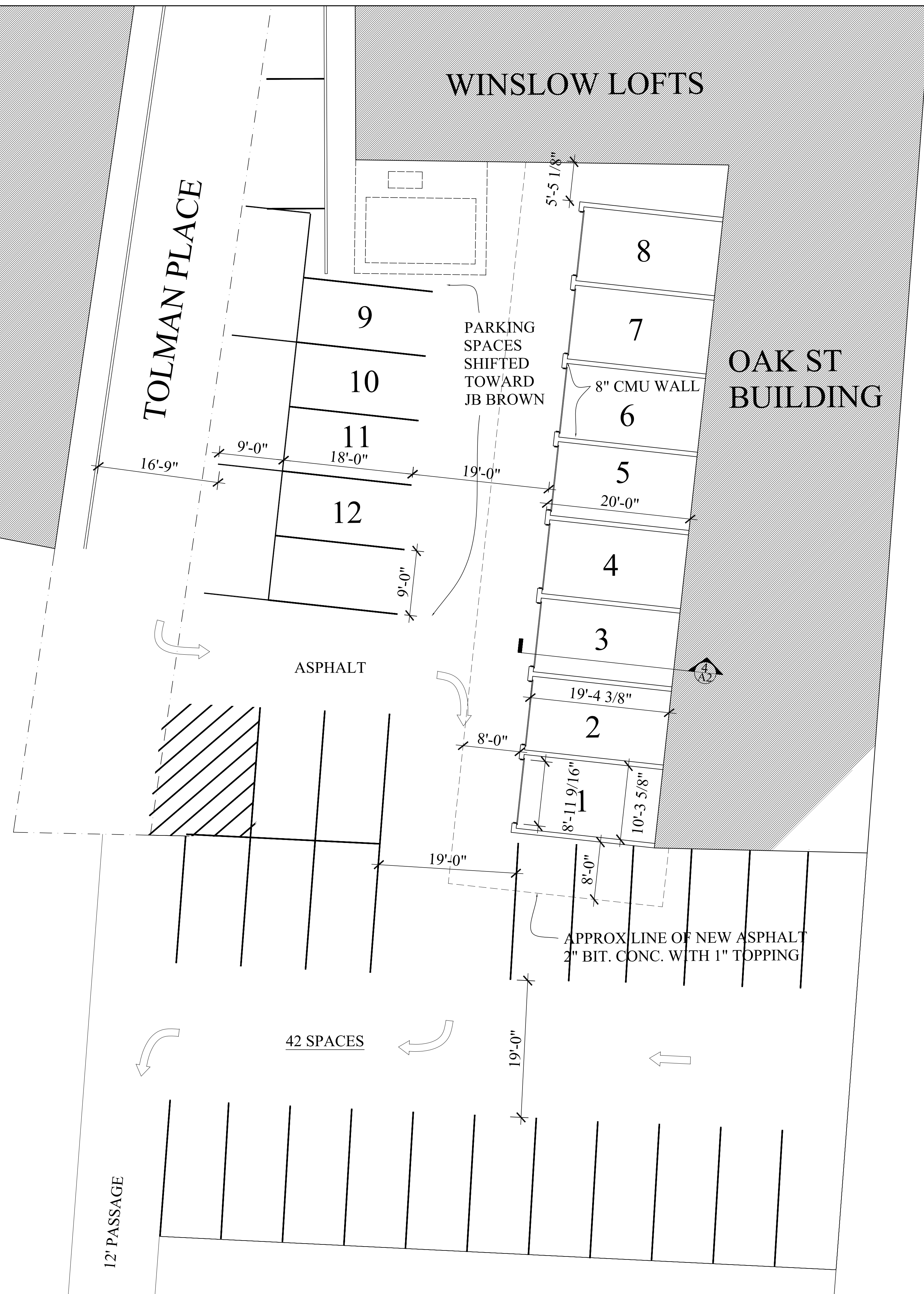

Date: JUNE 14, 2007		Scale: 1/8" = 1'-0"		Project: 537 LOFTS GARAGES	
Revisions: 1		JULY 5, 2007		TOLMAN PLACE PORTLAND, ME	
537 LOFTS GARAGES GARAGE SITE PLAN		ARCHETYPE, P.A. ARCHITECTS 48 Union Wharf Portland, Maine 04101 (207) 772-6022 Fax (207) 772-4056		OWNER:	
A-1					