

DISPLAY THIS CARD ON PRINCIPAL FRONTAGE OF WORK

CITY OF PORTLAND

Please Read
Application And
Notes, If Any,
Attached

BUILDING DEPARTMENT

PERMIT ISSUED

Permit Number: 071048

OCT - 5 2007

CITY OF PORTLAND

This is to certify that 54D - 18 LLC / Henckel Design and Fabricationhas permission to Install a Hood SystemAT 575 CONGRESS ST

City of Portland, Oregon 97205-037 A045001

provided that the person or persons, firm or corporation accepting this permit shall comply with all of the provisions of the Statutes of the State of Oregon and of the Ordinances of the City of Portland regulating the construction, maintenance and use of buildings and structures, and of the application on file in this department.

Apply to Public Works for street line and grade if nature of work requires such information.

Notification of inspection must be given and when permission is procured before this building or part thereof is started or closed-in. 24 HOUR NOTICE IS REQUIRED.

A certificate of occupancy must be procured by owner before this building or part thereof is occupied.

OTHER REQUIRED APPROVALS

Fire Dept. Craig Clark

Health Dept. _____

Appeal Board _____

Other _____

Department Name

Jaime Koufe 10/5/07
Director - Building & Inspection Services

PENALTY FOR REMOVING THIS CARD

City of Portland, Maine - Building or Use Permit Application

389 Congress Street, 04101 Tel: (207) 874-8703, Fax: (207) 874-8716

Permit No: 07-1048	Issue Date:	CBL: 037 A045001
-----------------------	-------------	---------------------

Location of Construction: 575 CONGRESS ST	Owner Name: 54D - 18 LLC	Owner Address: 559 CONGRESS ST	Phone:
Business Name:	Contractor Name: Henckel Design and Fabrication	Contractor Address: 134 Hartley Street Portland	Phone: 2073182623
Lessee/Buyer's Name	Phone:	Permit Type: Hood Systems, Commerical	Zone: B-3C
Past Use: Commercial	Proposed Use: Commercial install a Hood System	Permit Fee:	Cost of Work: \$6,706.00
		CE0 District: 1	
Proposed Project Description: Install a Hood System		FIRE DEPT: <input checked="" type="checkbox"/> Approved <input type="checkbox"/> Denied NFPA 96	INSPECTION: Use Group: A-2 IMC-2003 Type: Type A Hood
		Signature: <i>Carole Cass</i>	Signature: <i>JMB 10/5/07</i>
		PEDESTRIAN ACTIVITIES DISTRICT (P.A.D.)	
		Action: <input type="checkbox"/> Approved <input checked="" type="checkbox"/> Approved w/Conditions <input type="checkbox"/> Denied	
		Signature: <i>[Signature]</i>	Date: <i>8/29/07</i>

Permit Taken By: dmartin	Date Applied For: 08/28/2007
-----------------------------	---------------------------------

Zoning Approval

- This permit application does not preclude the Applicant(s) from meeting applicable State and Federal Rules.
- Building permits do not include plumbing, septic or electrical work.
- Building permits are void if work is not started within six (6) months of the date of issuance. False information may invalidate a building permit and stop all work..

Special Zone or Reviews	Zoning Appeal	Historic Preservation
<input type="checkbox"/> Shoreland	<input type="checkbox"/> Variance	<input checked="" type="checkbox"/> Not in District or Landmark
<input type="checkbox"/> Wetland	<input type="checkbox"/> Miscellaneous	<input type="checkbox"/> Does Not Require Review
<input type="checkbox"/> Flood Zone	<input type="checkbox"/> Conditional Use	<input type="checkbox"/> Requires Review
<input type="checkbox"/> Subdivision	<input type="checkbox"/> Interpretation	<input type="checkbox"/> Approved
<input type="checkbox"/> Site Plan	<input type="checkbox"/> Approved	<input type="checkbox"/> Approved w/Conditions
Maj <input type="checkbox"/> Minor <input type="checkbox"/> MM <input type="checkbox"/>	<input type="checkbox"/> Denied	<input type="checkbox"/> Denied
Date: <i>8/29/07</i>	Date: <i>8/29/07</i>	Date: <i>[Signature]</i>

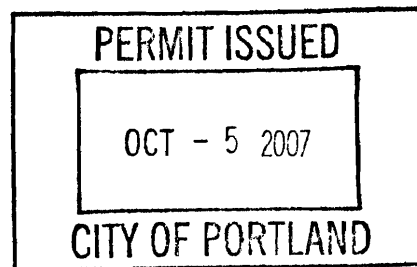

CERTIFICATION

I hereby certify that I am the owner of record of the named property, or that the proposed work is authorized by the owner of record and that I have been authorized by the owner to make this application as his authorized agent and I agree to conform to all applicable laws of this jurisdiction. In addition, if a permit for work described in the application is issued, I certify that the code official's authorized representative shall have the authority to enter all areas covered by such permit at any reasonable hour to enforce the provision of the code(s) applicable to such permit.

SIGNATURE OF APPLICANT	ADDRESS	DATE	PHONE
RESPONSIBLE PERSON IN CHARGE OF WORK, TITLE		DATE	PHONE

City of Portland, Maine - Building or Use Permit

389 Congress Street, 04101 Tel: (207) 874-8703, Fax: (207) 874-8716

Permit No: 07-1048	Date Applied For: 08/28/2007	CBL: 037 A045001
------------------------------	--	----------------------------

Location of Construction: 575 CONGRESS ST	Owner Name: 54D - 18 LLC	Owner Address: 559 CONGRESS ST	Phone:
Business Name:	Contractor Name: Henckel Design and Fabrication	Contractor Address: 134 Hartley Street Portland	Phone: (207) 318-2623
Lessee/Buyer's Name	Phone:	Permit Type: Hood Systems, Commerical	
Proposed Use: Commercial install a Hood System		Proposed Project Description: Install a Hood System	

Dept: Zoning **Status:** Approved with Conditions **Reviewer:** Marge Schmuckal **Approval Date:** 08/29/2007**Note:****Ok to Issue:**

- 1) This property shall remain a Restaurant use on the first and second floors with a combined restaurant/jazz entertainment restaurant on the second floor. Full meals shall be served at all times as defined in the ordinances. Any change of use shall require a separate permit application for review and approval.
- 2) The B-3c Zone maximum noise requirements require that any noise created shall not exceed 55 decibels on the A scale between the hours of 9:00 pm and 7:00 am; and shall not exceed 60 decibels on the A scale between the hours of 7:00 am and 9:00 pm at the boundaries of any lot nor within publicly accessible pedestrian open space. The noise ordinance is strictly enforced.
- 3) All requirements placed upon the original use permit #04-1660 are still in force. AS A REMINDER: this B-3c Zone does NOT allow bars or drinking establishments. Past permits have NOT permitted such uses.
- 4) This permit is being approved on the basis of plans submitted. Any deviations shall require a separate approval before starting that work.

Dept: Building **Status:** Approved with Conditions **Reviewer:** Jeanine Bourke **Approval Date:** 10/05/2007**Note:****Ok to Issue:**

- 1) Separate permits are required for any electrical, plumbing, or HVAC systems. Separate plans may need to be submitted for approval as a part of this process.
- 2) The Hood shall be installed per IMC 2003 and NFPA 96
This permit is approved based on the plans submitted and updated for reductions in the cleaances based on the application of a UL approved fire wrap or equivalent assembly per code.

Dept: Fire **Status:** Approved with Conditions **Reviewer:** Capt Greg Cass **Approval Date:** 08/29/2007**Note:****Ok to Issue:**

- 1) Install shall comply with NFPA 96.
A compliance letter is required

Comments:

9/6/2007-jmb: Contacted Peter, need construction plans showing the duct chase as this is a new interior chase, and cross section of hood to ceiling.

10/5/2007-jmb: Peter came in with details of the hood and ductwork including a one hour enclosed interior shaft. Ok to issue



General Building Permit Application

If you or the property owner owes real estate or personal property taxes or user charges on any property within the City, payment arrangements must be made before permits of any kind are accepted.

Location/Address of Construction: <u>575 Congress St Portland Me.</u>		
Total Square Footage of Proposed Structure		Square Footage of Lot
Tax Assessor's Chart, Block & Lot Chart# Block# Lot# <u>37 A 45</u>	Owner: <u>Bill Umbler</u>	Telephone: <u>1 207-329-5253</u>
Lessee/Buyer's Name (If Applicable)	Applicant name, address & telephone: <u>Peter Hanchel</u> <u>134 HARTLEY ST</u> <u>Portland ME 04103</u>	Cost Of Work: \$ <u>6706⁰⁰</u> Fee: \$ <u>90</u> C of O Fee: \$ <u>D/O</u>
Current legal use (i.e. single family) <u>Class A Restaurant / Music Club</u> If vacant, what was the previous use? <u>Bank</u> Proposed Specific use: <u>Restaurant</u> Is property part of a subdivision? <u>NO</u> If yes, please name _____ Project description: <u>Type I Hood Installation and welded Duct work per code (Fire system By others)</u>	Contractor's name, address & telephone: <u>Hanchel Design + Fab</u> <u>134 HARTLEY ST Portland</u> Who should we contact when the permit is ready: <u>Peter Hanchel</u> Mailing address: _____ Phone: <u>1 207-318-2623</u>	

Please submit all of the information outlined in the Commercial Application Checklist. Failure to do so will result in the automatic denial of your permit.

In order to be sure the City fully understands the full scope of the project, the Planning and Development Department may request additional information prior to the issuance of a permit. For further information visit us on-line at www.portlandmaine.gov, stop by the Building Inspections office, room 315 City Hall or call 874-8703.

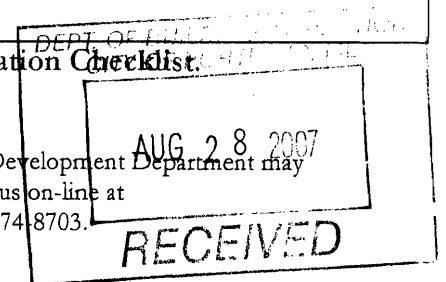

I hereby certify that I am the Owner of record of the named property, or that the owner of record authorizes the proposed work and that I have been authorized by the owner to make this application as his/her authorized agent. I agree to conform to all applicable laws of this jurisdiction. In addition, if a permit for work described in this application is issued, I certify that the Code Official's authorized representative shall have the authority to enter all areas covered by this permit at any reasonable hour to enforce the provisions of the codes applicable to this permit.

Signature of applicant: [Signature]

Date: 08-28-07

This is not a permit; you may not commence ANY work until the permit is issued.



Henckel Design and Fabrication

134 Hartley Street
Portland, Maine
04103

Phone: 1-207-318-2623
Fax: 1-207-772-8952
E-mail: petehenckel@maine.rr.com

March 1, 2007

Gary here is the quote for the Congress St location if after you have any questions
Please feel free to call .

Below you will find the scope of work for this site please note this quote includes no electrical
Work all roof penetrations are to be made by others all roofing curb will be installed by others
H/D/F will locate the curbs on the roof when the curbs are ordered the roof pitch will have to
Be figured to keep the units level.

A permit will be obtained through the city for the work listed below all drawings needed to obtain
The permit will be provided by others.

- #1. one stainless steel back splash will be install were the hood is to be located (please note that
the city inspector must verify that the wall has been made with steel studs per code)
- #2. one hood will be hung per code.
- #3. two roof curbs will be spotted on the roof (the holes and installation of the curbs will be done
by a roofer of your choice)
- #4. 16Ga black iron ducting will be installed from the new hood to the exhaust curb.
- #5. spiral ducting will be installed from the hood to the intake curb for the make up air system.
- #6. 15A fire barrier will be installed per code where ever the duct work comes with in 18" of
a combustibile item (if the ceiling is fire rated less insulation will be needed)
- #7. once the intake and exhaust ducting has been installed the fans will be lifted into place
on the roof.
- #8. Clean out doors will be installed where the code requires.

The quote for the work listed above \$6706.25 a deposit of 50% will be required to proceed
With the work listed with the balance paid upon the completion of this work.

Deposit coming
\$ 3353.12

• Restaurant Hoods • Boiler Breaching • HVAC Design • Curb Adapters and Unit Installations •
• Welded Ducting • Custom Welding Fabrication •



Henckel Design and Fabrication

134 Hartley Street
Portland, Maine
04103

Phone: 1-207-318-2623
Fax: 1-207-772-8952
E-mail: petehenckel@maine.rr.com

August 24, 2007

Attn; Jeanie Bourke
From; Pete Henckel
Subject; 575 Congress St

One ten foot hood will be installed per code using a UL rated Sammy system to anchor the 3/8" threaded rod to the beams the beams are 3"x12" 16 on center with a span of twenty feet.

The hood weight is 330LBS.

The areas that the ducting comes within 18" of any combustible item will have 15A fire barrier installed per code.

Clean outs will be installed every ten feet.

The exhaust ducting will be 16GA black iron with all welded joints.

The exhaust fan will be mounted on the roof ten feet from any intake air system and forty-three inches above the roof deck.

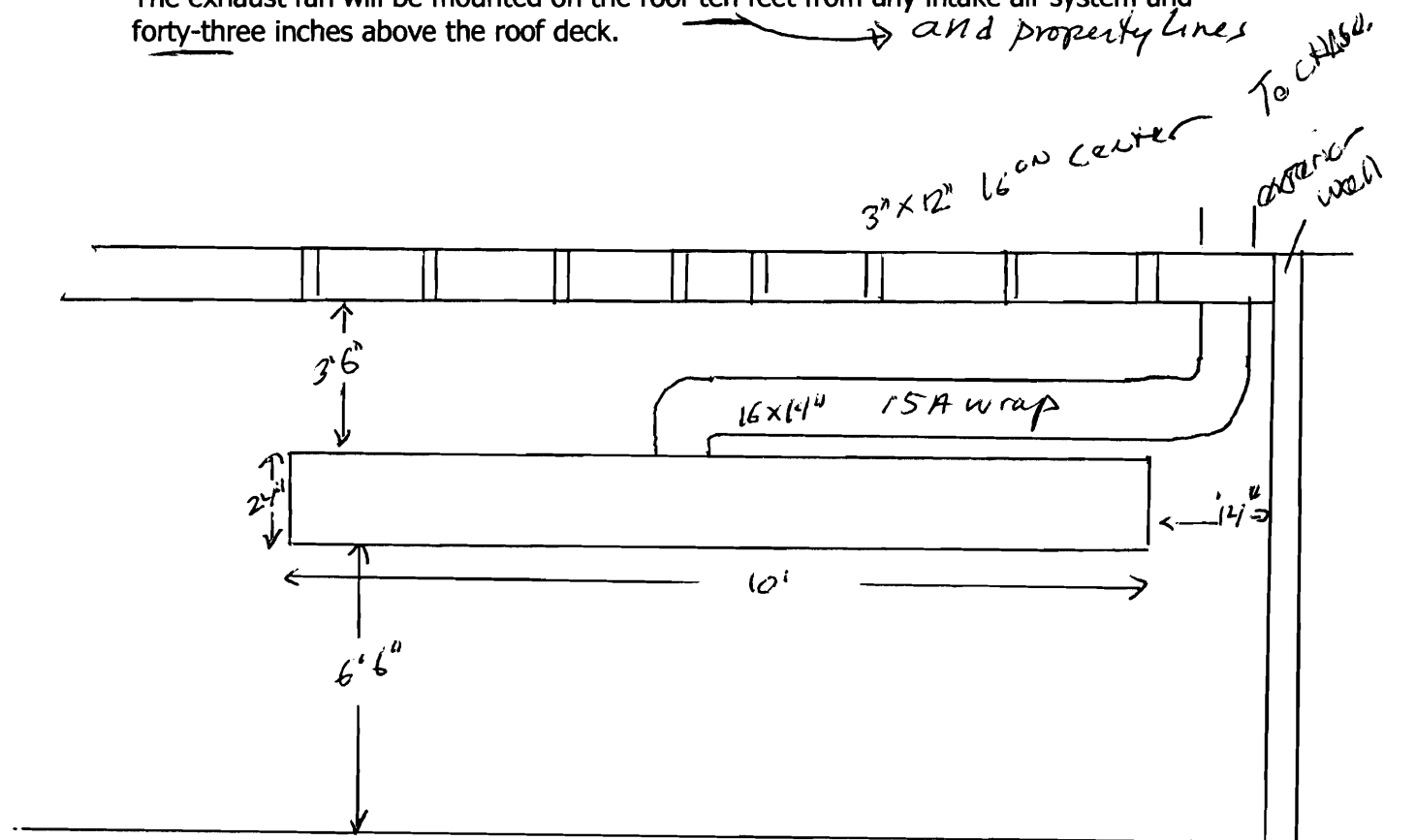

•Restaurant Hoods•Boiler Breaching•HVAC Design•Curb Adapters and Unit Installations•
•Welded Ducting•Custom Welding Fabrication•



PORTLAND MAINE

Strengthening a Remarkable City, Building a Community for Life • www.portlandmaine.gov

Lee Urban - Director of Planning and Development
Jeanie Bourke - Inspection Division Services Director

Kitchen Exhaust System Checklist and code Provisions

Dear Applicant,

The following is a checklist to assist you in filing for a permit for a Kitchen Exhaust system. The applicable Mechanical Code provisions have also been attached. Please complete this and submit job specific construction documents that demonstrate compliance with the attached information.

Type of System:

Type I Type II

Type I systems are systems that vent fryers, grills, broilers, ovens or woks.

Type II systems are systems that vent steamers and other non grease producing appliances.

Type of Materials:

Is the hood Stainless steel or other type of steel? yes If Other, what Type? _____

Is the duct work Stainless steel or other type of steel? No If Other, what type? 16 Ga Black iron

Thickness of the steel for the hood 18 Ga Stainless

Thickness of the duct for the hood 16 Ga Black iron

Type of Hood and Duct Supports

1 5/8" UNISTRUT / 3/8 Threaded Rod

UL R-10 R-15 R-20 R-25 R-30 R-35 R-40 R-45 R-50 R-55 R-60 R-65 R-70 R-75 R-80 R-85 R-90 R-95 R-100 R-105 R-110 R-115 R-120 R-125 R-130 R-135 R-140 R-145 R-150 R-155 R-160 R-165 R-170 R-175 R-180 R-185 R-190 R-195 R-200 R-205 R-210 R-215 R-220 R-225 R-230 R-235 R-240 R-245 R-250 R-255 R-260 R-265 R-270 R-275 R-280 R-285 R-290 R-295 R-300 R-305 R-310 R-315 R-320 R-325 R-330 R-335 R-340 R-345 R-350 R-355 R-360 R-365 R-370 R-375 R-380 R-385 R-390 R-395 R-400 R-405 R-410 R-415 R-420 R-425 R-430 R-435 R-440 R-445 R-450 R-455 R-460 R-465 R-470 R-475 R-480 R-485 R-490 R-495 R-500 R-505 R-510 R-515 R-520 R-525 R-530 R-535 R-540 R-545 R-550 R-555 R-560 R-565 R-570 R-575 R-580 R-585 R-590 R-595 R-600 R-605 R-610 R-615 R-620 R-625 R-630 R-635 R-640 R-645 R-650 R-655 R-660 R-665 R-670 R-675 R-680 R-685 R-690 R-695 R-700 R-705 R-710 R-715 R-720 R-725 R-730 R-735 R-740 R-745 R-750 R-755 R-760 R-765 R-770 R-775 R-780 R-785 R-790 R-795 R-800 R-805 R-810 R-815 R-820 R-825 R-830 R-835 R-840 R-845 R-850 R-855 R-860 R-865 R-870 R-875 R-880 R-885 R-890 R-895 R-900 R-905 R-910 R-915 R-920 R-925 R-930 R-935 R-940 R-945 R-950 R-955 R-960 R-965 R-970 R-975 R-980 R-985 R-990 R-995 R-1000

Type of seams and Joints All welded

Grease Gutters provided? yes

Hood Clearance reduction to Combustibles design /specs:

Duct Clearance reduction to Combustibles design /specs:

☑ Cleared to combustibles.

Vibration Isolation System:

Air Velocity within the duct system 1500 FPM

Grease accumulation prevention system:

yes

Cleanouts yes every 10'

Grease Duct enclosure _____

Exhaust Termination Roof ✓ Wall _____

Fire Suppression System yes By others.

Exhaust fan mounting and clearance from the roof / wall or Combustibles:

43" above the membrane roof

Exhaust fan distance from other vents or openings 10' MIN

Exhaust fan distance from adjacent buildings 25'

Exhaust fan height above adjoining grade Roof must 3 story.

Hood Specs

Style of Hood Type I

Type of Filter Aluminum Baffles

Height of filter above nearest cooking surface per Code 43" MAX

Capacity of hood CFM 2600 CFM

Make up Air system description and capacity

Standard Return Air Fan ducted to

The Hood.

**SECTION 506
COMMERCIAL KITCHEN HOOD VENTILATION
SYSTEM DUCTS AND EXHAUST EQUIPMENT**

506.1 General. Commercial kitchen hood ventilation ducts and exhaust equipment shall comply with the requirements of this section. Commercial kitchen grease ducts shall be designed for the type of cooking appliance and hood served.

506.2 Corrosion protection. Ducts exposed to the outside atmosphere or subject to a corrosive environment shall be protected against corrosion in an approved manner.

506.3 Ducts serving Type I hoods. Type I exhaust ducts shall be independent of all other exhaust systems except as provided in Section 506.3.5. Commercial kitchen duct systems serving Type I hoods shall be designed, constructed and installed in accordance with Sections 506.3.1 through 506.3.12.3.

506.3.1 Duct materials. Ducts serving Type I hoods shall be constructed of materials in accordance with Sections 506.3.1.1 and 506.3.1.2.

506.3.1.1 Grease duct materials. Grease ducts serving Type I hoods shall be constructed of steel not less than 0.055 inch (1.4 mm) (No. 16 Gage) in thickness or stainless steel not less than 0.044 inch (1.1 mm) (No. 18 Gage) in thickness.

Exception: Listed and labeled factory-built commercial kitchen grease ducts shall be installed in accordance with Section 304.1.

506.3.1.2 Makeup air ducts. Makeup air ducts connecting to or within 18 inches (457 mm) of a Type I hood shall be constructed and installed in accordance with Sections 603.1, 603.3, 603.4, 603.9, 603.10 and 603.12. Duct insulation installed within 18 inches (457 mm) of a Type I hood shall be noncombustible or shall be listed for the application.

506.3.2 Joints, seams and penetrations of grease ducts. Joints, seams and penetrations of grease ducts shall be made with a continuous liquid-tight weld or braze made on the external surface of the duct system.

Exceptions:

1. Penetrations shall not be required to be welded or brazed where sealed by devices that are listed for the application.
2. Internal welding or brazing shall not be prohibited provided that the joint is formed or ground smooth and is provided with ready access for inspection.
3. Listed and labeled factory-built commercial kitchen grease ducts installed in accordance with Section 304.1.

506.3.2.1 Duct joint types. Duct joints shall be butt joints or overlapping duct joints of either the telescoping or bell type. Overlapping joints shall be installed to prevent ledges and obstructions from collecting grease or interfering with gravity drainage to the intended collection point. The difference between the inside cross-sectional dimensions of overlapping sections of duct shall not exceed 0.25 inch (6 mm). The length of overlap for overlapping duct joints shall not exceed 2 inches (51 mm).

506.3.2.2 Duct-to-hood joints. Duct-to-hood joints shall be made with continuous internal or external liquid-tight welded or brazed joints. Such joints shall be smooth, accessible for inspection, and without grease traps.

Exceptions: This section shall not apply to:

1. A vertical duct-to-hood collar connection made in the top plane of the hood in accordance with all of the following:
 - 1.1. The hood duct opening shall have a 1-inch-deep (25 mm), full perimeter, welded flange turned down into the hood interior at an angle of 90 degrees from the plane of the opening.
 - 1.2. The duct shall have a 1-inch-deep (25 mm) flange made by a 1-inch by 1-inch (25 mm by 25 mm) angle iron welded to the full perimeter of the duct not less than 1 inch (25 mm) above the bottom end of the duct.
 - 1.3. A gasket rated for use at not less than 1,500°F (815°C) is installed between the duct flange and the top of the hood.
 - 1.4. The duct-to-hood joint shall be secured by stud bolts not less than 0.25 inch (6.4 mm) in diameter welded to the hood with a spacing not greater than 4 inches (102 mm) on center for the full perimeter of the opening. All bolts and nuts are to be secured with lockwashers.
2. Listed and labeled duct-to-hood collar connections installed in accordance with Section 304.1.

506.3.2.3 Duct-to-exhaust fan connections. Duct-to-exhaust fan connections shall be flanged and gasketed at the base of the fan for vertical discharge fans; shall be flanged, gasketed and bolted to the inlet of the fan for side-inlet utility fans; and shall be flanged, gasketed and bolted to the inlet and outlet of the fan for in-line fans.

506.3.2.4 Vibration isolation. A vibration isolation connector for connecting a duct to a fan shall consist of noncombustible packing in a metal sleeve joint of approved design or shall be a coated-fabric flexible duct connector listed and labeled for the application. Vibration isolation connectors shall be installed only at the connection of a duct to a fan inlet or outlet.

506.3.3 Grease duct supports. Grease duct bracing and supports shall be of noncombustible material securely attached to the structure and designed to carry gravity and seismic loads within the stress limitations of the *International Building Code*. Bolts, screws, rivets and other mechanical fasteners shall not penetrate duct walls.

506.3.4 Air velocity. Grease duct systems serving a Type I hood shall be designed and installed to provide an air velocity within the duct system of not less than 1,500 feet per minute (7.6 m/s).

Exception: The velocity limitations shall not apply within duct transitions utilized to connect ducts to differently

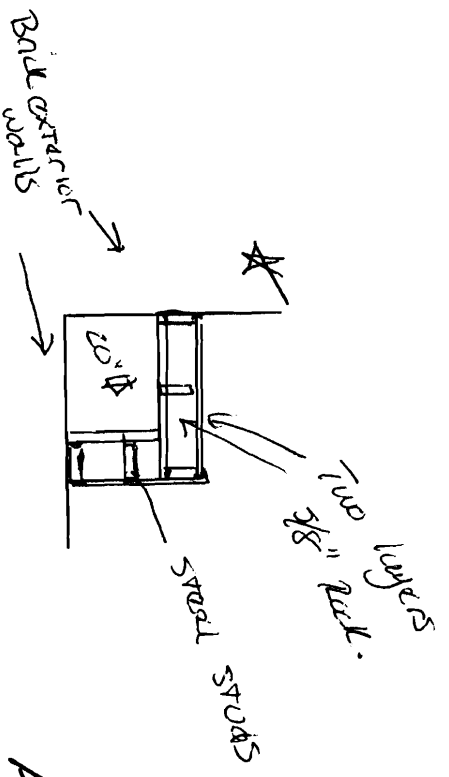

All welded ductwork that comes with in 18" of a combustible item will be fire wrapped for code.

16x14 16Ga Back iron duct
All welded joints

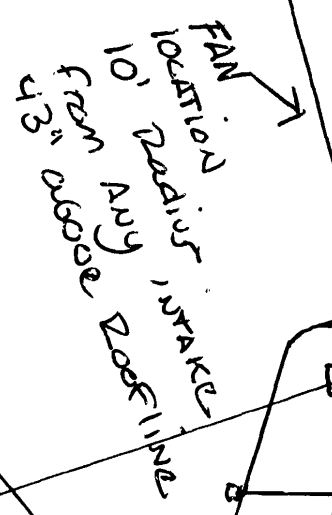

clean 5" x 5" up Rafter
A/C system - 1" 5/8"

5/12

Peak 20' off floor

SIDE
DOORWAY
FURDS
AND

REAR STAIRS

DEPT. OF BUILDINGS & PLANNING
CITY OF FORT LAUDERDALE, FL
OCT - 5 2007
RECEIVED

BUILDING PERMIT INSPECTION PROCEDURES

Please call 874-8703 or 874-8693 (ONLY)

to schedule your inspections as agreed upon

Permits expire in 6 months, if the project is not started or ceases for 6 months.

The Owner or their designee is required to notify the inspections office for the following inspections and provide adequate notice. Notice must be called in 48-72 hours in advance in order to schedule an inspection:

By initializing at each inspection time, you are agreeing that you understand the inspection procedure and additional fees from a "Stop Work Order" and "Stop Work Order Release" will be incurred if the procedure is not followed as stated below.

A Pre-construction Meeting will take place upon receipt of your building permit.

- Footing/Building Location Inspection: Prior to pouring concrete
- Re-Bar Schedule Inspection: Prior to pouring concrete
- Foundation Inspection: Prior to placing ANY backfill
- Framing/Rough Plumbing/Electrical: Prior to any insulating or drywalling
- Final/~~Certificate of Occupancy~~: Prior to any occupancy of the structure or use. NOTE: There is a ~~\$75.00 fee per~~ inspection at this point.

Certificate of Occupancy is not required for certain projects. Your inspector can advise you if your project requires a Certificate of Occupancy. All projects **DO** require a final inspection

If any of the inspections do not occur, the project cannot go on to the next phase, REGARDLESS OF THE NOTICE OR CIRCUMSTANCES.

~~NA~~ **CERIFICATE OF OCCUPANICES MUST BE ISSUED AND PAID FOR, BEFORE THE SPACE MAY BE OCCUPIED**

[Signature]
Signature of Applicant/Designee

10-5-07
Date

[Signature]
Signature of Inspections Official

10/5/07
Date

CBL: 37-A-45

Building Permit #: 07-1048