

**City of Portland, Maine - Building or Use Permit Application**

389 Congress Street, 04101 Tel: (207) 874-8703, Fax: (207) 874-8716

Permit No: 05-0245	Issue Date: <b>PERMIT ISSUED</b>	CBL: 037 A044001
Owner Address: 470 Deering Ave	Phone:	
Contractor Address: 158 St. John St Portland	Phone: 207-774-7849	
Permit Type: HVAC	Zone: B3	

Location of Construction: 553 Congress St	Owner Name: Paulson Richard W Jr
Business Name:	Contractor Name: Waynes Plumbing and Heating
Lessee/Buyer's Name	Phone:

Past Use: Commercial	Proposed Use: Commercial / Replace boiler in basement w/ Peerless Oil boiler ec/ect/ next to original boiler
----------------------	--

**Proposed Project Description:**  
Replace boiler in basement w/ Peerless Oil boiler ec/ect/ next to original boiler

Permit Fee: \$102.00	Cost of Work: \$8,900.00	CEO District: 1
FIRE DEPT: <input checked="" type="checkbox"/> Approved <input type="checkbox"/> Denied	INSPECTION: Use Group: Type: HVAC	
Signature: <i>JMB</i>	Signature: <i>JMB</i> 3/17/05	
PEDESTRIAN ACTIVITIES DISTRICT (P.A.D.)		
Action: <input type="checkbox"/> Approved <input type="checkbox"/> Approved w/Conditions <input type="checkbox"/> Denied		
Signature: Date:		

Permit Taken By: Idobson	Date Applied For: 03/14/2005	<b>Zoning Approval</b>	
--------------------------	------------------------------	------------------------	--

<p>1. This permit application does not preclude the Applicant(s) from meeting applicable State and Federal Rules.</p> <p>2. Building permits do not include plumbing, septic or electrical work.</p> <p>3. Building permits are void if work is not started within six (6) months of the date of issuance. False information may invalidate a building permit and stop all work..</p>	<p><b>Special Zone or Reviews</b></p> <p><input type="checkbox"/> Shoreland</p> <p><input type="checkbox"/> Wetland</p> <p><input type="checkbox"/> Flood Zone</p> <p><input type="checkbox"/> Subdivision</p> <p><input type="checkbox"/> Site Plan <i>JMB</i></p> <p>Maj <input type="checkbox"/> Minor <input type="checkbox"/> MM <input type="checkbox"/></p> <p>Date: <i>JMB</i> 3/17/05</p>	<p><b>Zoning Appeal</b></p> <p><input type="checkbox"/> Variance</p> <p><input type="checkbox"/> Miscellaneous</p> <p><input type="checkbox"/> Conditional Use</p> <p><input type="checkbox"/> Interpretation</p> <p><input type="checkbox"/> Approved</p> <p><input type="checkbox"/> Denied</p> <p>Date:</p>	<p><b>Historic Preservation</b></p> <p><input checked="" type="checkbox"/> Not in District or Landmar</p> <p><input type="checkbox"/> Does Not Require Review</p> <p><input type="checkbox"/> Requires Review</p> <p><input type="checkbox"/> Approved</p> <p><input type="checkbox"/> Approved w/Conditions</p> <p><input type="checkbox"/> Denied</p> <p>Date: <i>JMB</i></p>
---	--	--	---

**CERTIFICATION**

I hereby certify that I am the owner of record of the named property, or that the proposed work is authorized by the owner of record and that I have been authorized by the owner to make this application as his authorized agent and I agree to conform to all applicable laws of this jurisdiction. In addition, if a permit for work described in the application is issued, I certify that the code official's authorized representative shall have the authority to enter all areas covered by such permit at any reasonable hour to enforce the provision of the code(s) applicable to such permit.

SIGNATURE OF APPLICANT	ADDRESS	DATE	PHONE
RESPONSIBLE PERSON IN CHARGE OF WORK, TITLE		DATE	PHONE

**City of Portland, Maine - Building or Use Permit**

389 Congress Street, 04101 Tel: (207) 874-8703, Fax: (207) 874-8716

<b>Permit No:</b> 05-0245	<b>Date Applied For:</b> 03/14/2005	<b>CBL:</b> 037 A044001
------------------------------	--	----------------------------

<b>Location of Construction:</b> 553 Congress St	<b>Owner Name:</b> Paulson Richard W Jr	<b>Owner Address:</b> 470 Deering Ave	<b>Phone:</b>
<b>Business Name:</b>	<b>Contractor Name:</b> Waynes Plumbing and Heating	<b>Contractor Address:</b> 158 St. John St Portland	<b>Phone</b> (207) 774-7849
<b>Lessee/Buyer's Name</b>	<b>Phone:</b>	<b>Permit Type:</b> HVAC	

<b>Proposed Use:</b> Commercial / Replace boiler in basement w/ Peerless Oil boiler ec/ect/ next to original boiler	<b>Proposed Project Description:</b> Replace boiler in basement w/ Peerless Oil boiler ec/ect/ next to original boiler
--	---

**Dept:** Zoning      **Status:** Approved      **Reviewer:** Jeanine Bourke      **Approval Date:** 03/17/2005

**Note:**      **Okto Issue:**

**Dept:** Building      **Status:** Approved      **Reviewer:** Jeanine Bourke      **Approval Date:** 03/17/2005

**Note:**      **Okto Issue:**

1) Installation shall comply with 2003 International Mechanical Code and State of Maine Oil and Solid Fuel Board Laws and Rules

**Dept:** Fire      **Status:-** Approved with Conditions      **Reviewer:** Lt. MacDougal      **Approval Date:** 03/17/2005

**Note:**      **Okto Issue:**

1) the boiler shall be seperated with a one hour enclosure or a smoke enclosure with a domestic sprinkler

**City of Portland, Maine - Building or Use Permit**

389 Congress Street, 04101 Tel: (207) 874-8703, Fax: (207) 874-8716

<b>Permit No:</b> 05-0245	<b>Date Applied For:</b> 03/14/2005	<b>CBL:</b> 037 A044001
------------------------------	--	----------------------------

<b>Location of Construction:</b> 553 Congress St	<b>Owner Name:</b> Paulson Richard W Jr	<b>Owner Address:</b> 470 Deering Ave	<b>Phone:</b>
<b>Business Name:</b>	<b>Contractor Name:</b> Waynes Plumbing and Heating	<b>Contractor Address:</b> 158 St. John St Portland	<b>Phone:</b> (207) 774-7849
<b>Lessee/Buyer's Name</b>	<b>Phone:</b>	<b>Permit Type:</b> HVAC	

<b>Proposed Use:</b> Commercial / Replace boiler in basement w/ Peerless Oil boiler ec/ect/ next to original boiler	<b>Proposed Project Description:</b> Replace boiler in basement w/ Peerless Oil boiler ec/ect/ next to original boiler
--	---

<b>Dept:</b> Zoning	<b>Status:</b> Approved	<b>Reviewer:</b> Jeanine Bourke	<b>Approval Date:</b> 03/17/2005
<b>Note:</b>			<b>Ok to Issue:</b> <input checked="" type="checkbox"/>
<b>Dept:</b> Building	<b>Status:</b> Approved	<b>Reviewer:</b> Jeanine Bourke	<b>Approval Date:</b> 03/17/2005
<b>Note:</b>			<b>Ok to Issue:</b> <input type="checkbox"/>
1) Installation shall comply with 2003 International Mechanical Code and State of Maine Oil and Solid Fuel Board Laws and Rules			
<b>Dept:</b> Fire	<b>Status:</b> Approved with Conditions	<b>Reviewer:</b> Lt. MacDougal	<b>Approval Date:</b> 03/17/2005
<b>Note:</b>			<b>Ok to Issue:</b> <input checked="" type="checkbox"/>
1) the boiler shall be seperated with a one hour enclosure or a smoke enclosure with a domestic sprinkler			



FILL IN AND SIGN WITH INK

# APPLICATION FOR PERMIT HEATING OR POWER EQUIPMENT



44  
037

To the INSPECTOR OF BUILDINGS, PORTLAND, ME.

The undersigned hereby applies for a permit to install the following heating, cooking or power equipment in accordance with the Laws of Maine, the Building Code of the City of Portland, and the following specifications:

Location / CBL 553 Congress Use of Building Res-Comm Date 3/14/05

Name and address of owner of appliance Richard Paulson

Installer's name and address Waynes Plumbing 158 St John St Portland ME 04102  
Robert Curlew Telephone 828 1396

### Location of appliance:

- Basement
- Attic
- Floor
- Roof

### Type of Fuel:

- Gas
- Oil
- Solid

Appliance Name: Peerless oil boiler elect

U.L. Approved  Yes  No

Will appliance be installed in accordance with the manufacture's installation instructions?  Yes  No

IF NO Explain: \_\_\_\_\_

### The Type of License of Installer:

- ~~Master~~ Plumber # \_\_\_\_\_
- Solid Fuel # MS 3000 100 Z
- Oil # \_\_\_\_\_
- Gas # \_\_\_\_\_
- Other \_\_\_\_\_

### Type of Chimney:

- Masonry Lined Spray  
Factory built \_\_\_\_\_
- Metal  
Factory Built U.L. Listing # \_\_\_\_\_
- Direct Vent  
Type \_\_\_\_\_ U.L.# \_\_\_\_\_

### Type of Fuel Tank

- Oil
- Gas

Size of Tank 275 gal

Number of Tanks 1

Distance from Tank to Center of Flame 7 feet.

Cost of Work: \$ 8900.00

Inspection Fee: \$ \_\_\_\_\_

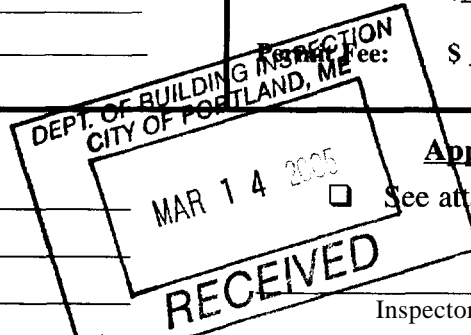

Approved

Fire: AMB

Ele.: \_\_\_\_\_

Bldg.: AMB

Approved with Conditions

See attached letter or requirement

Inspector's Signature

Date Approved

Signature of Installer Robert Curlew

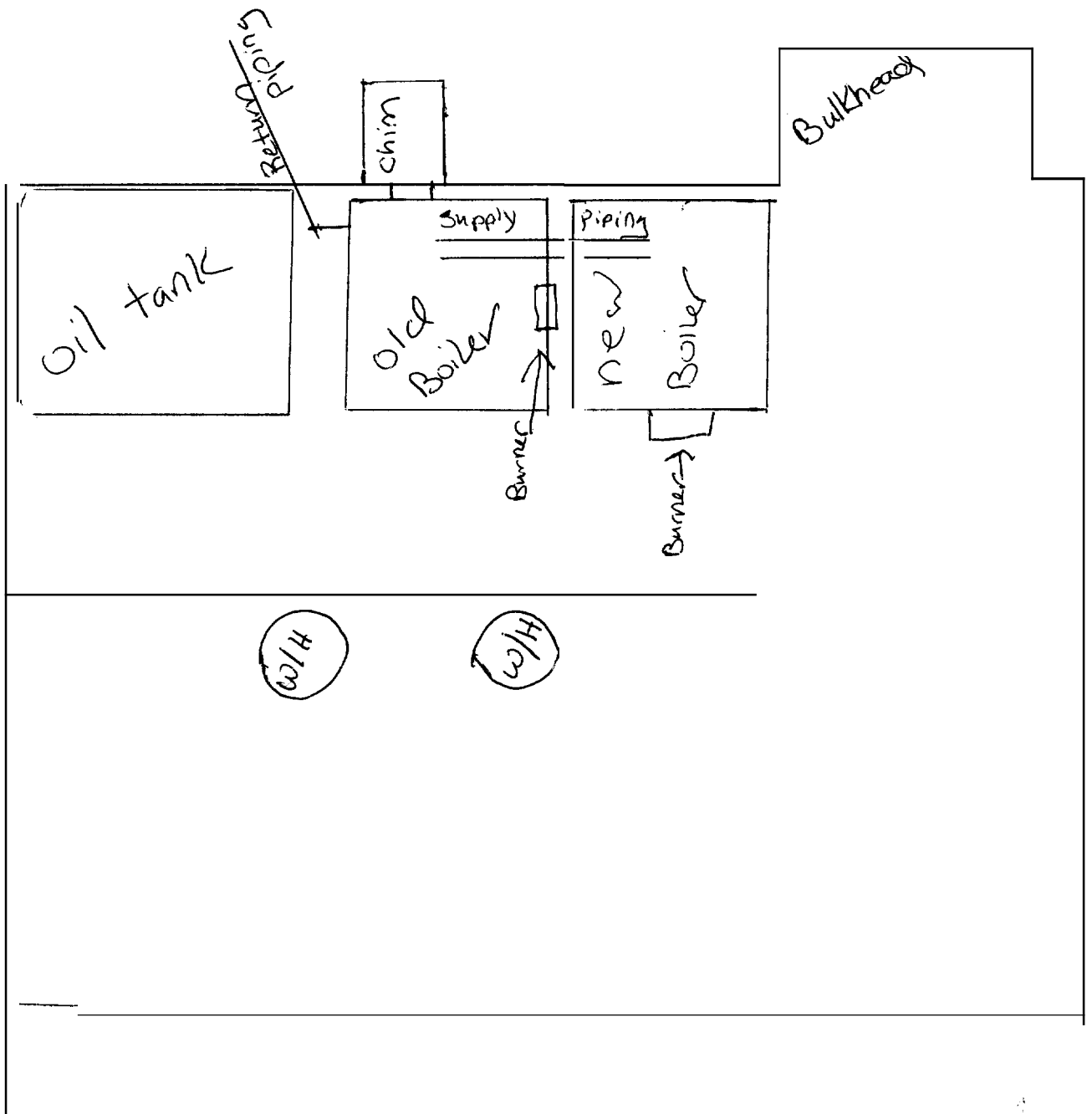

# Technical Information

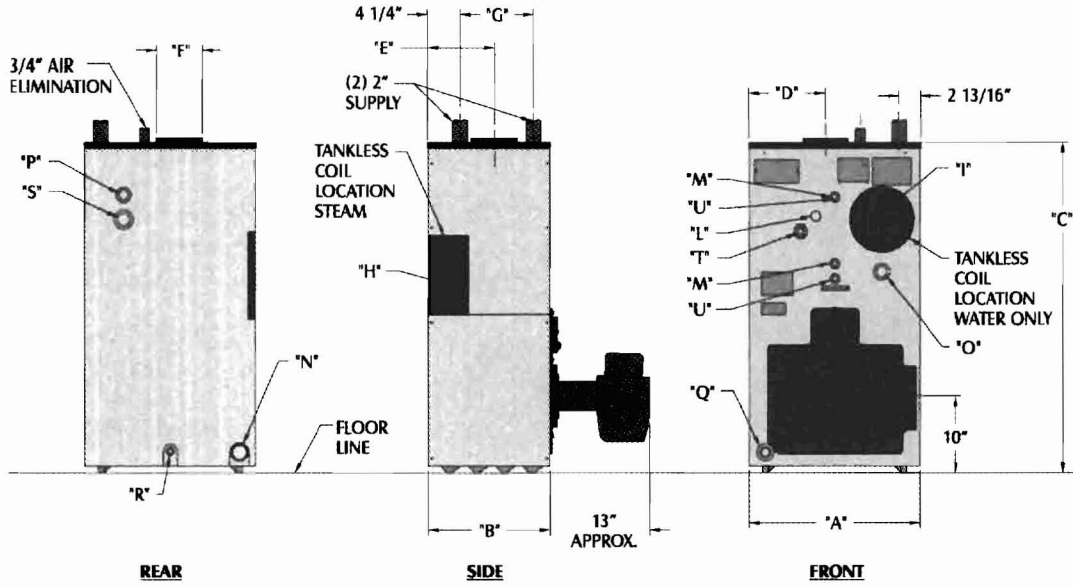

## Boiler Dimensions

Boiler Dimensions	Jacket			Left of Jacket to c/l of Flue "D"	Rear of Jacket to c/l of Flue "E"	Flue Size "F"	Distance Between Tappings "G"	Chimney Size
	Width "A"	Depth "B"	Top to Floor "C"					
EC/ECT-03	22 1/2"	15 3/4"	42"	10"	8 3/4"	6"	9 1/16"	8"x8"x20'
EC/ECT-04	22 1/2"	19 15/16"	42"	10"	10 7/8"	7"	13 1/4"	8"x8"x20'
EC/ECT-05	22 1/2"	24 1/8"	42"	10"	13"	8"	17 7/16"	8"x8"x20'*
EC/ECT-06	22 1/2"	28 5/16"	42"	10"	15 1/16"	9"	21 5/8"	8"x12"x20'

\*EC/ECT-05 with burner input of 2.50 GPH has chimney size of 8"x12"x20'

## Crate Dimensions & Shipping Weights

Length WPC-WPCT	Width WPC-WPCT	Height WPC-WPCT	Approx. Shipping Weight (lbs.)					
			Knockdown		Package			
			W-S	WU-SU	WPC	WPCT	SP	SPT
40"	28"	47"	570	610	700	710	690	700
40"	28"	47"	710	760	840	850	830	840
48"	28"	47"	840	880	-	-	-	-
48"	28"	47"	990	1030	-	-	-	-

## Tapping Locations

Location	Size N.P.T.	Steam	Water
H	3/4"	Low Limit Control	N/A
I	3/4"	Pressure Gage	Limit Control
L	1/4"	N/A	Temperature-Pressure Gage
M	1/2"	Gage Glass and Float LWCO	N/A
N	2"	Return	Alternate Return
O	3/4"	Secondary Probe LWCO	N/A

Location	Size N.P.T.	Steam	Water
P	3/4"	Safety Valve	Safety Relief Valve
Q	1 1/4"	N/A	Return
R	3/4"	Drain Valve	Drain Valve
S	1 1/2"	Skim Tapping	Optional High Limit
T	3/4"	Primary Probe LWCO	N/A
U	1/2"	Gauge Glass for Primary Probe LWCO	N/A

Installed By:



PeerlessBoilers.com



HI Div of gama



ASME



# CITY OF PORTLAND, MAINE

## Department of Building Inspections

20

Received from \_\_\_\_\_

Location of Work \_\_\_\_\_

Cost of Construction \$ \_\_\_\_\_

Permit Fee \$ \_\_\_\_\_

Building (IL) \_\_\_\_ Plumbing (I5) \_\_\_\_ Electrical (I2) \_\_\_\_ Site Plan (U2) \_\_\_\_

Other \_\_\_\_\_

CBL: \_\_\_\_\_

Check #: \_\_\_\_\_

**Total Collected \$** \_\_\_\_\_

# THIS IS NOT A PERMIT

No work is to be started until PERMIT CARD is actually posted upon the premises. Acceptance of fee is no guarantee that permit will be granted. PRESERVE THIS RECEIPT. In case permit cannot be granted the amount of the fee will be refunded upon return of the receipt less \$10.00 or 10% whichever is greater.

WHITE - Applicant's Copy

YELLOW - Office Copy

PINK - Permit Copy