

© 2013 RYAN SENATORE ARCHITECTURE

STRAND BUILDING - FACADE RENOVATION
565 CONGRESS STREET
PORTLAND, MAINE



RYAN SENATORE ARCHITECTURE
 67 GRAY ROAD
 GORHAM, MAINE 04038
 207-650-6414
 senatorearchitecture.com

CONSULTANTS:

REVISIONS:

DATE: JUNE 27, 2013

PROJECT No.

DRAWN BY:

CHECKED BY: RJS

SCALE: AS NOTED

SHEET TITLE:

STOREFRONT - 2
DETAILS

A2-2

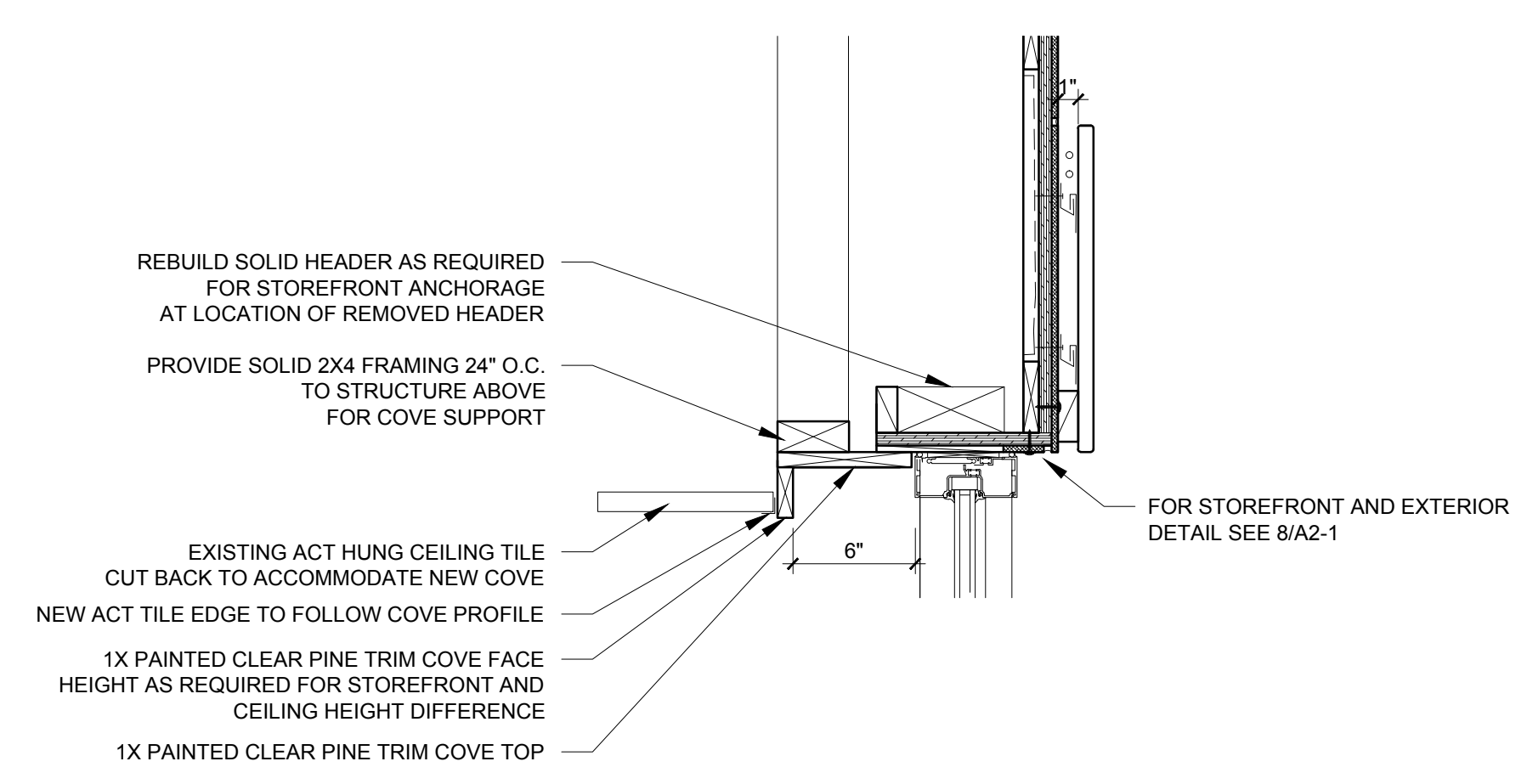

5 COVE DETAIL AT STOREFRONT HEAD
 1-1/2" = 1'-0"

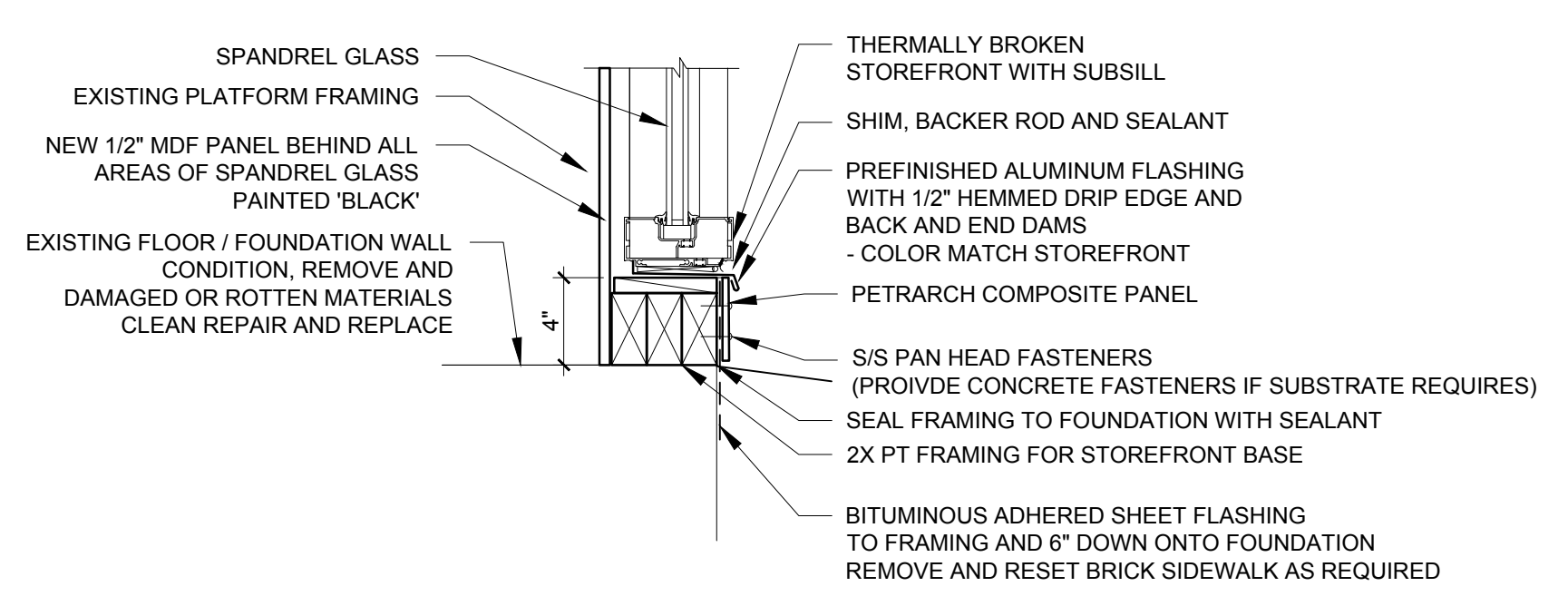

4 SILL DETAIL
 1-1/2" = 1'-0"

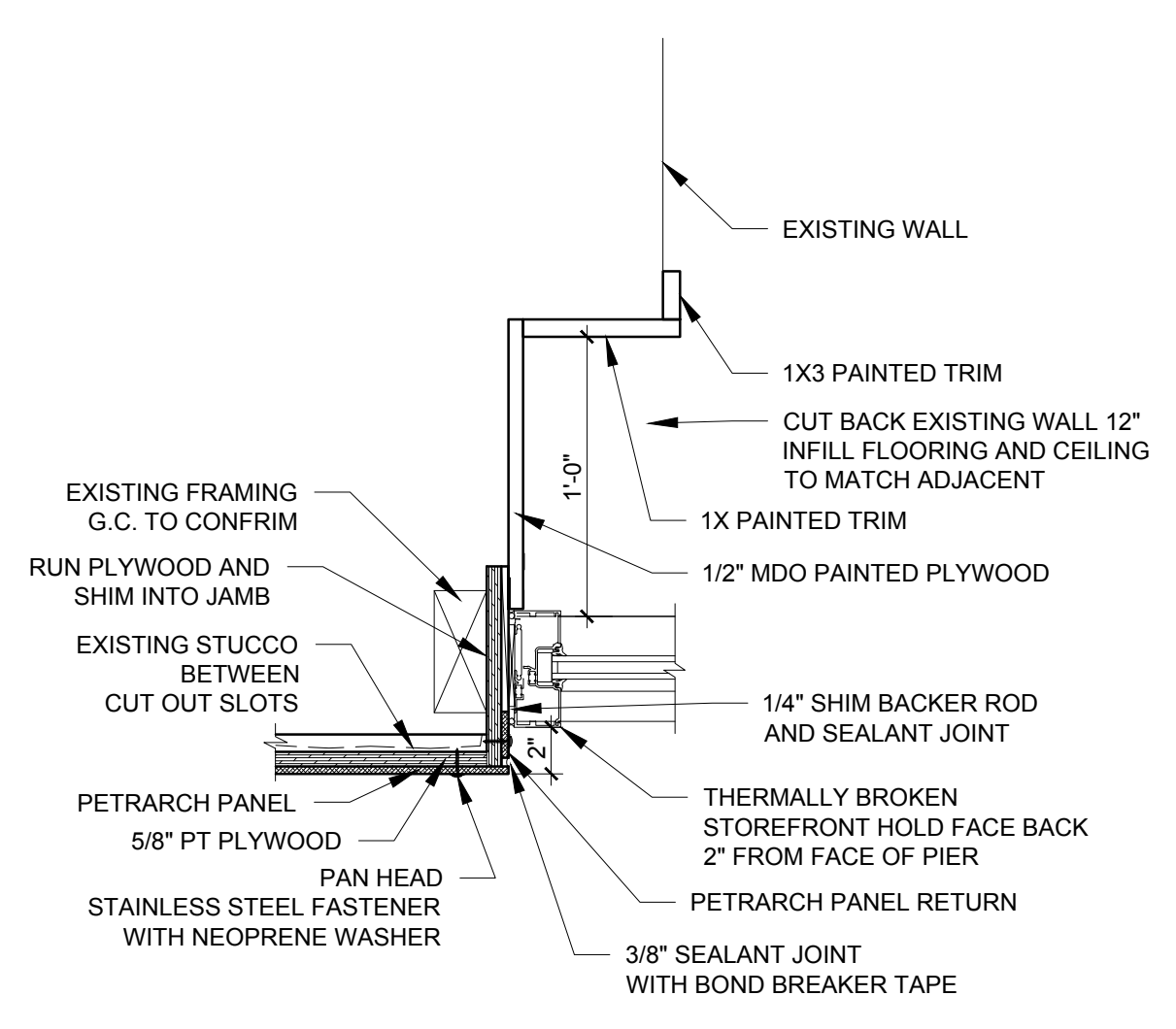

3 JAMB DETAIL
 1-1/2" = 1'-0"

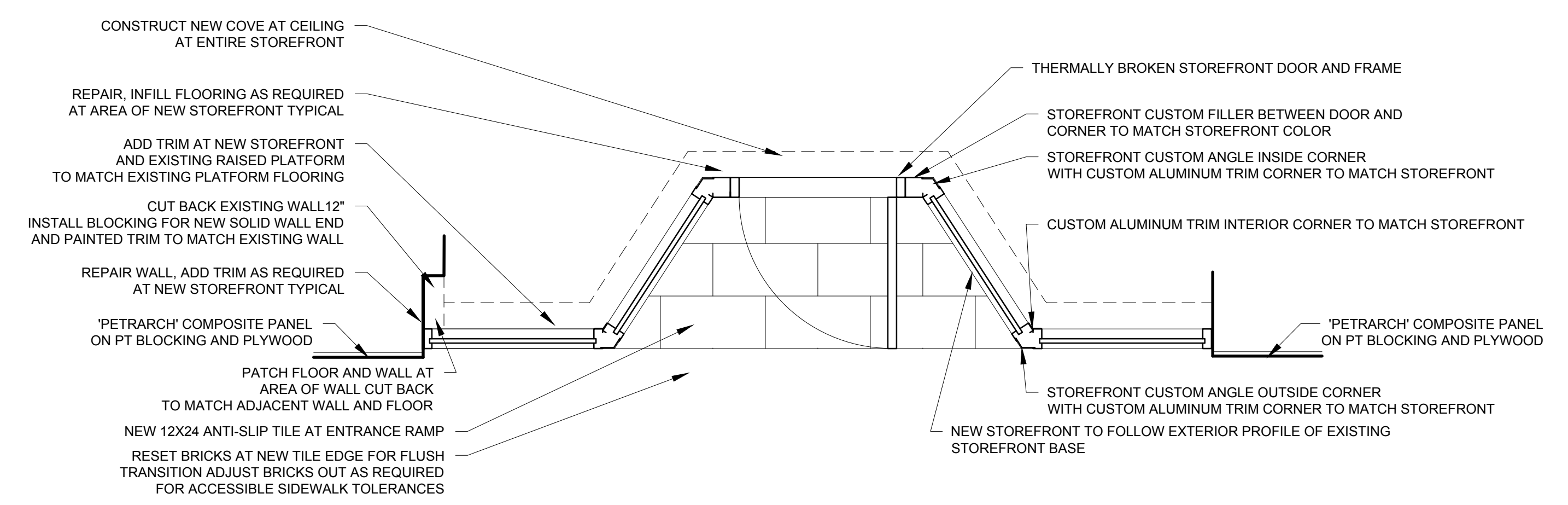

2 PLAN DETAIL
 1/2" = 1'-0"

INSTALL EXPOSED PANEL FASTENERS IN PATTERN SHOWN (DO NOT EXCEED 24" O.C. MAXIMUM SPACING)

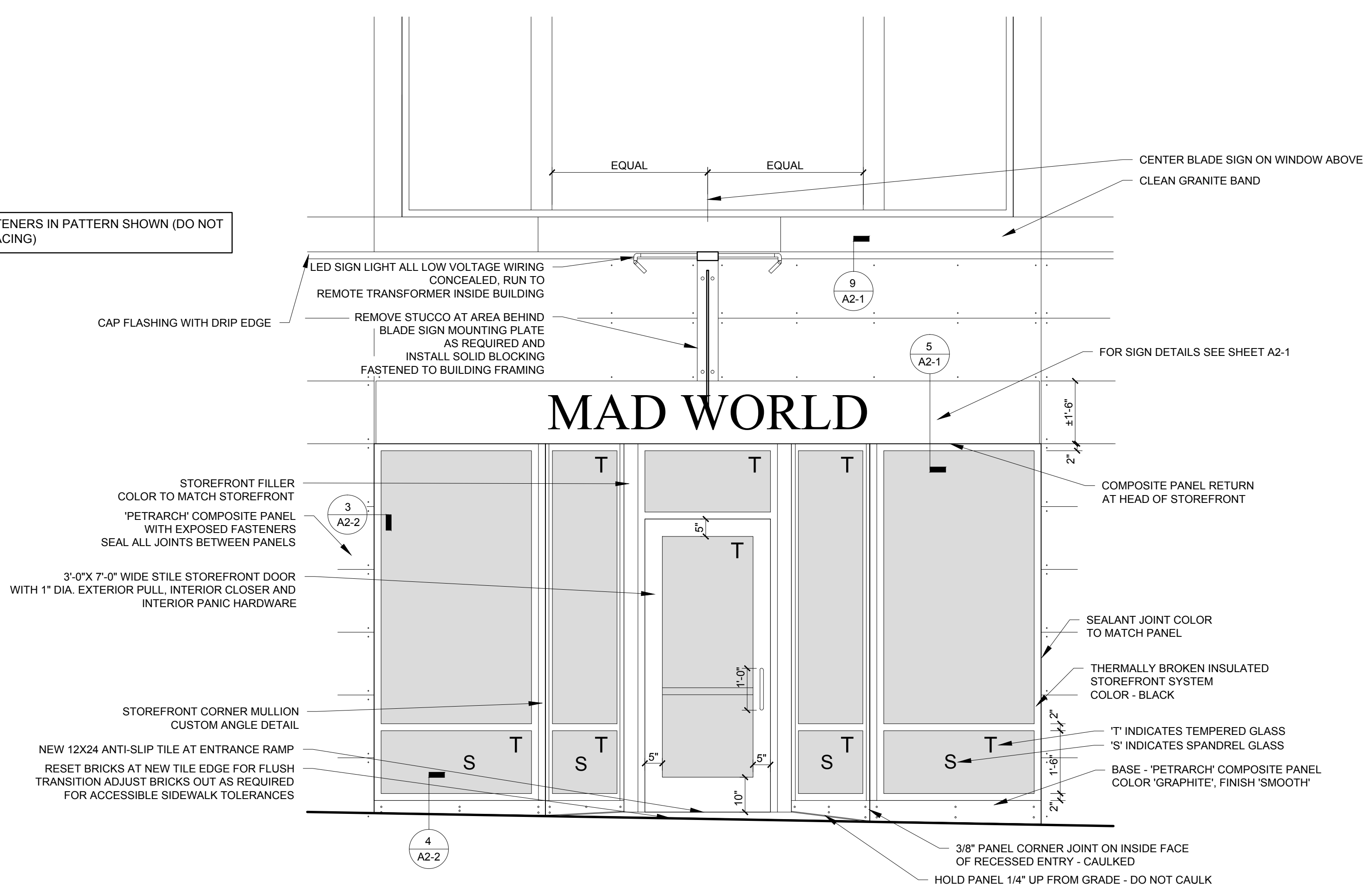

1 ELEVATION DETAIL
 1/2" = 1'-0"