

City of Portland, Maine - Building or Use Permit Application

389 Congress Street, 04101 Tel: (207) 874-8703, Fax: (207) 874-8716

Permit No: 04-0668	Issue Date: JUL 13 2004	CBL: 278 B003001
-----------------------	----------------------------	---------------------

Location of Construction: 432 Warren Ave	Owner Name: Warren Avenue Realty Llc	Owner Address: 90 Bay State Rd	Phone: 7812454800
Business Name:	Contractor Name: Batten Brothers Sign Advertising	Contractor Address: 893 Main Street W	Phone: 7812454800
Lessee/Buyer's Name	Phone:	Permit Type: Signs - Permanent	Zone: B4

Past Use: Retail Sales and Service	Proposed Use: Retail Sales and Service w/ four 4' x 4' sign panels on freestanding sign	Permit Fee: \$158.00	Cost of Work: \$0.00	CEO District: 5
Proposed Project Description: four 4' x 4' sign panels on freestanding sign		FIRE DEPT: <input type="checkbox"/> Approved <input type="checkbox"/> Denied	INSPECTION: Use Group: U Type: N/A Signature: [Signature]	

- New Free-standing sign (old is single pole) (this is double pole)

Signature: [Signature] Date: [Date]

PEDESTRIAN ACTIVITIES DISTRICT (P.A.D.)

Action: Approved Approved w/Conditions Denied

Signature: [Signature] Date: [Date]

Permit Taken By: kwd	Date Applied For: 0512412004	Zoning Approval
-------------------------	---------------------------------	------------------------

Special Zone or Reviews <input type="checkbox"/> Shoreland <input type="checkbox"/> Wetland <input type="checkbox"/> Flood Zone <input type="checkbox"/> Subdivision <input type="checkbox"/> Site Plan Maj <input type="checkbox"/> Minor <input checked="" type="checkbox"/> MM <input type="checkbox"/> Date: <i>DATA 6/14/04</i>	Zoning Appeal <input type="checkbox"/> Variance <input type="checkbox"/> Miscellaneous <input type="checkbox"/> Conditional Use <input type="checkbox"/> Interpretation <input type="checkbox"/> Approved <input type="checkbox"/> Denied Date: [Date]	Historic Preservation <input checked="" type="checkbox"/> Not in District or Landmark <input type="checkbox"/> Does Not Require Review <input type="checkbox"/> Requires Review <input type="checkbox"/> Approved <input type="checkbox"/> Approved w/Conditions <input type="checkbox"/> Denied Date: [Date]
--	--	---

of per reviewed by [Signature]

CERTIFICATION

I hereby certify that I am the owner of record of the named property. or that the proposed work is authorized by the owner of record and that I have been authorized by the owner to make this application as his authorized agent and I agree to conform to all applicable laws of this jurisdiction. In addition, if a permit for work described in the application is issued, I certify that the code official's authorized representative shall have the authority to enter all areas covered by such permit at any reasonable hour to enforce the provision of the code(s) applicable to such permit.

SIGNATURE OF APPLICANT	ADDRESS	DATE	PHONE
RESPONSIBLE PERSON IN CHARGE OF WORK, TITLE		DATE	PHONE

City of Portland, Maine - Building or Use Permit

389 Congress Street, 04101 Tel: (207) 874-8703, Fax: (207) 874-8716

Permit No: 04-0668	Date Applied For: 05/24/2004	CBL: 278 B003001
------------------------------	--	----------------------------

Location of Construction: 432 Warren Ave	Owner Name: Warren Avenue Realty Llc	Owner Address: 90 Bay State Rd	Phone:
Business Name:	Contractor Name: Batten Brothers Sign Advertising	Contractor Address: 893 Main Street Wakefield	Phone (781) 245-4800
Lessee/Buyer's Name	Phone:	Permit Type:	

Proposed Use: Retail Sales and Service w/ four 4' x 4' sign panels on freestanding sign	Proposed Project Description: four 4' x 4' sign panels on freestanding sign
---	---

Dept: Zoning **Status:** Approved with Conditions **Reviewer:** Marge Schmuckal **Approval Date:** 06/14/2004

Note: 5/27/02 spoke to Ray Young and requested a plot plan that showed where the new two pole sign would be located - needs to be 5' from the front property line. **Ok to Issue:**

6/14/04 - received a revised plan showing the property line and the location of the new sign - shows 5' from the front property line

1) This permit is being approved on the basis of plans submitted per fax dated 6/14/04. Any deviations shall require a separate approval before starting that work.

Dept: Building **Status:** Approved **Reviewer:** Mike Nugent **Approval Date:** 07/12/2004

Note: **Ok to Issue:**

Comments:

6/21/2004-mjn: need structural details advised the client and the sign maker

04-0668

Signage/Awning Permit Application

If you or the property owner owes real estate or personal property taxes or user charges on any property within the City, payment arrangements must be made before permits of any kind are accepted.

Location/Address of Construction: <u>432 WARREN AVE</u>		
Total Square Footage of Proposed Structure <u>64 SQ. FT.</u>	Square Footage of Lot <u>126785 SQ. FT.</u>	
Tax Assessor's Chart, Block & Lot Chart# <u>278</u> Block# <u>B</u> Lot# <u>3</u>	Owner: <u>WARREN AVE. REALTY LLC</u> <u>90 BAY STATE RD.</u> <u>WAKEFIELD, MA. 01880</u>	Telephone: <u>781-246-1810</u>
Lessee/Buyer's Name (If Applicable) <u>NEW ENGLAND DETROIT DIESEL</u> <u>432 WARREN AVE.</u> <u>PORTLAND, ME. 04103</u>	Applicant name, address & telephone: <u>NEW ENGLAND DETROIT DIESEL</u> <u>432 WARREN AVE.</u> <u>PORTLAND, ME. 04103</u> <u>207-797-5950</u>	Total s.f. of signage x \$2.00 per s.f. plus \$30.00/\$65.00 for H.D. signage = Total Fee: <u>\$158.00</u> Awning Fee = Cost Of Work: \$ DEPT. OF PERMITS CITY OF PORTLAND MAY 24 2004 SECRET
Current use: <u>RETAIL SALES + SERVICE</u>		
If the location is currently vacant, what was prior use: <u>N/A</u>		
Approximately how long has it been vacant <u>N/A</u>		
Proposed use: _____		
Project description: <u>Four 4' x 4' signs to be erected on existing post.</u>		
Contractor's name, address & telephone: <u>BATTEN BROS.</u> <u>SIGN ADVERTISING</u> <u>893 MAIN ST.</u> <u>WAKEFIELD, MA. 01880</u> <u>781-245-4800</u>		
Whom should we contact when the permit is ready: <u>RAY YOUNG</u>		
Mailing address: <u>NEW ENGLAND DETROIT DIESEL</u> <u>432 WARREN AVE.</u> <u>PORTLAND, ME. 04103</u>		
We will contact you by phone when the permit is ready. You must come in and pick up the permit and review the requirements before starting any work, with a Plan Reviewer. A STOP WORK ORDER will be issued and a \$100.00 fee if any work starts before the permit is picked up. PHONE: <u>207-797-5950</u> <i>xy</i>		

IF THE REQUIRED INFORMATION IS NOT INCLUDED IN THE SUBMISSIONS THE PERMIT WILL BE AUTOMATICALLY DENIED AT THE DISCRETION OF THE BUILDING/PLANNING DEPARTMENT. WE MAY REQUIRE ADDITIONAL INFORMATION IN ORDER TO APPROVE THIS PERMIT.

I hereby certify that I am the Owner of record of the named property, or that the owner of record authorizes the proposed work and that I have been authorized by the owner to make this application as his/her authorized agent. I agree to conform to all applicable laws of this jurisdiction. In addition, if a permit for work described in this application is issued, I certify that the Code Official's authorized representative shall have the authority to enter all areas covered by this permit at any reasonable hour to enforce the provisions of the codes applicable to this permit.

Signature of applicant: <u>Raymond Young</u>	Date: <u>5/21/04</u>
--	----------------------

This is NOT a permit, you may not commence ANY work until the permit is issued.

FOR:
NEW ENGLAND DDA
433 WARREN AVE.
PORTLAND, ME. 04103

WARREN AVE.

DEPT. OF BUILDING INSPECTION
PORTLAND, ME
JUN 11 2004
RECEIVED

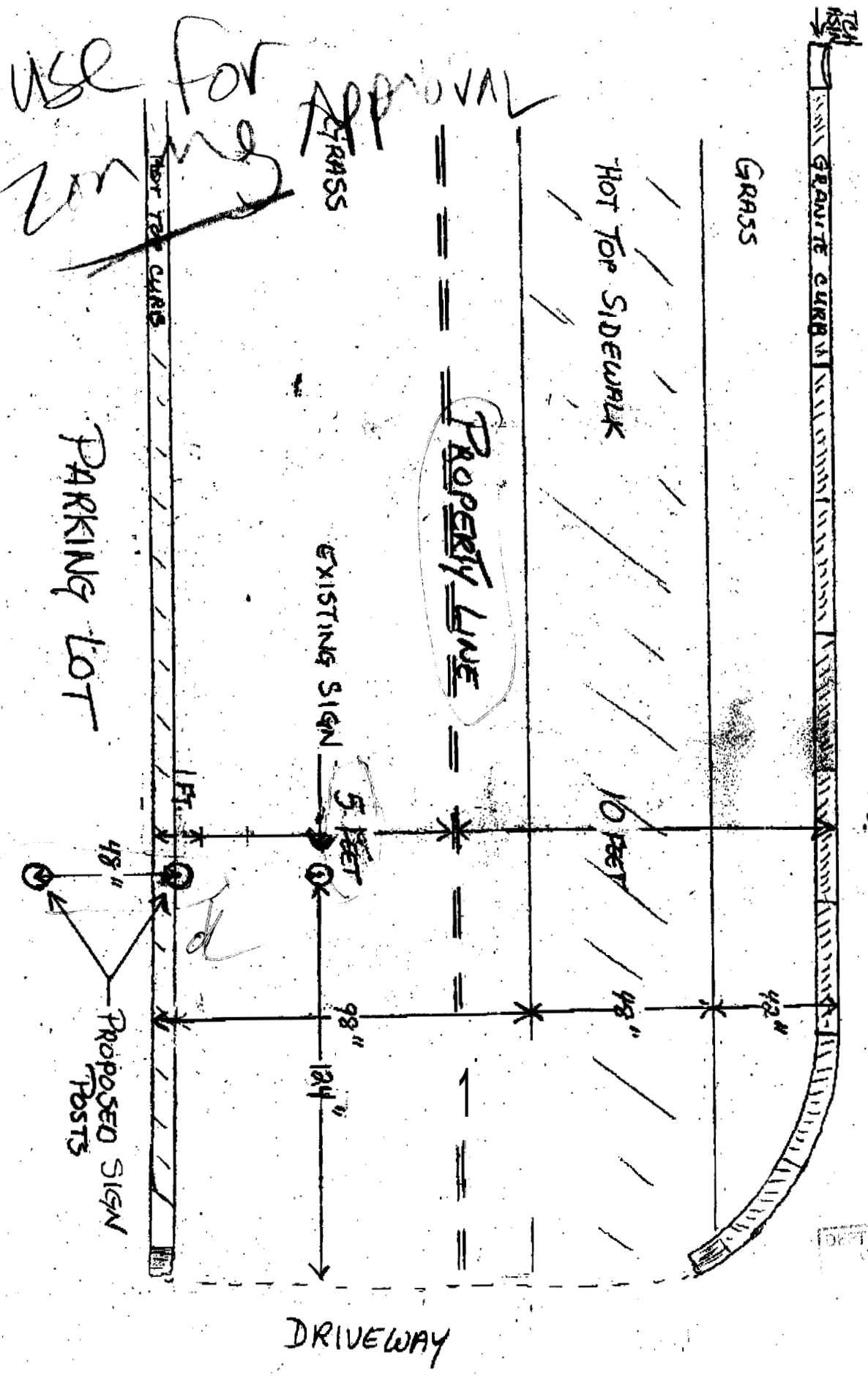



**NEW ENGLAND
DETROIT DIESEL-ALLISON**



TO: MARGE SCHMUCKAL
 COMPANY: CITY OF PORTLAND
 FAX: 874-8716

FROM: JEFF FALLES
 COMPANY: NEW ENGLAND DDA- MAINE
 FAX: (207) 797-5953
 PHONE: (207) 797-5950

OF PAGES — 2 Including Cover

COMMENTS: MARGE,
NEW SIGN POSTS WILL BE AT PARKING LOT
CURB + EXTEND INTO COMPANY PARKING LOT TO
CONFORM TO 5 FT. SET BACK.

*Thank you,
Jeff Falles*

DEPT OF BUILDING INSPECTION
 PORTLAND, ME

JUN 11 2004



TO: MARGE SCHMUCKAL
COMPANY: CITY OF PORTLAND
FAX: 874-8416

FROM: JEFF FALES
COMPANY: NEW ENGLAND DDA- MAINE
FAX: (207) 797-5953
PHONE: (207) 797-5950

OF PAGES a Including Cover

COMMENTS: MARGE.

EXISTING SIGN POST WILL BE IN THE CENTER OF
THE PROPOSED SIGN. SORRY FOR NO PICTURES AS
CAMERA IS MISSING. IF MORE INFO NEEDED PLEASE
CALL FOR RAY YOUNG.

*Thank you,
Jeff Fales*

FOR:
 NEW SUGLAND DDA
 432 WARREN AVE.
 PORTLAND, ME. 04103

WARREN AVE.

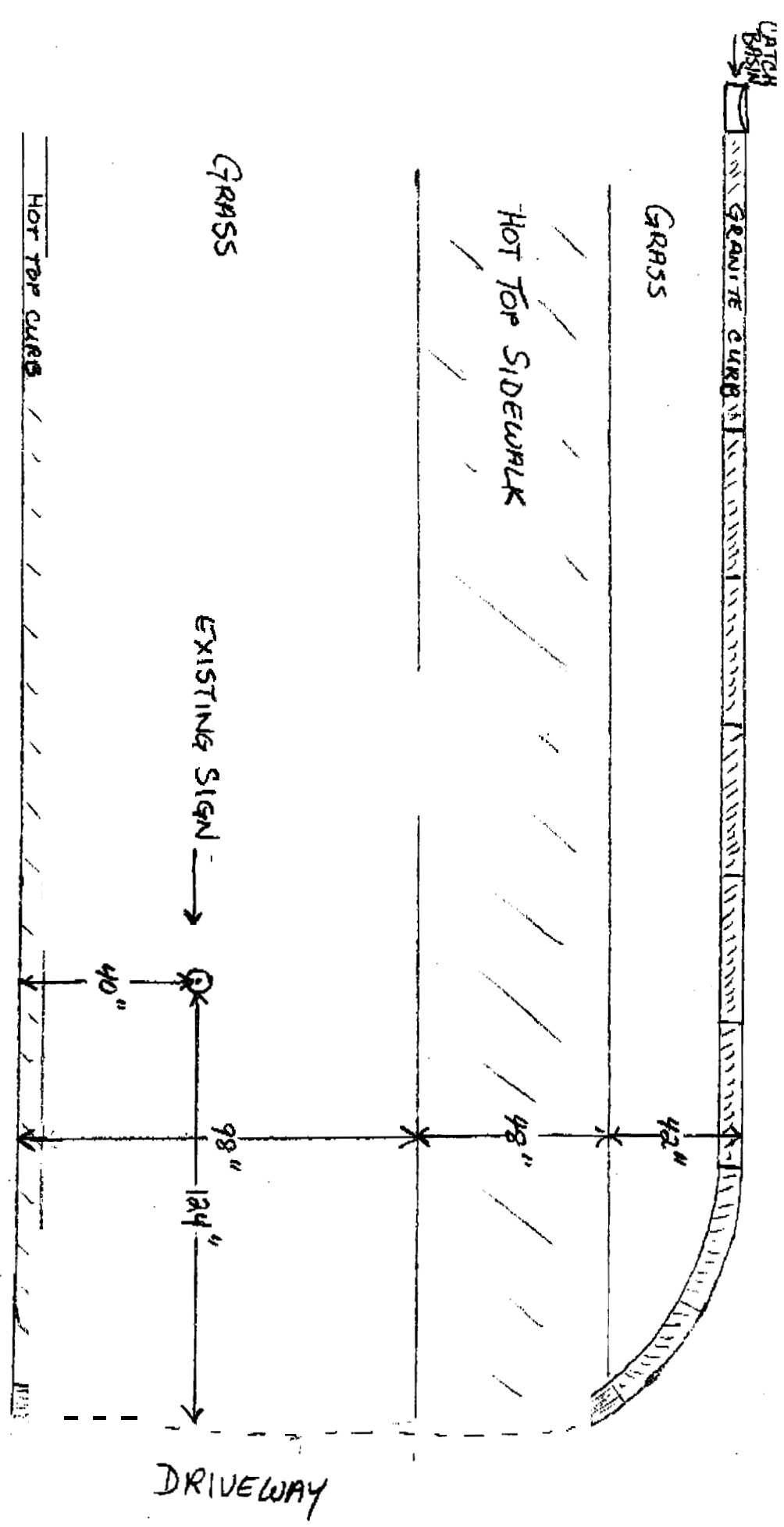

98"
 40"
 58" ←

From: Marge Schmuckal
To: port-web:jvanier@[nedda.com]
Date: Fri, Jun 11, 2004 3:00 PM
Subject: Re: sign permit

Joanne,

I had talked to Ray Young previously in reference to this sign permit. The one item that was not shown on the submittal is the location of the new ~~two~~ pole sign from the front property line. It is required to be setback five (5) feet from the front property line. I received a fax which gave me more information about the existing pole sign, and further lead me to believe that there would not be the required five foot setback to the front property line. All other aspects of the signage (height and square footage) are in compliance.

If I can receive a revised plan showing that the new sign can meet the required five foot setback from the front property, then I can further process this permit.

Thank you,
Marge Schmuckal,
Zoning Administrator

>>> "Joanne Vanier" <jvanier@nedda.com> 06/11 1:04 PM >>>
Marge:

We are trying to find out what is holding up our sign permit. New England Detroit Diesel 432 Warren Ave. Would you please e-mail me back.

Thank You
Joanne Vanier



EXISTING SIGN

SITE OF PROPOSED SIGN

DETROIT
DIESEL

Carrier
TRANSCOLD
TRANSPORT
REFRIGERATION

*single pole
now*

*As a
double pole*

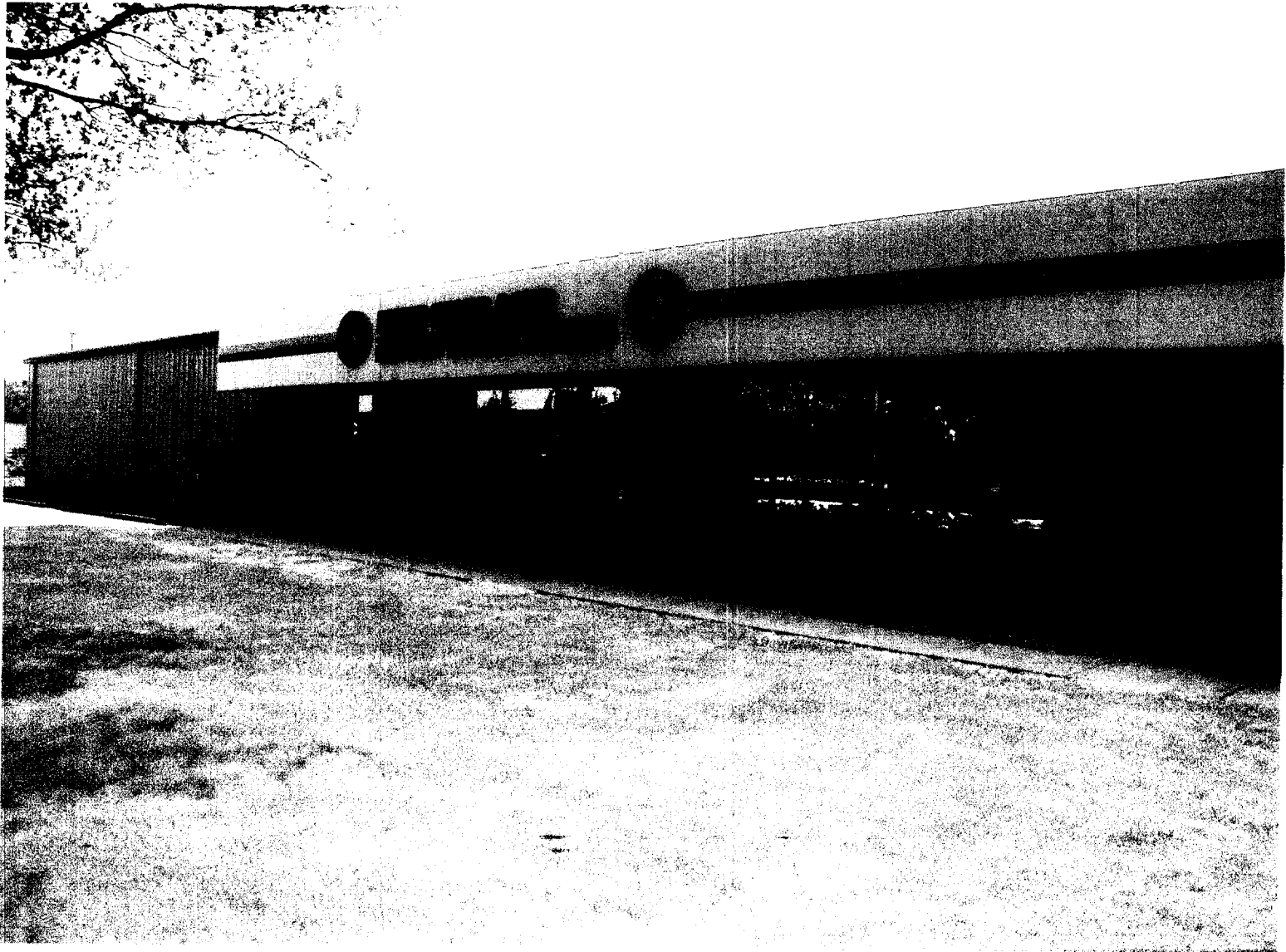

CHECKLIST FOR SIGN/AWNING APPLICATION

Applicants for a sign or awning permit are required to submit the following information to the Code Enforcement Office at the time of application:

- Certificate of Liability listing the City as additional insured if any portion of the sign abuts or encroaches on any public right of way, or can fall into any public right of way. Amount must equal \$400,000.00.
- Letter of permission from the owner indicating the permissions granted and the tenant/space building frontage.
- A sketch plan of lot, indicating location of buildings, driveways, and any abutting streets or rights of way, lengths of building frontages, street frontages, and all existing setbacks. **Indicate on the plan all existing: and proposed signs with their dimensions and specific locations. Be sure to include distance from the ground and building facade dimensions for any signage attached to a building.**
- A sketch or photo of any proposed sign(s) indicating *content, dimensions, materials, source of illumination, and construction method, as well as specifics of installation/attachment.*
- Certificate of Flammability required for awning or canopy at time of application.
- UL# required for lighted signs at the time of Final Inspection. Failure to provide this information will invalidate the Sign Permit.
- Pre-Application Questionnaire completed and attached. Photos of existing signage attached.

**Permit Fee for signage or awning-with-signage:
\$30.00 plus \$2.00 per square foot of sign.**

**Permit Fee for awning-without-signage is based on cost of work:
\$30.00 for the first \$1,000.00, plus \$9.00 for each additional \$1,000.00.**

Base Application Fee for any Historic District signage is \$65.00 instead of \$30.00



BATTEN BROS.
Sign Advertising

Mr. Ray Young
New England Detroit Diesel-Allison
432 Warren Ave.
Portland, ME

May 21,2004

Ray,

Batten Bros., Inc. Is a UL listed sign company. *Our* subscriber number is 774077-001.
Ths sign we will produce for you will have a UL sticker.

If you have any questions please don't hesitate to call.

Thanks,

Richard E. Batten



President



BATTEN BROS.
Sign Advertising

Richard E. Batten

893 Main Street
Wakefield, MA 01880
www.battensign.com

T 781.245.4800
F 781.246.4798
richard@battensign.com

SIGNS ARE 4'x4' DOUBLE FACE INTERNALLY ILLUMINATED SIGN CABINETS.

UPRIGHTS TO BE 5"x5" OR 6"x6" STEEL POLES WITH WELDED CROSS BEAMS TO SUPPORT CABINETS.

POLES TO BE COVERED WITH 10"x10" BAKED ENAMEL FINISH ALUMINUM POLE WRAPS. POLES TO BE INSTALLED ON A CUSTOM FABRICATED ANCHOR BOLT SYSTEM.

Proposed Signage

4 - 4'x4' = 16 sq ft
total 64 sq ft

lot size is 126,785 sq ft
single tenant lot

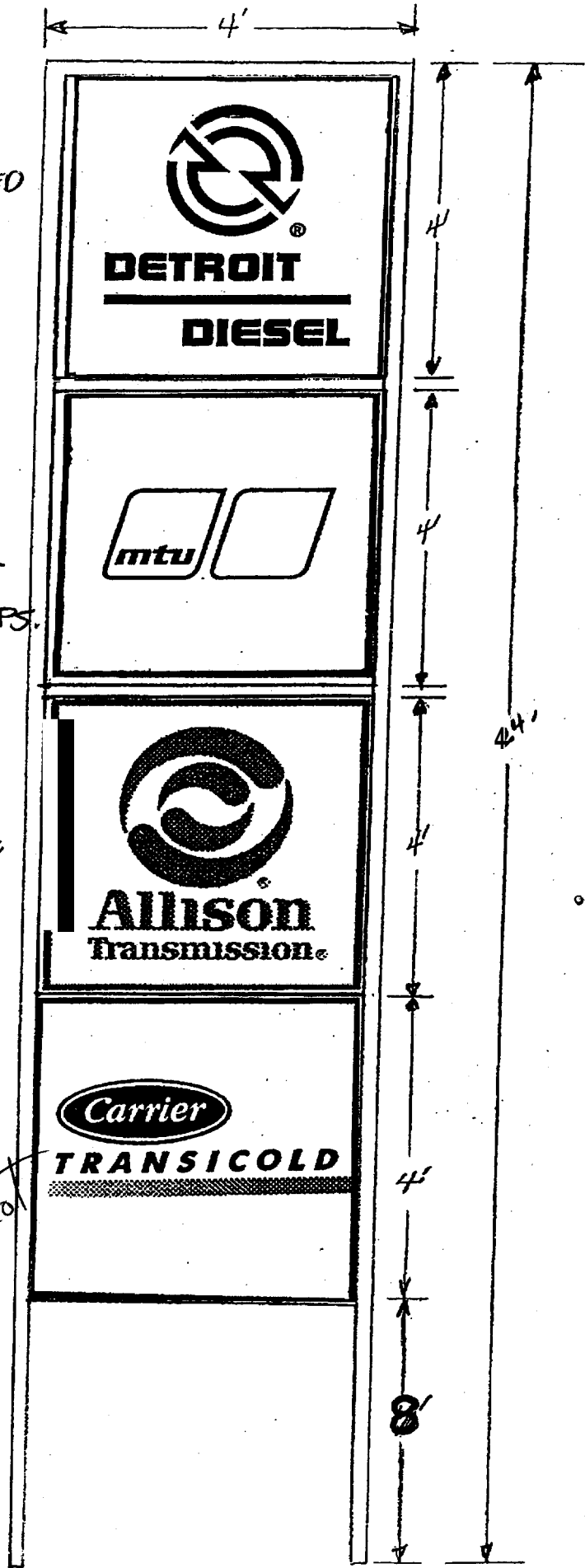

SIGNAGE/AWNING PRE-APPLICATION QUESTIONNAIRE

PLEASE COMPLETE ALL INFORMATION

ADDRESS: 432 WARREN AVE ZONE: B4

CBL: N/A

SINGLE TENANT LOT? YES NO MULTI TENANT LOT? YES NO
MORE THAN ONE SIGN TOTAL WITH PROPOSED SIGN? YES NO

TENANT/ALLOCATED BUILDING SPACE FRONTAGE (FEET):
Length: 125' Height: 12'

INFORMATION ON PROPOSED SIGN(S):
FREESTANDING (e.g., pole) SIGN? YES NO DIMENSIONS PROPOSED: 4' WIDE / 24' HIGH
BLDG. WALL SIGN? (attached to bldg) YES NO DIMENSIONS PROPOSED: _____

INFORMATION ON ALREADY EXISTING AND PERMITTED SIGN(S):
FREESTANDING (e.g., pole) SIGN? YES NO DIMENSIONS: 20' HIGH / 4' WIDE
BLDG. WALL SIGN (attached to bldg)? YES NO DIMENSIONS: _____
AWNING? YES NO DIMENSIONS: _____
LOT FRONTAGE (FEET): 323'

AWNING YES NO IS AWNING BACKLIT? YES NO
HEIGHT OF AWNING: _____ LENGTH OF AWNING: _____ DEPTH: _____
IS THERE ANY COMMUNICATION, MESSAGE, TRADEMARK OR SYMBOL ON IT? YES NO
IF YES, TOTAL S.F. OF PANELS WITH COMMUNICATIONS/MESSAGE/TRADEMARK/SYMBOL? _____ s.f.

A SITE SKETCH AND BUILDING SKETCH SHOWING EXACTLY WHERE EXISTING AND NEW SIGNAGE IS LOCATED MUST BE PROVIDED. SKETCHES AND/OR PICTURES OF PROPOSED SIGNAGE ARE ALSO REQUIRED.

SIGNATURE OF APPLICANT: [Signature] DATE: 5/2/04

***** FOR OFFICE USE ONLY *****
B-4
single tenant lots allow:
65' # - 64' # show
25' max height - 24' show
5' set back - 6/11/04 faxed plans showing the 5' of set back
changing sign pole



SENTRY SELECT INSURANCE COMPANY
 STEVENS POINT, WISCONSIN
 A PARTICIPATING STOCK COMPANY
 A MEMBER OF THE SENTRY FAMILY OF INSURANCE COMPANIES

CERTIFICATE OF INSURANCE

ACCOUNT NUMBER 49-76879

This certificate is issued as a matter of information only and confers no rights upon the certificate holder. This certificate does not amend, extend or alter the coverage afforded by the policies below.

Name and Address of Certificate Holder

CITY OF PORTLAND
 ZONING PLANNING ADMIN
 MARGE SCHMUCKAL
 389 CONGRESS STREET
 PORTLAND, ME 04101

Name and Address of the Insured

NEW ENGLAND DETRIOT DIESEL
 ALLISON INC
 90 BAY STATE RD
 WAKEFIELD, MA 01880

This certificate is issued on 01-01-2004 and is effective until-01-01-2005. It certifies that policies of insurance listed below have been issued to the insured named above. Notwithstanding any requirement, term or condition of any contract or other document with respect to which this certificate may be issued or may pertain, the insurance afforded by the policies described herein is subject to all the terms, exclusions, and conditions of such policies. Limits shown may have been reduced by paid claims.

Coverage Provided	Policy Number	All Limits in Thousands	
General Liability	49-76879-01	General Aggregate	N/A
Bodily Injury and Property Damage Combined	OCCURRENCE	Products Aggregate	N/A
		Pers/Adv Injury	\$ 500
		Each Occurrence	\$ 500
		Premises Damage	\$ 100
		Medical Expense	\$ 5
Automobile Liability	49-76879-01	Each Accident	\$ 500
Includes: Bodily Injury and Property Damage Combined - Any Auto			
Umbrella Liability	49-76879-01	Each Occurrence	\$ 10,000
		General Aggregate	\$ 10,000
		Products Aggregate	\$ 10,000
General Liability	49-76879-04	General Aggregate	N/A
Bodily Injury and Property Damage Combined	OCCURRENCE	Products Aggregate	N/P
		Pers/Adv Injury	\$ 500
		Each Occurrence	\$ 500
		Premises Damage	\$ 100
		Medical Expense	\$ 5

RD-C1035 (SEA)

NEW 49-76879 01-019920
 05-18-2004
 PAGE 1
 (0267)

01T07NB



CERTIFICATE OF INSURANCE - (CONT)**ACCOUNT NUMBER 49-76879**

Coverage Provided	Policy Number	All Limits in Thousands		
Automobile Liability	49-76879-07	Each Accident	\$	500

Includes: Bodily Injury and
Property Damage **Combined**
-Any Auto

If any of the listed policies are cancelled prior to their normal **expiration** date, the insurer **will** endeavor to send **notice** to the certificate holder **30** days in advance. Failure **to** mail such notice shall impose no obligation or liability **of any kind** upon the Insurer.

80-C1035 (SFA)

NEW 49-76879 01-019920
05-18-2004
PAGE 2
(0267)

0118JNB

SENTRY SELECT INSURANCE COMPANY
STEVENS POINT, WISCONSIN
(A PARTICIPATING STOCK COMPANY)
A MEMBER OF THE SENTRY FAMILY OF INSURANCE COMPANIES

COMMERCIAL GENERAL
LIABILITY POLICY

GENERAL LIABILITY DECLARATIONS

POLICY NUMBER **49-76879-01**

NAME INSURED: NEW ENGLAND DETRIOT DIESEL

ADDITIONAL INSURED
SCHEDULE

The following information is required to complete the accompanying
additional insured endorsement which forms a part of the Named Insured's
COMMERCIAL GENERAL LIABILITY COVERAGE PART.

<u>ADDITIONAL INSURED</u>	<u>ENDORSEMENT</u>	<u>EFFECTIVE</u>
CITY OF PORTLAND ZONING PLANNING ADMIN MARGE SCHMUCKAL 389 CONGRESS STREET PORTLAND, ME 04101	CG 20 26 11 85	FROM JANUARY 01, 2004 TO JANUARY 01, 2005

FOR ENDORSEMENT TEXT,
SEE OVER.

CG 89 01 11 85 (MECH)

NEW 49-76879-01 40 041
05-18-2004
(000 0267)

NEW ENGLAND

DETROIT DIESEL-ALLISON

May 18, 2004

Ms Marge Schmuckal
Planning Administrator
City of Portland
389 Congress Street
Portland, ME 04101

RE: AUTHORIZATION TO ERECT A SIGN

Dear Ms Schmuckal:

Please be advised that **as** President of New England Detroit Diesel-Allison, Inc., with the additional authority to act on behalf of the landlord, we have given Ray Young full authority to make the necessary changes to our franchise signs that will bring us into compliance with their requirements.

I have reviewed the information completed on the Application and am in full accord with Ray's information.

If you have any questions with regard to this subject, please feel free to call.

Sincerely,

NEW ENGLAND DETROIT DIESEL-ALLISON, INC.

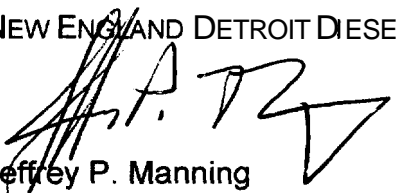
Jeffrey P. Manning
President

JPM:jaq

New England Detroit Diesel-Allison Inc.
90 Bay State Road Wakefield, MA 01880 • Tel 781-246-1810, Fax 781-246-1218
432 Warren Avenue Portland, ME 04103 • Tel 207-797-5950, Fax 207-797-5953

Distributor for:



DETROIT DIESEL 

 **Allison**
Transmission

See revised
taxed site plan of block
doesn't
look like
a 5' setback

T.M. OIL Co.

GEORGIA-PACIFIC

SHOP
PARKING
LOT

238'

PARK
LOT

CHAIN LINK FENCE

EXISTING
SIGN

SIDEWALK

DRIVEWAY

PARK
LOT

SIDEWALK

SHOP
PARKING
LOT

BUILDING

SIDEWALK

323'

LAWN

WARREN
AVE.

PORTLAND TERMINAL Co.

SHOP
PARKING
LOT

LAWN

PARK
LOT

SIDEWALK

27'

DRIVEWAY

412'

PORTLAND WATER DISTRICT
50 FT. R.O.W.

N.E. DETROIT DIESEL PORTLAND, MAINE

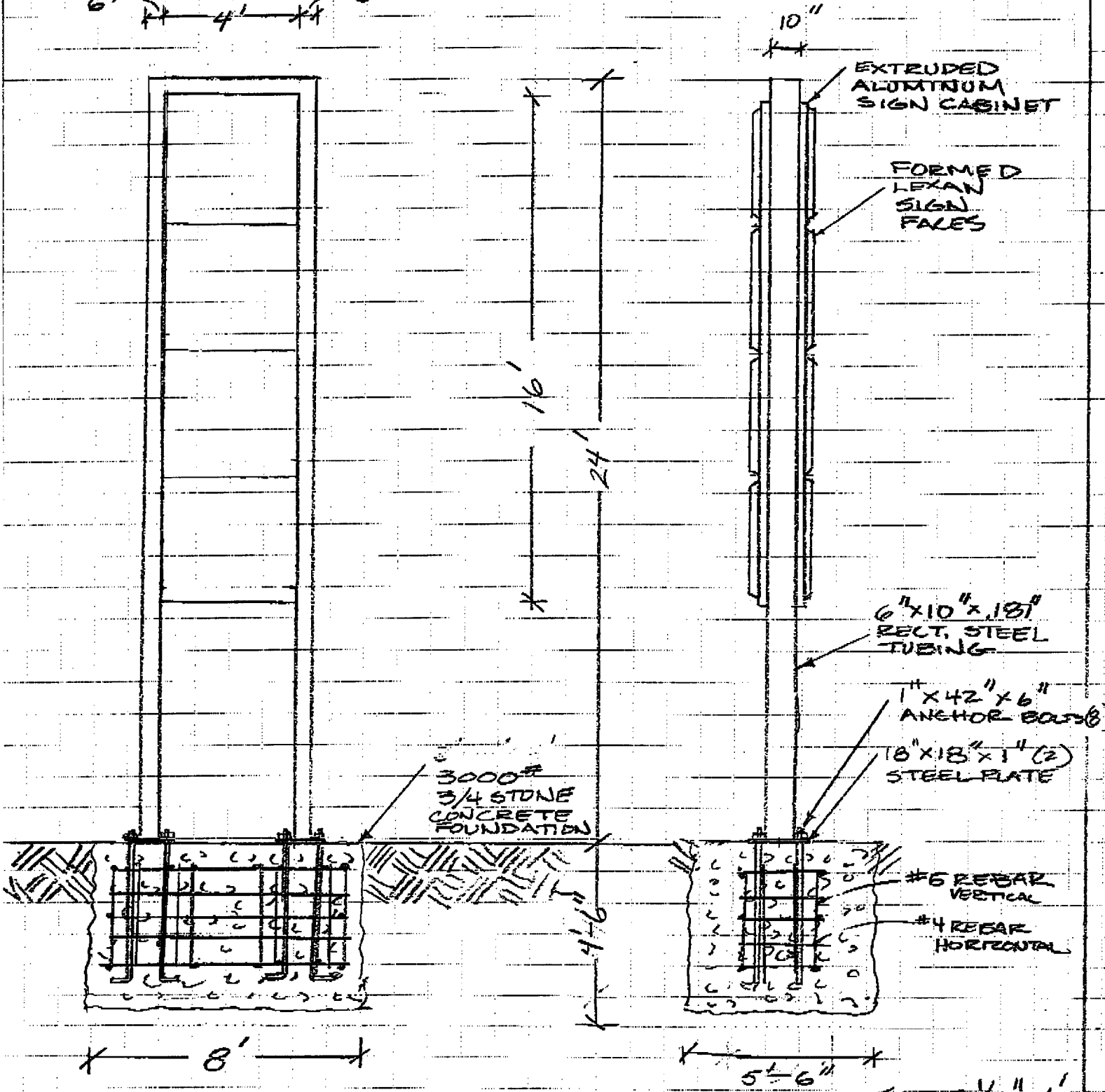
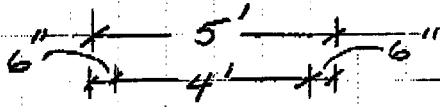

DOUBLE FACED PYLON SIGN

SCALE 1/4" = 1'

24-06

BATTEN BROS. SIGN

WE DETROIT DIESEL
 PORTLAND, ME

JET 8/29/04

1/3

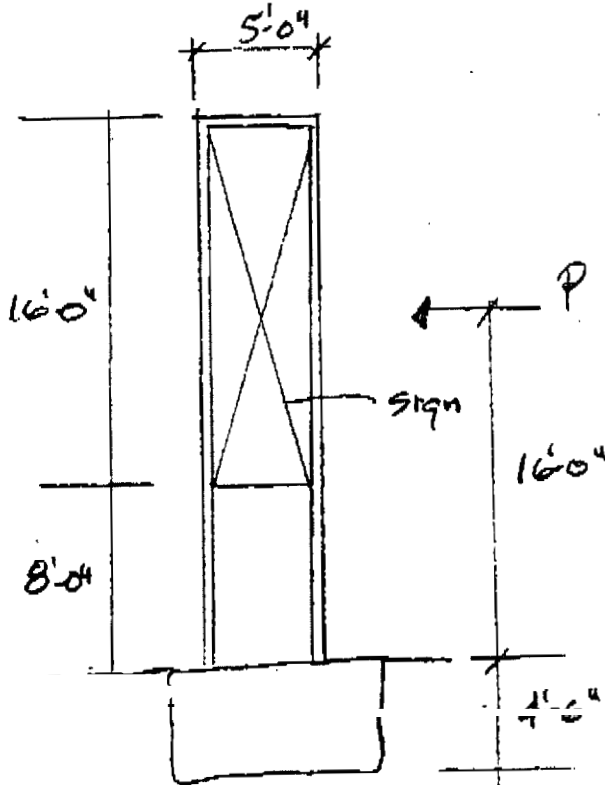

WIND @ 21 psf
 gust @ 15
 pressure @ 32 psf

$$P = 5 \times 16 \times 32 = 2560^{\#}$$

$$M_{col} = \frac{2560 \times 16}{2} = 20480'$$

$$M_{FTG} = 2560 \times 20.5 = 52480^{\#}$$

FTG @ 5'0"

$$W_{FTG} = 8 \times 5 \times 4.5 \times .15 = 27.0^{\#}$$

$$M_R = 27 \times 2.5 = 67.5$$

$$FSOT = \frac{67.5}{52.5} = 1.3 \text{ TOO LOW}$$

@ 5'6"

$$W_{FTG} = 8 \times 5.5 \times 4.5 \times .15 = 29.7^{\#}$$

$$M_R = 29.7 \times 2.75 = 81.7$$

$$FSOT = \frac{81.7}{52.5} = 1.6 \text{ OK}$$

$$e = \frac{52.5}{29.7} = 1.77$$

$$\frac{e}{b} = \frac{1.77}{5.5} = .32$$

$$K = 3.87$$

$$\sigma = \frac{3.87 \times 29.7}{b^2} = 2.16 \text{ KSI}$$

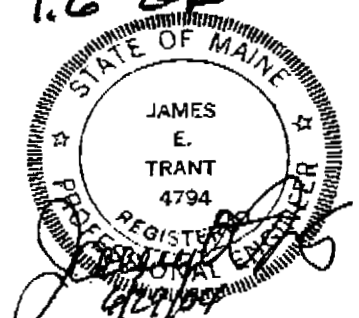

04-06

BATTEN BROS SIGN

NE VETROIT DIESEL
 PORTLAND, ME

JET 6/29/04

2/3

COLUMN

$M_{col} = 20.5^{1k}$

$F_b = .6 \times 46 \times 1.33 = 36.7 \text{ ksi}$

$S_{req'd} = \frac{20.5 \times 12}{36.7} = 6.7$

use HSS 10x6x1/4

ANCHOR BOLTS

$\frac{20.9 \times 12}{14} = \frac{17.9}{2} = 9.0 \text{ k/bolt}$

$f_t = 20 \text{ ksi} \quad A_{req'd} = \frac{9}{20} = .45 \text{ in}^2$

use 1" ϕ ($A = .606 \text{ in}^2$)

development = $\frac{9}{28 \times .15} = 19.1^{1k}$
 use 24"

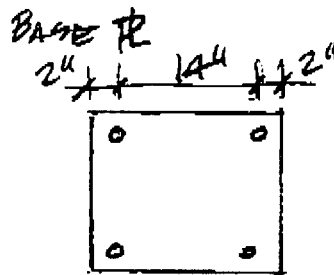

$F_{PL} = \frac{17.9}{18} = 1.0 \text{ k/in}$

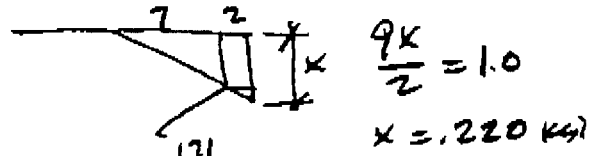

$M = \frac{171 \times 2^2}{2} + \frac{24 \times 2^3}{6} = 374^{1k-in}$

@ 27 ksi $S_{req'd} = .014 \text{ in}^3/\text{in}$

$t = \sqrt{\frac{.014 \times 6}{1}} = 0.29^{1k}$

use 1" PL

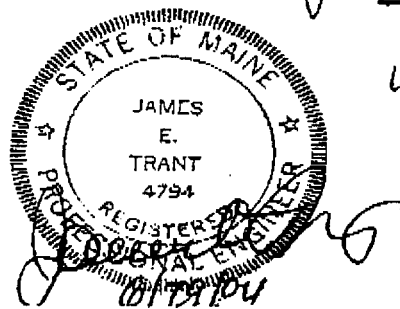
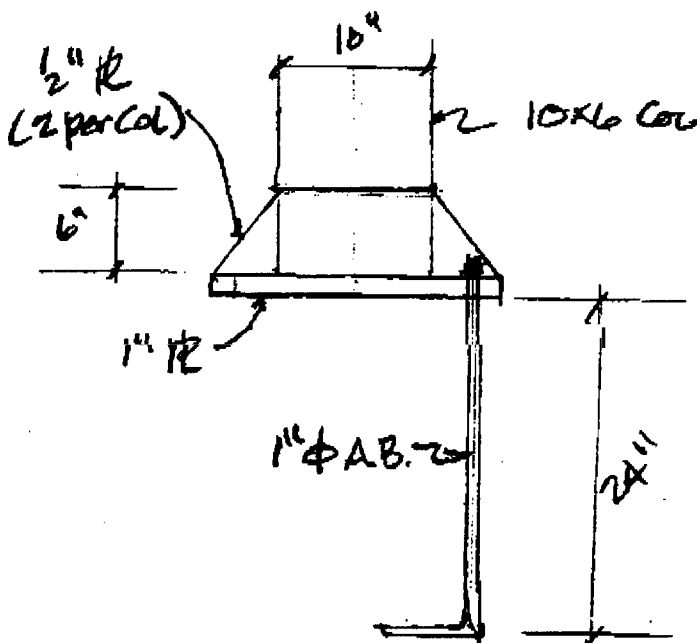

34-06 BATTEN BROS SIGN

NE DETROIT DIESEL
PORTLAND, ME

JST 6/29/04

3/3

