



ALPHAarchitects
17 CHESTNUT STREET
PORTLAND, ME 04101
PHONE: 207.761.9500
FAX: 207.761.9595
design@alphaarchitects.com

© COPYRIGHT
Reuse or reproduction of the contents of this document is not permitted without written permission of ALPHA ARCHITECTS

FOR PERMIT

Station 415

415 Cumberland Avenue
Portland, ME. 04101

JOB: 16110

ISSUE DATE	
PRELIM	01-17-16
SFMO	-
CD's	-
REV. 1	-
REV. 2	-
PRINT	-

SECOND FLOOR FRAMING PLAN
S1.3

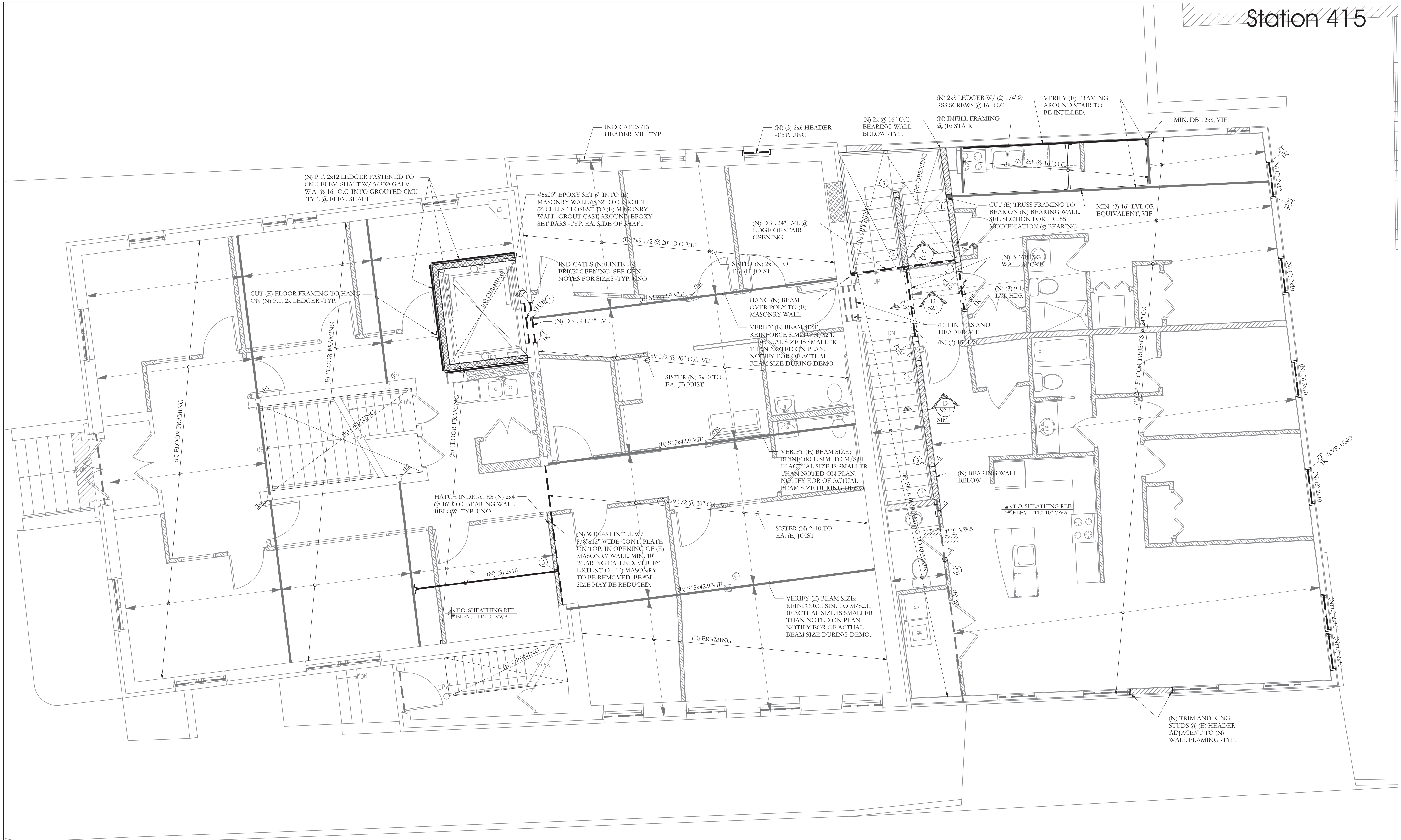

SECOND FLOOR FRAMING PLAN
SCALE 1/4"=1'-0"

- NOTES:
- SEE SHEET S1.0 FOR GENERAL STRUCTURAL NOTES
 - FLOOR SHEATHING SHALL BE 3/4" T&G SHEATHING. SEE GEN NOTES FOR MORE INFO.
 - ALL WOOD COLUMNS IN 2x6 WALLS SHALL BE (3) 2x6 AND IN 2x4 WALLS SHALL BE (3) 2x4 UNO
 - ALL HEADERS ARE DROPPED UNO
 - ALL HEADERS ARE (3) 2x6 UNO
 - ALL BEAMS ARE FLUSH UNO.

FRAMING PLAN SYMBOLS KEY

□	WOOD POST
○	STEEL COLUMN
⊙	NUMBER OF WOOD STUDS IN POST BELOW
A	COLUMN ABOVE THIS LEVEL
C	COLUMN CONTINUOUS THROUGH THIS LEVEL
→	JOIST BEARING
→	CONTINUOUS JOIST WITH INTERMEDIATE BEARING
→	FLUSH FRAMED JOIST BEARING WITH HANGER
→	WOOD STUD BEARING WALL BELOW
—	SHEAR WALL
⊙	NUMBER OF TRIM STUDS UNDER HEADER
⊙	NUMBER OF KING STUDS ADJACENT TO HEADER

LEGEND

—	DROPPED BEAM
—	FLUSH BEAM

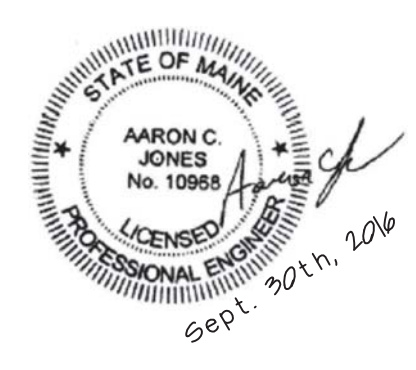

Structural Integrity
Consulting Engineers, Inc.
77 Oak Street
Portland, ME, 04101
p. 207-774-4614
f. 866-793-7835
www.structuralintegrity.com

SI # 16-0036

11-22-16

BUILD WITH CONFIDENCE
© 2016 Structural Integrity Consulting Engineers, Inc.