



© COPYRIGHT

Reuse or reproduction of the contents of this document is not permitted without written permission of ALPHA ARCHITECTS

FOR PERMIT

**Station 415**  
415 Cumberland Avenue  
Portland, ME. 04101

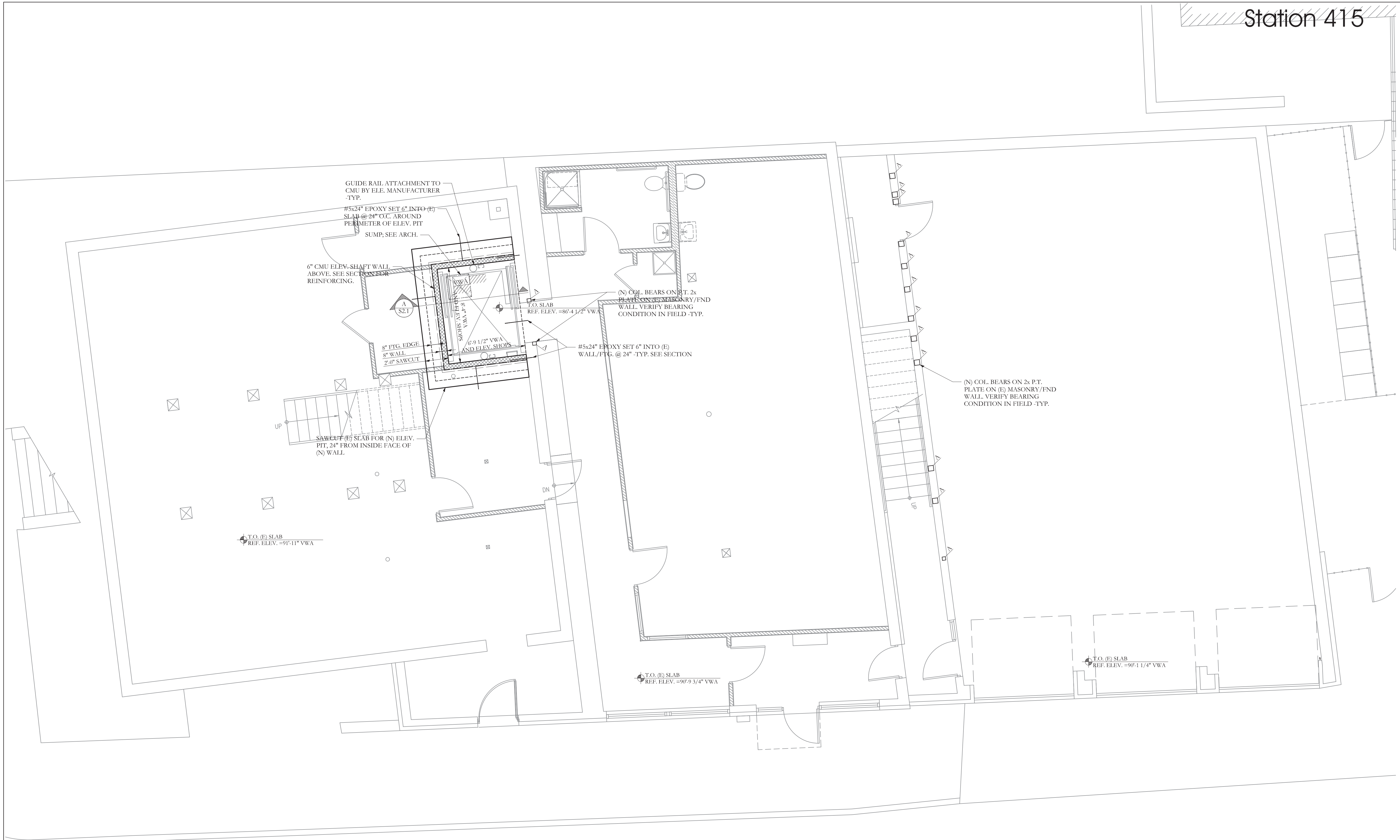

FOREST AVENUE

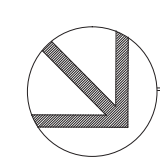

FOUNDATION/BASEMENT PLAN

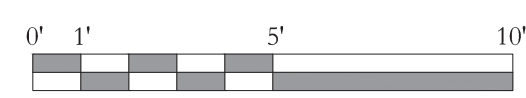

SCALE 1/4"=1'-0"

NOTES:

1. ALL FOOTINGS ARE 12" DEEP -TYP.
2. STEP IN TOP OF FOUNDATION WALL IS INDICATED THUS: AND SHOWS LOWER SIDE OF WALL.
3. SEE S1.0 FOR STRUCTURAL GENERAL NOTES
4. BOTTOM OF FOOTING TO BEAR 4'-6" BELOW GRADE, MIN. AND IS INDICATED THUS: (XX'-XX")
5. STEP IN TOP OF FOOTING IS INDICATED THUS: AND SHOWS LOWER FOOTING.
6. TOP OF WALL ELEV. NOTED IN SECTION

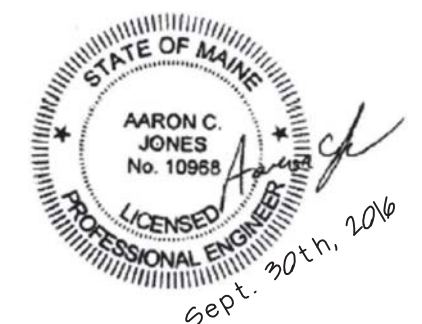

77 Oak Street  
Portland, ME, 04101  
p. 207-774-4614  
f. 866-793-7835  
www.structuralinteg.com

SI # 16-0036

BUILD WITH CONFIDENCE  
© 2016 Structural Integrity Consulting Engineers, Inc.

11-22-16

JOB: 16110

ISSUE DATE	
PRELIM	01-17-16
SFMO	-
CD's	-
REV. 1	-
REV. 2	-
PRINT	-

FOUNDATION PLAN

**S1.1**