

ALPHAarchitects
 17 CHESTNUT STREET
 PORTLAND, ME 04101
 PHONE: 207.761.9500
 FAX: 207.761.9595
 design@alphaarchitects.com

COPYRIGHT

Reuse or reproduction of the contents of this document is not permitted without written permission of ALPHA ARCHITECTS

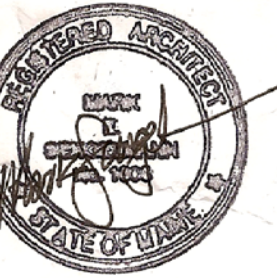

Station 415

415 Cumberland Avenue
 Portland, ME. 04101

JOB: 16110

ISSUE DATE	
PERMIT	10-04-16
SFMO	09-29-16
CD's	-
REV. 4	11-17-16
REV. 5	01-09-17
PRINT	11-17-16

ARCHITECTURAL SITE PLAN

AS1.1

01-09-17

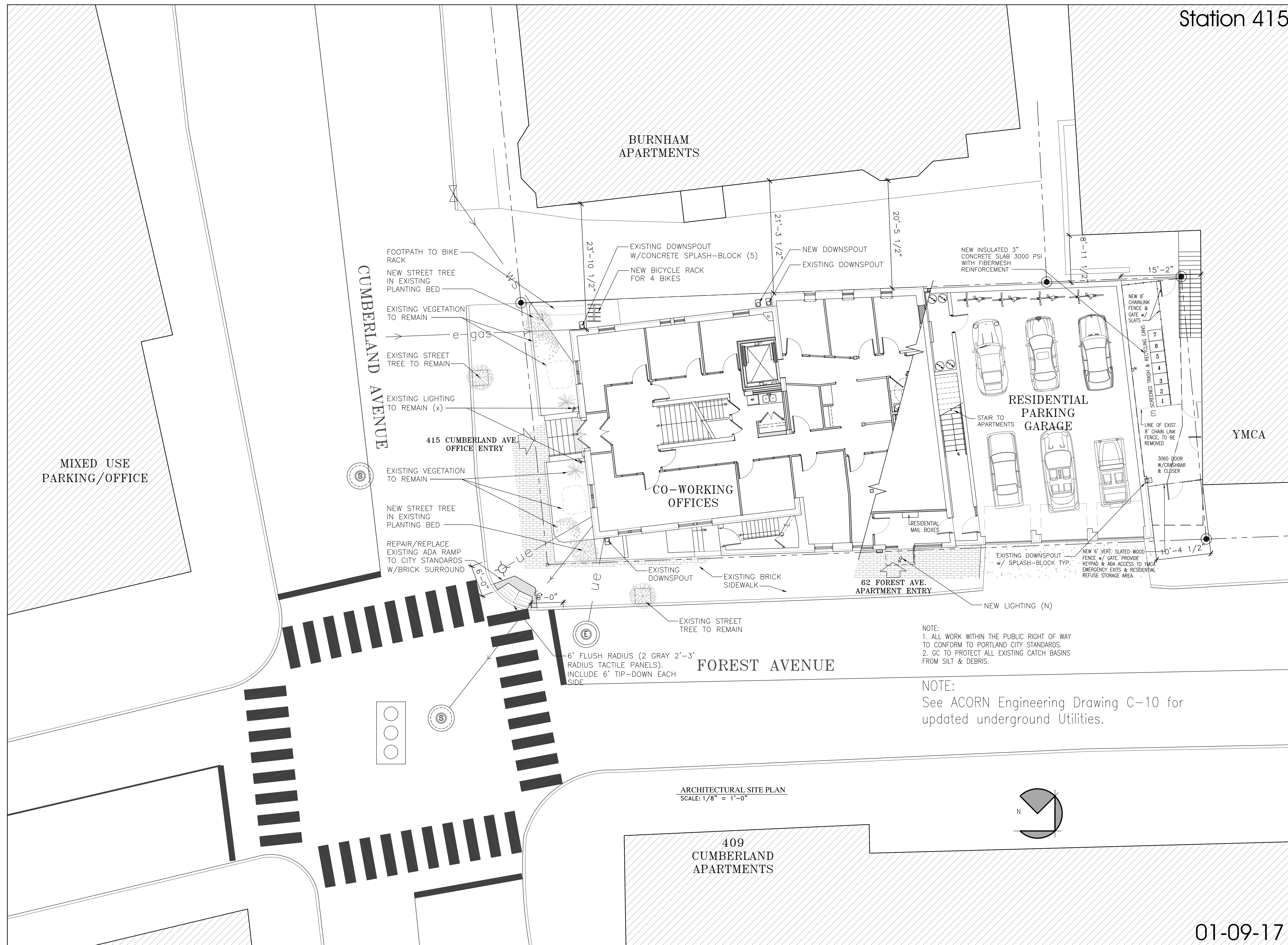

NOTE:
 1. ALL WORK WITHIN THE PUBLIC RIGHT OF WAY TO CONFORM TO PORTLAND CITY STANDARDS.
 2. GC TO PROTECT ALL EXISTING CATCH BASINS FROM SILT & DEBRIS.

NOTE:
 See ACORN Engineering Drawing C-10 for updated underground Utilities.

ARCHITECTURAL SITE PLAN
 SCALE: 1/8" = 1'-0"

409 CUMBERLAND APARTMENTS

MIXED USE PARKING/OFFICE

BURNHAM APARTMENTS

YMCA

EXISTING DOWNSPOUT W/ CONCRETE SPLASH-BLOCK (5)
 NEW BICYCLE RACK FOR 4 BIKES

NEW INSULATED 3" CONCRETE SLAB 3000 PSI WITH FIBERMESH REINFORCEMENT

RESIDENTIAL PARKING GARAGE

CO-WORKING OFFICES

62 FOREST AVE. APARTMENT ENTRY

6' FLUSH RADIUS (2 GRAY 2'-3' RADIUS TACTILE PANELS). INCLUDE 6" TIP-DOWN EACH SIDE

CUMBERLAND AVENUE

FOREST AVENUE

