

ALPHAarchitects  
 17 CHESTNUT STREET  
 PORTLAND, ME 04101  
 PHONE: 207.761.9500  
 FAX: 207.761.9595  
 design@alphaarchitects.com

COPYRIGHT

Reuse or reproduction of the contents of this document is not permitted without written permission of ALPHA ARCHITECTS



**Station 415**  
 415 Cumberland Avenue  
 Portland, ME. 04101

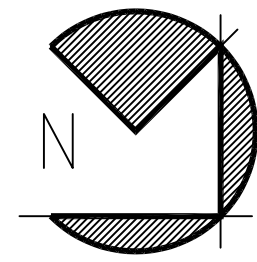

(3) INTERCONNECTED THRU FIRE SHUTTERS BY ALPINE OR EQ.

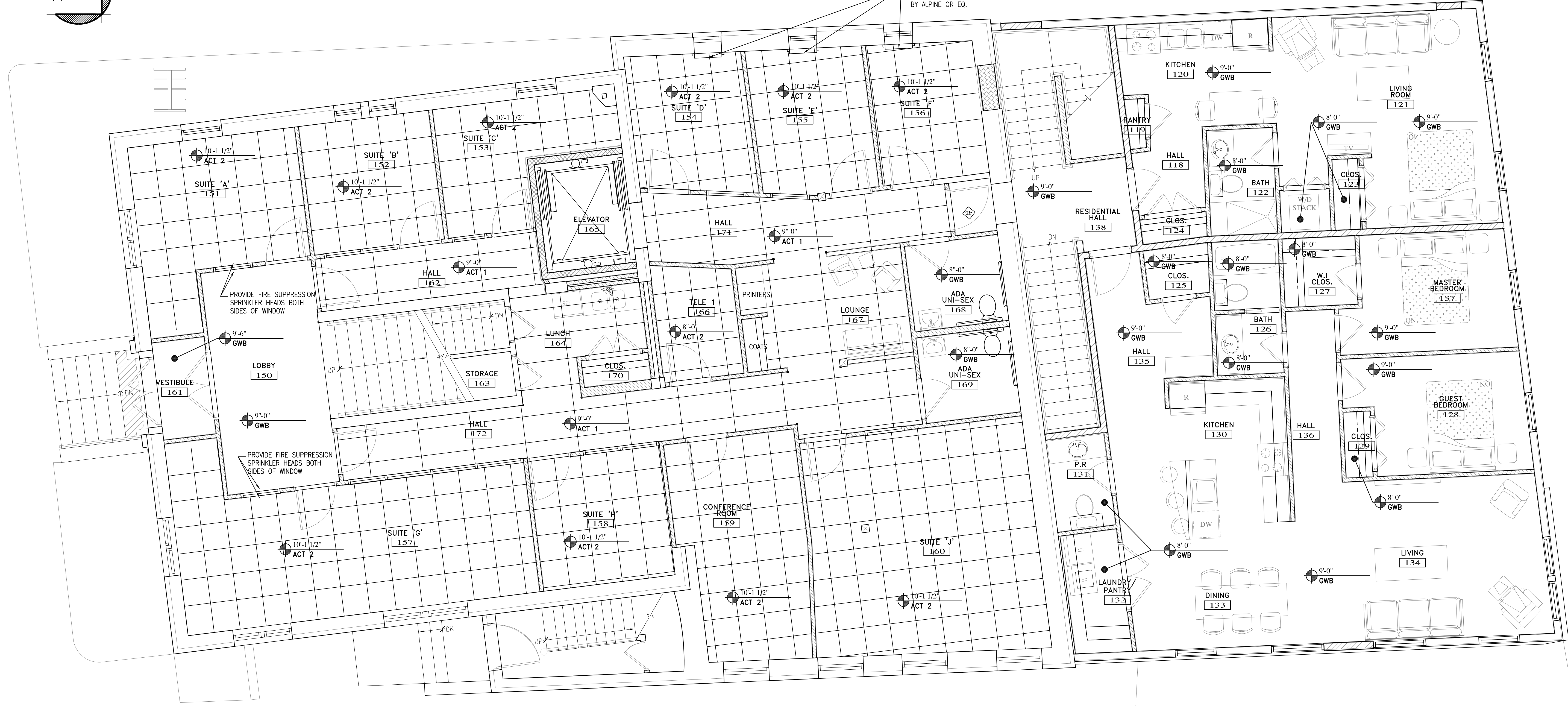

FIRST FLOOR REFLECTED CEILING PLAN  
 SCALE: 1/4" = 1'-0"

**GENERAL NOTE:**  
 REFER TO ELECTRICAL DRAWINGS FOR ALL LIGHTING LOCATIONS AND TYPES.  
 REFER TO MECHANICAL DRAWINGS FOR ALL VENT & DUCT LOCATIONS

**LEGEND:**  
 ACT 1 2x4 'ARMSTRONG' SECOND LOOK II (TEGULAR)  
 ACT 2 2x2 'ARMSTRONG' CORTEGA SECOND LOOK (TEGULAR)

JOB: 16110

ISSUE DATE	
PERMIT	10-04-16
SFMO	09-29-16
CD's	-
REV. 4	11-17-16
REV. 5	01-09-17
PRINT	11-17-16

FIRST FLOOR REFLECTED CEILING PLAN

**A1.7**

01-09-17