

ALPHAarchitects  
 17 CHESTNUT STREET  
 PORTLAND, ME 04101  
 PHONE: 207.761.9500  
 FAX: 207.761.9595  
 design@alphaarchitects.com

**© COPYRIGHT**  
 Reuse or reproduction of the contents of this document is not permitted without written permission of ALPHA ARCHITECTS



**Station 415**  
 415 Cumberland Avenue  
 Portland, ME. 04101

JOB: 16110

ISSUE DATE	
PERMIT	10-04-16
SFMO	09-29-16
CD's	-
REV. 4	11-17-16
REV. 5	01-09-17
PRINT	11-17-16

LOWER LEVEL FLOOR PLAN  
**A1.1**

01-09-17

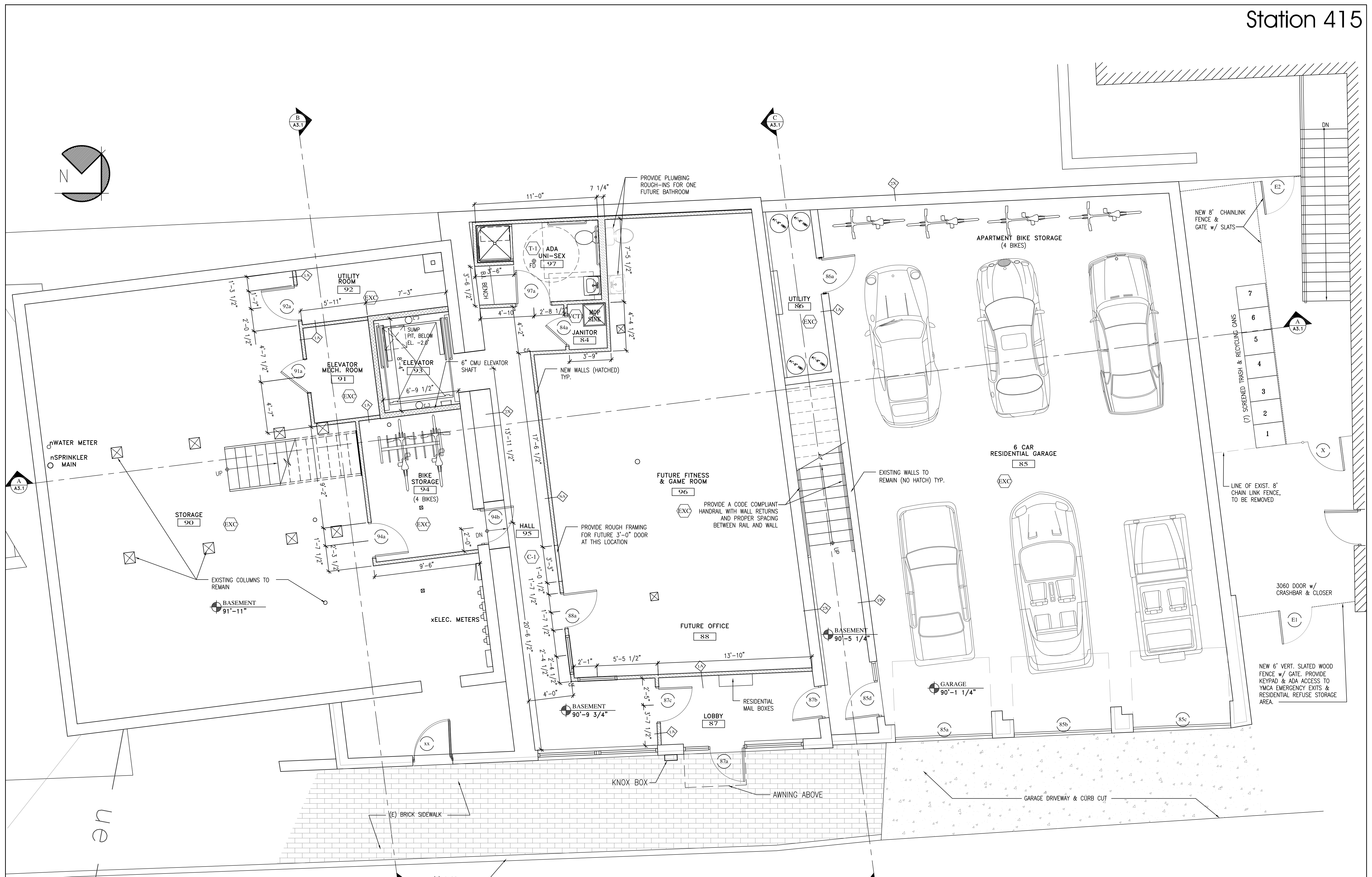

LOWER LEVEL PLAN  
 SCALE: 1/4" = 1'-0"  
 4836sf Gross Area

GENERAL NOTE:  
 ALL WALLS ARE 'NA' UNLESS OTHERWISE NOTED.  
 C.G.: INDICATES CORNER GUARD

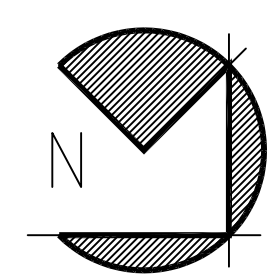

B  
A3.1

C  
A3.1

A  
A3.1

A  
A3.1

B  
A3.1

C  
A3.1

FOREST AVENUE

en