



ALPHAarchitects
17 CHESTNUT STREET
PORTLAND, ME 04101
PHONE: 207.761.9500
FAX: 207.761.9595
design@alphaarchitects.com

COPYRIGHT

Reuse or reproduction of the contents of this document is not permitted without written permission of ALPHA ARCHITECTS

FOR PERMIT

Station 415
415 Cumberland Avenue
Portland, ME. 04101

JOB: 16110

ISSUE DATE	
PRELIM	01-17-16
SFMO	-
CD's	-
REV. 1	-
REV. 2	-
PRINT	-

SECOND FLOOR FRAMING PLAN

S1.3

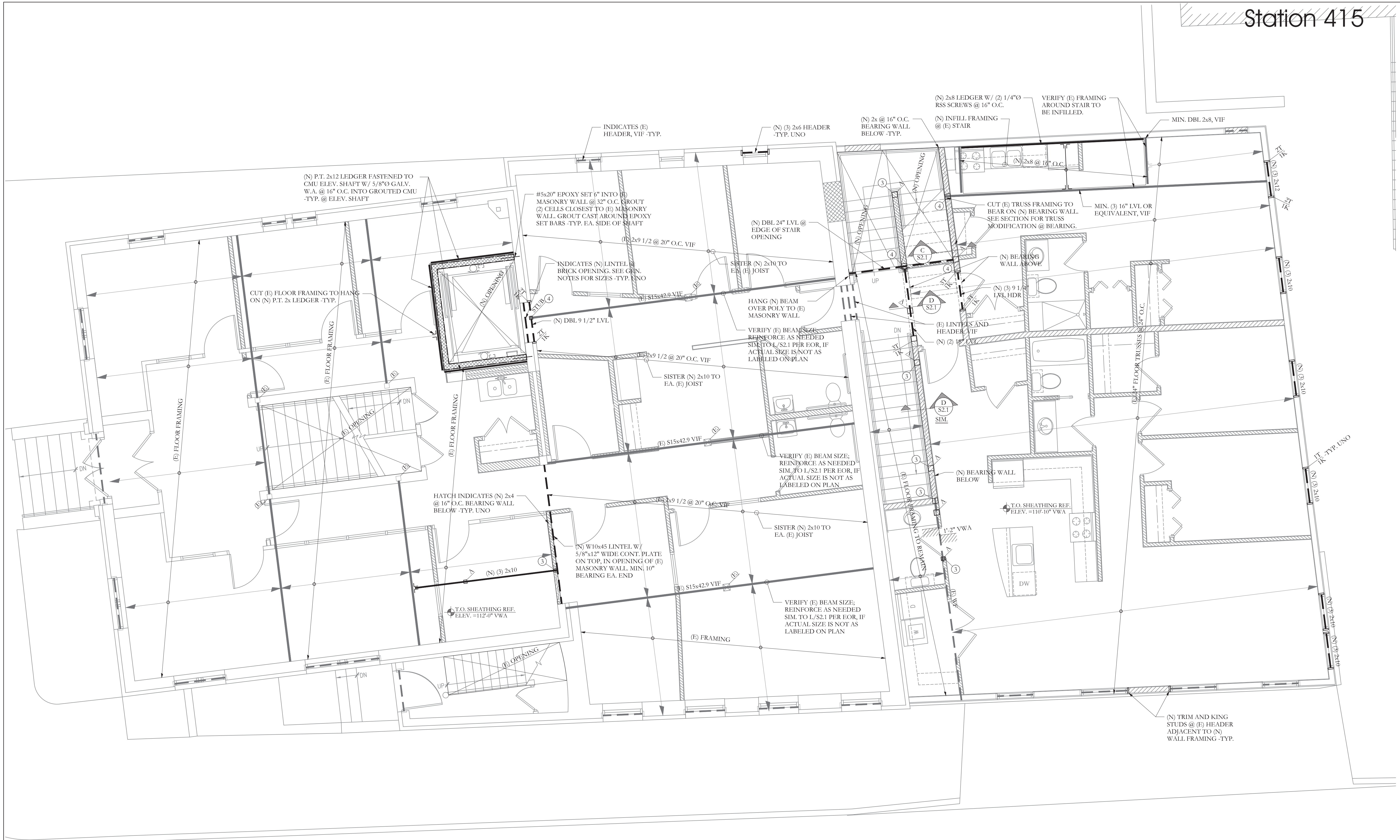

FOREST AVENUE

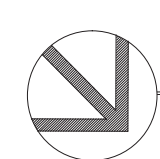

SECOND FLOOR FRAMING PLAN

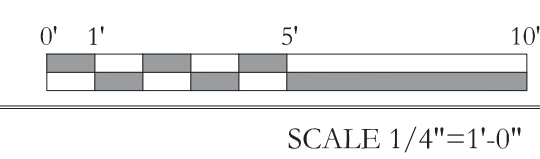

NOTES:

- SEE SHEET S1.0 FOR GENERAL STRUCTURAL NOTES
- FLOOR SHEATHING SHALL BE 3/4" T&G SHEATHING. SEE GEN NOTES FOR MORE INFO.
- ALL WOOD COLUMNS IN 2x6 WALLS SHALL BE (3) 2x6 AND IN 2x4 WALLS SHALL BE (3) 2x4 UNO
- ALL HEADERS ARE DROPPED UNO
- ALL HEADERS ARE (3) 2x6 UNO
- ALL BEAMS ARE FLUSH UNO.

FRAMING PLAN SYMBOLS KEY	
□	WOOD POST
○	STEEL COLUMN
○	NUMBER OF WOOD STUDS IN POST BELOW
A	COLUMN ABOVE THIS LEVEL
C	COLUMN CONTINUOUS THROUGH THIS LEVEL
—	JOIST BEARING
—	CONTINUOUS JOIST WITH INTERMEDIATE BEARING
—	FLUSH FRAMED JOIST BEARING WITH HANGER
—	WOOD STUD BEARING WALL BELOW
—	SHEAR WALL
—	NUMBER OF TRIM STUDS UNDER HEADER
—	NUMBER OF KING STUDS ADJACENT TO HEADER

LEGEND	
—	DROPPED BEAM
—	FLUSH BEAM

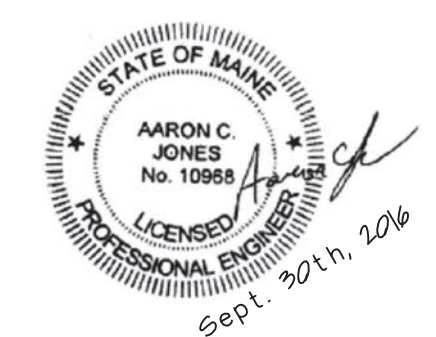

Structural Integrity
Consulting Engineers, Inc.

77 Oak Street
Portland, ME, 04101
p. 207-774-4614
f. 866-793-7835
www.structuralintegrity.com

SI # 16-0036

BUILD WITH CONFIDENCE
© 2016 Structural Integrity Consulting Engineers, Inc.

09-30-16