



ALPHAarchitects
 17 CHESTNUT STREET
 PORTLAND, ME 04101
 PHONE: 207.761.9500
 FAX: 207.761.9595
 design@alphaarchitects.com

© COPYRIGHT
 Reuse or reproduction of the contents of this document is not permitted without written permission of ALPHA ARCHITECTS

FOR PERMIT

Station 415
 415 Cumberland Avenue
 Portland, ME. 04101

JOB: 16110

ISSUE DATE	
PRELIM	01-17-16
SFMO	-
CD's	-
REV. 1	-
REV. 2	-
PRINT	-

FIRST FLOOR FRAMING PLAN
S1.2

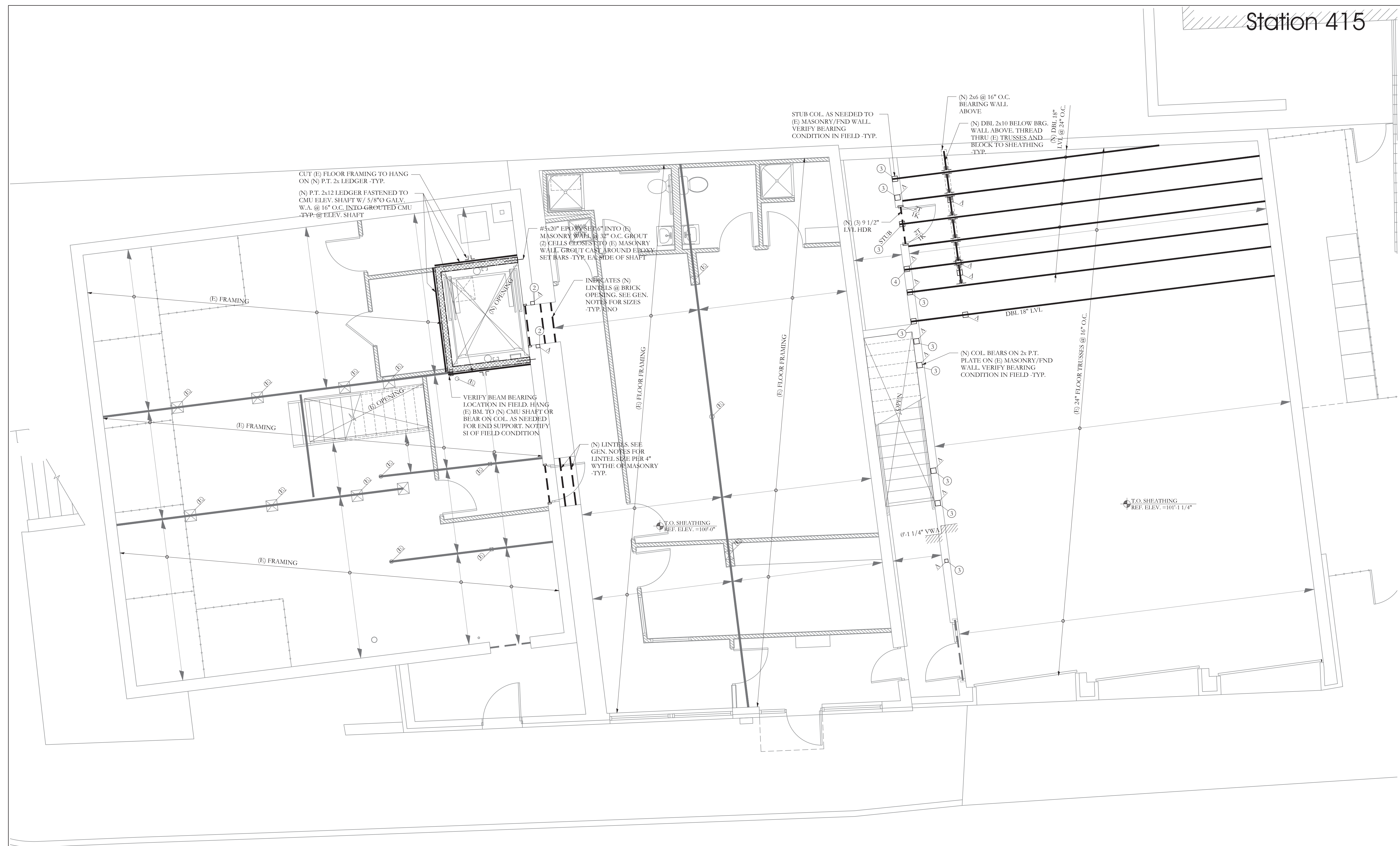

FIRST FLOOR FRAMING PLAN

NOTES:
 1. SEE SHEET S1.0 FOR GENERAL STRUCTURAL NOTES
 2. FLOOR SHEATHING SHALL BE 3/4" T&G SHEATHING. SEE GEN NOTES FOR MORE INFO.
 3. ALL WOOD COLUMNS IN 2x6 WALLS SHALL BE (3) 2x6 AND IN 2x4 WALLS SHALL BE (3) 2x4 UNO
 4. ALL HEADERS ARE DROPPED UNO
 5. ALL HEADERS ARE (3) 2x6 UNO
 6. ALL BEAMS ARE FLUSH UNO

SCALE 1/4"=1'-0"

FOREST AVENUE

FRAMING PLAN SYMBOLS KEY

□	WOOD POST
○	STEEL COLUMN
⊗	NUMBER OF WOOD STUDS IN POST BELOW
A	COLUMN ABOVE THIS LEVEL
C	COLUMN CONTINUOUS THROUGH THIS LEVEL
↗	JOIST BEARING
↔	CONTINUOUS JOIST WITH INTERMEDIATE BEARING
—	FLUSH FRAMED JOIST BEARING WITH HANGER
—	WOOD STUD BEARING WALL BELOW
—	SHEAR WALL
3x4	NUMBER OF TRIM STUDS UNDER HEADER
3x4	NUMBER OF KING STUDS ADJACENT TO HEADER

LEGEND

—	DROPPED BEAM
—	FLUSH BEAM

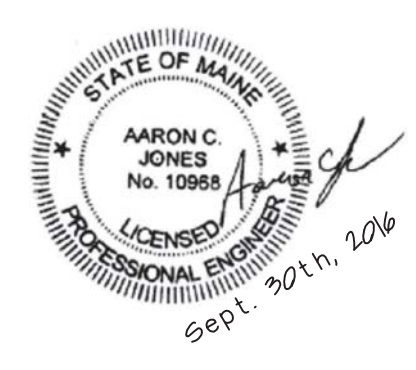

Structural Integrity
 Consulting Engineers, Inc.
 77 Oak Street
 Portland, ME, 04101
 p. 207-774-4614
 f. 866-793-7835
 www.structuralintg.com
 SI # 16-0036

09-30-16