

Station 415



ALPHAarchitects
 17 CHESTNUT STREET
 PORTLAND, ME 04101
 PHONE: 207.761.9500
 FAX: 207.761.9595
 design@alphaarchitects.com

© COPYRIGHT
 Reuse or reproduction of the contents of
 this document is not permitted without
 written permission of ALPHA ARCHITECTS

FOR PERMIT

Station 415
 415 Cumberland Avenue
 Portland, ME. 04101

JOB: 16110

ISSUE DATE	
PRELIM	01-17-16
SFMO	-
CD's	-
REV. 1	-
REV. 2	-
PRINT	-

FOUNDATION PLAN
S1.1

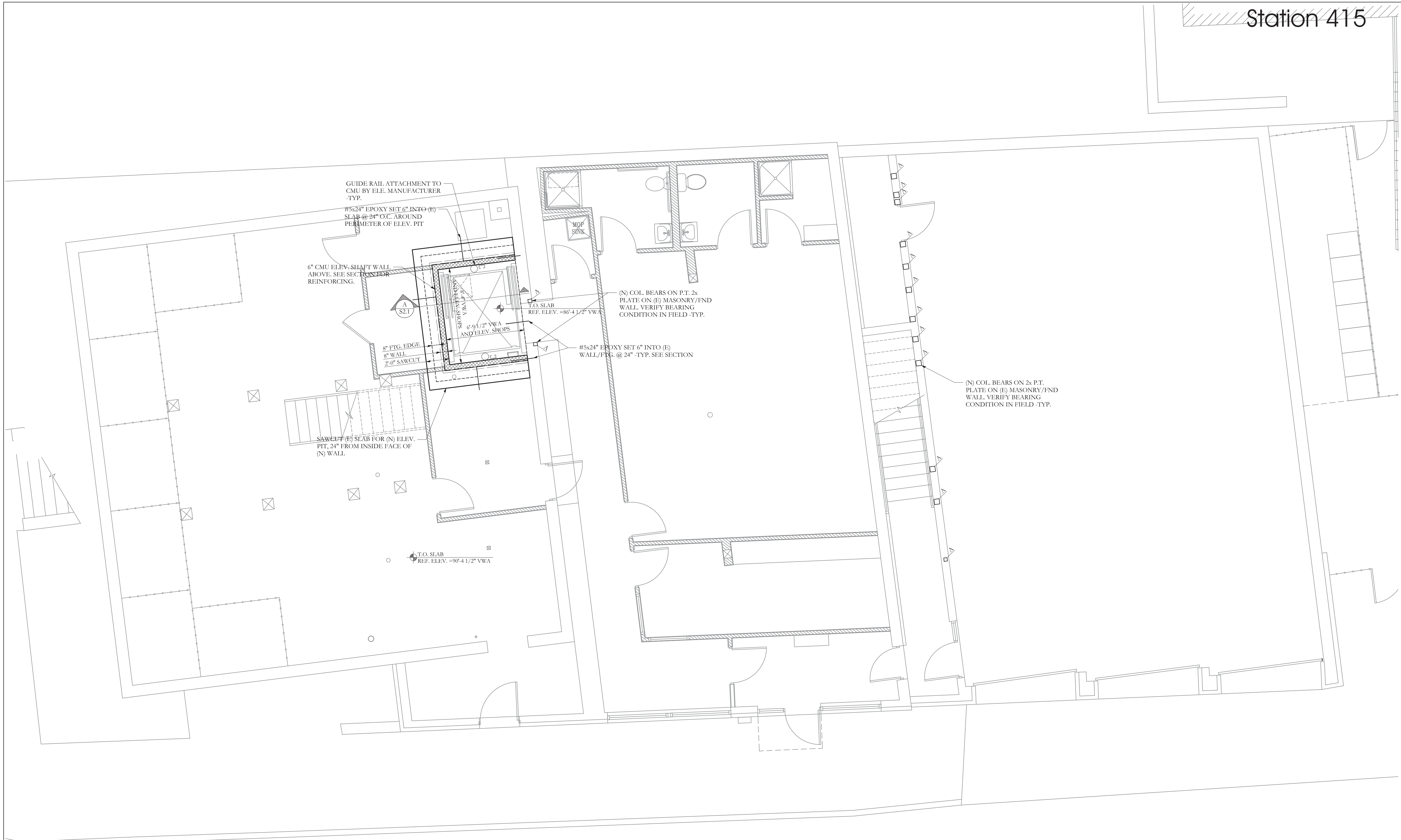

FOREST AVENUE

FOUNDATION/BASEMENT PLAN
 SCALE 1/4"=1'-0"

- NOTES:
1. ALL FOOTINGS ARE 12" DEEP -TYP.
 2. STEP IN TOP OF FOUNDATION WALL IS INDICATED THUS: AND SHOWS LOWER SIDE OF WALL.
 3. SEE S1.0 FOR STRUCTURAL GENERAL NOTES
 4. BOTTOM OF FOOTING TO BEAR 4'-6" BELOW GRADE, MIN. AND IS INDICATED THUS: (XX'-XX")
 5. STEP IN TOP OF FOOTING IS INDICATED THUS: , AND SHOWS LOWER FOOTING.
 6. TOP OF WALL ELEV. NOTED IN SECTION



Structural Integrity
 Consulting Engineers, Inc.
 77 Oak Street
 Portland, ME, 04101
 p. 207-774-4614
 f. 866-793-7835
 www.structuralintg.com

SI # 16-0036

09-30-16

BUILD WITH CONFIDENCE
 © 2016 Structural Integrity Consulting Engineers, Inc.