

- PLUMBING NOTES**
1. REFER TO PLUMBING FIXTURES SCHEDULE FOR INDIVIDUAL FIXTURE PIPE SIZES.
  2. ALL PIPING SHALL BE ROUTED IN FLOOR TRUSS SPACE WHEREVER POSSIBLE.
  3. PROVIDE 3/4" CW, 1/2" HW & 1/2" RHU FOR EACH APT W/ APT SHUTOFFS AND SIZE 'A' WATER HAMMER ARRESTORS AT WATER HEATER.
  4. NATURAL GAS PIPING SYSTEM BASED ON A 4INUC SERVICE PRESSURE.
  5. UNO. CW/HW PIPING SHALL BE 1/2".
  6. APT 'A' & APT 'B' CW/HW PIPING FROM BELOW.

**FIRST FLOOR DOMESTIC PLAN**  
SCALE - 1/8"=1'-0"

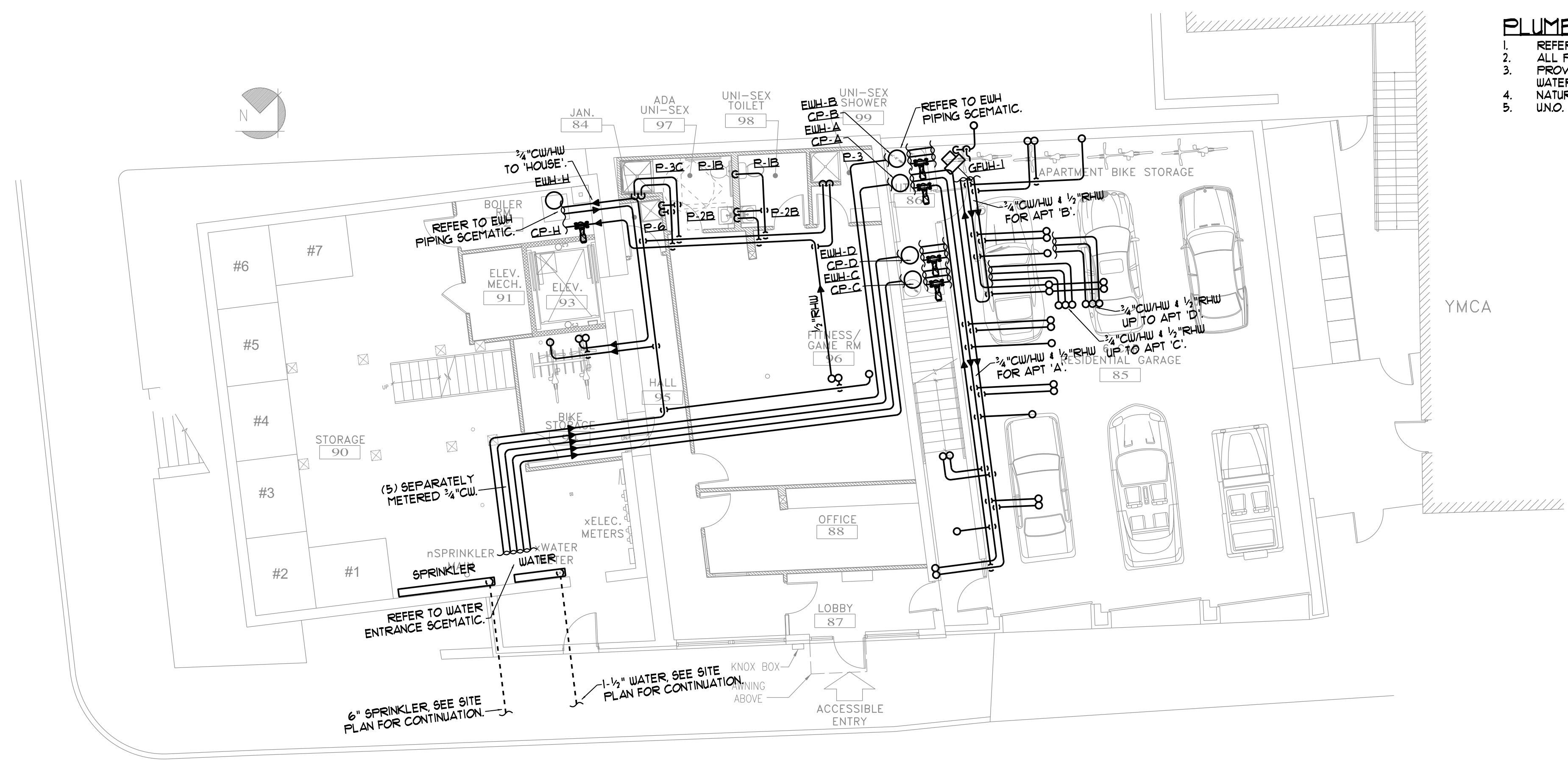

- PLUMBING NOTES**
1. REFER TO PLUMBING FIXTURES SCHEDULE FOR INDIVIDUAL FIXTURE PIPE SIZES.
  2. ALL PIPING SHALL BE ROUTED IN FLOOR TRUSS SPACE WHEREVER POSSIBLE.
  3. PROVIDE 3/4" CW, 1/2" HW & 1/2" RHU FOR EACH APT W/ APT SHUTOFFS AND SIZE 'A' WATER HAMMER ARRESTORS AT WATER HEATER.
  4. NATURAL GAS PIPING SYSTEM BASED ON A 4INUC SERVICE PRESSURE.
  5. UNO. CW/HW PIPING SHALL BE 1/2".

**LOWER LEVEL DOMESTIC PLAN**  
SCALE - 1/8"=1'-0"

FOR PERMIT 09-30-16

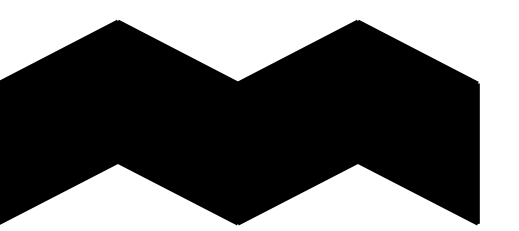

ALPHAarchitects  
17 CHESTNUT STREET  
PORTLAND, ME 04101  
PHONE: 207.761.9500  
FAX: 207.761.9595  
design@alphaarchitects.com

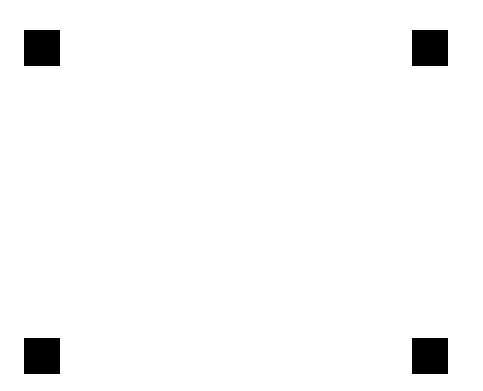
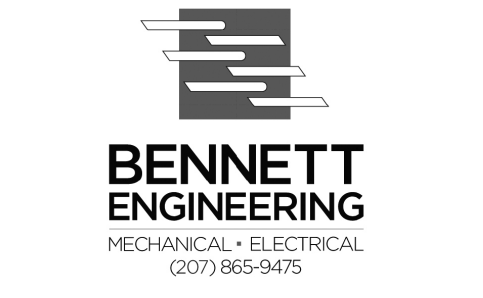

**Station 415**  
415 Cumberland Avenue  
Portland, ME. 04101

JOB: 16110

ISSUE DATE	
PRELIM	01-17-16
SFMO	-
CD's	-
REV. 1	-
REV. 2	-
PRINT	09-30-16

LOWER LEVEL & FIRST FLOOR DOMESTIC PLANS

**M3.0**