

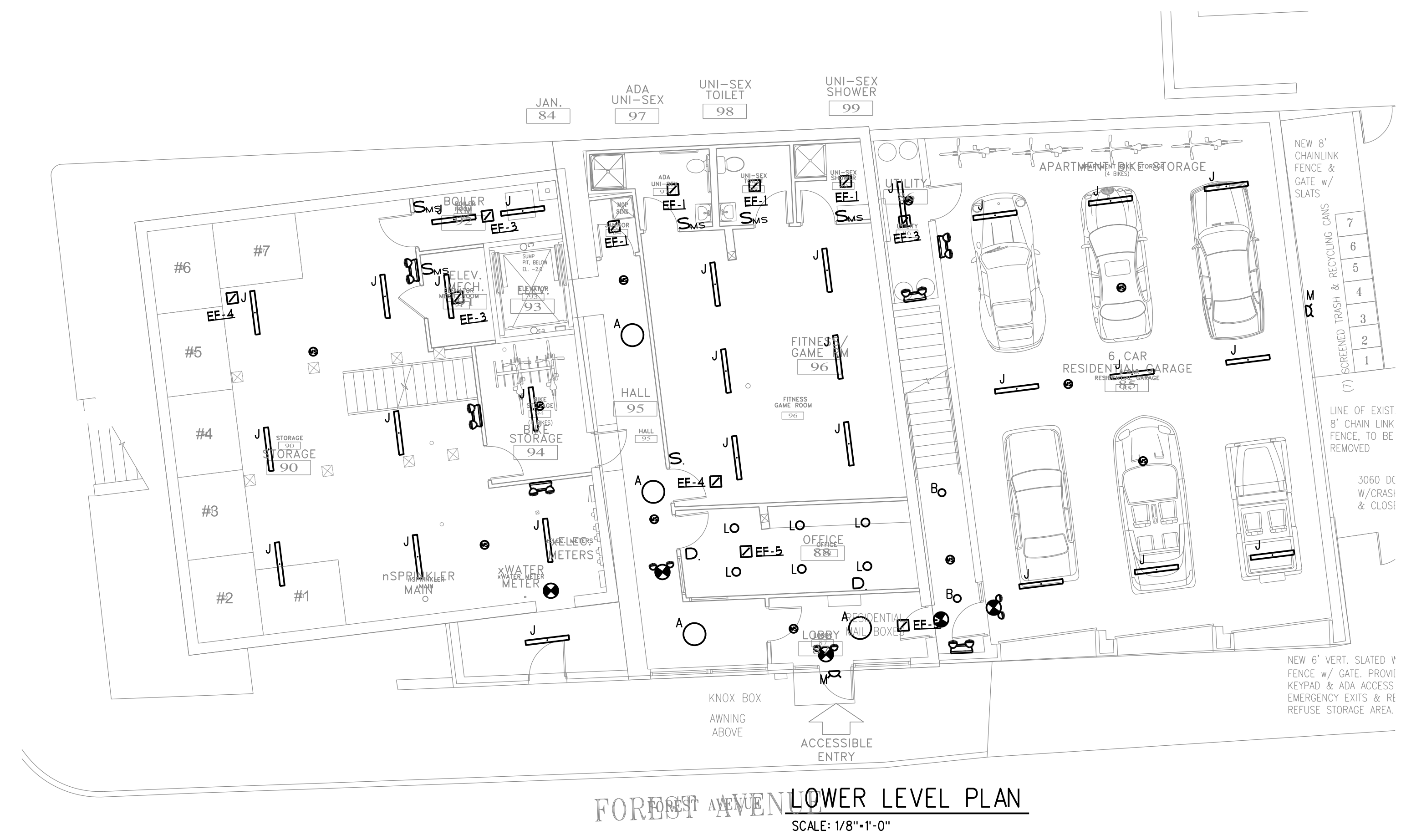

FOREST AVENUE FIRST FLOOR PLAN
SCALE: 1/8"=1'-0"



FOREST AVENUE LOWER LEVEL PLAN
SCALE: 1/8"=1'-0"

FOR PERMIT 09-30-16

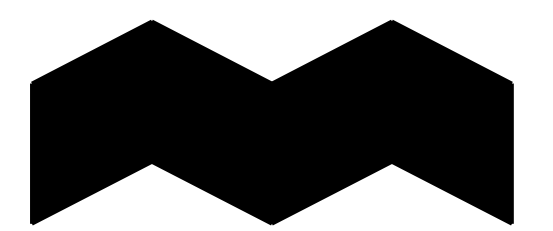

ALPHAarchitects
17 CHESTNUT STREET
PORTLAND, ME 04101
PHONE: 207.761.9500
FAX: 207.761.9595
design@alphaarchitects.com

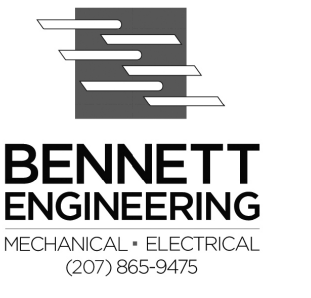

**BENNETT
ENGINEERING**
MECHANICAL • ELECTRICAL
(207) 866-9475

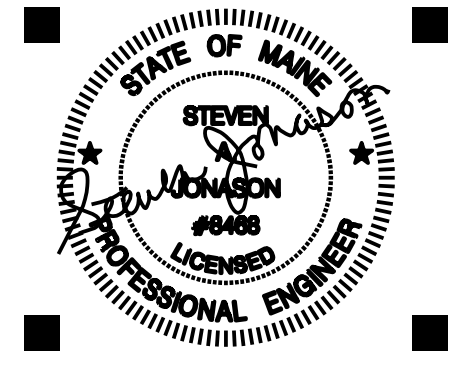

Station 415
415 Cumberland Avenue
Portland, ME. 04101

JOB: 16110

ISSUE DATE	
PRELIM	01-17-16
SFMO	-
CD's	-
REV. 1	-
REV. 2	-
PRINT	09-30-16

LOWER LEVEL & FIRST
FLR LIGHTING PLAN

E2.0