

PLAN VIEW
NTS

DRAWN BY:
D. JOHNSON
7/22/13

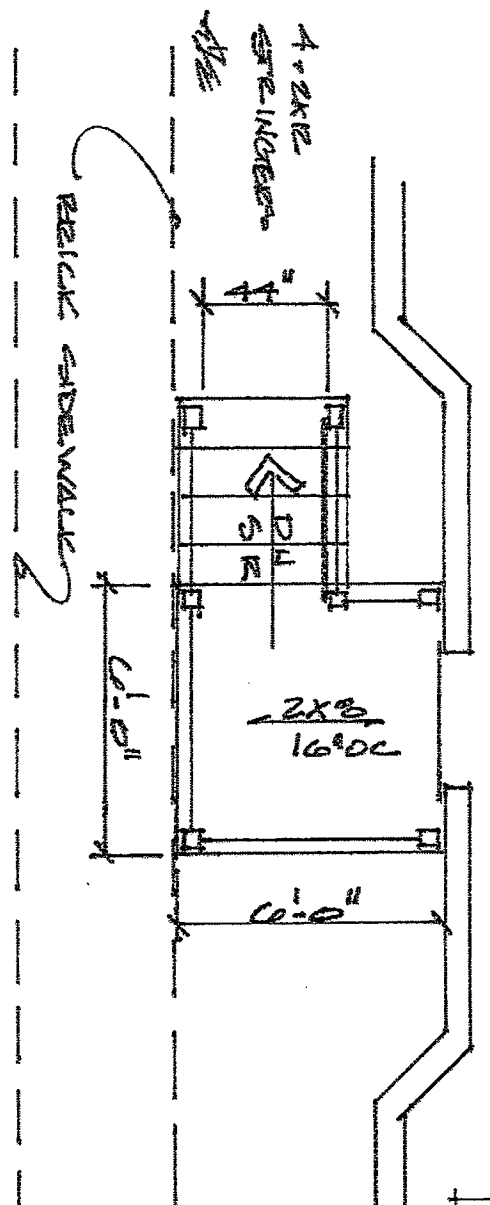

- STAIRS - 4x2x12 STEEL STRINGERS
- 7" RISE, 11" RUN
- HANDRAIL @ 34"
- GUARDS - 4x2" APRON
- 4" SPACING OF BALUSTERS

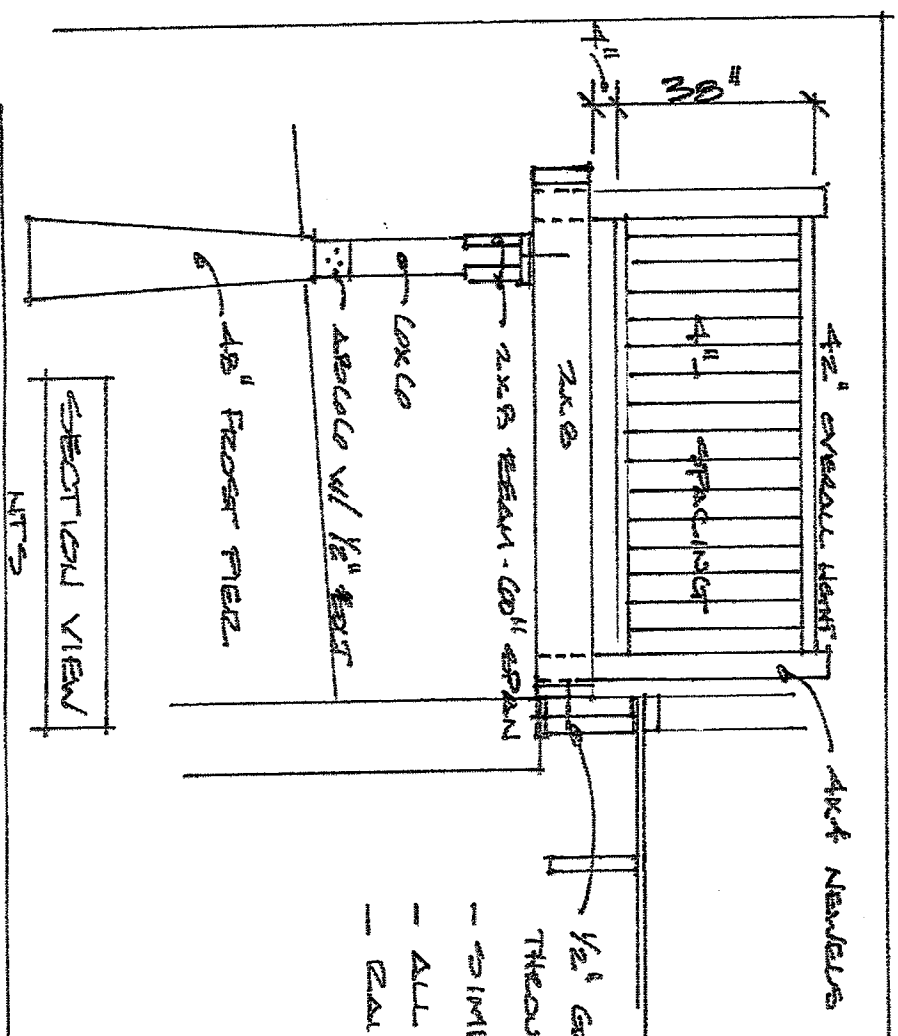

- 1/2" GALV. LAGS @ 24" OC, STAGGERED 2 ROWS THROUGH 2X8 LEDGER.
- SIMPSON HANGERS JOIST TO LEDGER
- ALL CONSTRUCTION LUMBER FRT
- ZALLING MATERIAL KD

FRONT STAIR REPLACEMENTS FOR
252 AND 230 HIGH STREET
PORTLAND, ME
OWNER: PWP ON HIGH LLC

SECTIONAL VIEW
NTS