

A-2 250-252 High St.

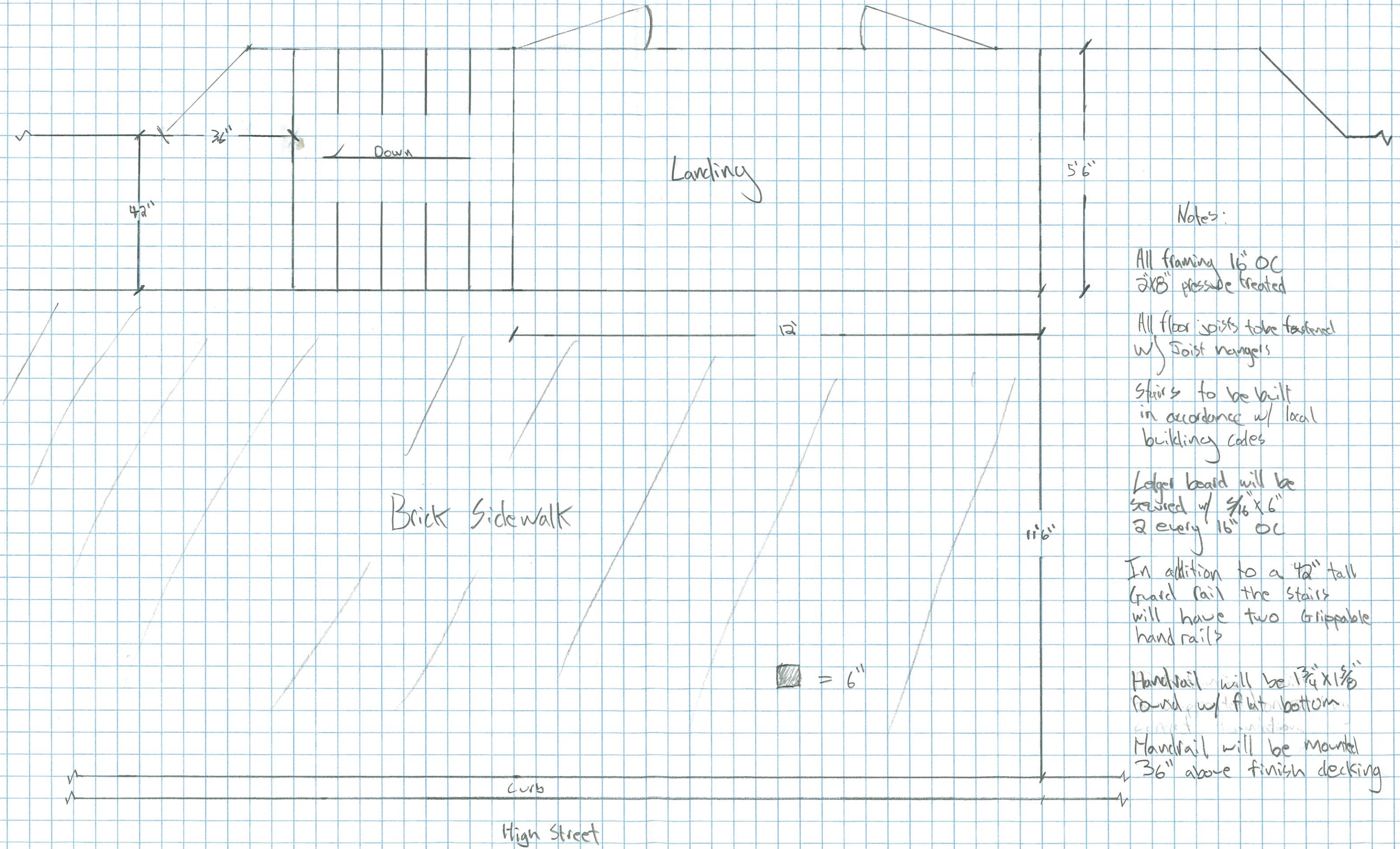

Notes:

All framing 16" OC  
2x8" pressure treated

All floor joists to be fastened  
w/ Joist hangers

Stairs to be built  
in accordance w/ local  
building codes

Ledge board will be  
secured w/  $\frac{3}{16}$ " x 6"  
2 every 16" OC

In addition to a 42" tall  
guard rail the stairs  
will have two grippable  
hand rails

Handrail will be  $1\frac{3}{4}$ " x  $1\frac{5}{8}$ "  
Round w/ flat bottom

Handrail will be mounted  
36" above finish decking