

A-2 250-252 High St.

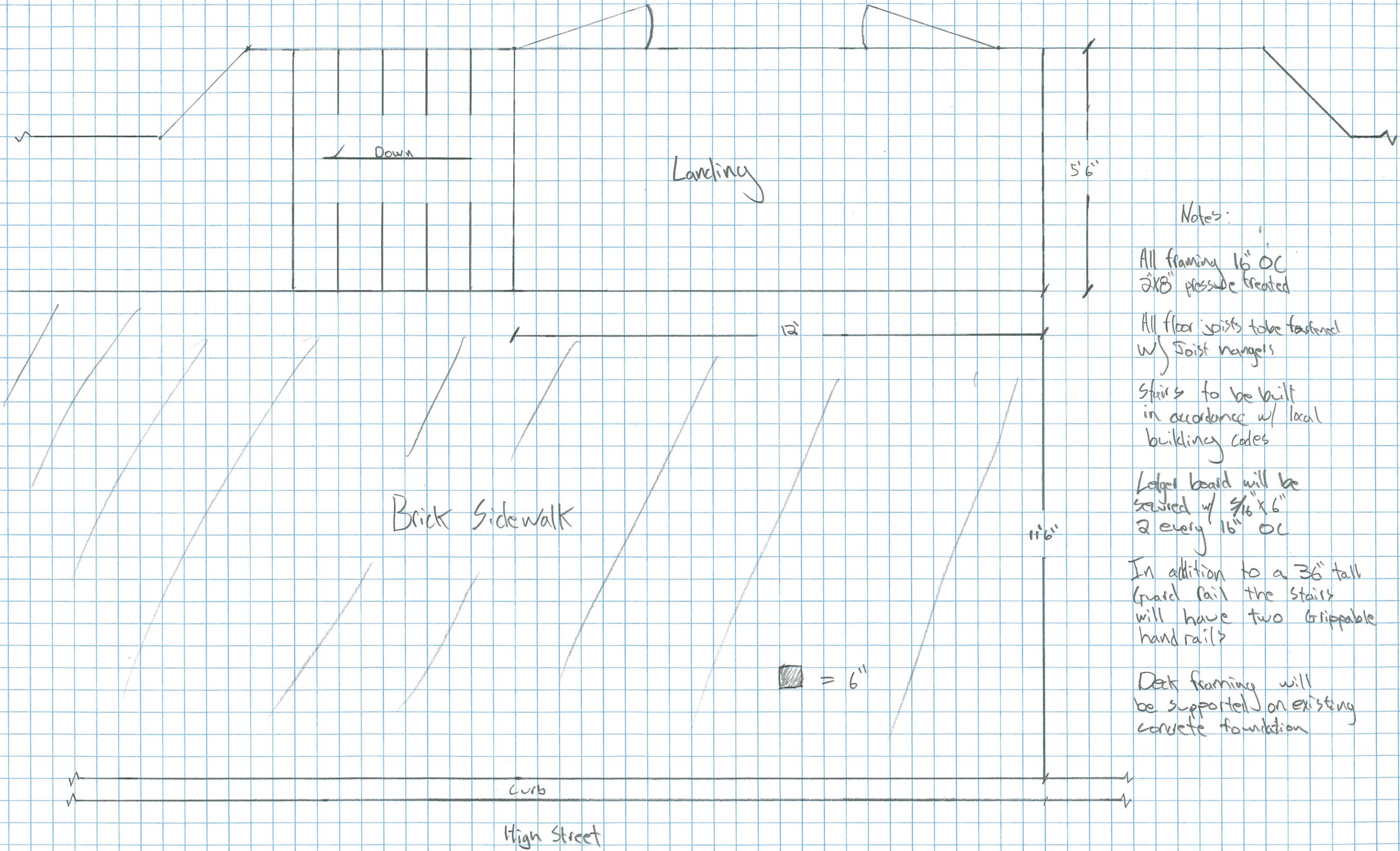

Notes:

All framing 16" OC  
2x8" pressure treated

All floor joists to be fastened  
w/ Joist hangers

Stairs to be built  
in accordance w/ local  
building codes

Ledge board will be  
sawed w/ 3/16" x 6"  
2 every 16" OC

In addition to a 36" tall  
guard rail the stairs  
will have two grippable  
hand rails

Deck framing will  
be supported on existing  
concrete foundation