

GENERAL NOTES:

- EXISTING CONDITIONS BASE MAP WAS COMPILED USING THE FOLLOWING DATA:
 - PLANIMETRIC AND TOPOGRAPHIC DATA PROVIDED BY THE CITY OF PORTLAND DPW ENGINEERING OFFICE COMPILED USING 2000 AERIAL IMAGES BY BRADSTREET CONSULTANTS OF MANCHESTER, MAINE.
 - POND RETAINING WALL REPLACEMENT PLANS BY EPDA DATED 1980 (APPROX.).
 - FOUNTAIN REPLACEMENT AT DEERING OAKS PARK RECORD DRAWINGS PREPARED BY RBCC DATED 12/18/2006.
 - MELLEN STREET RECORD DRAWINGS PREPARED BY WOODARD & CURRAN DATED 4/2014.
- VERTICAL DATUM IS REFERENCED TO NGVD29. HORIZONTAL DATUM IS REFERENCED TO STATE PLANE NAD 1983 (FEET), MAINE WEST ZONE.
- PUSH PROBES COLLECTED BY HALEY & ALDRICH IN SPRING 2013, REFER TO CONTRACT SPECIFICATIONS.
- THE UTILITY LOCATIONS SHOWN IN PLAN AND PROFILE ARE APPROXIMATE AND REQUIRE FIELD VERIFICATION BY THE CONTRACTOR. CONTACT THE CITY IMMEDIATELY UPON DISCOVERING ANY CONFLICTS WITH EXISTING AND PROPOSED UTILITY LOCATIONS. NOT ALL EXISTING UTILITIES ARE SHOWN ON PLANS.
- CONTRACTOR SHALL COORDINATE CONSTRUCTION ACTIVITY WITH UTILITY COMPANIES, EMERGENCY SERVICES AND CITY. CONTACTS ARE LISTED IN SPECIFICATIONS. NOTIFY UTILITY COMPANIES WITHIN 48 HOURS OF WORK ACTIVITY ADJACENT TO THOSE UTILITIES.
- CONTRACTOR SHALL NOTIFY ALL UTILITIES PRIOR TO COMMENCING WORK, ALLOWING SUFFICIENT TIME TO LOCATE AND MARK THE LOCATION OF BURIED UTILITIES. CONTRACTOR SHALL CONTACT "DIG SAFE", TELEPHONE 888-344-7233, PRIOR TO EXCAVATION.
- RESTORE ALL AREAS DISTURBED BY CONTRACTOR'S OPERATIONS TO ORIGINAL FINISH (GRAVEL, PAVEMENT, GRASS, ETC.). RESTORATION OF PAVED SURFACES, GRAVEL SURFACES, DRIVEWAYS, AND LAWNS DAMAGED BY CONSTRUCTION ACTIVITIES OUTSIDE OF LIMITS OF WORK INDICATED ON THE PLANS SHALL BE PERFORMED AT NO ADDITIONAL COST TO OWNER. ANY CURB OR SIDEWALK DAMAGED BY CONSTRUCTION ACTIVITIES SHALL BE REPLACED IN KIND AND SHALL CONFORM TO CITY OF PORTLAND AND MAINE DOT SPECIFICATIONS AT NO ADDITIONAL COST TO OWNER.
- PROPERLY PROTECT AND DO NOT DISTURB PROPERTY IRONS AND MONUMENTS. IF DISTURBED, THE PROPERTY MONUMENT SHALL BE RESET AT THE CONTRACTOR'S EXPENSE BY A LICENSED LAND SURVEYOR ACCEPTABLE TO THE CITY.
- EXISTING FACILITIES SHALL BE REMOVED AND PROTECTED DURING CONSTRUCTION AS REQUIRED TO COMPLETE THE WORK. CITY RETAINS RIGHT TO KEEP ANY AND ALL REMOVED FACILITIES. CONTRACTOR SHALL DISPOSE OF ANY REMOVED FACILITY AT THE REQUEST OF CITY AT CONTRACTOR'S EXPENSE.
- ALL TREES IN THE VICINITY OF THE CONSTRUCTION ACCESS SHALL BE PROTECTED BY CONTRACTOR DURING CONSTRUCTION.
- ALL WORK SHALL BE PERFORMED IN ACCORDANCE WITH THE REQUIREMENTS OF THE CITY TRAFFIC ENGINEER. THE CONTRACTOR SHALL SUBMIT A PROPOSED TRAFFIC CONTROL PLAN TO THE TRAFFIC ENGINEER AT LEAST 7 DAYS BEFORE BEGINNING CONSTRUCTION. THE PROPOSED TRAFFIC CONTROL PLAN SHALL BE SUBJECT TO APPROVAL BY THE TRAFFIC ENGINEER WHO MAY ATTACH SPECIAL CONDITIONS TO, OR REQUIRE MODIFICATIONS OF, THE TRAFFIC CONTROL PLAN. WORK SHALL NOT BEGIN UNTIL THE PLAN IS APPROVED BY THE TRAFFIC ENGINEER.
- DO NOT PARK, IMPEDE ACCESS TO, OR STORE EQUIPMENT ON ADJACENT CITY OR PRIVATELY OWNED LOTS, UNLESS PERMISSION HAS BEEN GRANTED IN WRITING BY CITY AND/OR LAND OWNER.
- RESTRICT ACCESS TO SITE THROUGH THE USE OF APPROPRIATE SIGNAGE, BARRIERS, FENCES, ETC. SITE SHALL BE LEFT WITH APPROPRIATE SAFETY MEASURES IN PLACE DURING NON-WORKING HOURS. NO TRENCH SHALL BE LEFT OPEN DURING NON-WORKING HOURS. SITE SAFETY IS THE RESPONSIBILITY OF CONTRACTOR, DURING BOTH WORKING AND NON-WORKING HOURS.
- CONTRACTOR IS RESPONSIBLE FOR OBTAINING ALL NECESSARY CONSTRUCTION PERMITS. PERMIT APPLICATIONS SHALL BE SUBMITTED WITH ADEQUATE TIME SO AS NOT TO DELAY CONSTRUCTION.

- ALL WORK ASSOCIATED WITH THE PROJECT SHALL BE COMPLETED IN ACCORDANCE WITH ARTICLES V, VII, AND IX OF CHAPTER 25-STREETS, SIDEWALKS, AND OTHER PUBLIC PLACES OF THE CITY OF PORTLAND CODE OF ORDINANCES.
- THE CITY OF PORTLAND ENGINEERING DIVISION REQUIRES THAT UPON COMPLETION OF CONSTRUCTION, A COMPLETE SET OF "RECORD" DRAWINGS THAT REFLECT ANY AND ALL MODIFICATIONS TO THE DESIGN BE SUBMITTED TO THE DIVISION. THESE DRAWINGS SHALL BE SUBMITTED IN BOTH DIGITAL AND HARD COPY FORMAT AS DEFINED IN THE SPECIFICATIONS PRIOR TO PAYMENT OF FINAL RETAINAGE.
- WORK IS PROPOSED IN CLOSE PROXIMITY TO EXISTING UTILITIES. PROTECTION OF EXISTING UTILITIES DURING CONSTRUCTION SHALL BE INCIDENTAL TO THE PAY ITEM UNDER WHICH WORK TO INSTALL SAID UTILITY IS PERFORMED.
- PROVIDE 6-INCHES OF LOAM AND MDOT SEEDING METHOD #1 IN ALL LAWN AREAS DISTURBED BY CONTRACTOR'S OPERATIONS.
- IF CONTRACTOR PROPOSES TO TEMPORARILY STOCKPILE ANY SURPLUS SOIL AND ROCK IN THE CITY OF PORTLAND, THE CONTRACTOR SHALL OBTAIN APPROVAL FOR EACH STOCKPILE LOCATION FROM THE ENGINEER. IF CONTRACTOR PROPOSES TO PERMANENTLY STOCKPILE ANY SURPLUS SOIL AND ROCK ON PROPERTY IN THE CITY OF PORTLAND, THE CONTRACTOR MUST OBTAIN ANY SITE PLAN PERMITS REQUIRED FROM THE CITY PLANNING AUTHORITY OR ANY FILL PERMITS REQUIRED FROM MDEP OR U.S. ARMY CORPS OF ENGINEERS. BOTH TEMPORARY AND PERMANENT STOCKPILE LOCATIONS SHALL MEET THE APPLICABLE SETBACK REQUIREMENTS IN THE CITY LAND USE CODE AND SHALL RECEIVE PROPER STABILIZATION AND EROSION & SEDIMENT CONTROL MEASURES IN ACCORDANCE WITH APPROVED SOIL EROSION & WATER POLLUTION CONTROL PLAN.
- CONTRACTOR SHALL BE RESPONSIBLE FOR KEEPING PARK AVENUE FREE OF SEDIMENT. A STABILIZED CONSTRUCTION EXIT SHALL BE CONSTRUCTED AT ALL ACCESS POINTS AND PARK AVENUE WILL BE SWEEPED ON A DAILY BASIS OR AT A MORE FREQUENT RATE AS NECESSARY AS REQUESTED BY THE CITY.

SYMBOLS

| DESCRIPTION | EXISTING | PROPOSED |
|-----------------------------|----------|----------|
| SANITARY SEWER MANHOLE | ⊙ | |
| STORM DRAIN MANHOLE | ⊙ | |
| CATCH BASIN W/ HEADSTONE | ⊙ | |
| CATCH BASIN, FIELD INLET | ⊙ | |
| UTILITY POLE W/GUY | ⊙ | |
| UTILITY POLE | ⊙ | |
| WATER GATE | ⊙ | |
| WATER VALVE | ⊙ | |
| WATER SHUT OFF | ⊙ | |
| HYDRANT | ⊙ | |
| SIGN | ⊙ | |
| TREE | ⊙ | |
| IRON PIN (FOUND) | ⊙ | |
| MONUMENTS (FOUND) | ⊙ | |
| PROBE & NUMBER | ⊙ | |
| MONITORING WELL | ⊙ | |
| BORING | ⊙ | |
| SEDIMENT SAMPLE | ⊙ | |
| SPOT GRADE | ⊙ | |
| ROADWAY BITUMINOUS PAVEMENT | | ■ |
| BLOCK MATTING | | ■ |
| TEMPORARY GRAVEL ACCESS | | ■ |

LINE TYPES

| DESCRIPTION | EXISTING | PROPOSED |
|----------------------------|-----------|----------|
| CONTOUR (1' INTERVAL) | ---122--- | --- |
| CONTOUR (INDEX) | ---120--- | --- |
| SANITARY SEWER | --- | --- |
| STORM DRAIN | --- | --- |
| UNDERDRAIN | --- | --- |
| WATER MAIN | --- | --- |
| UNDERGROUND ELECTRIC | --- | --- |
| GAS LINE | --- | --- |
| OVERHEAD ELECTRIC | --- | --- |
| PROPERTY LINE | --- | --- |
| RIGHT OF WAY | --- | --- |
| EASEMENT | --- | --- |
| EDGE OF VEGETATION | --- | --- |
| FENCE | --- | --- |
| CENTERLINE | --- | --- |
| RETAINING WALL | --- | --- |
| CURB | --- | --- |
| EDGE OF PAVEMENT | --- | --- |
| EDGE OF GRAVEL | --- | --- |
| CONTOUR (1' INTERVAL) | --- | --- |
| CONTOUR (INDEX) | --- | --- |
| CURB | --- | --- |
| EDGE OF PAVEMENT | --- | --- |
| EDGE OF GRAVEL | --- | --- |
| TEMPORARY SEDIMENT BARRIER | --- | --- |
| LIMIT OF WORK | --- | --- |

ABBREVIATIONS

| | |
|--------|------------------------------------|
| & | AND ABOVE GROUND |
| A.G. | AND ABOVE GROUND |
| BIT | BITUMINOUS |
| B/W | BETWEEN |
| CB | CATCH BASIN |
| CI | CAST IRON |
| CMP | CENTRAL MAINE POWER |
| CMP | CORRUGATED METAL PIPE |
| CONC | CONCRETE |
| DI | DUCTILE IRON |
| DIA. | DIAMETER |
| DMH | DRAIN MANHOLE |
| DTL | DETAIL |
| E | UNDERGROUND ELECTRICAL |
| EL | ELEVATION |
| E.O.P. | EDGE OF PAVEMENT |
| EXIST. | EXISTING |
| FF | FINISH FLOOR |
| FT | FOOT/FEET |
| G | GAS MAIN |
| GS | GAS SERVICE |
| GALV. | GALVANIZED |
| GRAN. | GRANITE |
| HDPE | HIGH DENSITY POLYETHYLENE |
| HYD | HYDRANT |
| INV. | INVERT |
| LF | LINEAR FEET |
| MAX. | MAXIMUM |
| MDOT | MAINE DEPARTMENT OF TRANSPORTATION |
| MIN. | MINIMUM |
| MON | MONUMENT |
| N.I.C. | NOT IN CONTRACT |
| NO. | NUMBER |
| NR | NO REFUSAL |
| N.T.S. | NOT TO SCALE |
| OE | OVERHEAD ELECTRIC |
| OH | OVERHEAD |
| ± | PLUS OR MINUS |
| LLS | LICENSED LAND SURVEYOR |
| PROP. | PROPOSED |
| PT. | POINT |
| PVC | POLYVINYL CHLORIDE |
| PWD | PORTLAND WATER DISTRICT |
| R.O.W. | RIGHT-OF-WAY |
| RCF | REINFORCED CONCRETE PIPE |
| REINF. | REINFORCED |
| REQ'D | REQUIRED |
| S | SLOPE (FT./FT.) |
| SD | STORM DRAIN |
| SMH | SEWER MANHOLE |
| SCH | SCHEDULE |
| STA. | STATION |
| TYP. | TYPICAL |
| U.P. | UTILITY POLE |
| VC | VITRIFIED CLAY |
| VIT. | VITRIFIED CLAY |
| W | WEST |
| W | WATER |
| W | WITH |
| W | WATERMAIN |
| WS | WATER SERVICE |
| WV | WATER VALVE |

41 HUTCHINS DRIVE
 PORTLAND, MAINE 04102
 800.426.4262 | www.woodardcurran.com

WOODARD & CURRAN
 COMMITMENT & INTEGRITY DRIVE RESULTS

REFERENCES:

| | |
|--------------|----------------|
| DESIGNED BY: | BOB/JLS |
| DRAWN BY: | BOB |
| CHECKED BY: | BOB |
| SCALE: | DAS |
| AS NOTED | DATE: MAY 2014 |

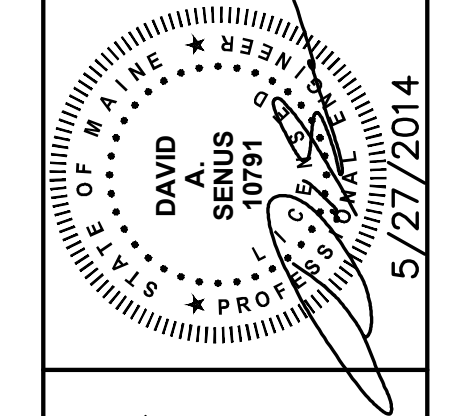

DEERING OAKS POND
 POND BOTTOM REPLACEMENT
 GENERAL NOTES, LEGEND &
 ABBREVIATIONS

CITY OF PORTLAND, MAINE
 PUBLIC SERVICES DEPARTMENT
 ENGINEERING SECTION



SHEET #
 1 OF 9
 PLAN NUMBER
 G-001

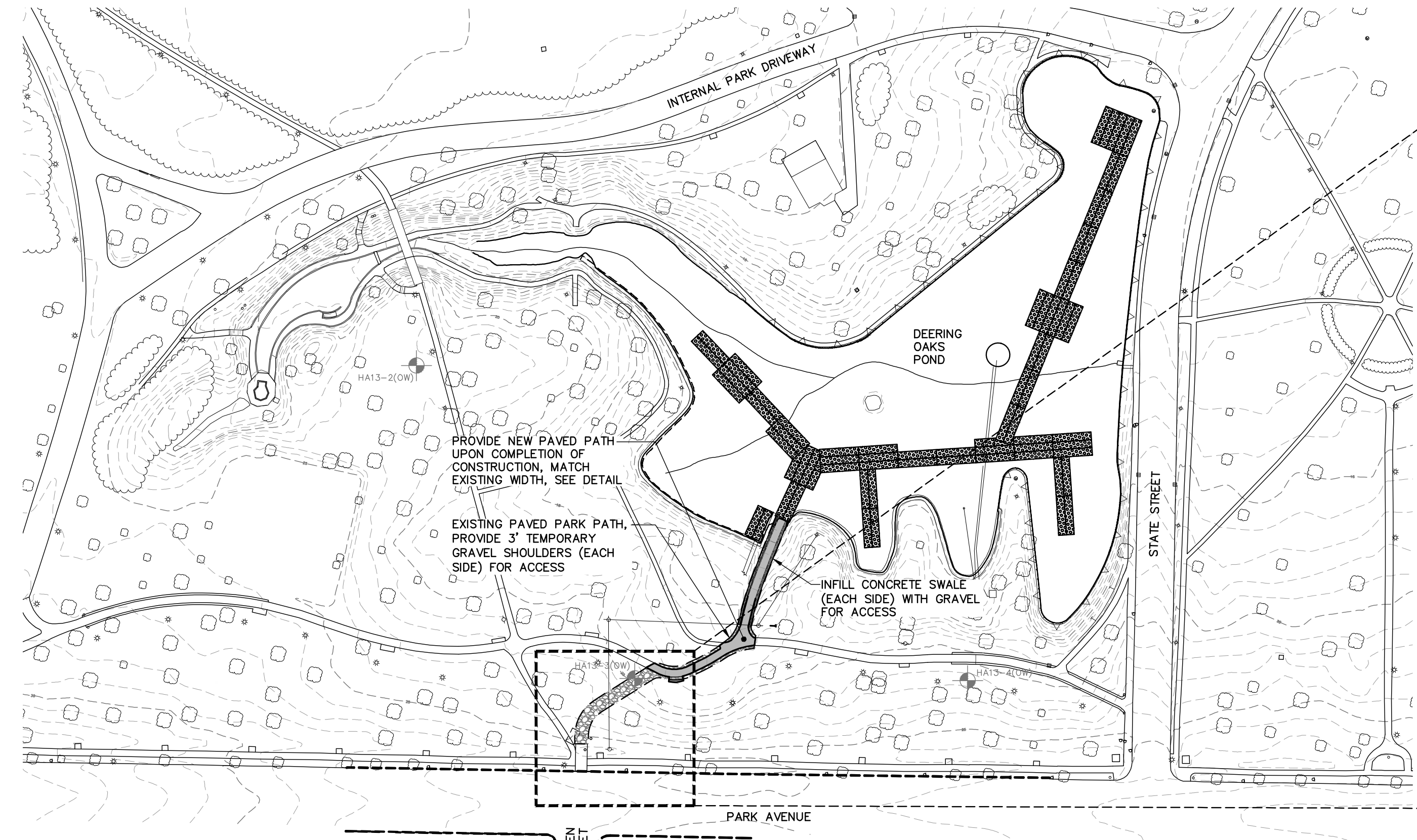

POND CONSTRUCTION ACCESS PLAN
 SCALE: 1"=100'

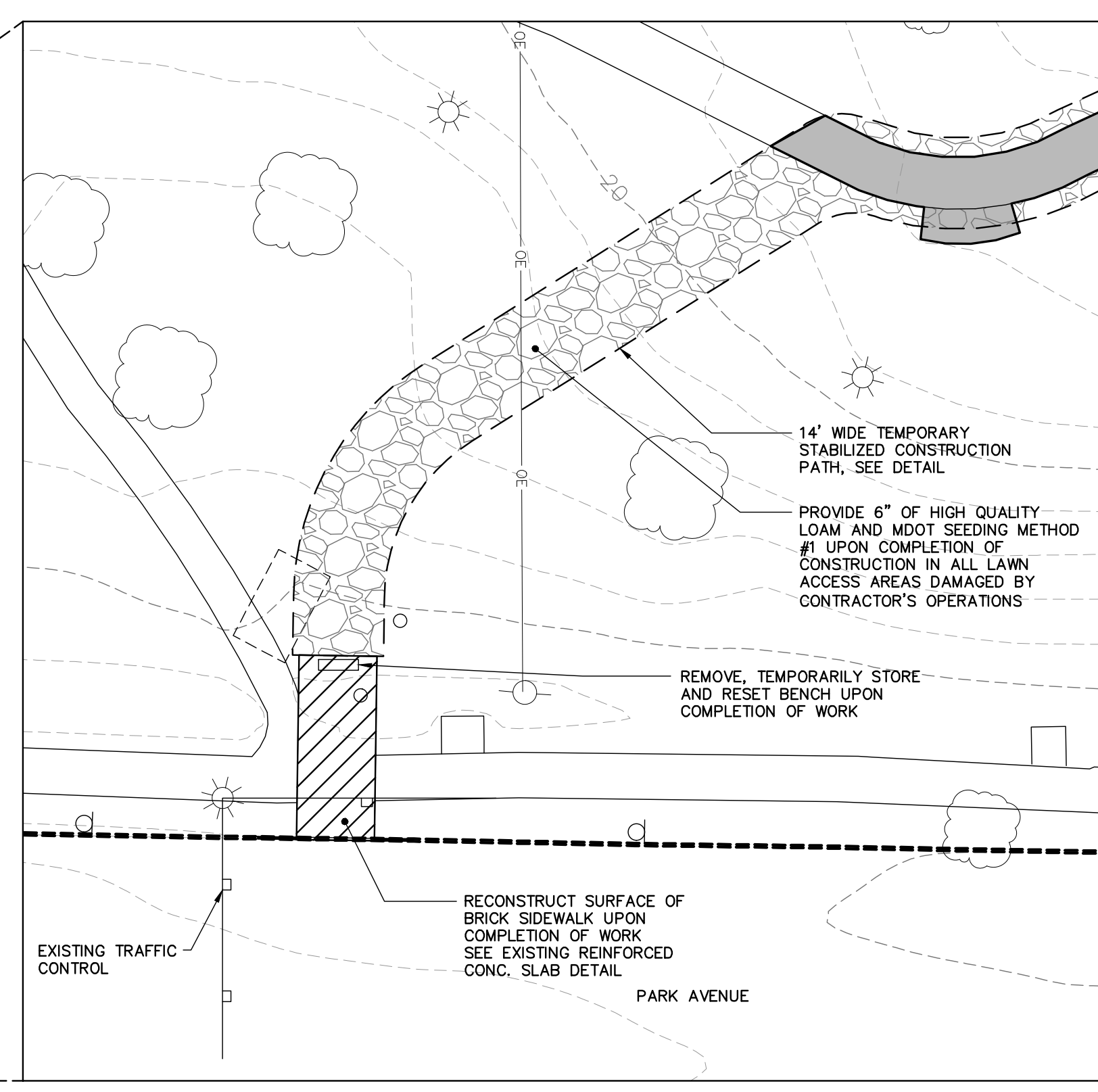

CONSTRUCTION EXIT DETAIL
 SCALE: 1"=20'

NOT FOR CONSTRUCTION