

GENERAL NOTES:
 A. DESIGN DRAWING ELEVATION 100'-0"
 B. DIMENSIONS ARE TO FACE OF FINISHED WALL OR COLUMN CENTER LINE. DIMENSIONS AT COOLER/FREEZERS ARE TO FACE OF COOLER/FREEZER WALL UNLESS OTHERWISE NOTED
 C. PROVIDE CLEAR CORNER GUARDS AT ALL OUTSIDE CORNERS 3"x3"x48"H
 D. GENERAL CONTRACTOR TO PROVIDE FRT WOOD BLOCKING IN ALL PARTITIONS FOR SURFACE MOUNTED EQUIPMENT INCLUDING, BUT NOT LIMITED TO, FIRE EXTINGUISHERS, SHELVING, COUNTERS & CABINETS
 E. NOT USED
 F. REFER TO DRAWING A102 FOR FLOOR FINISHES
 G. REFER TO DRAWINGS A202, A203, A204, A205 & A206 FOR INTERIOR ELEVATIONS
 H. ALL PARTITIONS TO EXTEND 6" ABOVE HIGHEST ADJACENT CEILING UNLESS OTHERWISE NOTED
 I. NOT USED
 J. NOT USED
 K. VERIFY SHELVING LIGHT VALANCE LOCATIONS WITH HBC PROJECT MANAGER PRIOR TO INSTALLATION

L. FOR VALANCES REFER TO PRIMARY DECOR GUIDE
 M. FOR WALL TYPES SEE DETAILS ON DRAWING A501
 N. FOR DOOR TYPES SEE SCHEDULE ON DRAWING A601
 O. FOR WINDOW TYPES SEE DRAWING A601

KEY NOTES:
 1 NOT USED
 2 FALSE COLUMN; DETAIL D3/A502
 3 NOT USED
 4 NOT USED
 5 NOT USED
 6 NOT USED
 7 NOT USED
 8 NOT USED
 9 NOT USED
 10 NOT USED
 11 NOT USED
 12 NOT USED
 13 NOT USED
 14 NOT USED
 15 NOT USED

16 NOT USED
 17 NOT USED
 18 NOT USED
 19 NOT USED
 20 NOT USED
 21 NOT USED
 22 NOT USED
 23 NOT USED
 24 NOT USED
 25 REMOVE ALL RUST FROM EXIST. METAL STAIR SUPPORT FRAMING, GRATING AND HANDRAILS. PREPARE AND PAINT STAIR COMPONENTS (SUPPORT FRAMING, GRATING AND HANDRAILS) TO MATCH
 26. REPAIR EXISTING DAMAGED HANDRAIL
 27. NOT USED.
 28. INFILL OPENING WHERE DOOR AND FRAME ARE TO BE REMOVED W/ METAL STUDS AND GYPSUM BOARD SIMILAR TO PARTITION TYPE A3 ON SHEET A501. NEW GYPSUM BOARD IS TO ALIGN W/ EXIST. GYPSUM BOARD
 29. COORD. INFILL W/ NEW DOOR SIZE
 30. ALIGN FACE OF NEW WALL W/ FACE OF EXIST. SOFFIT ABOVE
 31. ALIGN FACE OF NEW WALL W/ FACE OF EXIST. ADJACENT WALL
 32. NESTED MET. STUD COLUMN W/ 2X WOOD BLOCKING, CLAD W/ GWB 2" TO MATCH WALL. SEE DET C5/A501
 33. EXTEND WALL TO UNDERSIDE OF ROOF DECK. SEE DET A8/A501

34. METAL STUD FRAMING AT DOOR #6:
 CONTRACTOR TO ADVISE ARCHITECT IF EXISTING WALL MATERIALS DIFFER FROM NEW MATERIALS AS NOTED.
 NEW MET. STUD BOX HEADER TO CONSIST OF (2) 800S182-94 STUDS W/ 800T125 TOP AND BOTTOM TRACKS.
 FASTEN HEADER TO JAMB ASSEMBLY USING A VERTICAL 8" LONG 800T200-54 W/ (6) #10 SCREWS INTO THE JAMB AND (6) #10 SCREWS INTO THE HEADER.
 JAMB CONSTRUCTION - NESTED ASSEMBLY CONSISTING OF (2) 800S182-94 STUDS W/ (2) 800T125-94 TRACKS.
 FASTEN JAMB ASSEMBLY TO EXIST. STEEL ABOVE USING A UNI-CLIP BY CLARK DIETRICH (4) 1/4" DIA. X-EDN1'S INTO STEEL AND (8) #10 SCREWS INTO JAMB ASSEMBLY.
 FASTEN JAMB ASSEMBLY INTO EXIST. CONCRETE FOUNDATION USING AN 'EASYCLIP' #686 BY CLARK DIETRICH USING (8) #10 SCREWS INTO JAMB ASSEMBLY AND (2) 1/4" DIA. W/ 1" EMBEDMENT HILTI KWIKCON 11'S INTO CONCRETE.
 SEE LINTEL SCHEDULE ON DWG. A501 FOR SUPPORT OF THE EXIST. PRECAST CONCRETE BAND OVER THE DOOR OPENING
 35. INSTALL NEW 1/2" TILE BACKER BOARD ON EXIST. COOLER PANEL(S) IN PREPARATION FOR NEW WALL FINISH

LEGEND:
 COOLER OR FREEZER WALLS
 FIRE EXTINGUISHER
 KEY NOTES
 WALL TYPE/HEIGHT
 WINDOW TYPE
 DOOR TYPE
 NEW WALL PARTITION

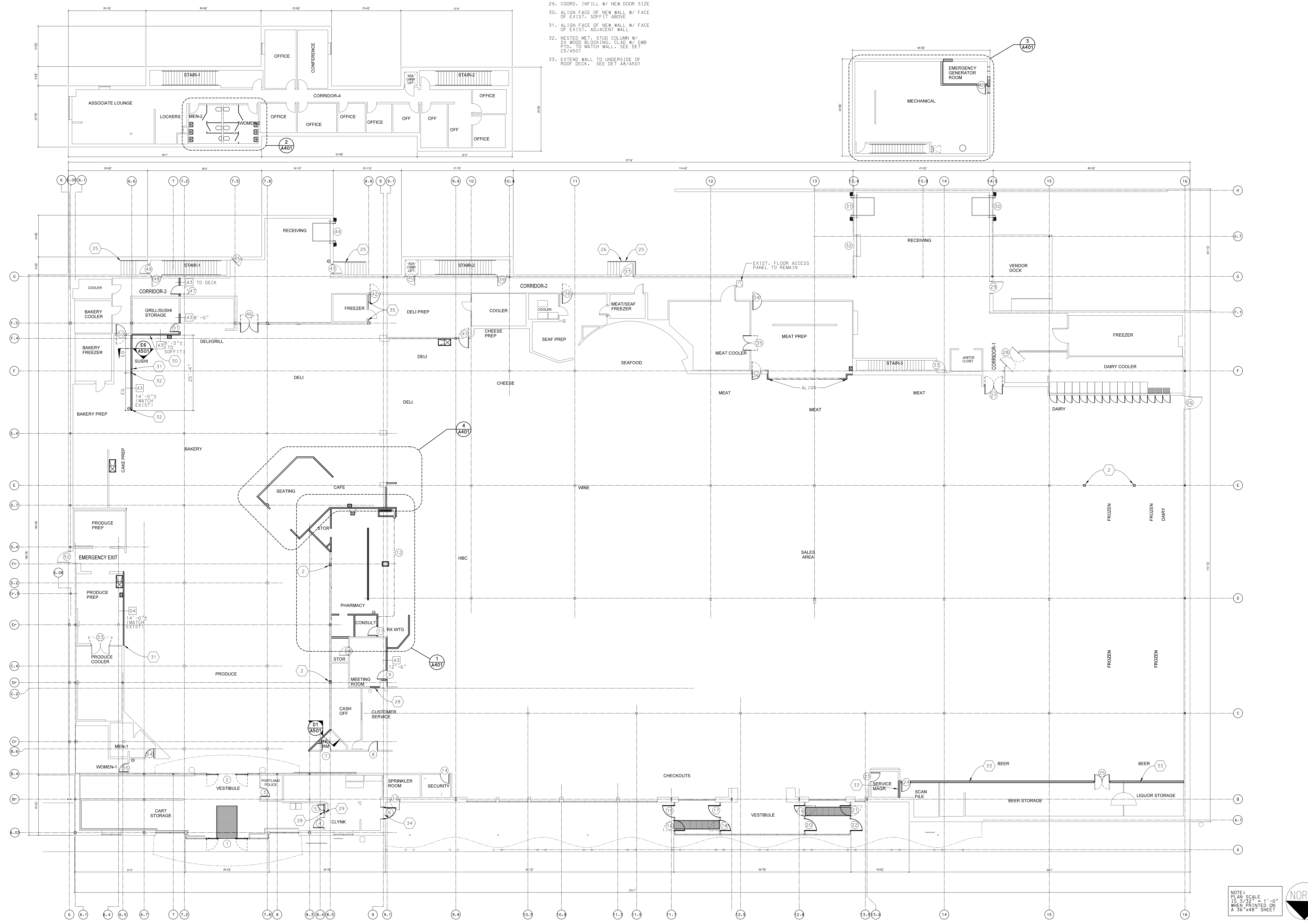

11/18/2011 8:52:14 AM

1 2 3 4 5 6

Revision

No.	Date	Description
2	11/19/11	ISSUED FOR CONSTRUCTION
1	10/21/11	ISSUED FOR HANNAFORD 100% REVIEW
0	09/29/11	ISSUED FOR HANNAFORD COX REVIEW

REMODEL HANNAFORD
SUPERMARKET & PHARMACY
 STORE #8311 - 295 FOREST AVENUE
 PORTLAND, MAINE 04101

Hannaford Bros. Co.

Prepared By: **JACOBS**
 ARCHITECT OF RECORD
 NAME: FLOYD W. MCCOLLUM, JR. AIA
 MAINE LICENSED ARCHITECT: 3850

Scale: 3/32" = 1'-0"
 Date: 10/21/11
 Designed by: I ESHAK
 Drawn by: I ESHAK
 Checked by: S OUELLETTE

Drawing No.
A101
 Project No.
PRY0300

NOTE: SCALE
 1/8" = 1'-0"
 WHEN PRINTED ON
 A 36" X 48" SHEET