

# DOOR SCHEDULE

DOORS										FRAMES			NOTES
MARK	LOCATION	TYPE	LABEL	MATERIAL	WIDTH	HEIGHT	THICK	LEAFS	MATERIAL	TYPE	DTL.	HRD	
01	shipping exit to hall	F	none	maple veneer solid core	3-0	8-0	1-3/4	1	metal	1	A		
02	inventory	F	none	maple veneer solid core	3-0	8-0	1-3/4	1	metal	1	A		
03	conference	F	none	maple veneer solid core	3-0	7-5/2"	1-3/4	1	metal	2	A		
04	office manager	FG	none	maple veneer solid core	3-0	8-0	1-3/4	1	metal	3	A		
05	office #1	FG	none	maple veneer solid core	3-0	8-0	1-3/4	1	metal	1	A		
06	office #2	FG	none	maple veneer solid core	3-0	8-0	1-3/4	1	metal	1	A		
07	office #3	FG	none	maple veneer solid core	3-0	8-0	1-3/4	1	metal	1	A		
08	kitchen	FV	none	maple veneer solid core	3-0	8-0	1-3/4	1	metal	1	A		
09	kitchen exit to hallway	F	none	maple veneer solid core	3-0	8-0	1-3/4	1	metal	1	A		
10	network closet	F	none	maple veneer solid core	3-0	8-0	1-3/4	1	metal	1	A		

**Notes:**  
Provide ADA compliant lever operated hardware at all doors

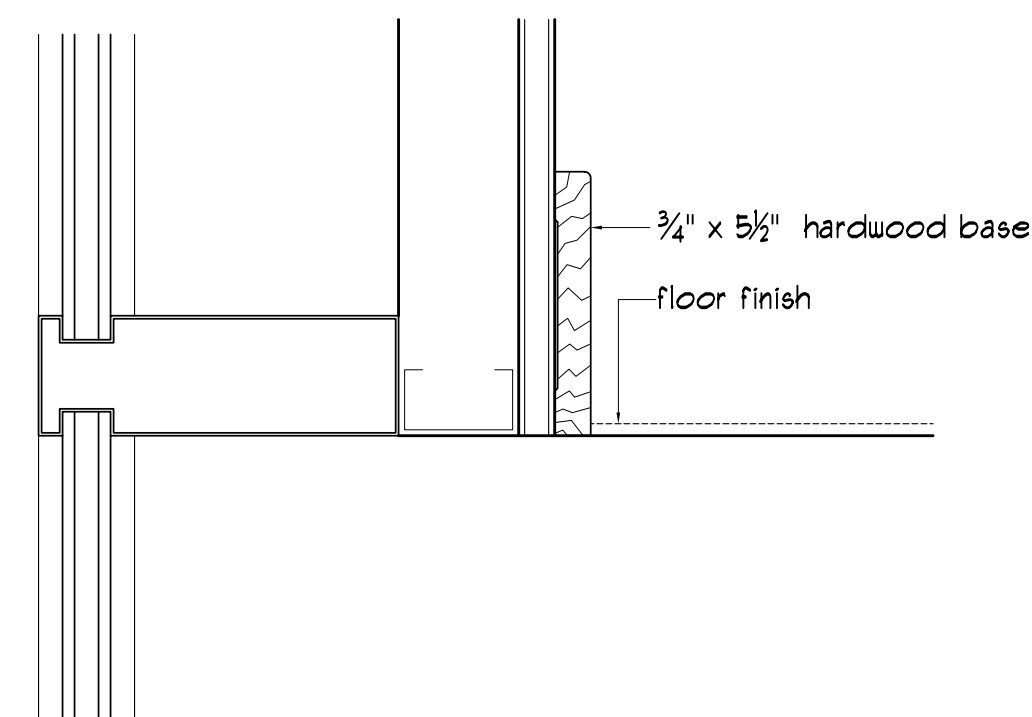
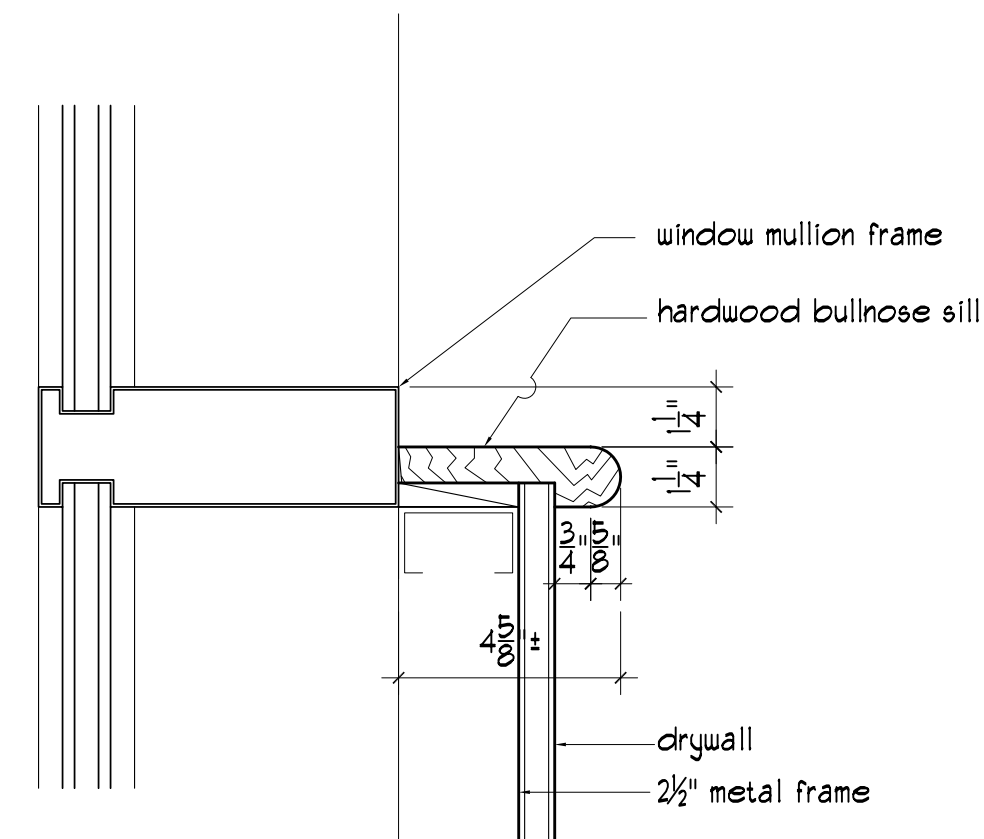
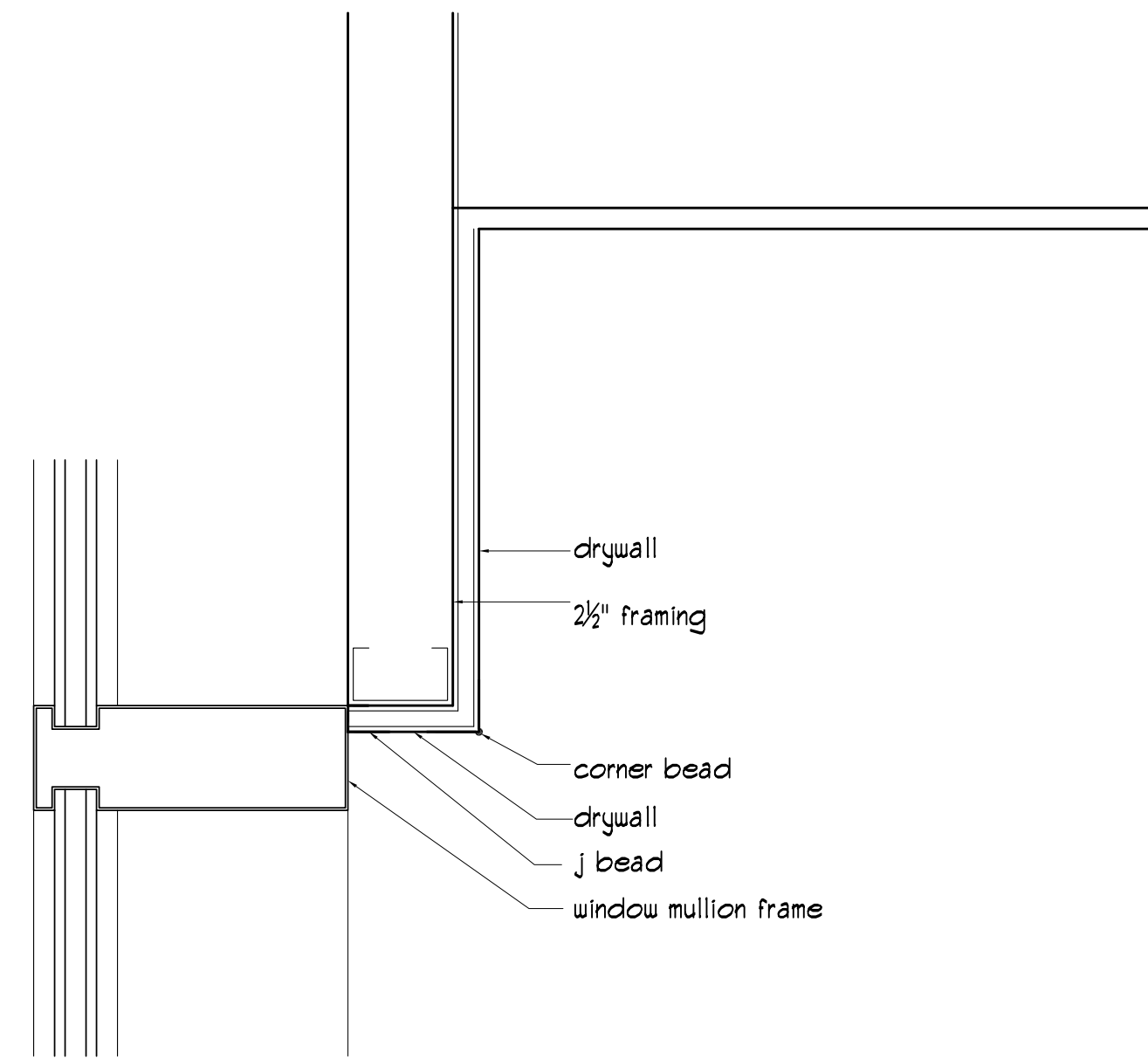

**1** detail at exterior wall  
scale: 3"= 1'-0"

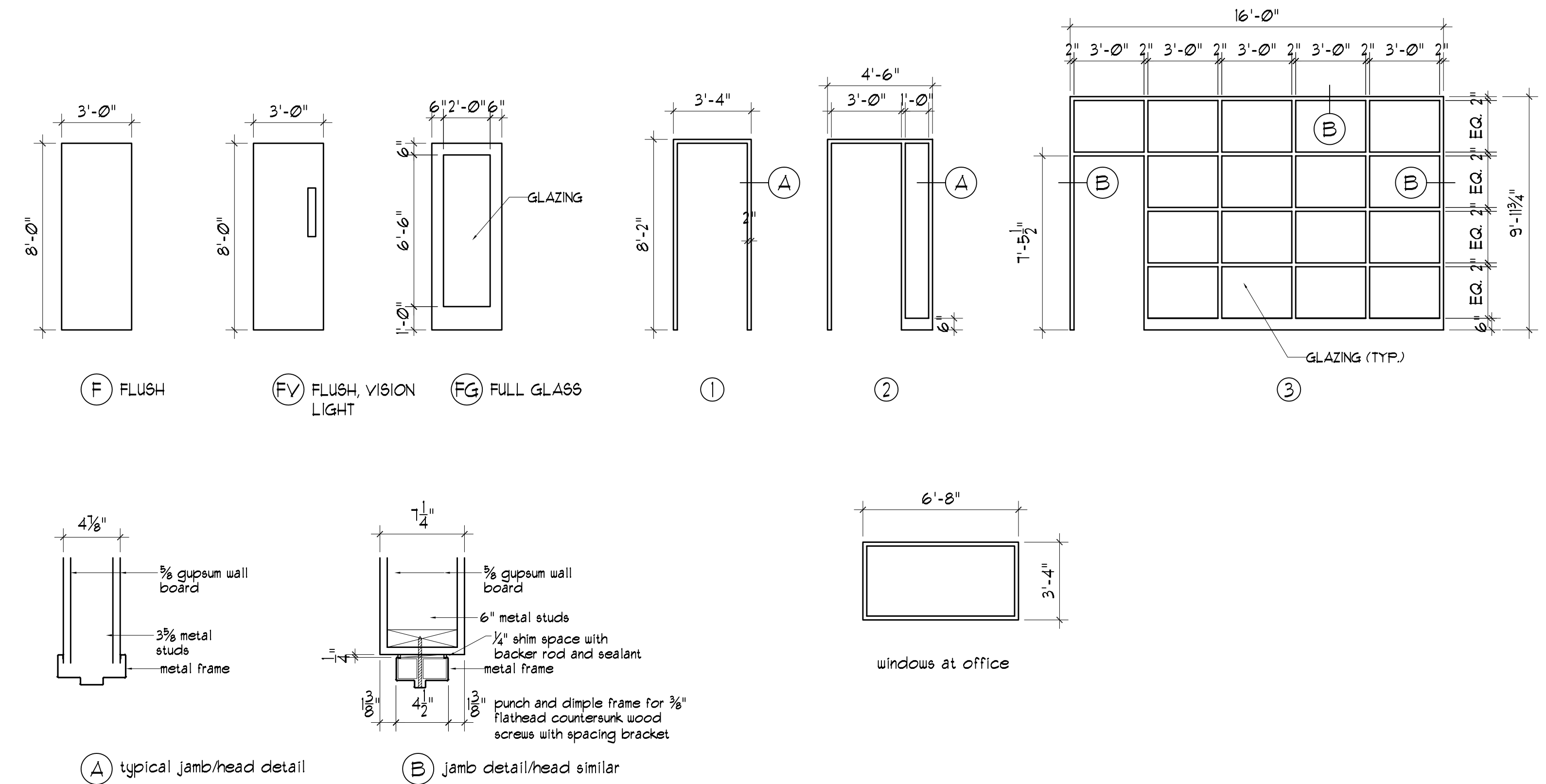

Note: Provide blocking and shims and backer rod and sealant at head. Contact architect for information on anchoring head of frame to ceiling

OWNER:  
WinXnet  
865 Spring Street  
Westbrook, ME 04096

ARCHITECTS  
ARCHETYPE, P.A.  
48 Union Wharf Portland, Maine 04101  
(207) 772-6022 Fax (207) 772-4056

Project:  
WinXnet  
Complete Business Technology Solutions  
5th floor, 84 Marginal Way,  
Portland, Maine 04101

Date: May 13, 2008  
Revisions:

door schedule  
details

a4.1