

City of Portland, Maine – Building or Use Permit Application 389 Congress Street, 04101, Tel: (207) 874-8703, FAX: 874-8716

Location of Construction: <i>36 Sargent St/Trable St</i>		Owner: <i>City of Portland</i>		Phone:		Permit No: 98133g	
Owner Address: <i>389 Congress St</i>		Lessee/Buyer's Name:		Phone:		Business Name:	
Contractor Name:		Address:		Phone:		Permit Issued: DEC - 1 1998	
Past Use: <i>Parking Lot</i>		Proposed Use: <i>Air Monitoring</i>		COST OF WORK: \$		PERMIT FEE: \$ <i>400.00</i>	
				FIRE DEPT. <input type="checkbox"/> Approved <input type="checkbox"/> Denied		INSPECTION: Use Group: Type:	
				Signature:		Signature: <i>[Signature]</i>	
Proposed Project Description: <i>Construct Cement Block Tower to Support Air Monitoring Instrument. (2' x 2' x 5')</i>				PEDESTRIAN ACTIVITIES DISTRICT (P.A.D.)			
				Action: Approved <input type="checkbox"/> Approved with Conditions: <input type="checkbox"/> Denied <input type="checkbox"/>			
				Signature:		Date:	
Permit Taken By: <i>MG</i>		Date Applied For: <i>November 13, 1998</i>		Zone:		CBL: <i>034A-B-901</i>	

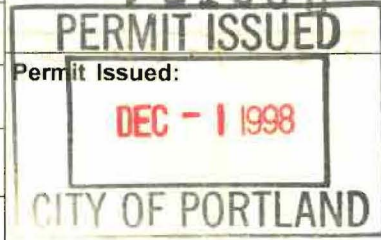

Zoning Approval:

Special Zone or Reviews:

Shoreland
 Wetland
 Flood Zone
 Subdivision
 Site Plan maj minor mm

Zoning Appeal

Variance
 Miscellaneous
 Conditional Use
 Interpretation
 Approved
 Denied

Historic Preservation

Not in District or Landmark
 Does Not Require Review
 Requires Review

Action:

Approved
 Approved with Conditions
 Denied

Date: *[Signature]*

1. This permit application does not preclude the Applicant(s) from meeting applicable State and Federal rules.
2. Building permits do not include plumbing, septic or electrical work.
3. Building permits are void if work is not started within six (6) months of the date of issuance. False information may invalidate a building permit and stop all work..

CERTIFICATION

I hereby certify that I am the owner of record of the named property, or that the proposed work is authorized by the owner of record and that I have been authorized by the owner to make this application as his authorized agent and I agree to conform to all applicable laws of this jurisdiction. In addition, if a permit for work described in the application is issued, I certify that the code official's authorized representative shall have the authority to enter all areas covered by such permit at any reasonable hour to enforce the provisions of the code(s) applicable to such permit

30 NOV 98 - SIGNED
November 16, 1998

SIGNATURE OF APPLICANT	ADDRESS:	DATE:	PHONE:
RESPONSIBLE PERSON IN CHARGE OF WORK, TITLE			PHONE:

CEO DISTRICT

APPLICATION FOR EXEMPTION FROM SITE PLAN REVIEW

Maine Department of Environmental Protection
 AIR Bureau

11/13/98

Applicant
312 Canco Road

Application Date
EMP AIR Monitoring Site

Applicant's Mailing Address
William Richardson 8226312

Project Name/Description /
City Park to 36 Marginal way

Consultant/Agent/Phone Number

Address of Proposed Site
5 Pablo St

Description of Proposed Development:
Construction of 2'x2' x 9' (aboveground) cement block tower to support air monitoring instrument (OBSIS - telescope receiver)

Please Attach Sketch/Plan of Proposal/Development

Applicant's Assessment (Yes, No, N/A)	Planning Office Use Only
Temporary EPA Y - Air Monitor Equipment (new)	
Y / Y	OK
Y / Y	OK
Y	OK
Y / Y	OK
Y / Y	OK
Y	OK
Y	OK

Criteria for Exemptions:

See Section 14-523 (4)

- a) Within Existing Structures; No New Buildings, Demolitions or Additions
- b) Footprint Increase Less Than 500 Sq. Ft.
- c) No New Curb Cuts, Driveways, Parking Areas
- d) Curbs and Sidewalks in Sound Condition/ Comply with ADA
- e) No Additional Parking / No Traffic Increase
- f) No Stormwater Problems
- g) Sufficient Property Screening
- h) Adequate Utilities

Planning Office Use Only:

Exemption Granted Partial Exemption _____ Exemption Denied _____

Planner's Signature Kandice Hunt

Date 11/30/98

THIS IS NOT A PERMIT/CONSTRUCTION CANNOT COMMENCE UNTIL THE PERMIT IS ISSUED

**Building or Use Permit Pre-Application
Attached Single Family Dwellings/Two-Family Dwelling
Multi-Family or Commercial Structures and Additions Thereto**

In the interest of processing your application in the quickest possible manner, please complete the Information below for a Building or Use Permit.

NOTEIf you or the property owner owes real estate or personal property taxes or user charges on ANY PROPERTY within the City, payment arrangements must be made before permits of any kind are accepted.**

Location/Address of Construction (include Portion of Building): <i>26 Marginal Way / Preble</i>		
Total Square Footage of Proposed Structure	Square Footage of Lot	
Tax Assessor's Chart, Block & Lot Number Chart# <i>034A</i> Block# <i>B</i> Lot# <i>001</i>	Owner: <i>City of Portland</i>	Telephone#: <i>Larry Meade 874-8689</i>
Owner's Address:	Lessee/Buyer's Name (If Applicable)	Cost Of Work: \$ <i>3000.00</i> Fee: \$ <i>N/C</i>
Proposed Project Description: (Please be as specific as possible) <i>Construction of a 2' x 2' x 9' cement block tower to support air monitoring instrument. Construction will occur adjacent to existing air monitoring shelter.</i>		
Applicant's Name, Address & Telephone <i>Catherine Richardson Maine DEP 312 Carco Road Portland 04103 8226312</i>		Rec'd By <i>[Signature]</i>
Current Use: <i>Park's Lot</i>	Proposed Use: <i>Air Monitoring - DEP EPA</i>	

Separate permits are required for Internal & External Plumbing, HVAC and Electrical installation.

- All construction must be conducted in compliance with the 1996 B.O.C.A. Building Code as amended by Section 6-Art II.
- All plumbing must be conducted in compliance with the State of Maine Plumbing Code.
- All Electrical Installation must comply with the 1996 National Electrical Code as amended by Section 6-Art III.
- HVAC(Heating, Ventillation and Air Conditioning) installation must comply with the 1993 BOCA Mechanical Code.

You must Include the following with you application:

- 1) A Copy of Your Deed or Purchase and Sale Agreement
- 2) A Copy of your Construction Contract, if available
- 3) A Plot Plan/Site Plan

Minor or Major site plan review will be required for the above proposed projects. The attached checklist outlines the minimum standards for a site plan.

4) Building Plans

Unless exempted by State Law, construction documents must be designed by a registered design professional.

A complete set of construction drawings showing all of the following elements of construction:

- Cross Sections w/Framing details (including porches, decks w/ railings, and accessory structures)
- Floor Plans & Elevations
- Window and door schedules
- Foundation plans with required drainage and dampproofing
- Electrical and plumbing layout. Mechanical drawings for any specialized equipment such as furnaces, chimneys, gas equipment, HVAC equipment (air handling) or other types of work that may require special review must be included.

Certification

I hereby certify that I am the Owner of record of the named property, or that the proposed work is authorized by the owner of record and that I have been authorized by the owner to make this application as his/her authorized agent. I agree to conform to all applicable laws of this jurisdiction. In addition, if a permit for work described in this application is issued, I certify that the Code Official's authorized representative shall have the authority to enter all areas covered by this permit at any reasonable hour to enforce the provisions of the codes applicable to this permit.

Signature of applicant: <i>[Signature]</i>	Date: <i>11/13/98</i>
--	-----------------------

Building Permit Fee: \$25.00 for the 1st \$1000.cost plus \$5.00 per \$1,000.00 construction cost thereafter.

Additional Site review and related fees are attached on a separate addendum





STATE OF MAINE
DEPARTMENT OF ENVIRONMENTAL PROTECTION

ANGUS S. KING, JR.
GOVERNOR

EDWARD O. SULLIVAN
COMMISSIONER

November 13, 1998

To Whom It May Concern:

Attached you will find documentation to support a building permit application. Included are two site drawings, a drawing of the tower, the bid from the mason and a note from the City giving us permission to locate at the site.

Any questions about the site or structure can be directed to me. My desk phone number is 822-6312.

Sincerely,

Catherine Richardson
Maine Department of Environmental Protection

PO. # for billing
FY 99 APR 111

Bill sent to:

AUGUSTA
17 STATE HOUSE STATION
AUGUSTA, MAINE 04333-0017
(207) 287-7688
RAY BLDG., HOSPITAL ST.

BANGOR
106 HOGAN ROAD
BANGOR, MAINE 04401
(207) 941-4570 FAX: (207) 941-4584

PORTLAND
312 CANCO ROAD
PORTLAND, MAINE 04103
(207) 822-6300 FAX



DEPARTMENT OF ENVIRONMENTAL PROTECTION
BUREAU OF AIR QUALITY

CATHERINE CLAYTON-RICHARDSON
ENVIRONMENTAL SPECIALIST

312 CANCO ROAD
PORTLAND, MAINE 04103

TEL. (207) 822-6512
FAX (207) 822-6505

e-mail: cathy.c.richardson@state.me.us

Executive Department



Larry S. Mead
Administrative Assistant
to the City Manager

CITY OF PORTLAND

November 13, 1998

Catherine Richardson
Maine Department of Environmental Protection
Canco Road
Portland, Maine 04103

Dear Ms. Richardson.

The City and State DEP have entered into an agreement authorizing DEP to use one parking space at the Marginal Way parking lot for the placement of an air quality monitoring structure and a small concrete block tower (8-10 feet high, approx. 2 feet square). The State has provided satisfactory evidence of insurance to the City in this regard.

The monitoring structure is already in place at Marginal Way. I authorize DEP to begin construction of the concrete block tower upon securing the necessary permits from the City's Inspections Office.

Sincerely,

A handwritten signature in black ink, appearing to read "L. Mead", written over the word "Sincerely,".

Larry S. Mead
Administrative Assistant to the City Manager

cc file copy

- Air/vents in Shelter
- Lights
- Tower Location

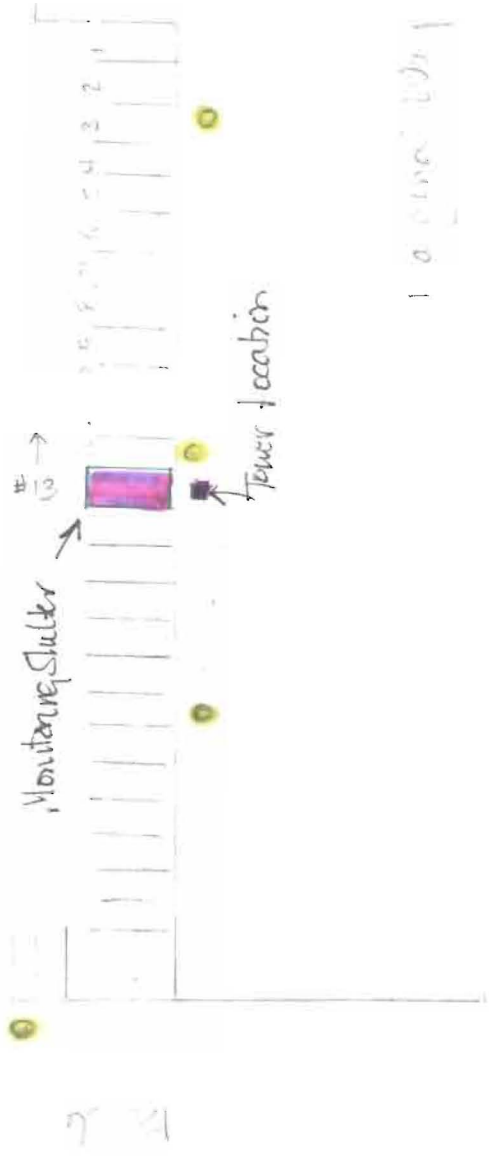

1000000000

EMP Site Drawing

Maine Department of Environmental Protection
Bureau of Air Quality

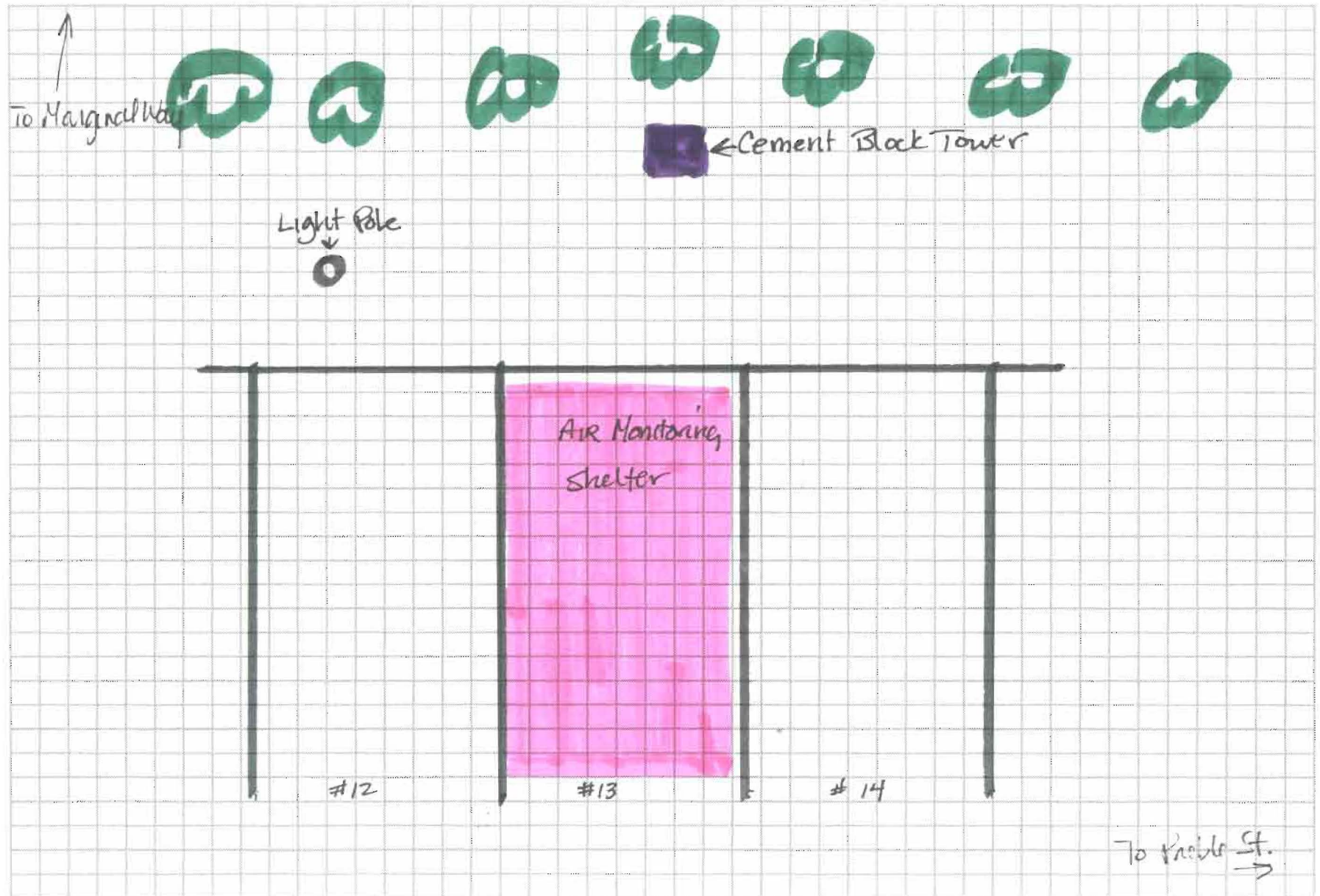

OP515 Recamer Support Tower

11/10/98

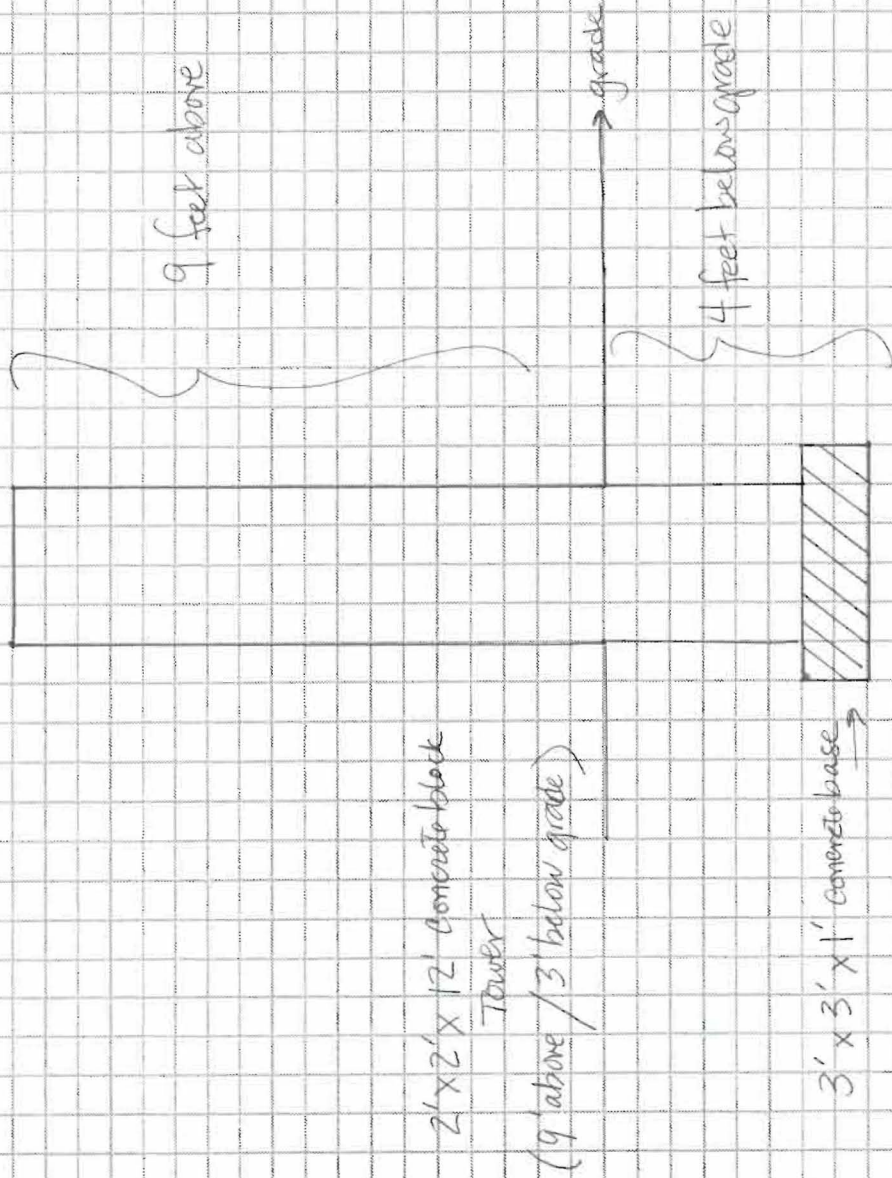

Catherine Richardson
Me DEP - Air Bureau

FRED HERSOM

Mason Contractor

3 Matthews Ave.
Bath, ME 04530
207-442-0433

TO: Maine DEP Impact
312 Canco Rd.
Portland, Me.
ATTN. Cathy Richardson

Date: 11-9-98

Please remit total amount due within fourteen (14) days.
Interest charged at the rate of 1 1/2% after thirty (30) days.
This is an annual rate of 18%.

Proposal For Block Towers EMP Site

Block Tower Base, 3'x3' Concrete 12" thick.
Concrete Block Tower, 24"X24" with Steel Rods
in Corners and Concrete Filled. Tower will be
4' Below grade, 9' above.

Labor & Material — \$ 3,000.00

As always, we THANK YOU for your business!