

1 PRECAST CONCRETE FIELD INLET  
 NOT TO SCALE

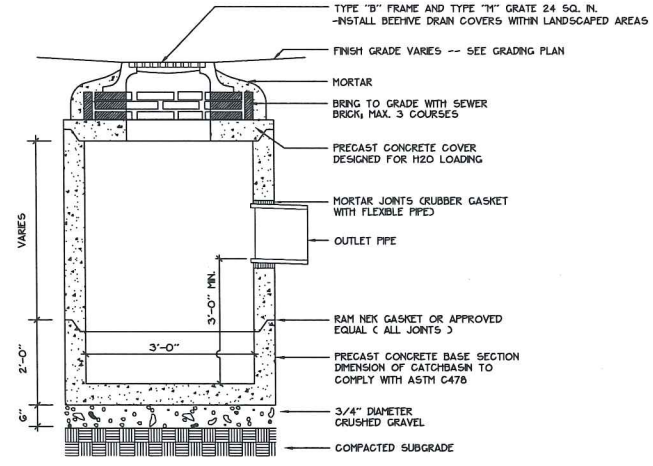

5 PRECAST CONCRETE CATCHBASIN  
 NOT TO SCALE

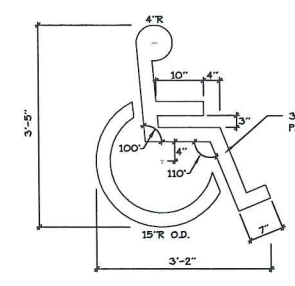

6 ACCESSIBLE SPACE MARKINGS + SIGNAGE  
 NOT TO SCALE

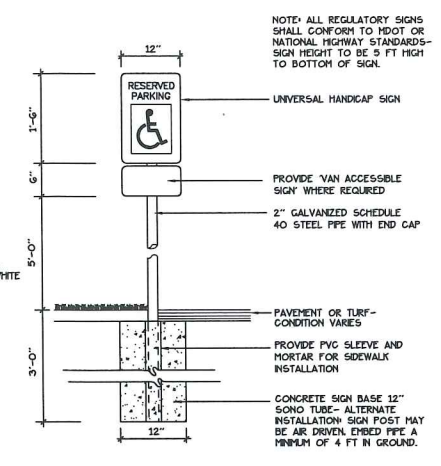

Prepared For:  
 Applicant:  
 BoPo, L.L.C.  
 58 Alder Street  
 Portland, Maine  
 Justin Alford, Manager

Prepared By:  
 MITCHELL & ASSOCIATES  
 Landscape Architects  
 The Staples School  
 79 Center Street  
 Portland, Maine 04101  
 Tel: (207) 774-4427

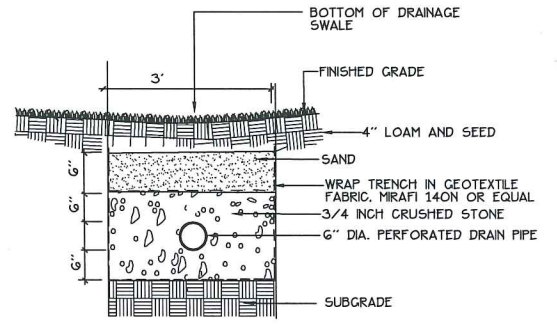

2 STONE INFILTRATION TRENCH  
 NOT TO SCALE

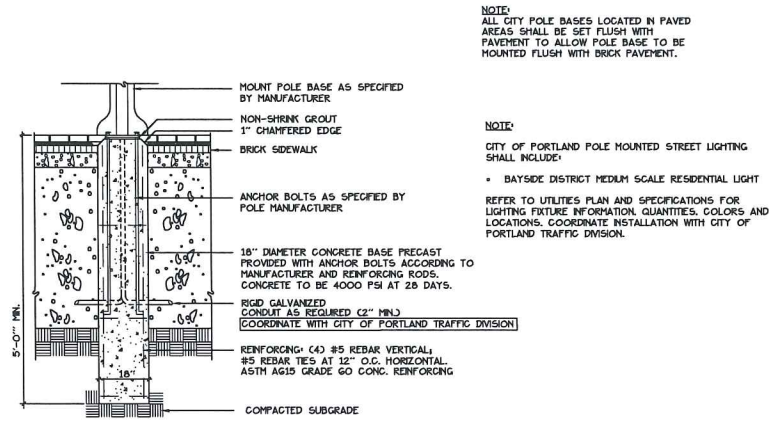

7 LIGHT POLE BASE  
 NOT TO SCALE

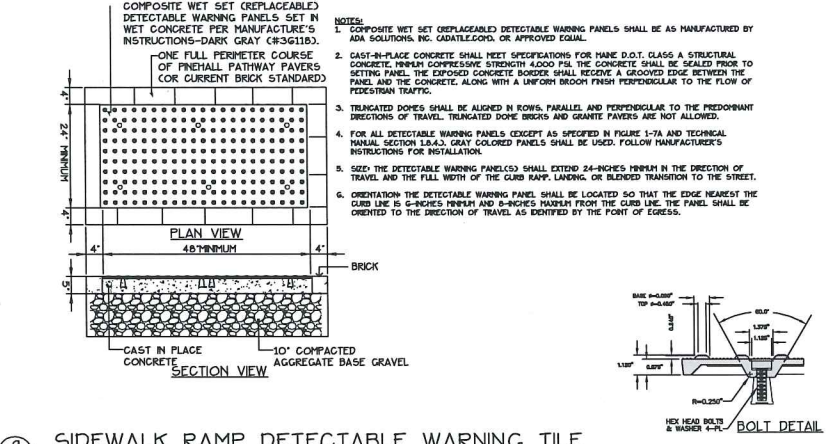

9 SIDEWALK RAMP DETECTABLE WARNING TILE  
 NOT TO SCALE

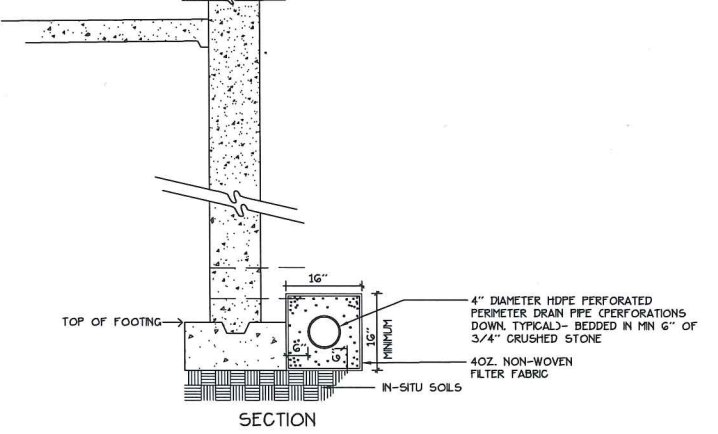

3 PERIMETER FOUNDATION UNDERDRAIN  
 NOT TO SCALE

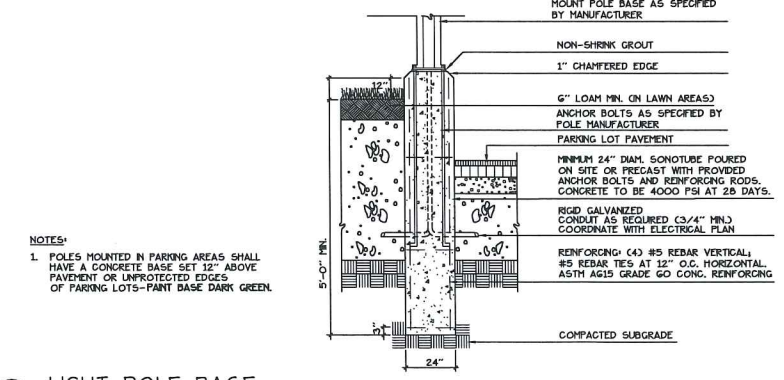

6 BAYSIDE FIXTURE LIGHT POLE BASE  
 NOT TO SCALE

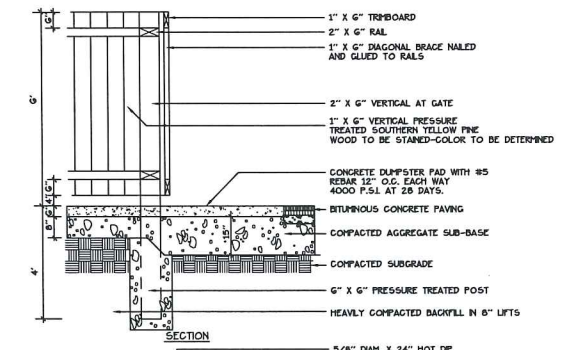

10 DUMPSTER ENCLOSURE  
 NOT TO SCALE

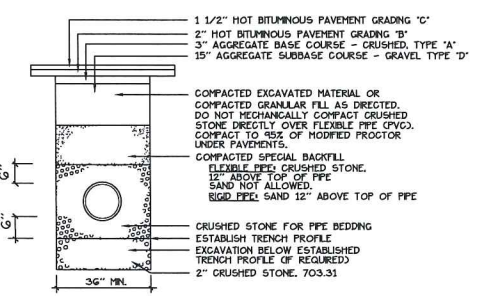

4 PIPE TRENCH DETAIL  
 NOT TO SCALE

BAYSIDE BOWL  
 58 Alder Street  
 Portland, Maine

Date:  
 DECEMBER 18, 2015

Issued For:  
 AMENDED  
 SITE PLAN SUBMISSION

Revisions:

Reproduction or reuse of this document without the expressed written consent of Mitchell & Associates is prohibited.

Title:  
 SITE DETAILS

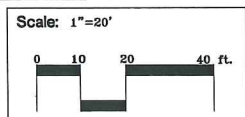

North:

Sheet No.:  
 6

