

**GENERAL NOTES**

- SITE AREA: 55,290 SF OR 1.27 ACRES
- SUBCATCHMENT 1: AREA = 51,053 S.F. IMPERVIOUS AREA = 45,968 S.F.  
SUBCATCHMENT 2: AREA = 4,239 S.F. IMPERVIOUS AREA = 1,628 S.F.
- SUBCATCHMENT BOUNDARIES AND TC PATHS WERE ESTIMATED BASED ON SPOT GRADES PROVIDED ON THE PROPOSED GRADING PLAN.
- ASSUMES ROOF DRAINS OUTLET IN THE DIRECTION OF THE EXISTING BUILDING PER THE ARCHITECTURAL ELEVATIONS PROVIDED IN PROPOSAL.



Prepared For:  
**Applicant:**  
**BoPo, L.L.C.**  
 58 Alder Street  
 Portland, Maine

Prepared By:  
**MITCHELL & ASSOCIATES**  
 Landscape Architects  
 The Staples School  
 70 Center Street  
 Portland, Maine 04101  
 Tel: (207) 774-4457

**BAYSIDE BOWL**  
 Portland, Maine  
 58 Alder Street

**LEGEND**

	EXISTING	PROPOSED
PROPERTY LINE		
GRANITE MONUMENT		
IRON PIN		
CATCHBASIN		
MANHOLE		
HYDRANT		
UTILITY POLE		
WATER VALVE		
SANITARY SEWER		
STORM DRAIN		
WATER		
TELEPHONE		
GAS		
CURB		
FENCE		
SIGN		
DECIDUOUS TREE		
EVERGREEN TREE		
PIPE BOLLARD		
BIKE HITCH		
SPOT GRADE		
WALL MOUNTED		
LIGHT FIXTURE		
SECURITY CAMERA		
OVERHEAD WIRES		
CMP CABLE LINES		

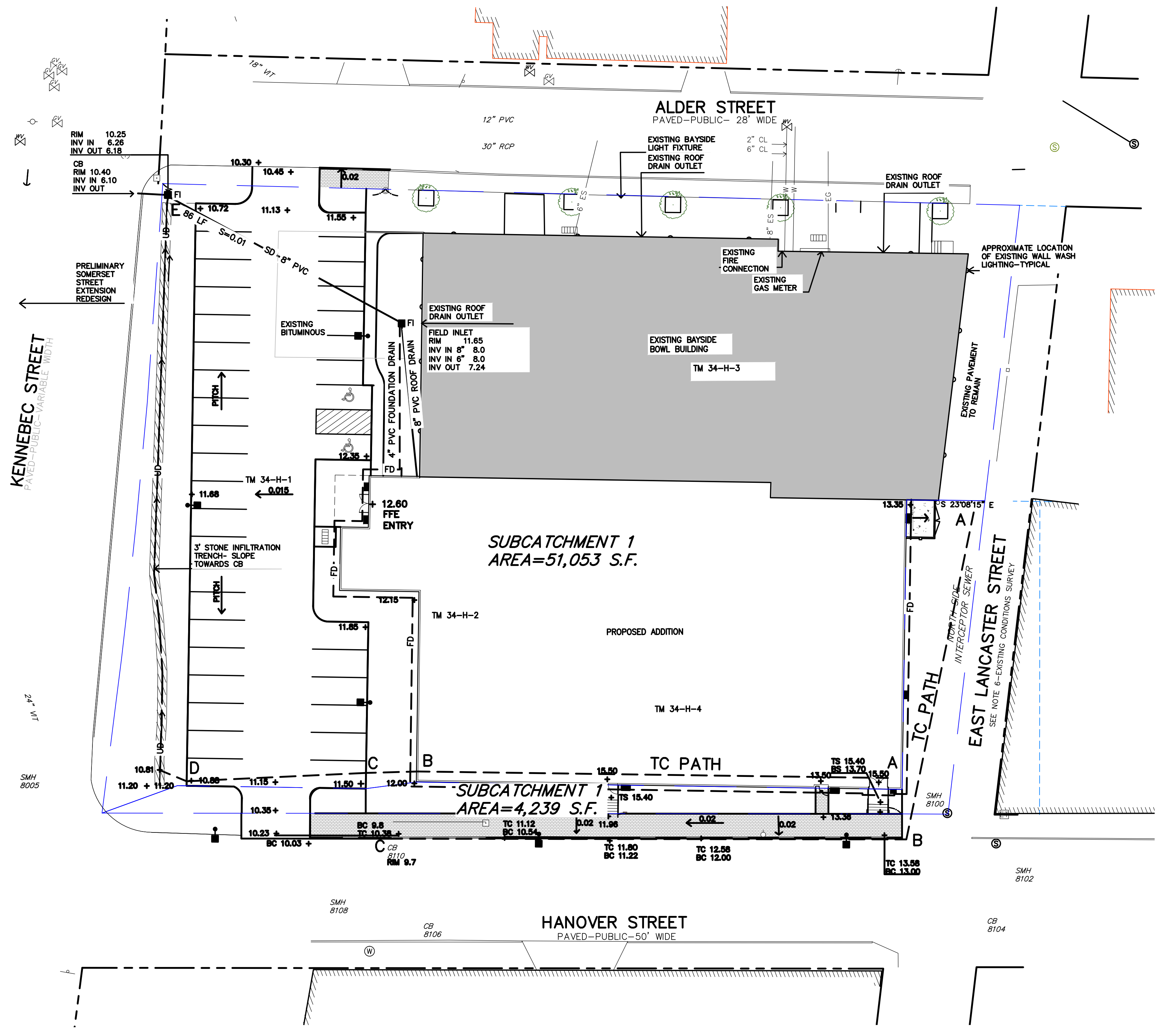

Date: **MARCH 24, 2015**

Issued For:  
**SITE PLAN SUBMISSION**

Revisions:

Reproduction or reuse of this document without the expressed written consent of Mitchell & Associates is prohibited.

Title:  
**POST DEVELOPMENT STORMWATER PLAN**

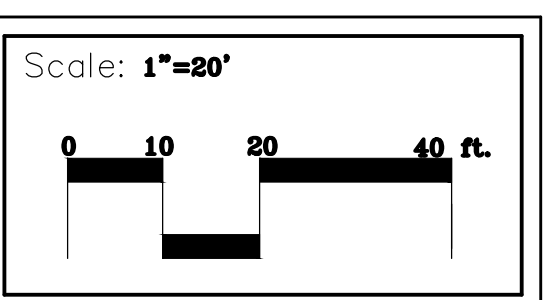

North:

Sheet No.: **SW-2**