

12 OVERFLOW ROOF DRAIN - TYPICAL DETAIL
1:1/2" = 1'-0"

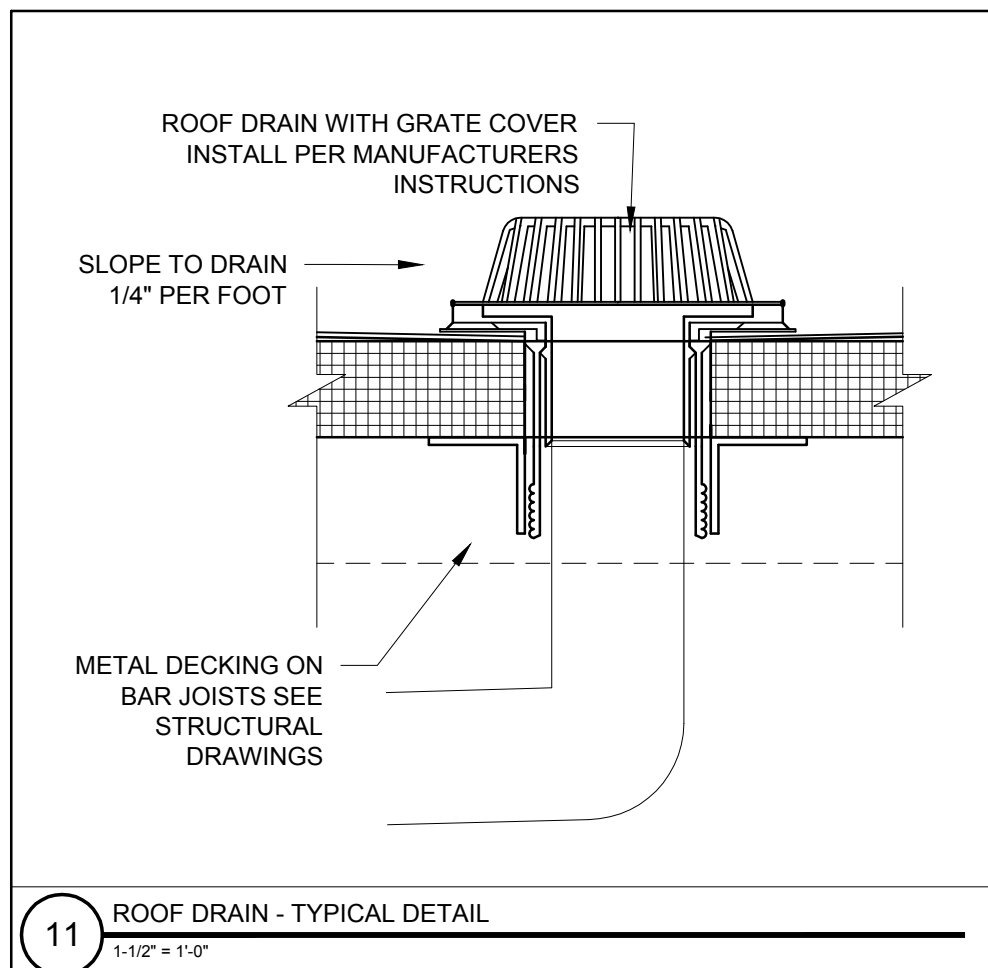

11 ROOF DRAIN - TYPICAL DETAIL
1:1/2" = 1'-0"

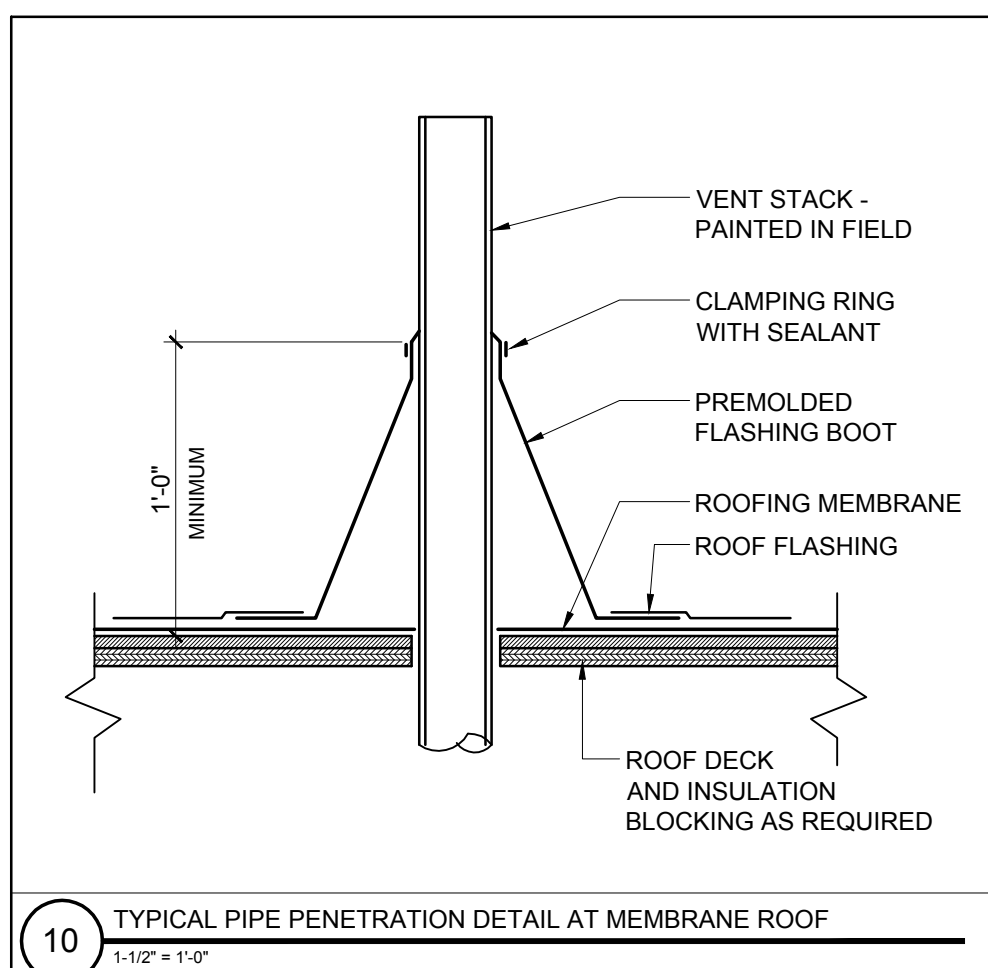

10 TYPICAL PIPE PENETRATION DETAIL AT MEMBRANE ROOF
1:1/2" = 1'-0"

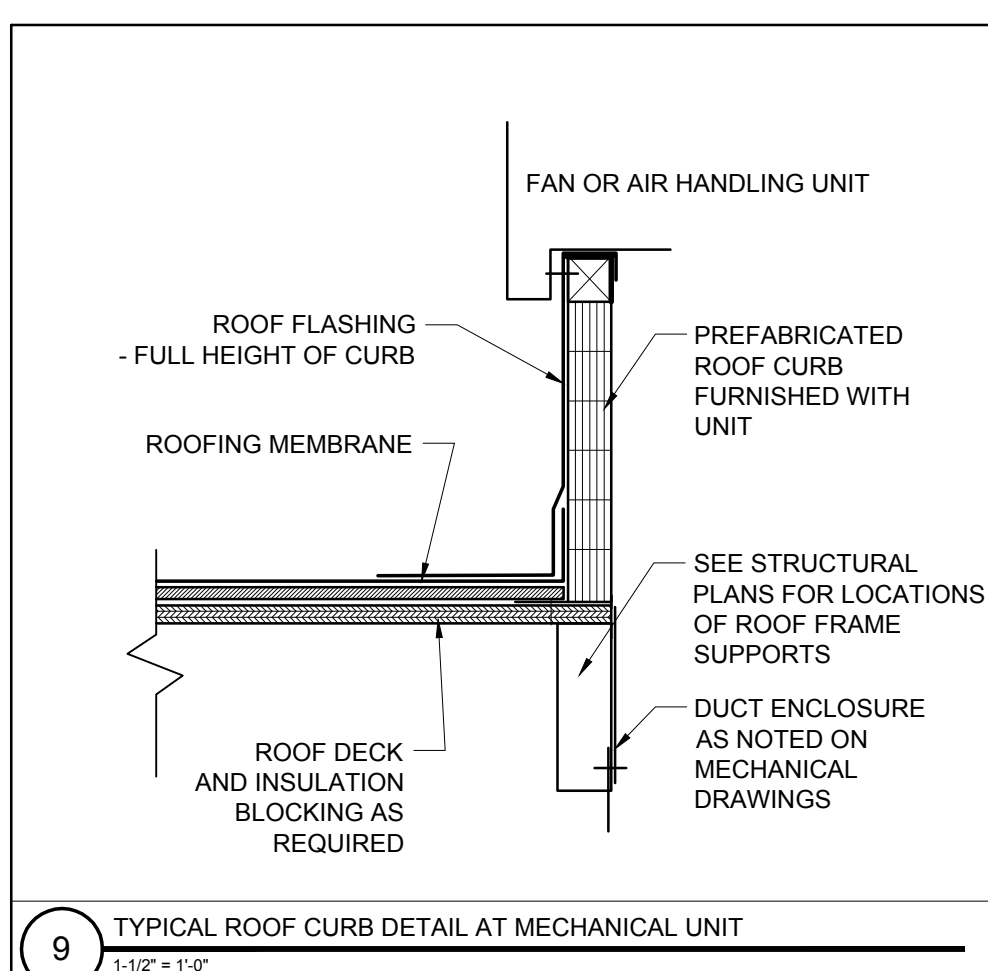

9 TYPICAL ROOF CURB DETAIL AT MECHANICAL UNIT
1:1/2" = 1'-0"

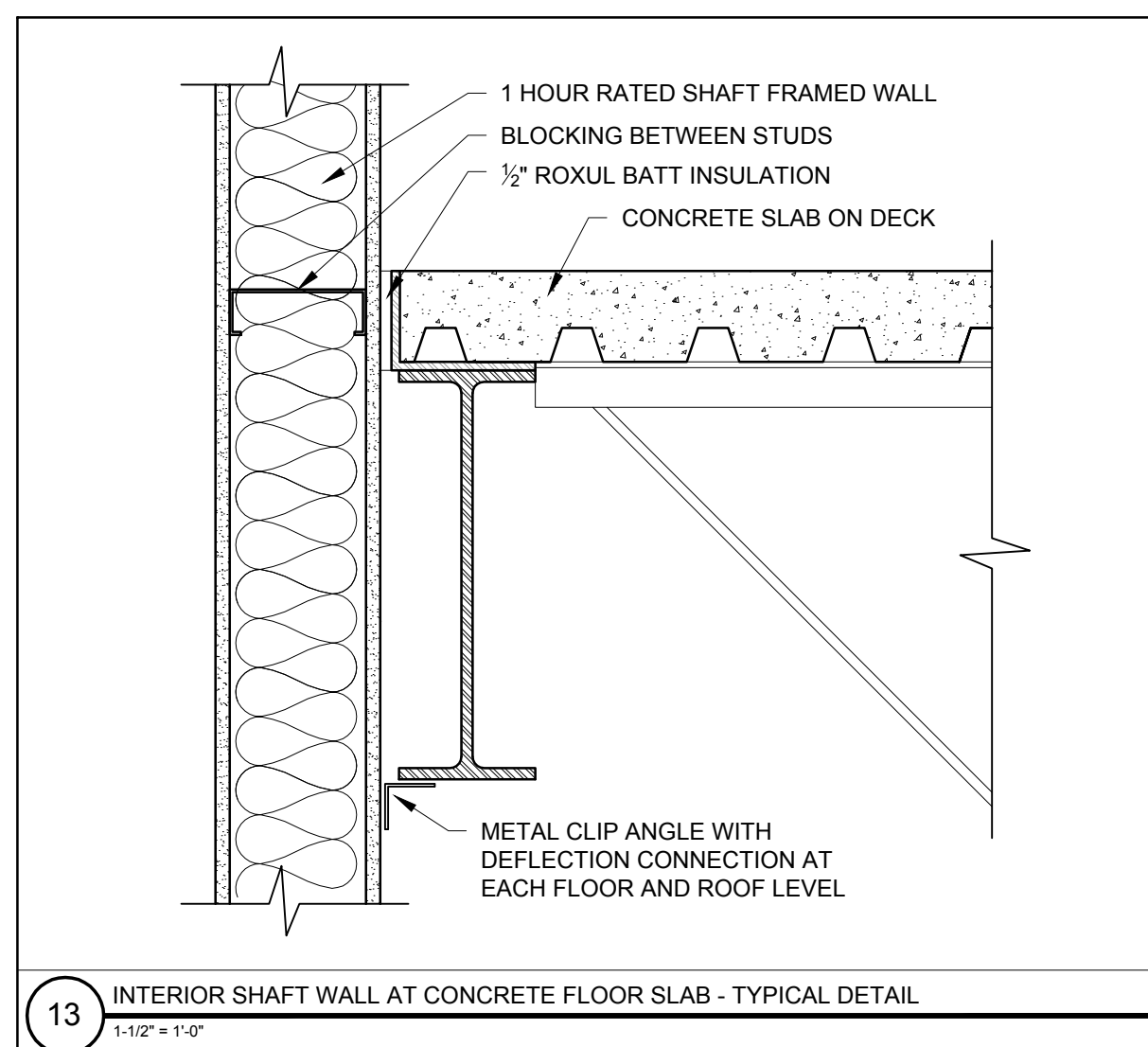
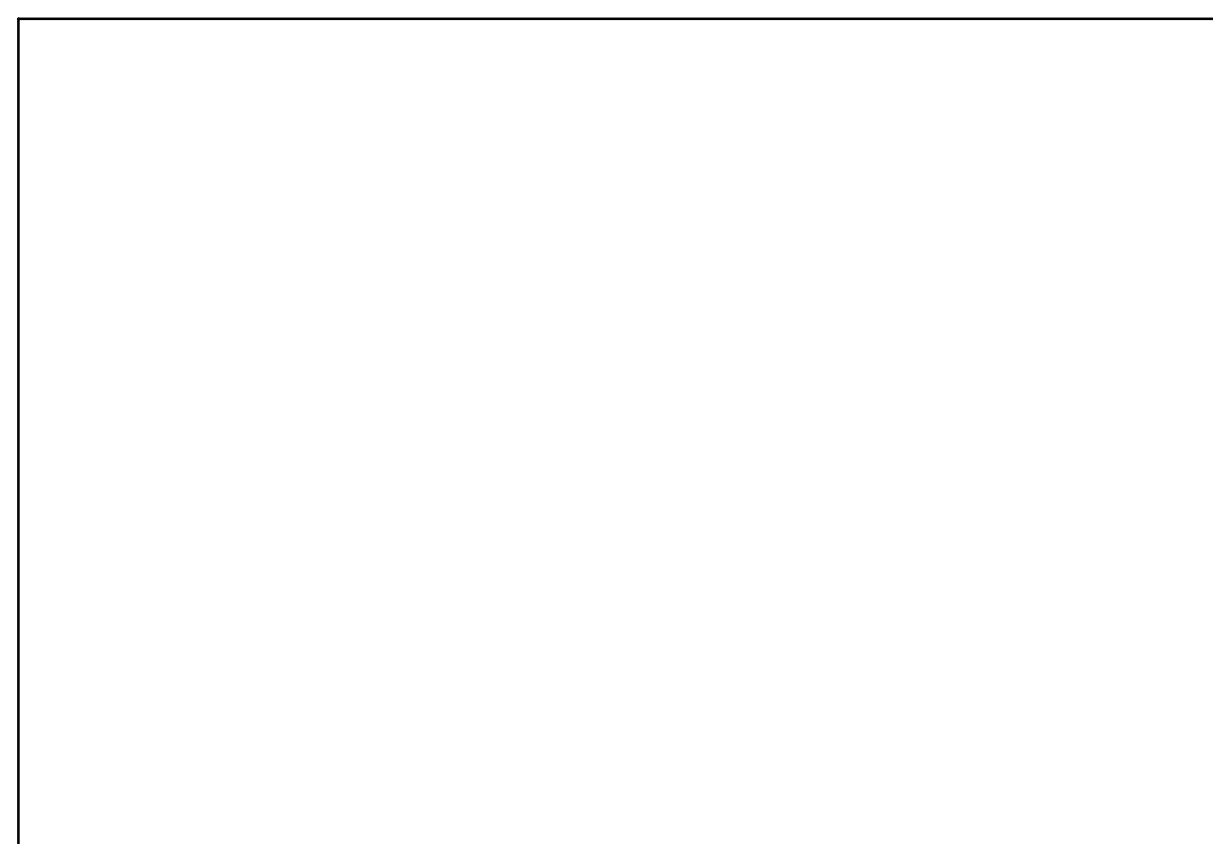

13 INTERIOR SHAFT WALL AT CONCRETE FLOOR SLAB - TYPICAL DETAIL
1:1/2" = 1'-0"

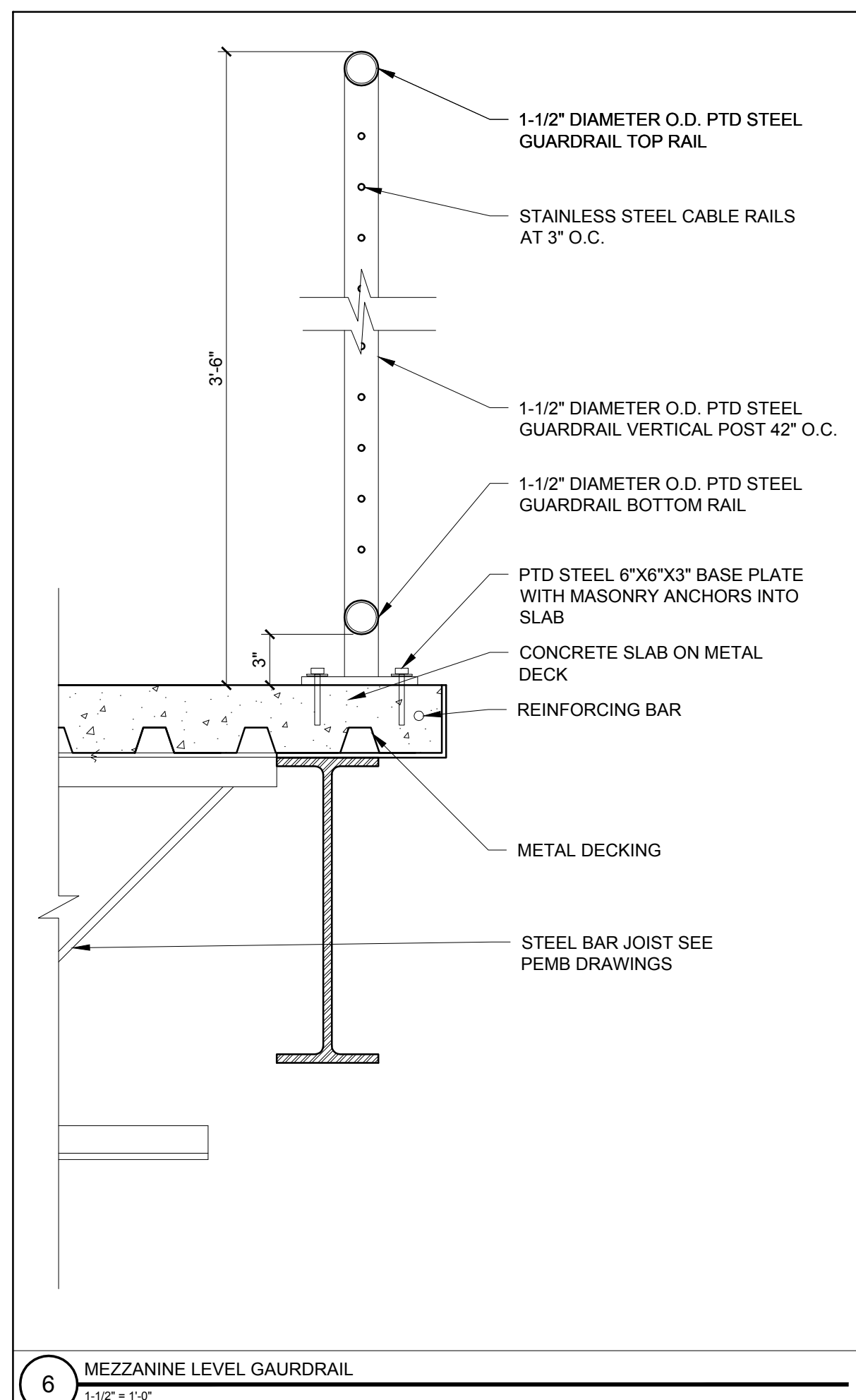

6 MEZZANINE LEVEL GAURDRAIL
1:1/2" = 1'-0"

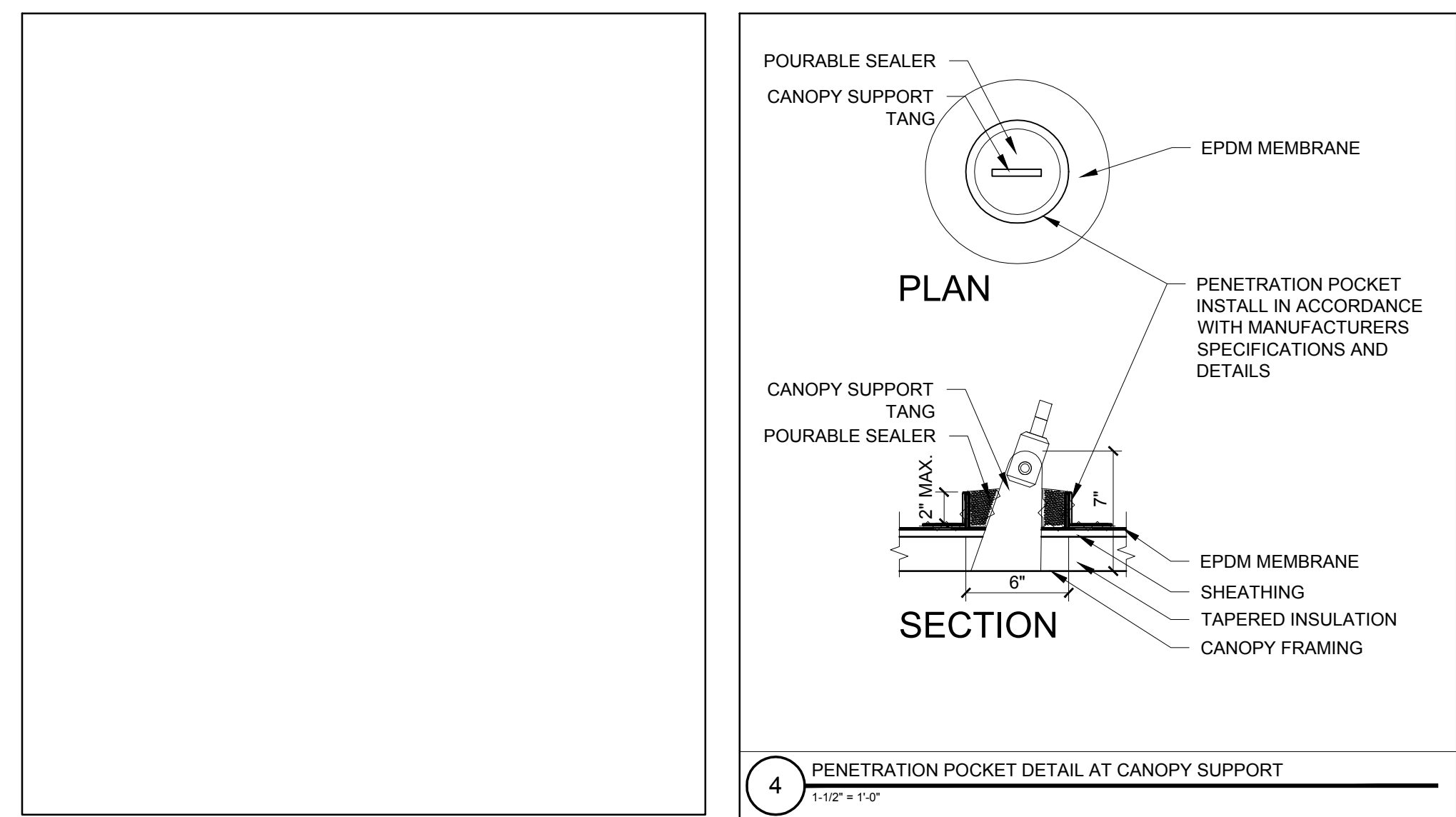

4 PENETRATION POCKET DETAIL AT CANOPY SUPPORT
1:1/2" = 1'-0"

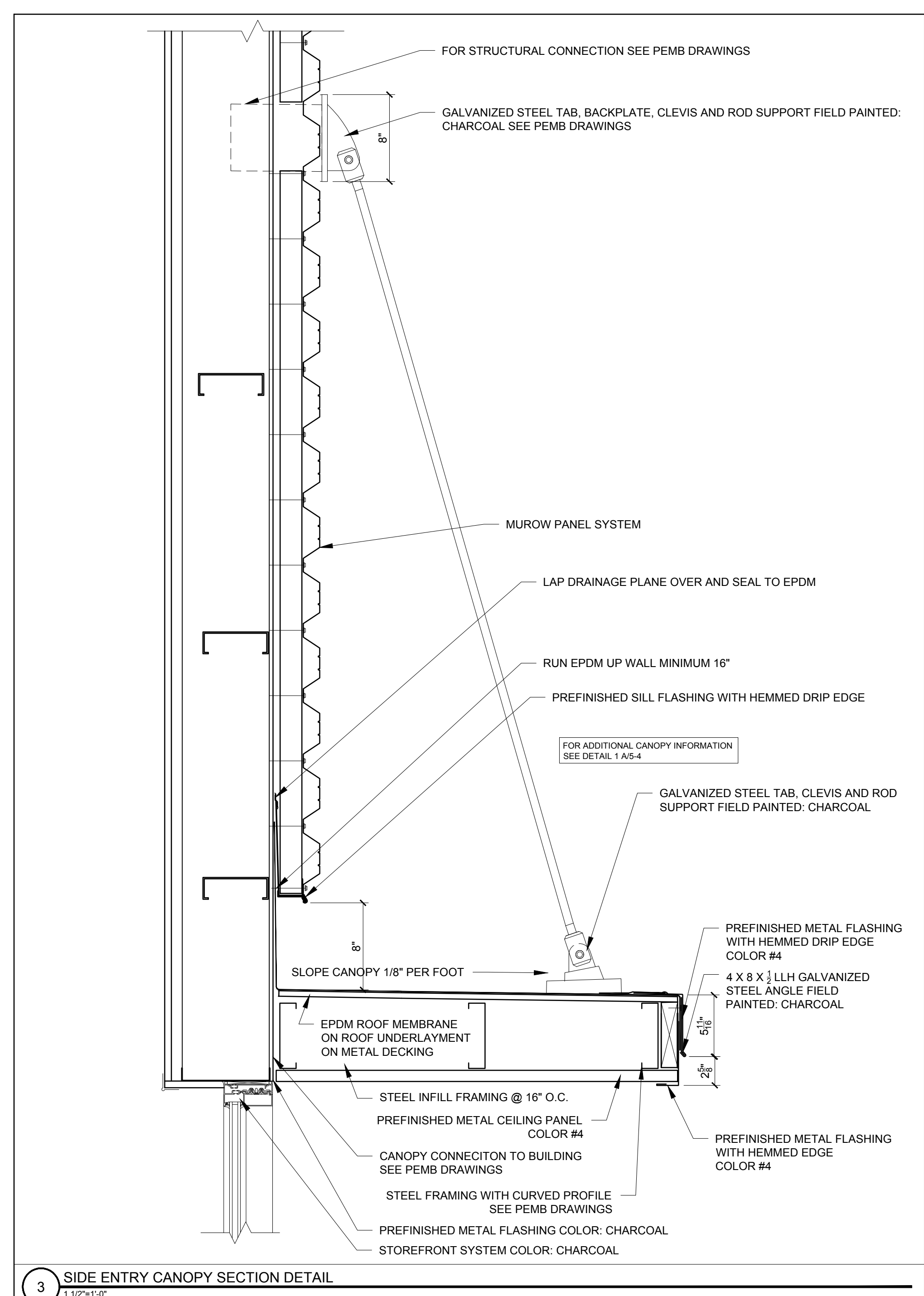

3 SIDE ENTRY CANOPY SECTION DETAIL
1:1/2" = 1'-0"

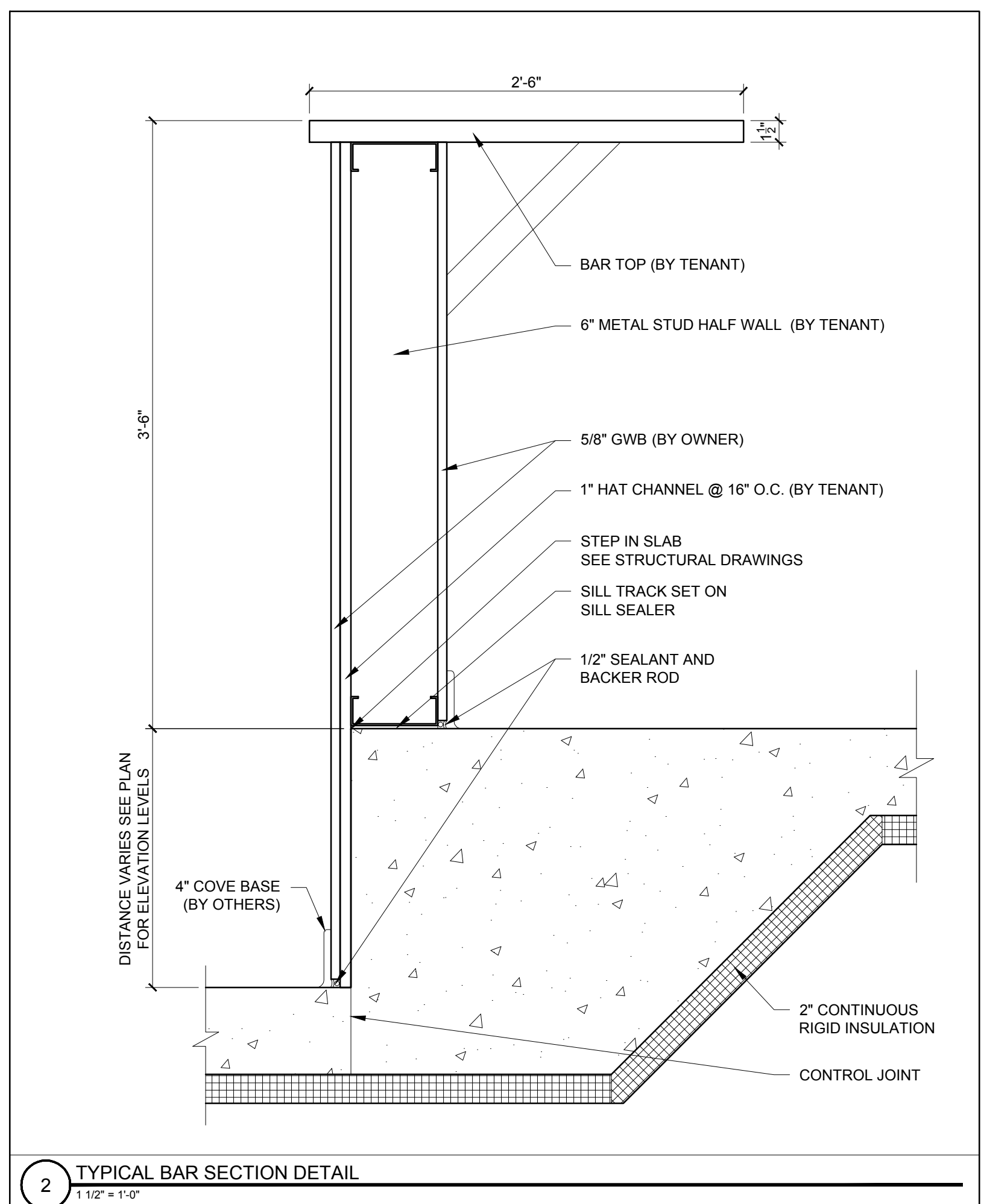

2 TYPICAL BAR SECTION DETAIL
1:1/2" = 1'-0"

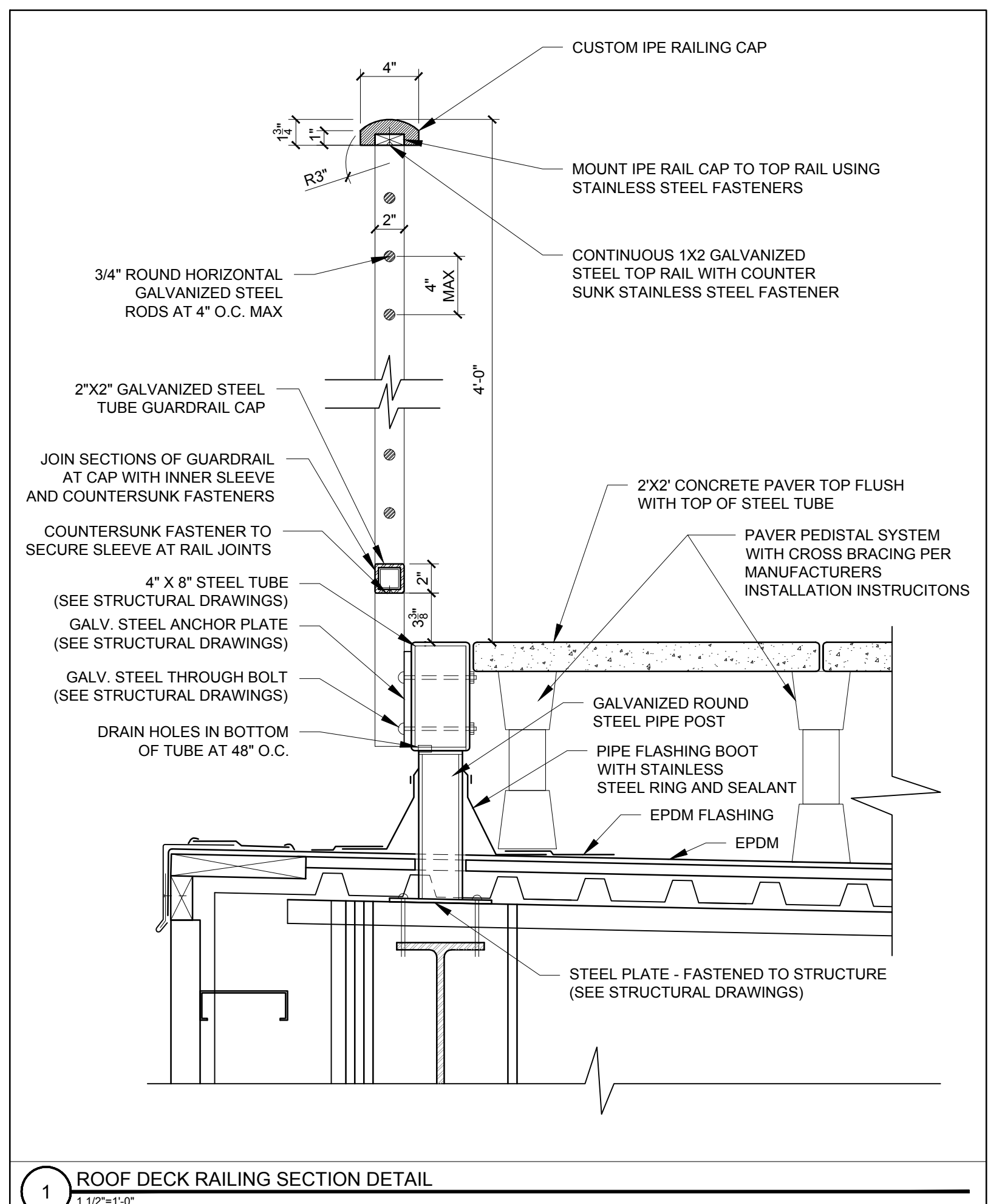

1 ROOF DECK RAILING SECTION DETAIL
1:1/2" = 1'-0"

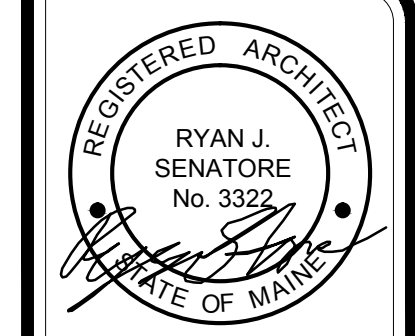

© 2016 RYAN SENATORE ARCHITECTURE

ADDITION TO BAYSIDE BOWL
ALDER STREET
PORTLAND, MAINE



RYAN SENATORE ARCHITECTURE
565 CONGRESS STREET
PORTLAND, MAINE 04101
207-656-6414
senatorearchitecture.com

CONSULTANTS:
STRUCTURAL: Structural Integrity
77 Oak Street
Portland, ME 04101
207-774-4814

REVISIONS:

DATE: JANUARY 29, 2016

PROJECT No. 1452

DRAWN BY: JPF / RRT / RJS

CHECKED BY: RJS

SCALE: AS NOTED

SHEET TITLE: DETAILS

A5-2