

**PLANT LIST**

KEY	QTY	BOTANICAL NAME	COMMON NAME	SIZE
<b>TREES</b>				
A. RUB	4	ACER RUBRUM 'KARPICK'	KARPICK MAPLE	2" CAL
M. SAR	4	MALUS SARGENTI	SARGENT FLOWERING CRAB	5'-6"
Q. RUB	2	QUERCUS CRIMSCHMIDT	CRIMSON SPIRE OAK	2" CAL
<b>SHRUBS</b>				
C. ALN	6	CLETHRA ALNIFOLIA 'RUBY SPICE'	RUBY SPICE SUMMERSWEET	#3
C. SAF	20	CORNUS SERICEA 'ARCTIC FIRE'	RED TWIG DOGWOOD	#3
M. GAL	9	MYRICA GALE	SWEET GALE	#3

**\*NOTES\***

DIG HOLE AT LEAST 2 TIMES THE WIDTH OF ROOT BALL AND AS DEEP AS THE ROOT BALL (NO DEEPER). SET ROOT BALL CENTERED, WITH TOP AT GROUND LEVEL OR SLIGHTLY HIGHER. CORRECT HOLE DEPTH AS NEEDED.

FOR DECIDUOUS AND NEEDLED EVERGREEN TREES AND SHRUBS 1 FULL WHEELBARROW EXISTING SOIL, 2 SHOVELS PEAT, 1 SHOVEL WELL ROTTED MANURE, OR OTHER COMPOSTED ORGANIC MATERIAL, FOR BROADLEAVED EVERGREENS AND RELATED ERGACAE PLANTS: 1 FULL WHEELBARROW EXISTING SOIL, 3-4 SHOVELS PEAT, 1 SHOVEL WELL ROTTED MANURE, OR OTHER COMPOSTED ORGANIC MATERIAL OF LOW pH (RECOMMENDATIONS ARE FOR ACCEPTABLE PLANTING AREAS).

CONTAINER GROWN STOCK: REMOVE CONTAINER PROTECTING ROOT BALL, GENTLY COMB OUT ROOTS, PRUNE DAMAGED ROOTS.

BACKFILL 2/3 OF HOLE WITH AMENDED SOIL THEN FILL HOLE WITH WATER. LET DRAIN, REPEAT WATER AND DRAIN. BACK FILL TO FINISH GRADE. TAMP GENTLY, AND GREAT EARTH SAUCER, WATER THOROUGHLY ONCE AGAIN TO REMOVE REMAINING AIR POCKETS.

2" X 2" OF 2 1/2" DIAMETER STAKES WITH 2 #12 GAUGE WIRES ENCASED IN 2-PLY REINFORCED RUBBER HOSE 1/2" DIAMETER OR CHARLOCK AS APPROVED BY LANDSCAPE ARCHITECT. 2 STAKES LOCATED 180° APART (STAKES SHALL BE FIRMLY SET TO PROVIDE NECESSARY TENSION).

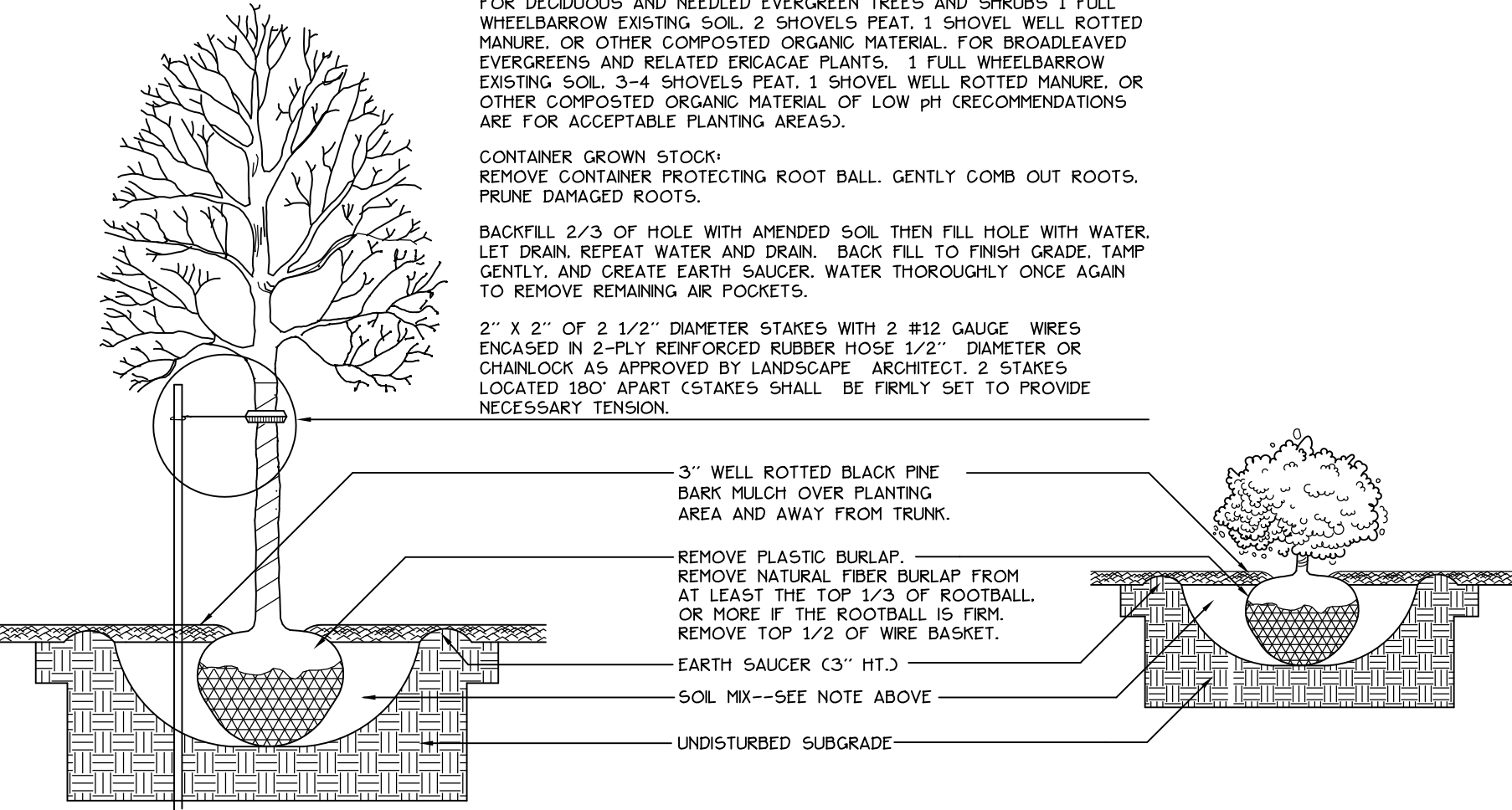

1  
3A TREE AND SHRUB INSTALLATION  
NOT TO SCALE

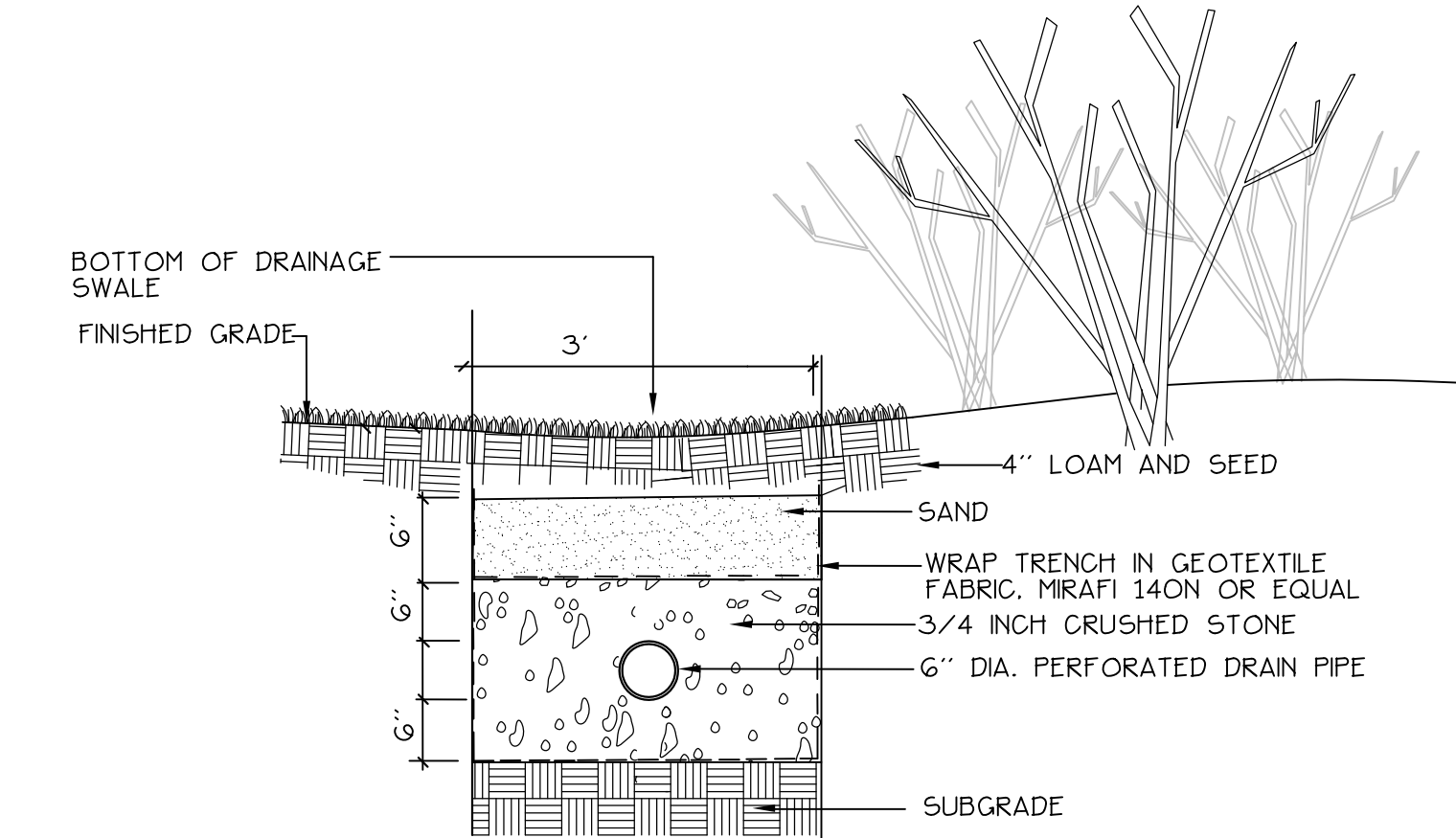

2  
3A STONE INFILTRATION TRENCH  
NOT TO SCALE

**LEGEND**

	EXISTING	PROPOSED
PROPERTY LINE		
GRANITE MONUMENT		
IRON PIN		
CATCHBASIN		
MANHOLE		
HYDRANT		
UTILITY POLE		
CURB		
FENCE		
SIGN		
DECIDUOUS TREE		
EVERGREEN TREE		
WALL MOUNTED		
LIGHT FIXTURE		
INFILTRATION TRENCH		

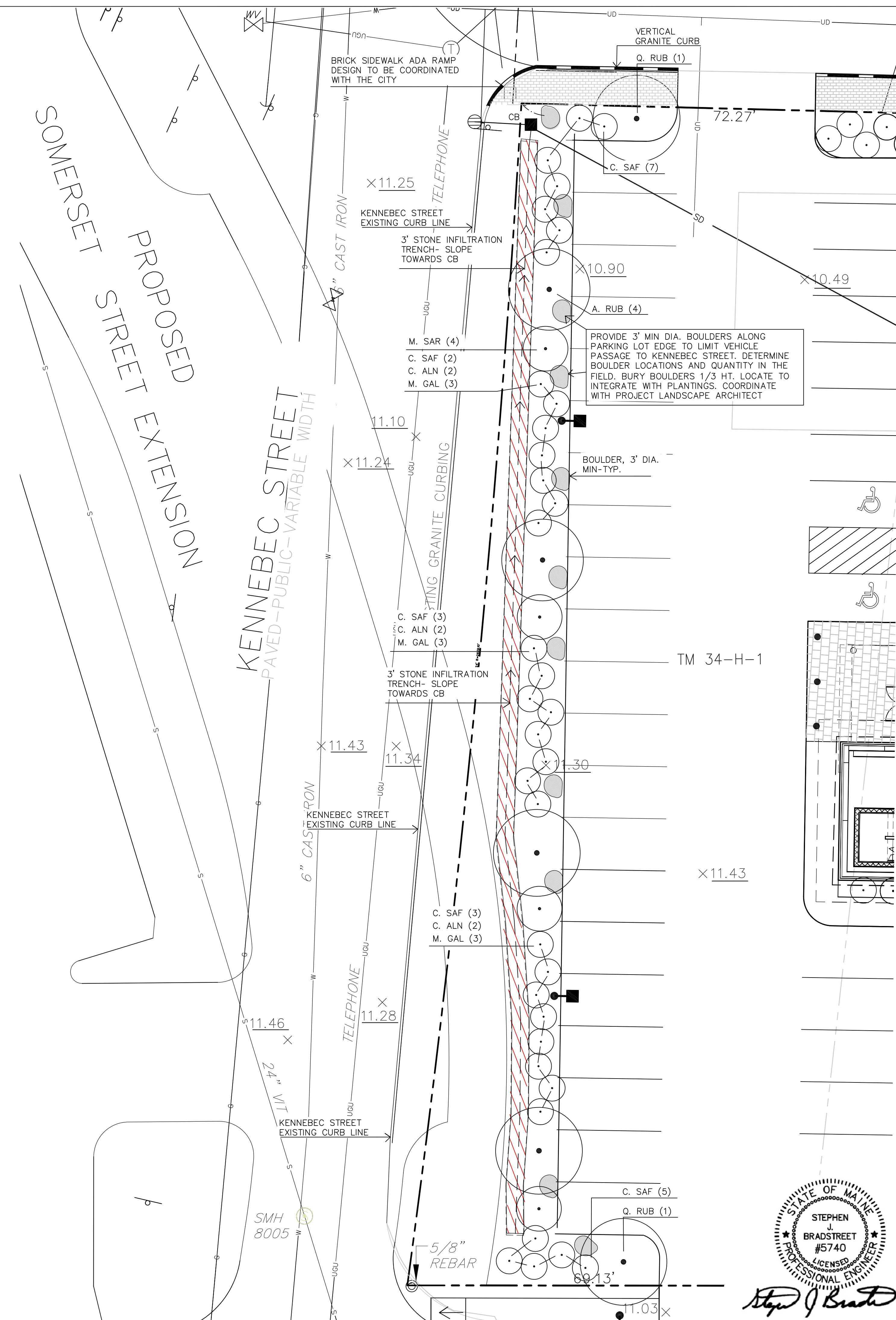

**Prepared For:**  
 Applicant:  
 BoPo.L.L.C.  
 58 Alder Street  
 Portland, Maine  
 Justin Alford, Manager

**Prepared By:**  
 MITCHELL & ASSOCIATES  
 Landscape Architects  
 The Staples School  
 70 Center Street  
 Portland, Maine 04101  
 Tel: (207) 774-4427

**BAYSIDE BOWL**

**Portland, Maine**

**58 Alder Street**

**Date:**  
 DECEMBER 18, 2015

**Issued For:**  
 AMENDED  
 SITE PLAN SUBMISSION

**Revisions:**

Reproduction or reuse of this document without the expressed written consent of Mitchell & Associates is prohibited.

**Title:**  
 DRAINAGE AND  
 PLANTING PLAN -  
 ENLARGEMENT

**Scale:** 1"=10'

**North:**

**Sheet No.:**  
**3A**

STATE OF MAINE  
 STEPHEN J. BRADSTREET  
 #5740  
 LICENSED PROFESSIONAL ENGINEER

*Step J Bradst*