

**GENERAL NOTES**

1. SITE AREA: 55,290 SF OR 1.27 ACRES
2. APPLICANT: BOPO, L.L.C.  
58 ALDER STREET  
PORTLAND, MAINE 04101
3. RECORD OWNERS: BOPO LLC, RECORDED JUNE 30, 2011 CITY OF PORTLAND, RECORDED APRIL 23, 2014  
C.C.R.D. BOOK 28797 PAGE 222 C.C.R.D. BOOK 213 PAGE 449  
TAX MAP 34, BLOCK H, LOTS 2 AND 3 TAX MAP 34, BLOCK H, LOT 4  
  
BOPO LLC, RECORDED JUNE 30, 2011 CITY OF PORTLAND, RECORDED MARCH 14, 2017  
C.C.R.D. BOOK 28797 PAGE 224 C.C.R.D. BOOK 988 PAGE 166  
TAX MAP 34, BLOCK H, LOT 1 TAX MAP 34, BLOCK H, LOT 5
4. THE SURVEYED PARCELS ARE SHOWN AS LOTS 1, 2, 3, 4 AND 5, BLOCK H, ON THE CITY OF PORTLAND'S ASSESSORS MAP 34.
5. THE PARCEL IS LOCATED, BY SCALING METHODS, WITHIN ZONE C (AREAS OF MINIMAL FLOODING) AS SHOWN ON THE FLOOD INSURANCE RATE MAP FOR THE CITY OF PORTLAND, MAINE, COMPLYING PANEL NO. 230051-0013-B WITH AN EFFECTIVE DATE OF JULY 17, 1986. THE FLOOD ELEVATION FOR THE A2 ZONE WHICH ENCOMPASSES BACK COVE HAS AN ELEVATION OF 10 NGVD 1929.
6. UTILITIES SHOWN ARE BASED ON THE REFERENCED PLANS AND A FIELD SURVEY OF VISIBLE STRUCTURES PERFORMED IN FEBRUARY 2015. DURING THE FIELD SURVEY THERE WAS SNOW IN EXCESS OF THREE FEET DEEP AND ASSOCIATED ICE THAT MADE VERIFICATION DIFFICULT. A SITE VISIT TO VERIFY UTILITIES IS RECOMMENDED ONCE SNOW COVER IS GONE.
7. THE FOLLOWING NOTES APPEAR IN THE "SURVEY REPORT FOR HANOVER STREET SALT SHED SITE" DATED JANUARY 7, 2002 BY WILLIAM G. SCOTT, P.L.S., CITY OF PORTLAND D.P.W.:
  - A. "LANCASTER STREET EAST HAD BEEN DISCONTINUED AS A CITY STREET ON MAY 5, 1995. THE DISCONTINUANCE RESERVED THE CONTINUED USE OF THIS PROPERTY AS A SEWER EASEMENT FOR THE STILL-ACTIVE NORTH SIDE INTERCEPTING SEWER. HOWEVER, THE DISCONTINUANCE NOTICE MADE NO MENTION OF ALSO DISCONTINUING THE PUBLIC EASEMENT WITHIN THE STREET BOUNDARIES."
  - B. "THE CITY HAS A STOCKADE FENCE BUILT OUT TO THE APPROXIMATE CENTERLINE OF THE STREET WHICH FENCES IN A DUMPSTER AND MATERIALS STORAGE AREA. I BELIEVE THAT THE REVERSIONARY RIGHTS INVOLVED IN THE STREET DISCONTINUANCE IN MAY 1995 WOULD ESTABLISH THE PROPERTY LINE BACK IN ITS LOCATION PRIOR TO THE CREATION OF LANCASTER STREET, AS IS CLEARLY SHOWN ON THE 1913 PLAN OF LANCASTER STREET EXTENSION, THE FORMER PROPERTY LINE BETWEEN WHAT IS NOW FURMAN AND THE CITY, FRONTING ALONG ALDER STREET, DID NOT RUN ALONG WITH THE CENTERLINE OF THE PROPOSED STREET, IN FACT, MORE LAND WAS TAKEN FROM WHAT IS NOW FURMAN'S PARCEL THAN WAS TAKEN FROM WHAT IS NOW THE CITY'S."
9. ZONING DISTRICT: B-7 MIXED DEVELOPMENT DISTRICT ZONE
10. SPACE AND BULK STANDARDS:
 

|                                | REQUIRED           | PROPOSED                 |
|--------------------------------|--------------------|--------------------------|
| MINIMUM LOT SIZE:              | NONE               | 55,290 SF                |
| MINIMUM FRONTAGE:              | NONE               | 140 FEET                 |
| FRONT SETBACK:                 | NONE REQUIRED      | EXISTING: 12.5-14.7 FEET |
| SIDE SETBACK:                  | NONE REQUIRED      | 0 FEET                   |
| REAR SETBACK:                  | NONE REQUIRED      | 10 FEET                  |
| MAXIMUM STREET SETBACK:        | 10 FEET            | 10 FEET (ADDITION)       |
| MAXIMUM BUILDING LOT COVERAGE: | 100 PERCENT        | 78 PERCENT               |
| MAXIMUM BUILDING HEIGHT:       | 105 FEET           | 45 FEET                  |
| MINIMUM BUILDING HEIGHT:       | 3 FLOORS (45 FEET) | 45 FEET                  |
11. BICYCLE PARKING:
 

|           |           |
|-----------|-----------|
| REQUIRED: | 16 SPACES |
| EXISTING: | 14 SPACES |
| PROPOSED: | 21 SPACES |
12. ALL WORK WITHIN THE ROAD RIGHT-OF-WAY AND ALL UTILITIES CONNECTING TO INFRASTRUCTURE WITHIN THE ROAD SHALL MEET CITY OF PORTLAND TECHNICAL MANUAL STANDARDS.

**LIGHTING SCHEDULE**

| KEY | QTY | MANUFACTURER | CATALOG NUMBER                         | DESCRIPTION                                    | LAMP                |
|-----|-----|--------------|--|--|---------------------|
| (A) | 3   | HOLOPHANE    | ESL 110 4K A5 X                        | BAYSIDE DISTRICT FIXTURE 'MEDIUM' LED TEARDROP | 110 W 100 LED ARRAY |
| (B) | 4   | BEACON       | VP-5-30NB-90-5K-T4-UNIV-MOB50-WB-BZ-PC | VIPER WITH PHOTOCELL                           | XX                  |
| (C) | 4   | HUBBELL      | LNC2-18LU-5K-3-1-PC                    | LAREDO WALL PAC WITH PHOTOCELL                 | XX                  |
| (D) | 5   | HUBBELL      | PGF1-P-PC-1                            | PGF1 SCONCE                                    | XX                  |

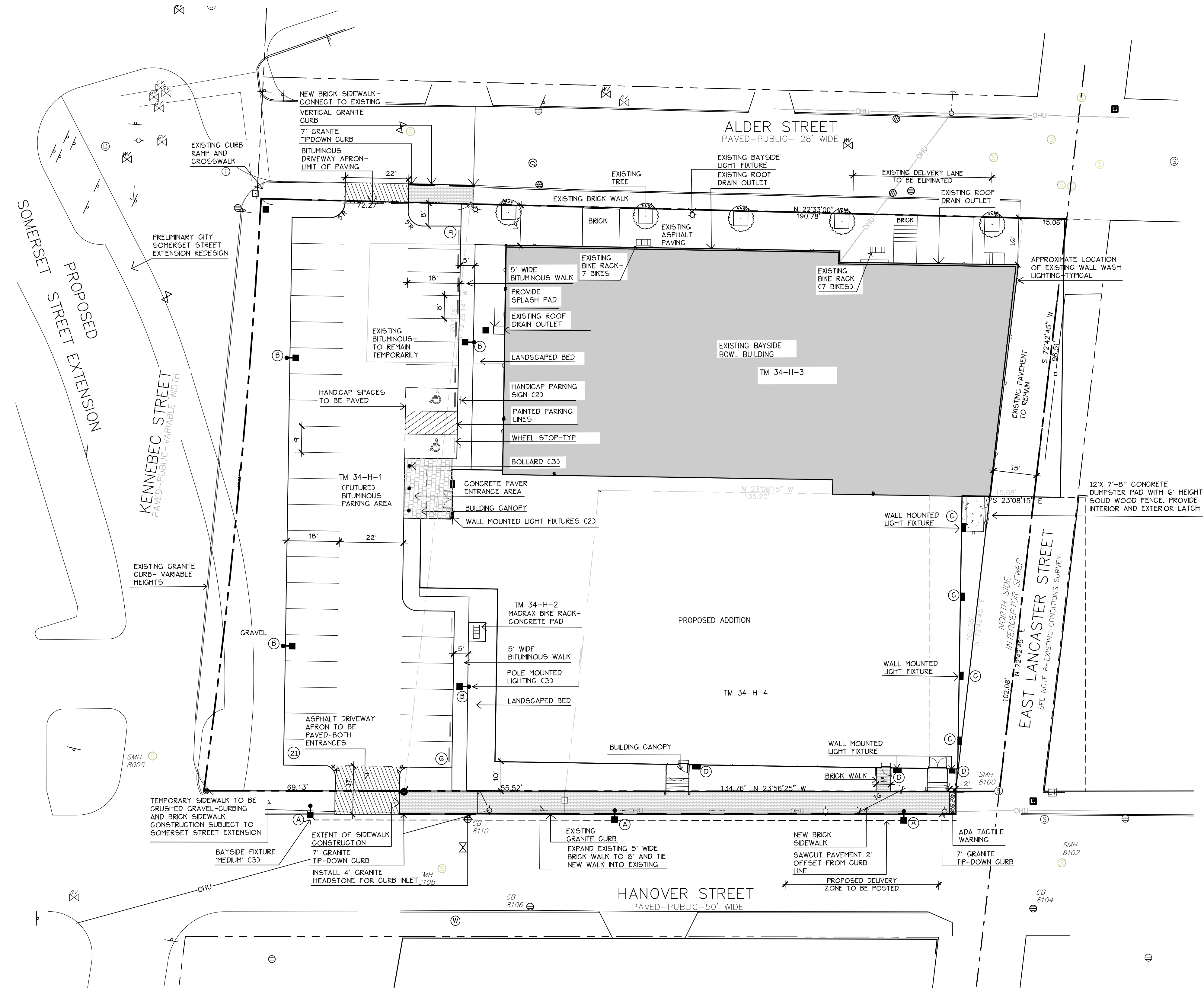

**LEGEND**

|                  | EXISTING | PROPOSED |
|------------------|----------|----------|
| PROPERTY LINE    | [Symbol] | [Symbol] |
| GRANITE MONUMENT | [Symbol] | [Symbol] |
| IRON PIN         | [Symbol] | [Symbol] |
| CATCHBASIN       | [Symbol] | [Symbol] |
| MANHOLE          | [Symbol] | [Symbol] |
| HYDRANT          | [Symbol] | [Symbol] |
| UTILITY POLE     | [Symbol] | [Symbol] |
| WATER VALVE      | [Symbol] | [Symbol] |
| SANITARY SEWER   | [Symbol] | [Symbol] |
| STORM DRAIN      | [Symbol] | [Symbol] |
| WATER            | [Symbol] | [Symbol] |
| TELEPHONE        | [Symbol] | [Symbol] |
| GAS              | [Symbol] | [Symbol] |
| CURB             | [Symbol] | [Symbol] |
| FENCE            | [Symbol] | [Symbol] |
| SIGN             | [Symbol] | [Symbol] |
| DECIDUOUS TREE   | [Symbol] | [Symbol] |
| EVERGREEN TREE   | [Symbol] | [Symbol] |
| PIPE BOLLARD     | [Symbol] | [Symbol] |
| BIKE HITCH       | [Symbol] | [Symbol] |
| ZONE LINE        | [Symbol] | [Symbol] |
| WALL MOUNTED     | [Symbol] | [Symbol] |
| LIGHT FIXTURE    | [Symbol] | [Symbol] |
| SECURITY CAMERA  | [Symbol] | [Symbol] |
| OVERHEAD WIRES   | [Symbol] | [Symbol] |
| CHP CABLE LINES  | [Symbol] | [Symbol] |

**Prepared For:**

Applicant:  
BoPo, L.L.C.  
58 Alder Street  
Portland, Maine  
Justin Alfond, Manager

**Prepared By:**

MITCHELL & ASSOCIATES  
Landscape Architects  
The Staples School  
70 Center Street  
Portland, Maine 04101  
Tel: (207) 774-4427

**BAYSIDE BOWL**  
**Portland, Maine**  
**58 Alder Street**

**Date:**  
MARCH 23, 2015

**Issued For:**  
SITE PLAN SUBMISSION

**Revisions:**  
4-23-15:  
per staff comments

Reproduction or reuse of  
this document without the  
expressed written consent of  
Mitchell & Associates is prohibited.

**Title:**  
LAYOUT AND LIGHTING  
PLAN

**Scale:** 1"=20'  
0 10 20 40 ft.

**North:** [Symbol]  
**Sheet No.:**  
**2**

